

EXISTING DRAINAGE
 RAMP "B" 55+06.6 LT
 EXISTING DIAND GRATE ~ REMOVE
 EXISTING PIPE ~ RETAIN AND PREP. FOR NEW CB

NEW DRAINAGE
 RAMP "B" 55+06.6 LT
 NEW CB AND NEW 18"x4' PCCSP

8 INCH UNDERDRAIN

③ RAMP "B" 57+59.7 RT ~ RAMP "B" 55+00.0 RT
 NEW 8"x260' UNDERDRAIN W/FB @ RAMP "B" 57+59.7 RT

④ SLIP RAMP "B" 80+62.2 RT ~ RAMP "B" 57+59.7 RT
 NEW 8"x111' UNDERDRAIN W/FB @ SLIP RAMP "B" 80+62.2 RT

⑤ RAMP "B" 56+75.0 LT ~ RAMP "B" 55+06.3 LT
 NEW 8"x166' UNDERDRAIN W/FB @ RAMP "B" 56+75.0 LT

⑥ RAMP "B" 58+59.0 LT ~ RAMP "B" 56+75.0 LT
 NEW 8"x184' UNDERDRAIN W/FB @ RAMP "B" 58+59.0 LT

8 INCH UNDERDRAIN CARRIER PIPE

① RAMP "B" 53+07.4 RT ~ RAMP "B" 53+00.0 RT
 NEW 8"x18' UNDERDRAIN CARRIER PIPE W/FB
 @ RAMP "B" 53+07.4 RT

② RAMP "B" 55+00.0 RT ~ RAMP "B" 53+07.4 RT
 NEW 8"x194' UNDERDRAIN CARRIER PIPE W/FB
 @ RAMP "B" 55+00.0 RT

EXIT 15 SB ON-RAMP

INTERSTATE-89
(SOUTHBOUND)

INTERSTATE-89
(NORTHBOUND)

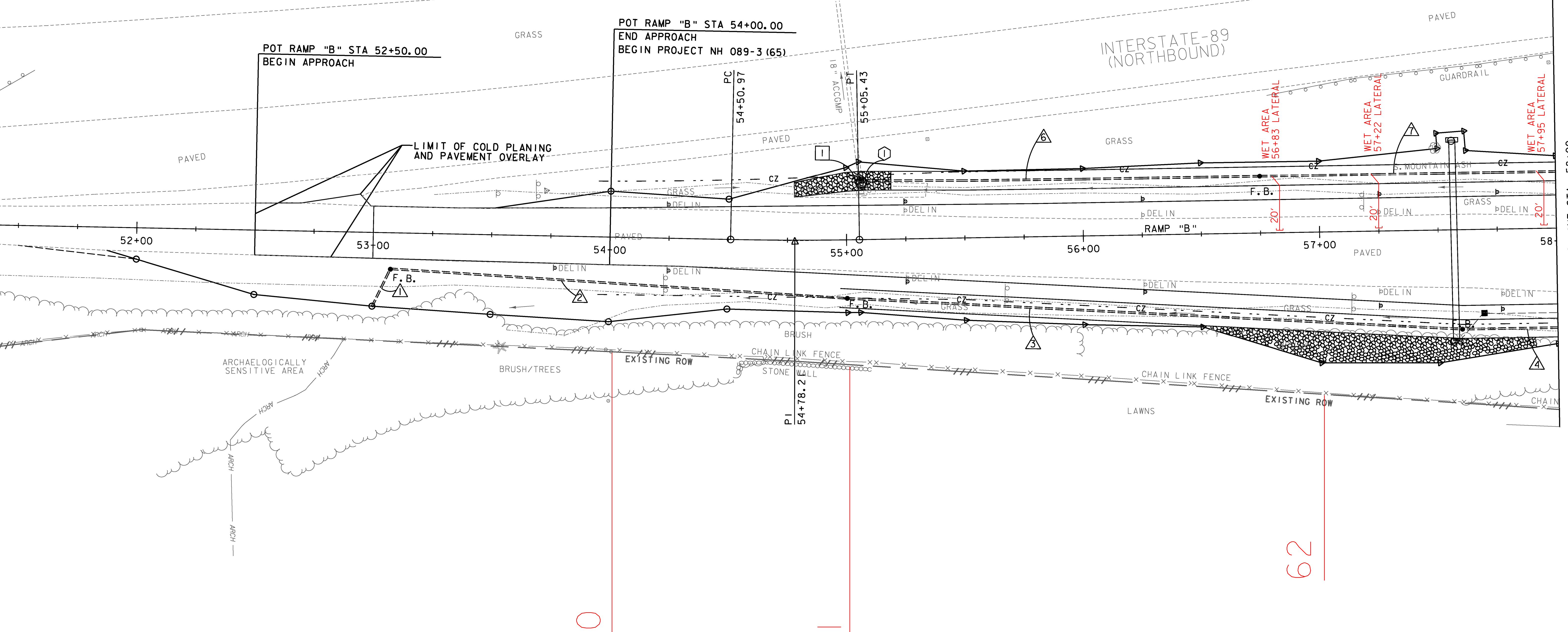
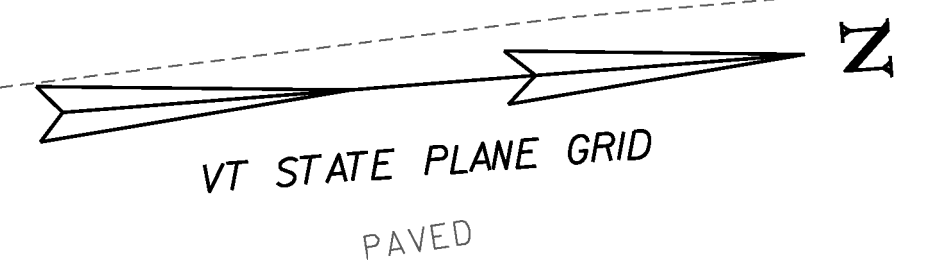

MATCHLINE STA. 58+00
DRAINAGE LAYOUT SHEET 2

60

61

62



PROJECT NAME:	WINOOSKI	FILE NAME:	z94a198drnbdr.dgn	PLOT DATE:	2/23/2010
PROJECT NUMBER:	NH 089-3(65)	PROJECT LEADER:	KEN UPMAL	DRAWN BY:	T.BIGELOW
		DESIGNED BY:	T.BIGELOW	CHECKED BY:	E.ATKINS
		DRAINAGE LAYOUT SHEET 1		SHEET	25 OF 67