

**COLD PLANING, BITUMINOUS PAVEMENT**

RAMP "B" 52+50.0 ~ 53+00.0

**CLEARING AND GRUBBING, INCLUDING INDIVIDUAL TREES AND STUMPS**

RAMP "B" 52+25 RT ~ 58+00 RT  
RAMP "B" 57+49.1 LT (S. MOUNTAIN ASH)

**REMOVE EXISTING PAVEMENT (COMMON EXCAVATION)**

RAMP "B" 53+00.0 ~ 58+00.0  
RAMP "B" 54+78 LT ~ 55+35 LT (PAVED WATERWAY)

**STONE FILL, TYPE I**

RAMP "B" 54+78 LT ~ 55+19 LT

**STONE FILL, TYPE II**

RAMP "B" 56+50 RT ~ 57+90 RT

**DELINEATOR WITH STEEL POST**

RAMP "B" 53+75 LT-RT ~ 58+00 LT-RT (EACH)  
REMOVE, STACK AND REINSTALL EACH

EXIT 15 SB ON-RAMP

**CURVE DATA**  
Δ = 2° 04' 48.90" LT.  
D = 3° 49' 11"  
R = 1500.00'  
T = 27.23'  
L = 54.46'  
E = 0.25'  
BANK = N/A

VT STATE PLANE GRID  
PAVED

INTERSTATE-89 (SOUTHBOUND)

INTERSTATE-89 (NORTHBOUND)

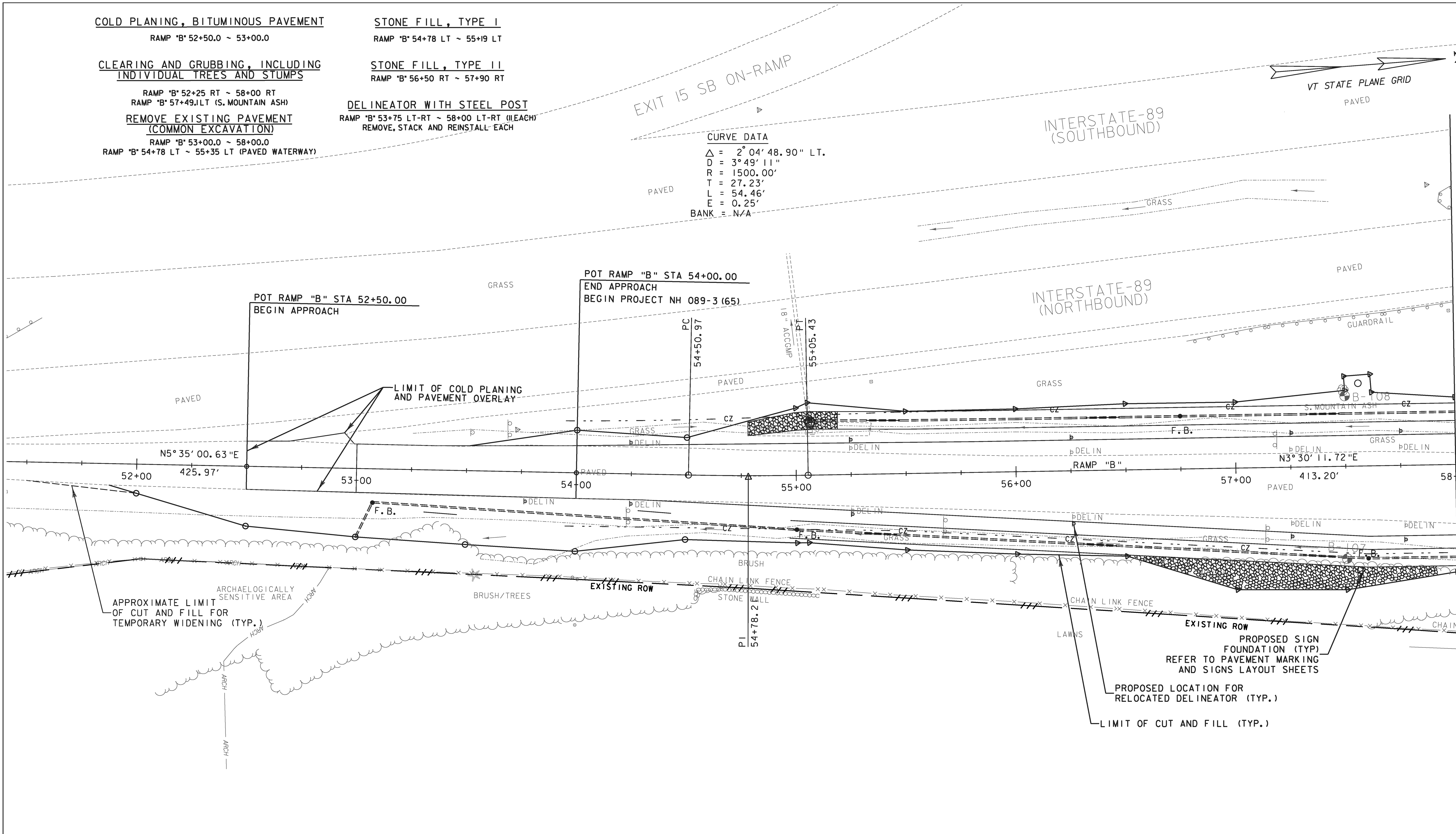

N5° 35' 00.63" E

N3° 30' 11.72" E

APPROXIMATE LIMIT OF CUT AND FILL FOR TEMPORARY WIDENING (TYP.)

PROPOSED SIGN FOUNDATION (TYP.) REFER TO PAVEMENT MARKING AND SIGNS LAYOUT SHEETS  
PROPOSED LOCATION FOR RELOCATED DELINEATOR (TYP.)  
LIMIT OF CUT AND FILL (TYP.)

MATCHLINE STA. 58+00  
ROADWAY LAYOUT SHEET 2

PROJECT NAME: WINOOSKI  
PROJECT NUMBER: NH 089-3(65)

FILE NAME: z94a198bdr.dgn  
PROJECT LEADER: KEN UPMAL  
DESIGNED BY: T.BIGELOW  
ROADWAY LAYOUT SHEET 1

PLOT DATE: 3/9/2010  
DRAWN BY: T.BIGELOW  
CHECKED BY: E.ATKINS  
SHEET 19 OF 67

