

FLG THK	'A'
25	6
42	12

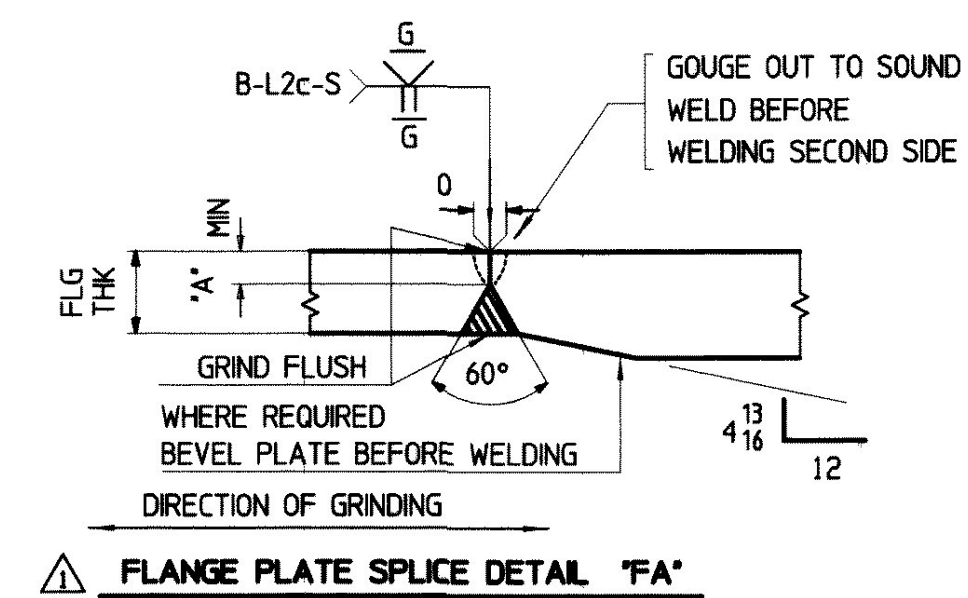

SECTION A-A FOR 6G1B THRU 10G5B

LOCATION	RAD	ARC	CHD	AB	AC	A1	A2	A3	A4	A5	B1	B2	B3	B4	B5	BB	CB	C1	C2	C3	C4	C5	CC	WL1	WL2	WL3	HD1	HD2	PL PA (M270-50WT2)	PL PB (M270-50WT2)	PL PC (M270-50WT2)
6G1B TOP FLG	1130.92	131'-4 7/8"	131'-4"	51'-5 1/8"	39'-11 7/8"	2 1/8"	2 1/16"	1 3/4"	1 3/8"	3/4"	3 1/2"	3 3/8"	2 15/16"	2 1/4"	1 1/4"	5'-1 11/16"	51'-5 1/16"	2 1/8"	2 1/16"	1 3/4"	1 3/8"	3/4"	39'-11 7/8"	39'-11 7/8"	51'-5 1/16"	39'-11 1/2"	1'-7 3/8"	1'-7 3/8"	PL 1 1/2 x 16-ta (2/L)	PL 1 x 16-tb (3/C)	PL 1 1/2 x 16-tc (2/L)
6G1B BTM FLG	1130.92	131'-5 1/4"	131'-4 3/8"	51'-5 1/2"	39'-11 7/8"	2 1/8"	2 1/16"	1 3/4"	1 3/8"	3/4"	3 1/2"	3 3/8"	2 15/16"	2 1/4"	1 1/4"	5'-1 3/4"	51'-5 1/16"	2 1/8"	2 1/16"	1 3/4"	1 3/8"	3/4"	39'-11 7/8"	39'-11 7/8"	51'-5 1/16"	39'-11 1/2"	1'-7 3/8"	1'-7 3/8"	PL 1 1/2 x 16-ba (2/L)	PL 1 1/2 x 16-bb (1/Q)	PL 1 1/2 x 16-bc (2/L)
7G2B TOP FLG	1138.42	130'-9 5/8"	130'-8 3/4"	50'-9 7/8"	39'-11 7/8"	2 1/8"	2	1 3/4"	1 3/8"	3/4"	3 3/8"	3 1/4"	2 7/8"	2 3/8"	1 1/4"	5'-1"	50'-9 7/8"	2 1/8"	2	1 3/4"	1 3/8"	3/4"	39'-11 13/16"	39'-11 7/8"	50'-9 7/8"	39'-11 1/2"	1'-7 1/8"	1'-7 1/8"	PL 1 1/2 x 16-ta (2/L)	PL 1 x 16-tb (3/E)	PL 1 1/2 x 16-tc (2/L)
7G2B BTM FLG	1138.42	130'-9 15/16"	130'-9 1/16"	50'-10 1/4"	39'-11 13/16"	2 1/8"	2	1 3/4"	1 3/8"	3/4"	3 7/16"	3 1/4"	2 7/8"	2 3/8"	1 1/4"	5'-1"	50'-10 3/16"	2 1/8"	2	1 3/4"	1 3/8"	3/4"	39'-11 13/16"	39'-11 7/8"	50'-10 3/16"	39'-11 1/2"	1'-7 1/8"	1'-7 1/8"	PL 1 1/2 x 16-ba (2/L)	PL 1 1/2 x 16-bb (1/S)	PL 1 1/2 x 16-bc (2/L)
8G3B TOP FLG	1145.92	130'-2 1/16"	130'-1 7/8"	50'-2 15/16"	39'-11 7/8"	2 1/8"	2	1 3/4"	1 5/16"	3/4"	3 5/16"	3 3/16"	2 3/4"	2 1/8"	1 3/16"	5'-0 5/16"	50'-2 15/16"	2 1/8"	2	1 3/4"	1 5/16"	3/4"	39'-11 13/16"	39'-11 1/2"	50'-2 15/16"	39'-11 7/8"	1'-6 7/8"	1'-6 7/8"	PL 1 1/2 x 16-ta (2/L)	PL 1 x 16-tb (3/G)	PL 1 1/2 x 16-tc (2/L)
8G3B BTM FLG	1145.92	130'-3 1/16"	130'-2 1/4"	50'-3 5/16"	39'-11 7/8"	2 1/8"	2	1 3/4"	1 5/16"	3/4"	3 5/16"	3 3/16"	2 3/4"	2 1/8"	1 3/16"	5'-0 5/16"	50'-3 1/4"	2 1/8"	2	1 3/4"	1 5/16"	3/4"	39'-11 7/8"	39'-11 1/2"	50'-3 1/4"	39'-11 1/2"	1'-6 7/8"	1'-6 7/8"	PL 1 1/2 x 16-ba (2/L)	PL 1 1/2 x 16-bb (1/U)	PL 1 1/2 x 16-bc (2/L)
9G4B TOP FLG	1153.42	129'-8"	129'-7 3/8"	49'-8 1/4"	39'-11 7/8"	2 1/8"	2	1 3/4"	1 5/16"	3/4"	3 3/16"	3 1/16"	2 11/16"	2 1/16"	1 1/8"	4'-11 5/8"	49'-8 1/4"	2 1/8"	2	1 3/4"	1 5/16"	3/4"	39'-11 13/16"	39'-11 1/2"	49'-8 1/4"	39'-11 7/8"	1'-6 5/8"	1'-6 5/8"	PL 1 1/2 x 16-ta (2/L)	PL 1 x 16-tb (3/J)	PL 1 1/2 x 16-tc (2/L)
9G4B BTM FLG	1153.42	129'-8 3/8"	129'-7 1/8"	49'-8 5/8"	39'-11 7/8"	2 1/8"	2	1 3/4"	1 5/16"	3/4"	3 3/16"	3 1/16"	2 11/16"	2 1/16"	1 1/16"	4'-11 11/16"	49'-8 5/8"	2 1/8"	2	1 3/4"	1 5/16"	3/4"	39'-11 13/16"	39'-11 1/2"	49'-8 5/8"	39'-11 1/2"	1'-6 5/8"	1'-6 5/8"	PL 1 1/2 x 16-ba (2/L)	PL 1 1/2 x 16-bb (1/W)	PL 1 1/2 x 16-bc (2/L)
10G5B TOP FL	1160.92	129'-1 9/16"	129'-0 3/4"	49'-1 13/16"	39'-11 7/8"	2 1/8"	2	1 3/4"	1 5/16"	3/4"	3 1/8"	3	2 5/8"	2	1 1/8"	4'-11"	49'-1 1/4"	2 1/8"	2	1 3/4"	1 5/16"	3/4"	39'-11 13/16"	39'-11 1/2"	49'-1 3/4"	39'-11 1/2"	1'-6 7/8"	1'-6 7/8"	PL 1 1/2 x 16-ta (2/L)	PL 1 x 16-tb (3/L)	PL 1 1/2 x 16-tc (2/L)
10G5B BTM FL	1160.92	129'-1 15/16"	129'-1 1/8"	49'-2 1/4"	39'-11 13/16"	2 1/8"	2	1 3/4"	1 5/16"	3/4"	3 1/8"	3	2 5/8"	2	1 1/8"	4'-11"	49'-2 3/16"	2 1/8"	2	1 3/4"	1 5/16"	3/4"	39'-11 13/16"	39'-11 1/2"	49'-2 3/16"	39'-11 7/8"	1'-6 7/8"	1'-6 7/8"	PL 1 1/2 x 16-ba (2/L)	PL 1 1/2 x 16-bb (1/Y)	PL 1 1/2 x 16-bc (2/L)

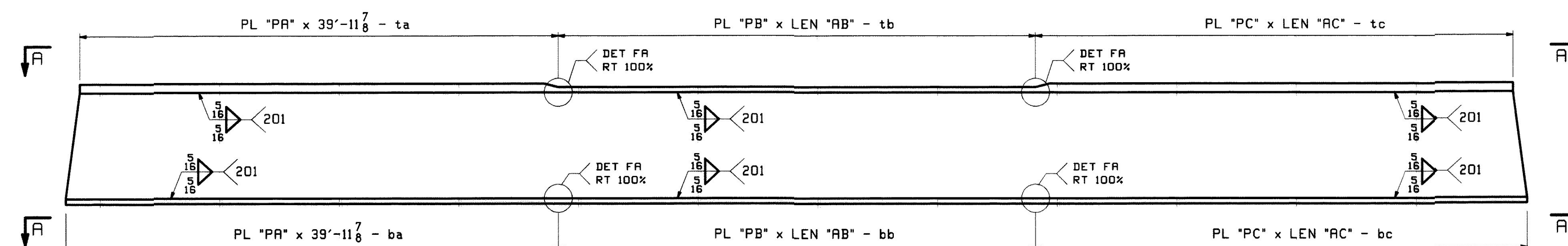

FLANGE DIAGRAM FOR 6G1B THRU 10G5B

NOTES:  
1. FOR GENERAL SHOP NOTES SEE DRAWING GNI.

REV.	DATE	REMARKS	DWN	CHK	APVL	SHOP
0	2/22/2010	APPROVAL COMMENT: ADD THK TRANSITION		SOB	SOB	
MATERIAL:		SURFACE PREP. & PAINT:	HOLES:		SHOP BOLTS:	
M270-50W			AS NOTED		AS NOTED	
DESCRIPTION: FLANGE DIAGRAM						
CASCO BAY STEEL STRUCTURES, INC. 75 SPRING HILL ROAD SACO, MAINE 04072 PHONE (207) 282-7360 FAX. (207) 282-1179						
STRUCTURE: U.S. 5 over I-91 Bridge No. 19A Putney County of Windham			DRAWN:	DATE:		
			SOB	01/05		
LOCATION: Putney			CHKD:	DATE:		
JOB NO. IM 091-1(3)			SOB	01/08		
CUSTOMER: VT ROT			JOB NO.	DWG NO.		
			438	F2		
			REV.			

APPROVED BY: [Signature]  
DATE: 2/22/2010  
SCALE: AS SHOWN  
DESIGN: [Signature]  
CHECKED: [Signature]  
DATE: 2/22/2010