

ELEVATION

SECTION A-A

BOLTED FIELD SPLICE DETAILS

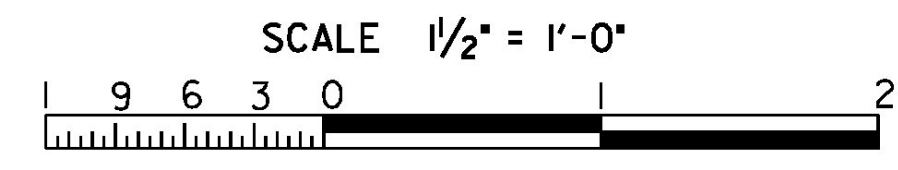

ALL PLATES SHALL BE CHARPY V-NOTCH TESTED

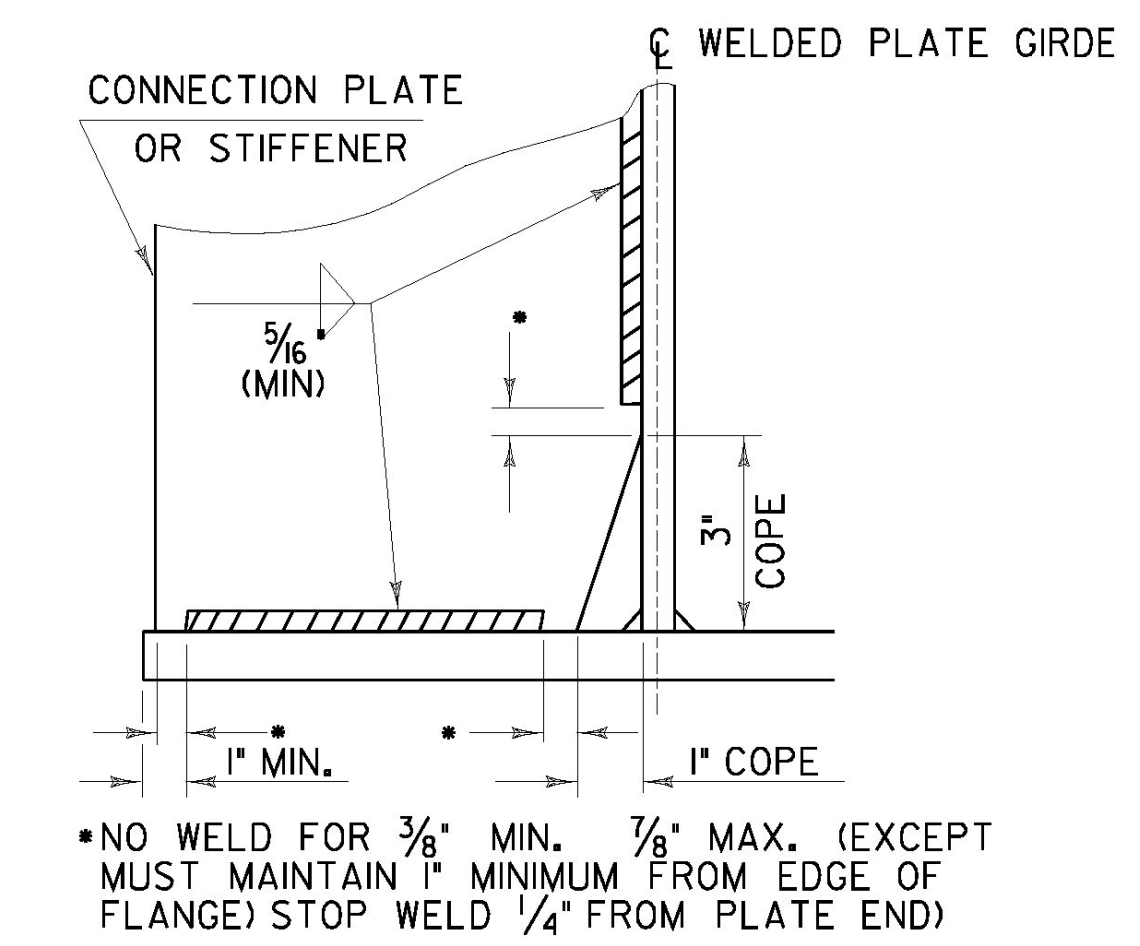

**WELD TERMINATION AND COPING
DETAILS FOR STEEL MEMBERS**
NOT TO SCALE

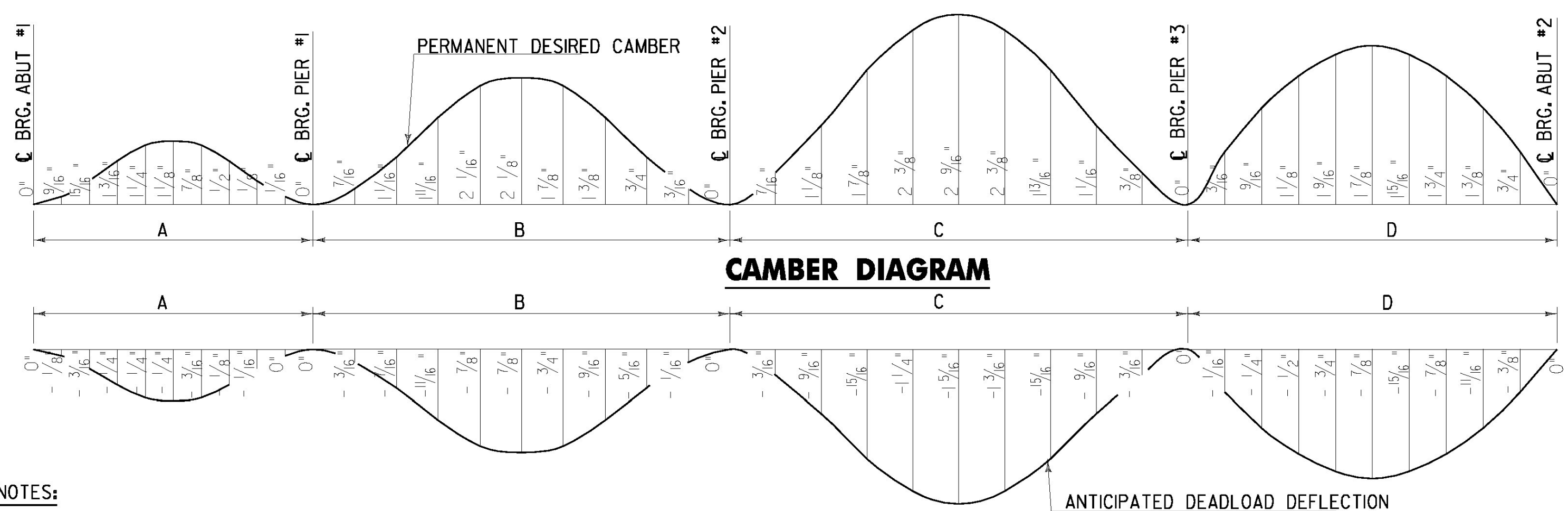

DEAD LOAD DEFLECTION

- NOTES:**
- CAMBER AND DEAD LOAD MEASUREMENTS ARE GIVEN IN INCHES AT SPAN TENTH POINTS.
 - DEAD LOAD DEFLECTIONS SHOWN ARE FOR ALL DEAD LOADS AND SUPERIMPOSED DEAD LOADS INCLUDING BEAM AND DIAPHRAGM WEIGHTS. DESIGN DEAD LOAD DEFLECTIONS SHOWN ARE BASED ON THE AVERAGE OF GIRDERS 1 THRU 5.
 - CAMBER DIAGRAM INCLUDES RESIDUAL CAMBER, WHICH EXCEEDS THE VERTICAL CURVATURE CORRECTION. ADDITIONAL CORRECTION FOR VERTICAL CURVATURE IS NOT REQUIRED.

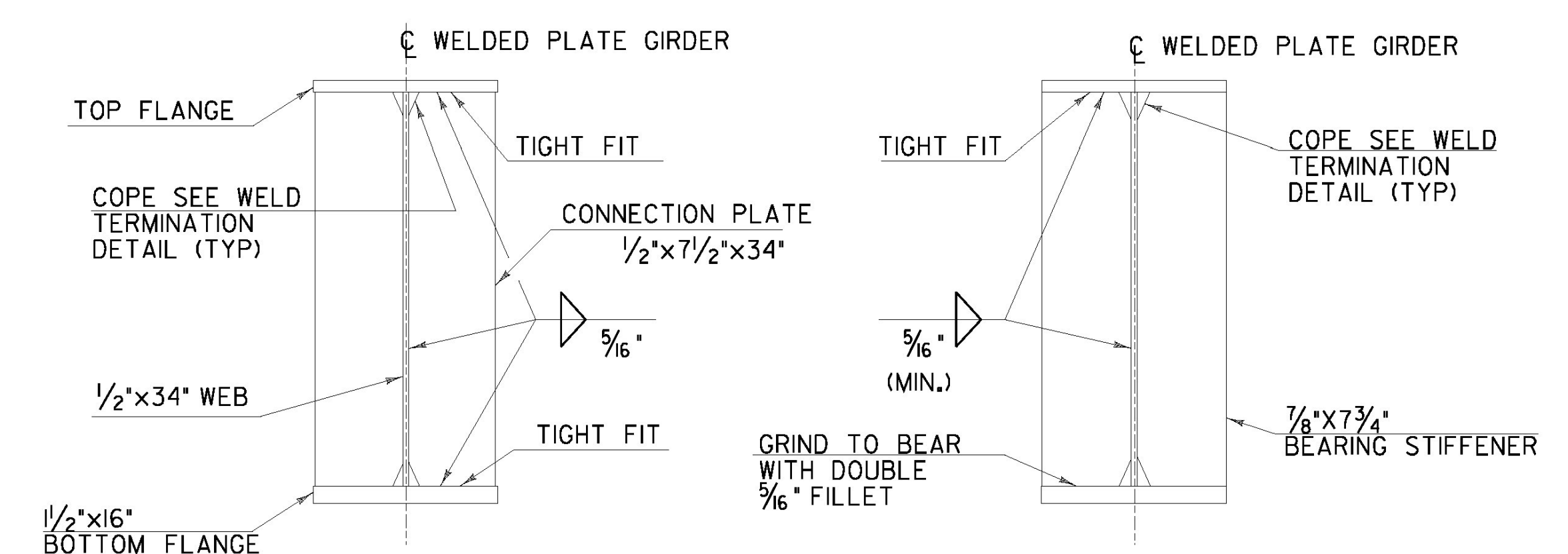

INTERMEDIATE CONNECTION PLATES
NOT TO SCALE

BEARING STIFFENERS
NOT TO SCALE

| STATE OF VERMONT AGENCY OF TRANSPORTATION | | | |
|--|--|--------------------------|---------------------|
| Town Of | PUTNEY | Bridge No. | 19A |
| Highway No. | U.S. ROUTE 5 | Log Sta. | |
| | | Surv. Sta. | |
| U.S. ROUTE 5 OVER I-91 | | | |
| GIRDER DETAILS II | | | |
| Designed By | G. BOGUE | Drawn By | E. ALLING |
| Checked By | G. BOGUE | Date | 06/09 |
| | | Bridge Design Supervisor | G. BOGUE Date 07/09 |
| PROJECT | PUTNEY | PROJECT NO. | NH F019-(15) |
| CAD Drawing Name: | ...Plot Files\30 29301600.dwg 7/8/2009 | | |
| Bridge Sheet No. | | Sheet | 30 of 75 |

