

ITEM 210.10 COLD PLANING-BIT. PAVEMENT
 STATION 205+50.00 - 206+00.00
 STATION 213+50.00 - 214+00.00

ITEM 621.20 STEEL BEAM GUARDRAIL, GALVANIZED
 STATION 206+45.71 - 207+45.71 RIGHT
 STATION 206+47.68 - 207+72.68 LEFT
 STATION 211+47.92 - 211+72.55 RIGHT
 STATION 211+98.34 - 212+23.69 LEFT

ITEM 621.50 MANUFACTURED TERMINAL SECTION, FLARED
 STATION 206+08.21 - 206+45.71 RIGHT
 STATION 206+10.18 - 206+47.68 LEFT

ITEM 621.75 REMOVE AND RESET GUARDRAIL
 STATION 212+23.69 - 213+50.00 LEFT

ITEM 621.79 ADJUST HEIGHT OF GUARDRAIL
 STATION 211+72.55 - 212+50.00 RIGHT

ITEM 616.28 CAST-IN-PLACE CEMENT
 CONCRETE CURB, TYPE B
 STATION 207+45.71 - 207+75.12 RIGHT
 STATION 207+72.68 - 208+02.09 LEFT
 STATION 211+18.91 - 211+47.92 RIGHT
 STATION 211+68.51 - 211+98.34 LEFT

ITEM 621.80 REMOVAL AND DISPOSAL OF GUARDRAIL
 STATION 205+50.00 - 207+87.21 RIGHT
 STATION 206+50.97 - 208+12.75 LEFT
 STATION 211+20.10 - 211+72.55 RIGHT
 STATION 211+69.51 - 212+23.69 LEFT

ITEM 646.40 DURABLE 4" WHITE LINE
 STATION 205+50.00 - 214+00.00 LEFT & RIGHT

ITEM 646.41 DURABLE 4" YELLOW LINE (DOUBLE)
 STATION 205+50.00 - 214+00.00

ITEM 631.10 STONE FILL, TYPE I
 STA. 212+00.00 LEFT
 ITEM 649.31 GEOTEXTILE UNDER STONE FILL
 STA. 212+00.00 LEFT

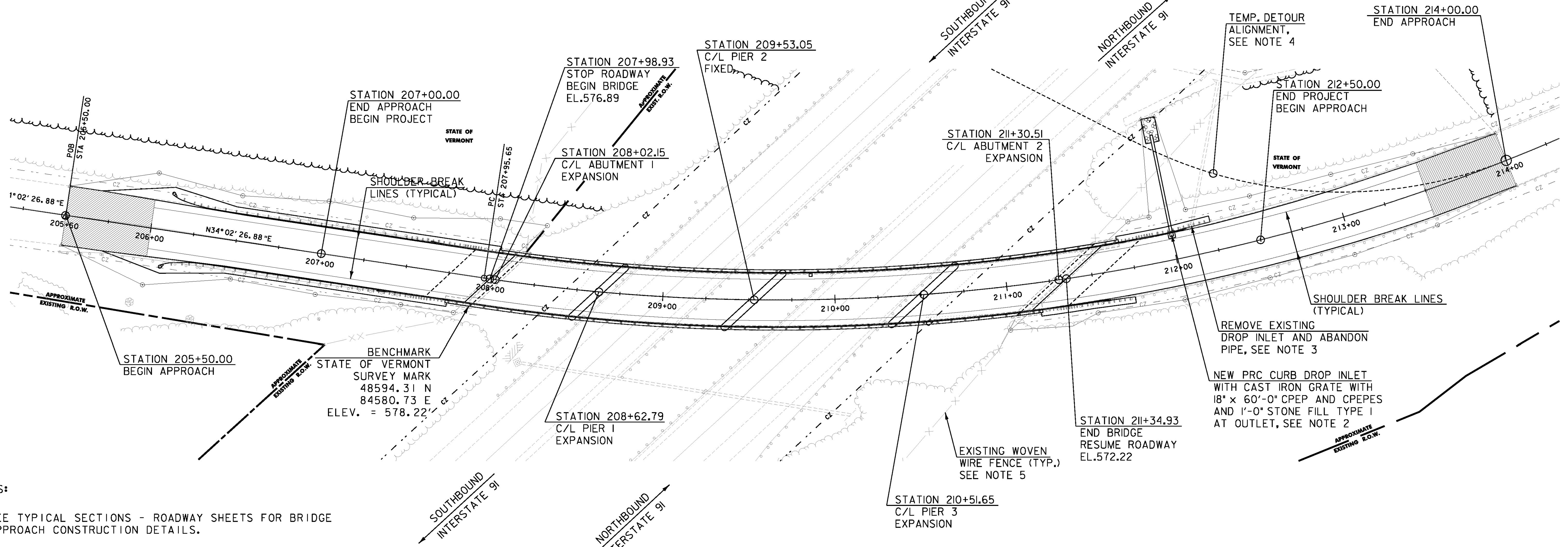
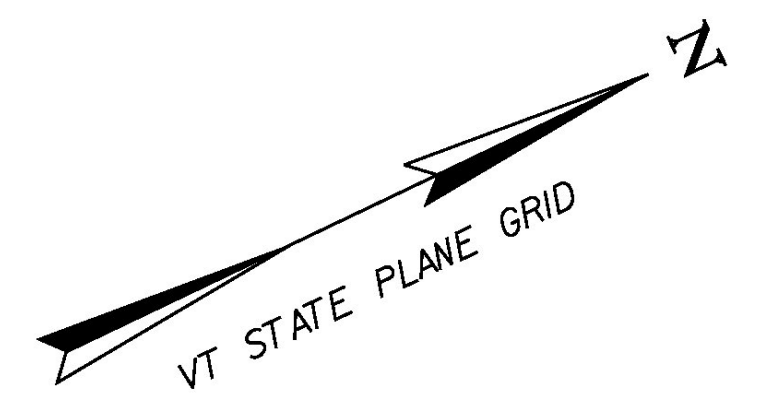

NOTES:

- SEE TYPICAL SECTIONS - ROADWAY SHEETS FOR BRIDGE APPROACH CONSTRUCTION DETAILS.
- PROVIDE GEOTEXTILE UNDER STONE FILL IN ACCORDANCE WITH SECTION 649 OF THE STANDARD SPECIFICATIONS. GEOTEXTILE TO BE PAID AS ITEM 649.31.
- REMOVAL OF EXISTING DROP INLET SHALL BE CONSIDERED INCIDENTAL TO ITEM 203.15 COMMON EXCAVATION.
- SEE TRAFFIC CONTROL PLAN (US 5) FOR TEMPORARY DETOUR INFORMATION INCLUDING CLEARING AND GRUBBING LIMITS AND ALIGNMENT DATA.
- ITEM 620.12, CHAIN LINK FENCE, 6 FEET SHALL BE USED TO REPLACE APPROXIMATELY 100 FEET OF EXISTING RIGHT OF WAY FENCE REMOVED AT EACH CORNER OF THE BRIDGE. REMOVAL OF RIGHT OF WAY FENCE SHALL BE INCIDENTAL TO ITEM 620.12.
- DURABLE 4" YELLOW LINE IS COINCIDENT WITH CONSTRUCTION BASELINE.
- DURABLE 4" WHITE LINE IS USED TO MARK EDGE OF TRAVELWAY. SEE TYPICAL SECTIONS - ROADWAY SHEETS.

LEGEND

COLD PLANING

| PI DATA | ARC DEFINITION |
|--|--|
| | CURVE DATA |
| BEARING: N34°02'26.88"E N24°34'57.10"W | $\Delta = 58^\circ - 37' - 23.98" \text{ LEFT}$ D = 05°-00'-00" R = 1145.92 T = 643.36 L = 1172.47 E = 168.25 BANK = 0.067 FT / FT |
| STA. 214+39.01 BK = STA. 213+24.75 AHD | |

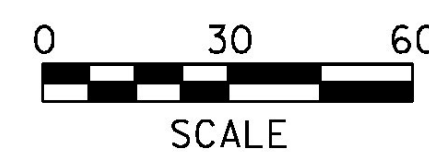

PROJECT NAME: PUTNEY
 PROJECT NUMBER: IM 091-(131)
 FILE NAME: ...\\Plot Files\09 z93a148plani.p+fPLOT DATE: 7/8/2009
 PROJECT LEADER: G. BOGUE DRAWN BY: E. ALLING
 DESIGNED BY: E. ALLING CHECKED BY: G. GOYETTE
LAYOUT PLAN SHEET 9 OF 75