

NOTES:

- 1- For location of cross-frames see BR 108-110
- 2- Transverse stiffeners at intermediate cross-frames (CF-2) shall be welded to the web of an angle so that the gusset plates need not be bent.

PIER AND ABUTMENT CROSS FRAMES
SCALE 1/2" = 1'-0"

CF-1 ALL L-4x4x8
CF-3 ALL L-5x5x8
CF-4 ALL L-5x5x8

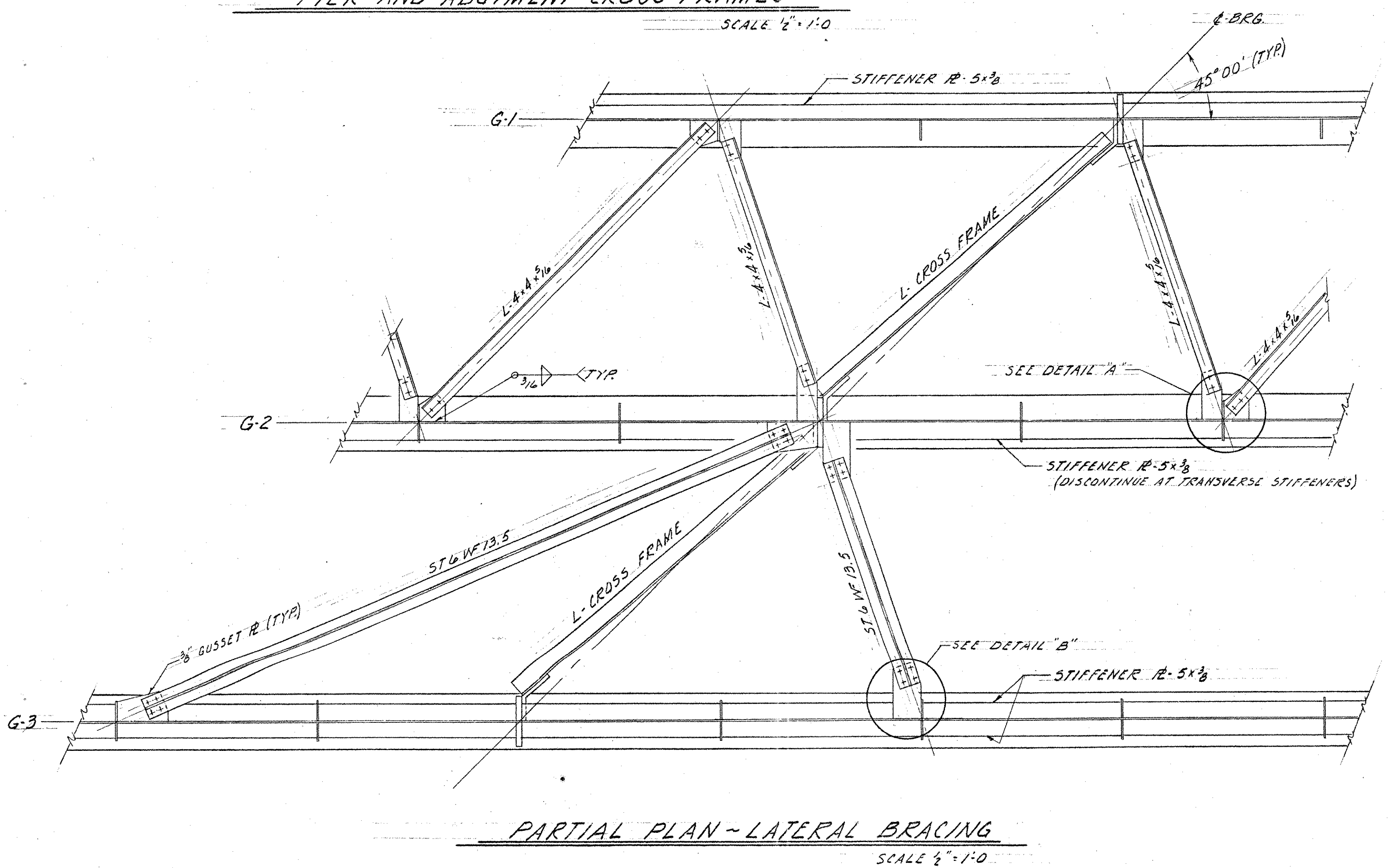
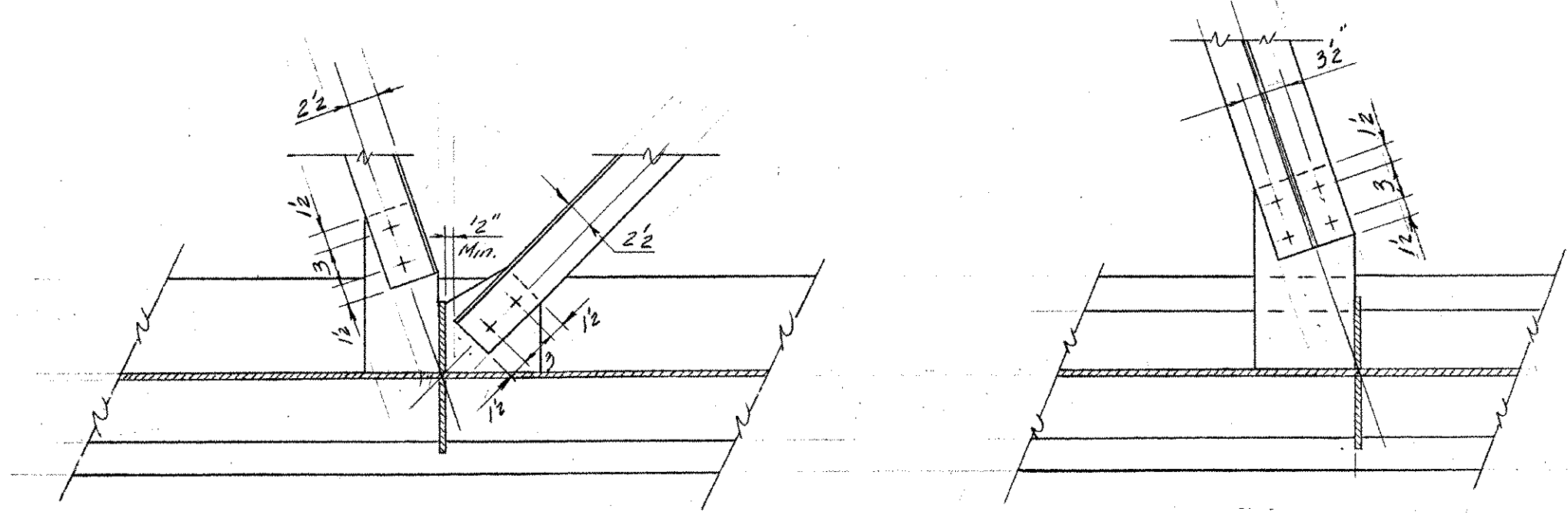

ITEM NO.	ITEM	UNIT	NET	TOTAL	FINAL
	CHAN. EXCAV. OF EARTH	C. Y.			
	CHAN. EXCAV. OF ROCK	C. Y.			
	UNCLASS. CHAN. EXCAV.	C. Y.			
	STRUCT. EXCAV.	C. Y.			
	CONC. CLASS AA (MOD.)	C. Y.			
	CONC. CLASS B (MOD.)	C. Y.			
	REINF. STEEL	LBS.			
	ASPHALTIC-ASB. COATING	S. Y.			
	TREATED TIMBER PILING	L. F.			
	SPLICES FOR STEEL PILING	EA.			
	STEEL PILING	L. F.			
	UNTREATED TIMBER PILING	L. F.			

IR 089-1(13)
This sheet for information only
BR 11 N & S
BR. 111 OF 128

STATE OF VERMONT
DEPARTMENT OF HIGHWAYS

TOWN OF HARTFORD
ROAD NO. I-89 BRIDGE NO. _____
I-89 OVER WHITE RIVER, VT. 74 AND CVRR
BRACING DETAILS
SCALE As Shown

SURVEYED BY _____
DRAWN BY RLO CHECKED BY AGC
PROJECT NO. I-89-1(6)
SHEET 19 OF 59 SHEET 61 OF 101