

FRAMING PLAN

SCALE 8" = 1'-0"

NOTES: ~

- 1- For General Notes see Std. Sht. S.C.B-D1-63 and B.R.100
- 2- Span No. 4 girders identical to Span No. 3. Bracing to be similar.
- 3- Span Nos. 3 and 4 shall each be combered 5/8"
- 4- Intermediate transverse stiffeners between Field Splices shall be welded to the web and to the top flange. All other intermediate transverse stiffeners shall be welded to the web and to the bottom flange.
- 5- For detail of 40'-0" parabolic haunch see B.R. 109.
- 6- For detail of field Splice "B" and other notes see B.R. 108.
- 7- For details of lateral bracing and cross-braces see B.R. 111.

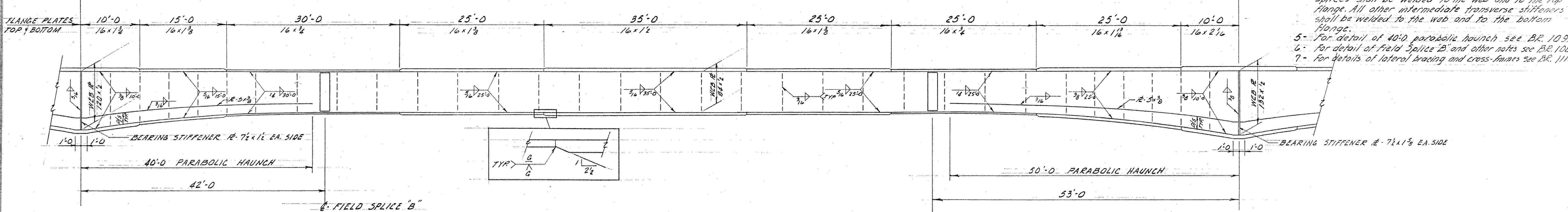

ELEVATION - EXTERIOR GIRDER

SCALE 8" = 1'-0"

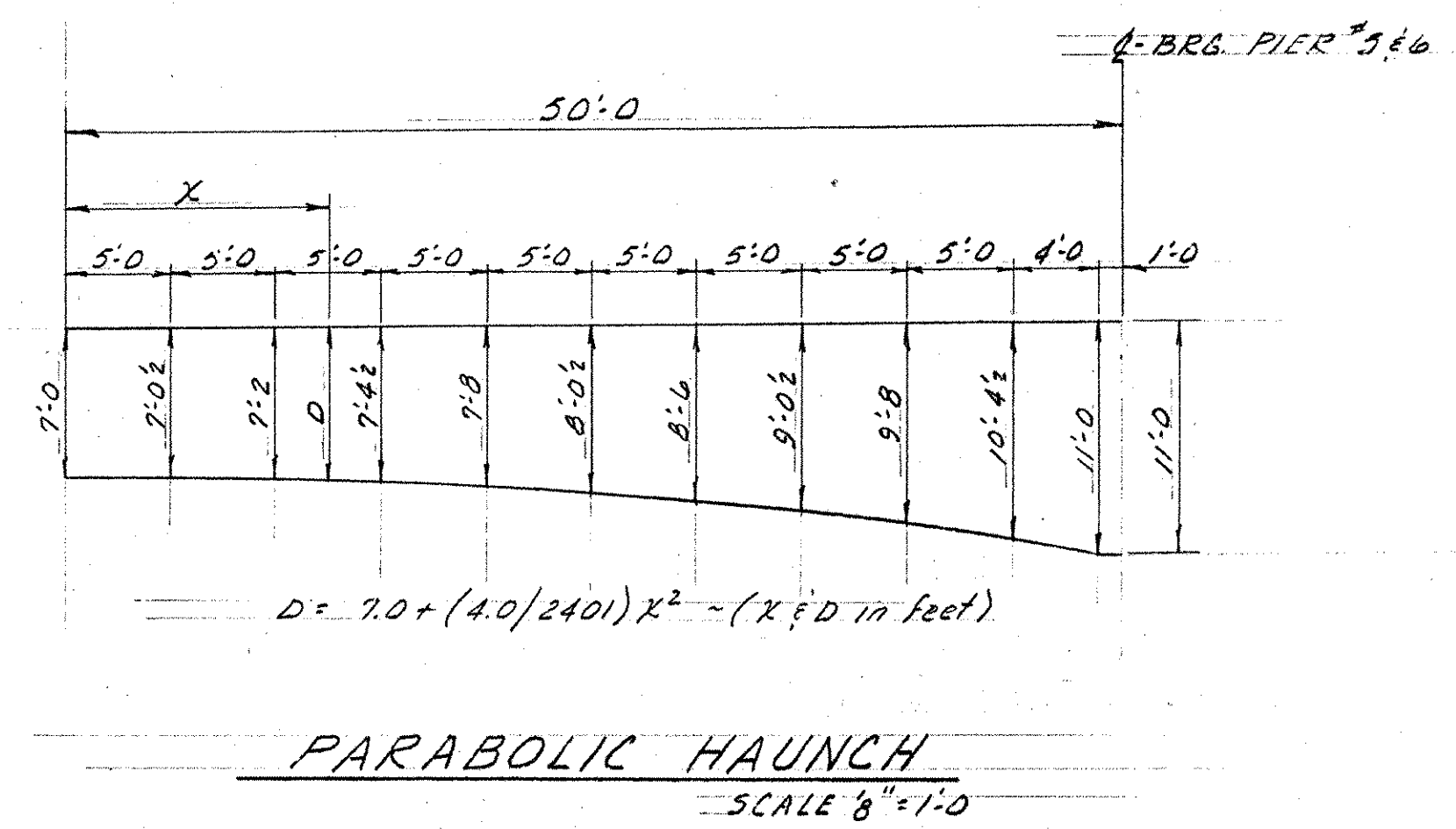

PARABOLIC HAUNCH

SCALE 8" = 1'-0"

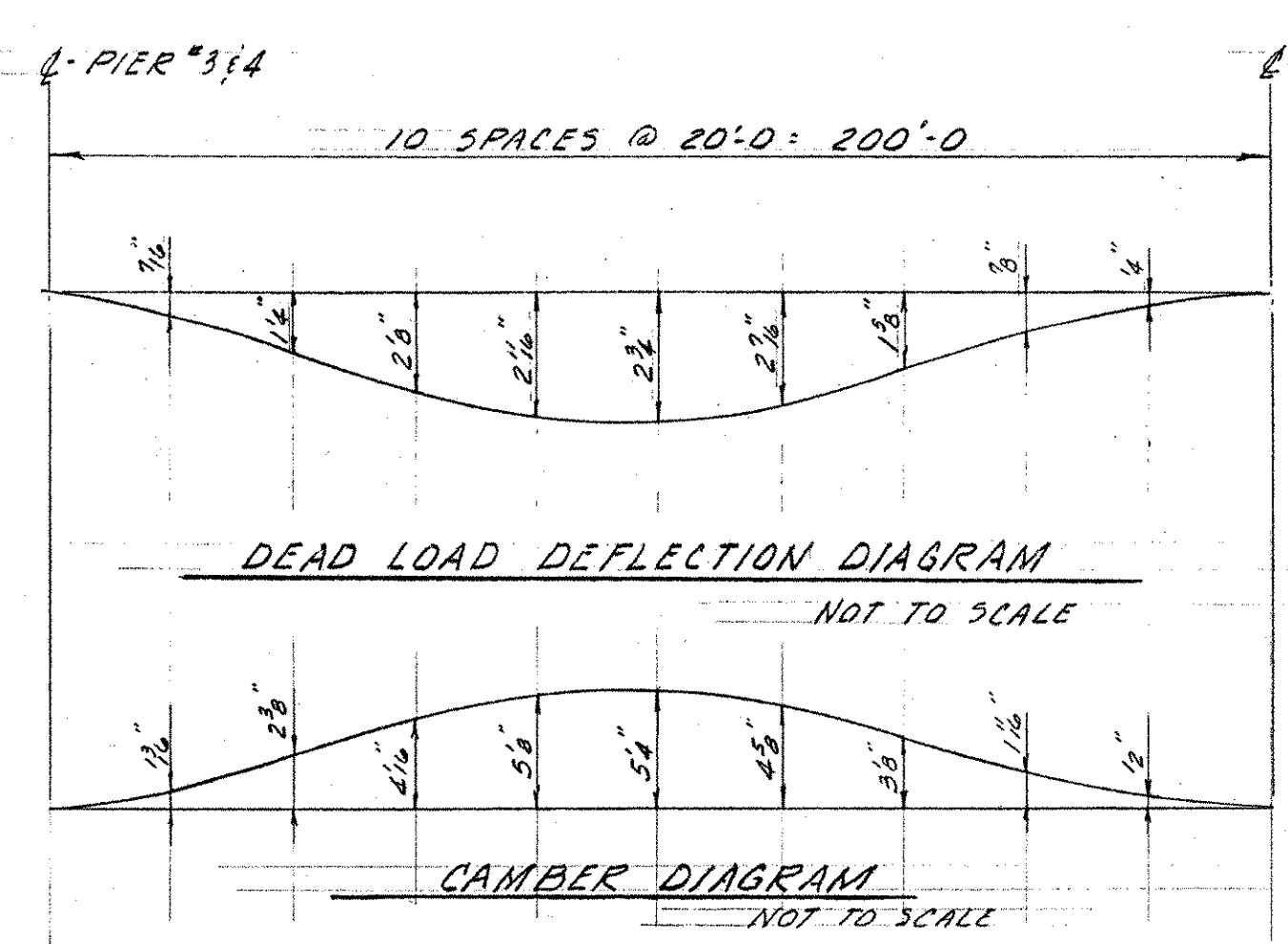

DEAD LOAD DEFLECTION DIAGRAM

NOT TO SCALE

CAMBER DIAGRAM

NOT TO SCALE

ITEM NO.	ITEM	UNIT	NET	TOTAL	FINAL
	CHAN. EXCAV. OF EARTH	C. Y.			
	CHAN. EXCAV. OF ROCK	C. Y.			
	UNCLASS. CHAN. EXCAV.	C. Y.			
	STRUCT. EXCAV.	C. Y.			
	CONC. CLASS AA (MOD.)	C. Y.			
	CONC. CLASS B (MOD.)	C. Y.			
	REINF. STEEL	LBS.			
	ASPHALTIC-ASB. COATING	S. Y.			
	TREATED TIMBER PILING	L. F.			
	SPLICES FOR STEEL PILING	EA.			
	STEEL PILING	L. F.			
	UNTREATED TIMBER PILING	L. F.			

IR 089-1(13)
This sheet for information only
BR 11 N & S

BR. 110 OF 128

STATE OF VERMONT
DEPARTMENT OF HIGHWAYS

TOWN OF HARTFORD
ROAD No. I-89 BRIDGE No.
I-89 OVER WHITE RIVER, VT. 4 AND C.V.R.R.
SPAN NO. 3 - FRAMING PLAN
SCALE As Shown
SURVEYED BY
DRAWN BY RLO CHECKED BY AGC
PROJECT No. I-89-1(6)
SHEET 18 OF 59 SHEET 60 OF 101