

1996 TRAFFIC DATA			
ADT		DHV	
I-89 NB	I-89 SB	I-89 NB	I-89 SB
6550	6440	990	775

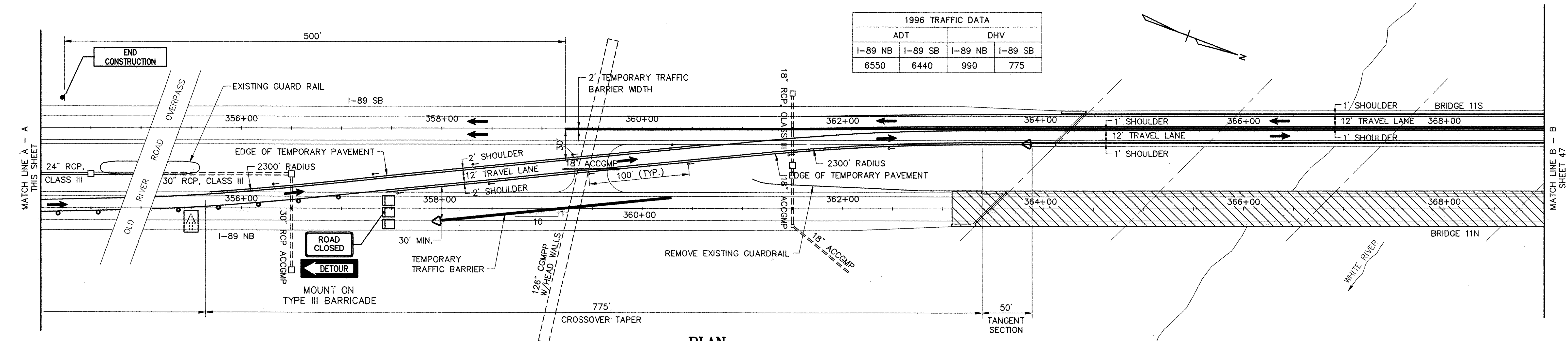

PLAN
SCALE: 1" = 50'

TRAFFIC CONTROL NOTES:

- TRAFFIC SHALL BE CONTROLLED AND MAINTAINED AT ALL TIMES AS SPECIFIED IN THE TRAFFIC CONTROL PLANS. A MINIMUM OF ONE LANE OF TRAFFIC IN EACH DIRECTION SHALL BE MAINTAINED AT ALL TIMES DURING CONSTRUCTION. BRIDGE 11N SHALL BE CLOSED AND REHABILITATED BEFORE BRIDGE 11S.
- TRAFFIC CONTROL MEASURES WILL NOT BE PERMITTED BETWEEN NOVEMBER 1 AND APRIL 15, UNLESS OTHERWISE APPROVED BY THE ENGINEER. IN ADDITION, ONCE TRAFFIC CONTROL DEVICES HAVE BEEN INSTALLED (PARTICULARLY CROSSOVERS), THE CONTRACTOR SHALL BEGIN ASSOCIATED CONSTRUCTION WORK IMMEDIATELY, AND PROCEED WITHOUT DELAYS THROUGH COMPLETION IN ORDER TO MINIMIZE INCONVENIENCE TO THE TRAVELING PUBLIC.
- ALL PRIVATE VEHICLES BELONGING TO THE CONTRACTOR'S WORK CREWS SHALL NOT BE PARKED ON THE INTERSTATE RIGHT-OF-WAY NOR ON THE TRAVELLED WAY OF ANY OTHER ROAD.
- SIGNS, BARRICADES, AND OTHER TRAFFIC CONTROL DEVICES SHALL BE CLEANED WEEKLY. ALSO ALL EXISTING SIGNS WHICH CONTRADICT TEMPORARY TRAFFIC CONTROL SIGNS MUST BE COVERED, OR REMOVED AND THEN REPLACED AFTER CONSTRUCTION COMPLETION. COST FOR THIS WORK SHALL BE INCLUDED IN THE BID PRICE FOR ITEM 641.10, "TRAFFIC CONTROL".
- PAYMENT FOR PORTABLE CHANGEABLE MESSAGE SIGNS SHALL BE UNDER ITEM 641.15, "PORTABLE CHANGEABLE MESSAGE SIGN" AND PAYMENT FOR FLASHING ARROW PANELS SHALL BE UNDER ITEM 641.16, "PORTABLE ARROW BOARD". PAYMENT FOR TRAFFIC CONTROL SIGNS, PLASTIC DRUMS, DELINEATORS, FLEXIBLE TUBULAR MARKERS AND TYPE III BARRICADES SHALL BE UNDER 641.10, "TRAFFIC CONTROL". PAYMENT SHALL INCLUDE ALL NECESSARY MAINTENANCE AND REPAIRS TO THESE TRAFFIC CONTROL DEVICES ON A DAILY BASIS. THE ENGINEER MAY ADD TRAFFIC CONTROL SIGNS AS NECESSARY. ADDITIONAL SIGNS, INCLUDING POSTS AND FOUNDATIONS, SHALL BE PAID FOR AS EXTRA WORK, IN ACCORDANCE WITH SECTION 109.06.
- TEMPORARY SPEED LIMIT THROUGH THE CONSTRUCTION ZONE SHALL BE 50 MPH.

- ENERGY ABSORPTION ATTENUATORS WILL BE REQUIRED AT LOCATIONS INDICATED IN THE TRAFFIC CONTROL PLANS AND AS ORDERED BY THE ENGINEER. ATTENUATORS SHOWN IN THE PLANS ARE SYMBOLIC ONLY AND DO NOT REPRESENT THE ACTUAL CONFIGURATION OF THE ATTENUATORS TO BE USED. THE ATTENUATORS SHALL MEET THE REQUIREMENTS OF THE LATEST VERSION OF THE AASHTO "GUIDE FOR SELECTING, LOCATING AND DESIGNING TRAFFIC BARRIERS" AND THE AASHTO "ROADSIDE DESIGN GUIDE". ATTENUATORS SHALL BE DESIGNED FOR 65 MPH AND A 4500 LB. VEHICLE. ATTENUATORS SHALL BE APPROVED BY THE ENGINEER AND PAID FOR UNDER ITEM 621.57. IF ATTENUATORS ARE DAMAGED BY AN ERRANT VEHICLE, COSTS TO THE CONTRACTOR FOR REPLACEMENT OF ANY PART OR ALL OF THE ATTENUATOR SHALL BE PAID AS "EXTRA WORK" PER SECTION 109.06. THE CONTRACTOR SHALL PROVIDE A SPARE FOR EACH TYPE OF ATTENUATOR USED ON THIS PROJECT, FOR THE PURPOSE OF IMMEDIATE REPLACEMENT OF DAMAGED ATTENUATORS. THE COST OF ON-SITE STORAGE OF EXTRA ATTENUATORS SHALL BE PAID AS SPECIFIED IN THE SPECIAL PROVISIONS.
- ANY REMOVAL AND REINSTALLATION OF GUARD RAIL, BRIDGE APPROACH RAIL OR BRIDGE RAIL WHICH IS REQUIRED TO COMPLETE WORK SHOWN IN THE TRAFFIC CONTROL PLANS SHALL BE SUBSIDIARY TO ITEM 641.10, "TRAFFIC CONTROL" UNLESS OTHERWISE NOTED.
- ALL PAVEMENT MARKINGS TO BE REMOVED AS SHOWN IN STANDARD SHEETS E-103, E-104, AND E-104A, SHALL BE REMOVED USING ITEM 646.82, "REMOVAL OF EXISTING PAVEMENT MARKINGS", EXCEPT FOR EXISTING YELLOW LINES ON THE APPROACHES BEYOND THE LIMITS OF NEW PAVEMENT WHICH SHALL BE COVERED WITH ITEM 646.86, "BLACK PAVEMENT MASKING TAPE". TEMPORARY PAVEMENT MARKINGS ON THE CROSSOVERS IN THE MEDIAN SHALL BE PAID AS ITEM 646.614, "TEMPORARY 6" WHITE LINE" AND ITEM 646.615, "TEMPORARY 6" YELLOW LINE". TEMPORARY PAVEMENT MARKINGS THROUGHOUT THE REST OF THE TRAFFIC CONTROL PACKAGE SHALL BE PAID AS ITEM 646.614, "TEMPORARY 6" WHITE LINE (TAPE, TYPE II)", AND ITEM 646.615, "TEMPORARY 6" YELLOW LINE (TAPE, TYPE II)". ALL PAVEMENT MARKINGS PERMANENTLY REMOVED SHALL BE REPLACED WITH ITEM 646.414, "DURABLE 6" WHITE LINE" AND ITEM 646.415, "DURABLE 6" YELLOW LINE".
- AT THE APPROACHES TO BOTH BRIDGES, PRIOR TO BEGINNING COLD PLANING OF THE ROADWAY SURFACE, THE CONTRACTOR SHALL INSTALL THE ADVANCED WARNING SIGN PACKAGE SHOWN IN STANDARD SHEET E-106. THE COST SHALL BE INCLUDED UNDER ITEM 641.10, "TRAFFIC CONTROL".

- THE CONTRACTOR SHALL PERFORM FIELD SURVEY SUFFICIENT TO DESIGN THE CROSSOVER PROFILES, SUPERELEVATION TRANSITIONS, AND DRAINAGE. CROSSOVER DESIGN COMPUTATIONS AND PLANS SHALL BE SUBMITTED BY THE CONTRACTOR TO THE RESIDENT ENGINEER FOR APPROVAL. FILL MATERIAL PLACED IN THE MEDIAN SHALL BE APPROVED BY THE RESIDENT ENGINEER AND SHALL NOT CONTAIN EXCESSIVE AMOUNTS OF MOISTURE, SILT OR ORGANIC SUBSTANCES. EXISTING EMBANKMENT SLOPES WHICH CROSSOVER FILL IS TO BE PLACED AGAINST SHALL BE BENCHES AS ORDERED BY THE RESIDENT ENGINEER. SUBBASE MATERIAL SHALL BE APPROVED BY THE RESIDENT ENGINEER AND SHALL BE PLACED WITH A MINIMUM 12" THICKNESS. PAVING OF CROSSOVER DETOURS SHALL BE PAID FOR AS "BITUMINOUS CONCRETE PAVEMENT, TYPE III", ITEM 406.25, AND SHALL BE PLACED IN A SINGLE COURSE, 2" THICK. THE COST OF ALL OTHER WORK REQUIRED FOR THE DESIGN, CONSTRUCTION, AND REMOVAL OF CROSS-OVERS SHALL BE INCLUDED UNDER ITEM 641.10, "TRAFFIC CONTROL".
- DURING BRIDGE DECK CONCRETE REMOVAL AND RECONSTRUCTION OPERATIONS, THE VT. 14 TRAFFIC LANES, THE WHITE RIVER, AND THE NEW ENGLAND CENTRAL RAILROAD UNDER THE BRIDGE SHALL BE PROTECTED BY ENCLOSING THE AREA BELOW THE DECK (WITHOUT REDUCING OVERHEAD CLEARANCE). THE CONTRACTOR SHALL SUBMIT DETAILS OF PROTECTIVE ENCLOSURES TO THE RESIDENT ENGINEER FOR APPROVAL. COSTS FOR PROVIDING PROTECTIVE ENCLOSURES SHALL BE INCLUDED UNDER ITEM 527.11, "TRAFFIC PROTECTION FOR BRIDGE PROJECT".

NOTES:

- DESIGN SPEED 65 MPH.
- LAYOUT BASED ON VAOT STANDARD E-104.
- THIS TRAFFIC CONTROL SHEET IS TO BE USED IN CONJUNCTION WITH VAOT STANDARD SHEETS E-103, E-104, E-104A, AND E-107A.
- SEE VAOT STANDARD SHEET E-103 FOR ADVANCE SIGN PACKAGE. SIGN PACKAGE LAYOUT EXTENDS BACK FROM THE BEGINNING OF THE 780' MERGING TAPER.
- EXISTING DRAINAGE STRUCTURES ARE SHOWN ONLY IN AREAS BETWEEN PROPOSED CROSSOVERS. ALL DRAINAGE SHOWN WAS OBTAINED FROM THE EXISTING ROADWAY DESIGN PLANS AND SHALL BE FIELD VERIFIED BY THE CONTRACTOR PRIOR TO DESIGNING THE CROSSOVER.



- KEY**
- CONSTRUCTION AREA
 - DIRECTION OF TRAFFIC FLOW
 - TEMPORARY TRAFFIC BARRIER
 - 1998 DESIGN HOUR TRAFFIC VOLUME
 - FLASHING ARROW PANEL
 - TYPE I DELINEATOR (YELLOW)
 - TYPE I DELINEATOR (WHITE)
 - REFLECTORIZED DRUM
 - TYPE III BARRICADE
 - ENERGY ABSORPTION ATTENUATOR

VANASSE HANGEN BRUSTLIN, INC. Bridge Sheet No. 46 Sheet 46 of 101

STATE OF VERMONT AGENCY OF TRANSPORTATION	
Town Of HARTFORD	Bridge No. 11N & 11S
Highway No. I-89 NB & SB	Log Sta. Surv. Sta.
I-89 NB & SB OVER WHITE RIVER, VT 14 & NECR	
TRAFFIC CONTROL-BR. 11N CLOSED (1 OF 2)	
Designed By J.A. ROUILLARD	Drawn By R.F. CLARK
Checked By T.S. BRYANT Date 9/98	Bridge Design Supervisor C.D. BAKER Date 9/98
PROJECT HARTFORD	PROJECT NO. IR 089-1(13)
VHB Cad Filename 50699TGP	
Bridge Sheet No. 46	Sheet 46 of 101