

CONSTRUCT NEW SIDEWALK RAMPS AS PER STANDARD C-3.

TO BE PAID UNDER:  
 SOLID ROCK EXCAVATION, 203.16  
 PORTLAND CEMENT CONCRETE SIDEWALK - 5'', 618.10  
 REMOVING AND RESETTING CURB, 616.40

NOTE: SOUTHBOUND REST AREA IS TO BE REPAVED UNDER A SEPARATE PROJECT AFTER CONSTRUCTION OF SPRINGFIELD - HARTFORD IR 091-1(20). SIDEWALK RAMPS SHOULD THEREFORE BE CONSTRUCTED WITH A 1 1/2'' RISE BETWEEN TOP OF EXISTING PAVEMENT AND TOP OF NEW RAMP SUCH THAT TRANSITION WILL BE FLUSH WHEN REST AREA IS REPAVED. IN THE MEANTIME A SMALL FILLET MADE OF BITUMINOUS CONCRETE PAVEMENT SHALL BE USED TO RENDER THE RAMP ACCESSIBLE TO WHEELCHAIRS, AS SHOWN ON DETAIL 'A' OF THIS SHEET.

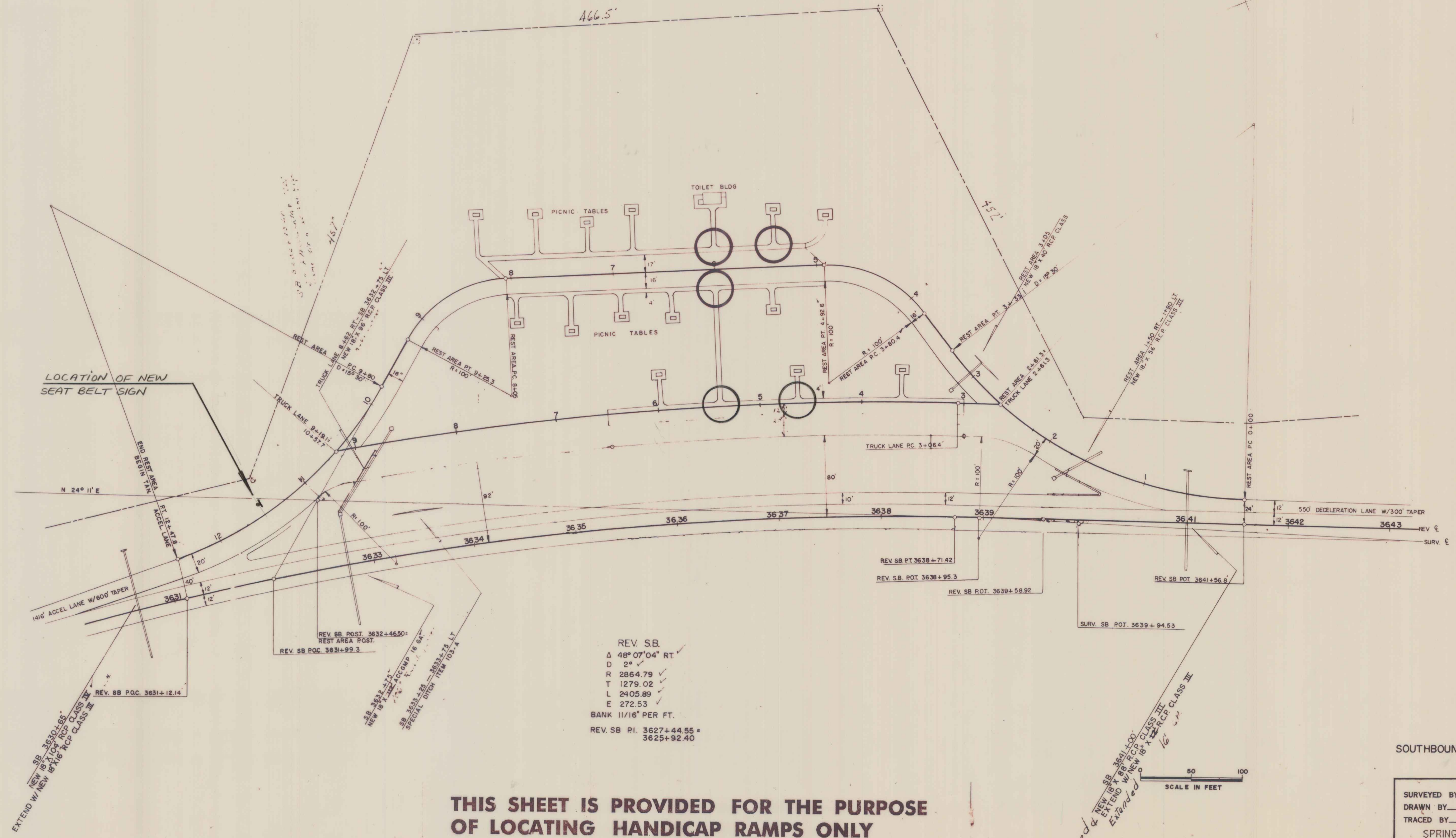

REV. SB  
 Δ 48° 07' 04" RT.  
 D 2' ✓  
 R 2864.79 ✓  
 T 1279.02 ✓  
 L 2405.89 ✓  
 E 272.53 ✓  
 BANK 11/16" PER FT.  
 REV. SB PI. 3627+44.55 =  
 3625+92.40

**THIS SHEET IS PROVIDED FOR THE PURPOSE OF LOCATING HANDICAP RAMPS ONLY**

SOUTHBOUND REST AREA

SURVEYED BY \_\_\_\_\_ DATE \_\_\_\_\_  
 DRAWN BY R. HAY DATE 12/65  
 TRACED BY A. J. A. DATE 12/65  
 SPRINGFIELD-HARTFORD  
 IR 091-1(20)  
 SHEET 127 OF 133

SCALE IN FEET  
 0 50 100

Relayed & Extended  
 NEW SB 3641+100'  
 EXTEND W/ NEW 8' X 16' RCP CLASS III  
 NEW SB 3641+100'  
 EXTEND W/ NEW 8' X 16' RCP CLASS III