

CONSTRUCTION APPROACH SIGNING

I-91 HARTFORD INTERCHANGE*

MAINLINE*

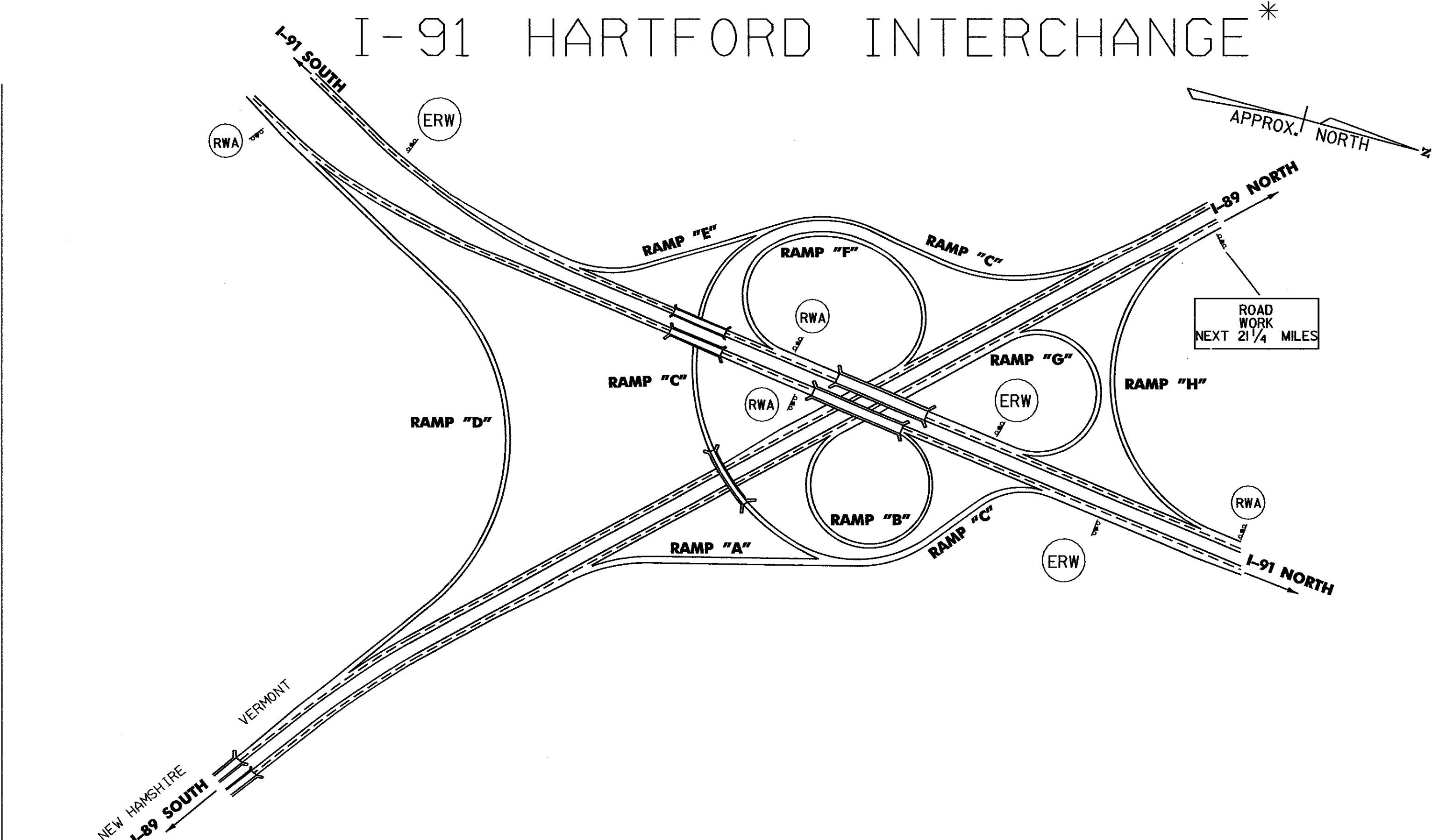
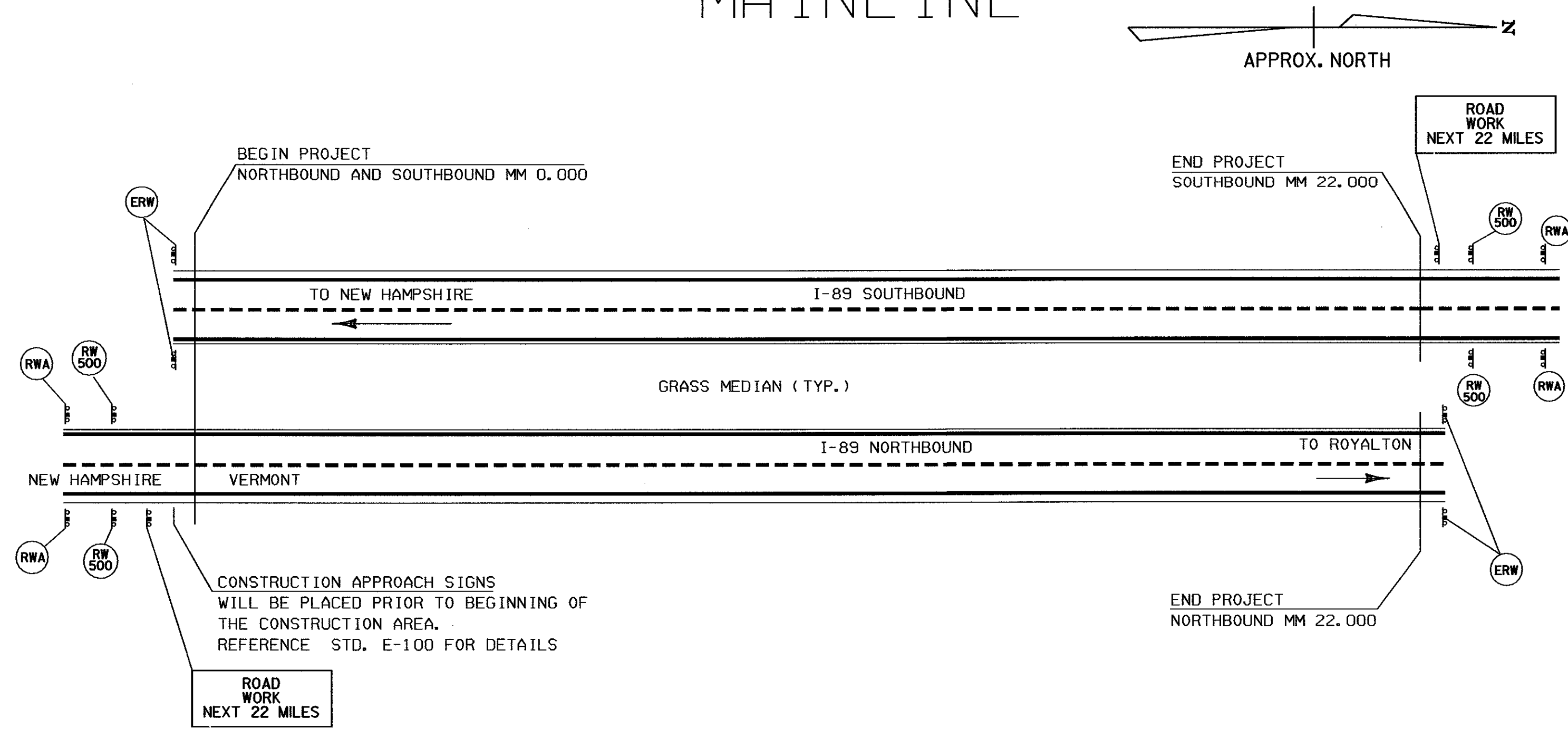

I-89 QUECHEE INTERCHANGE*

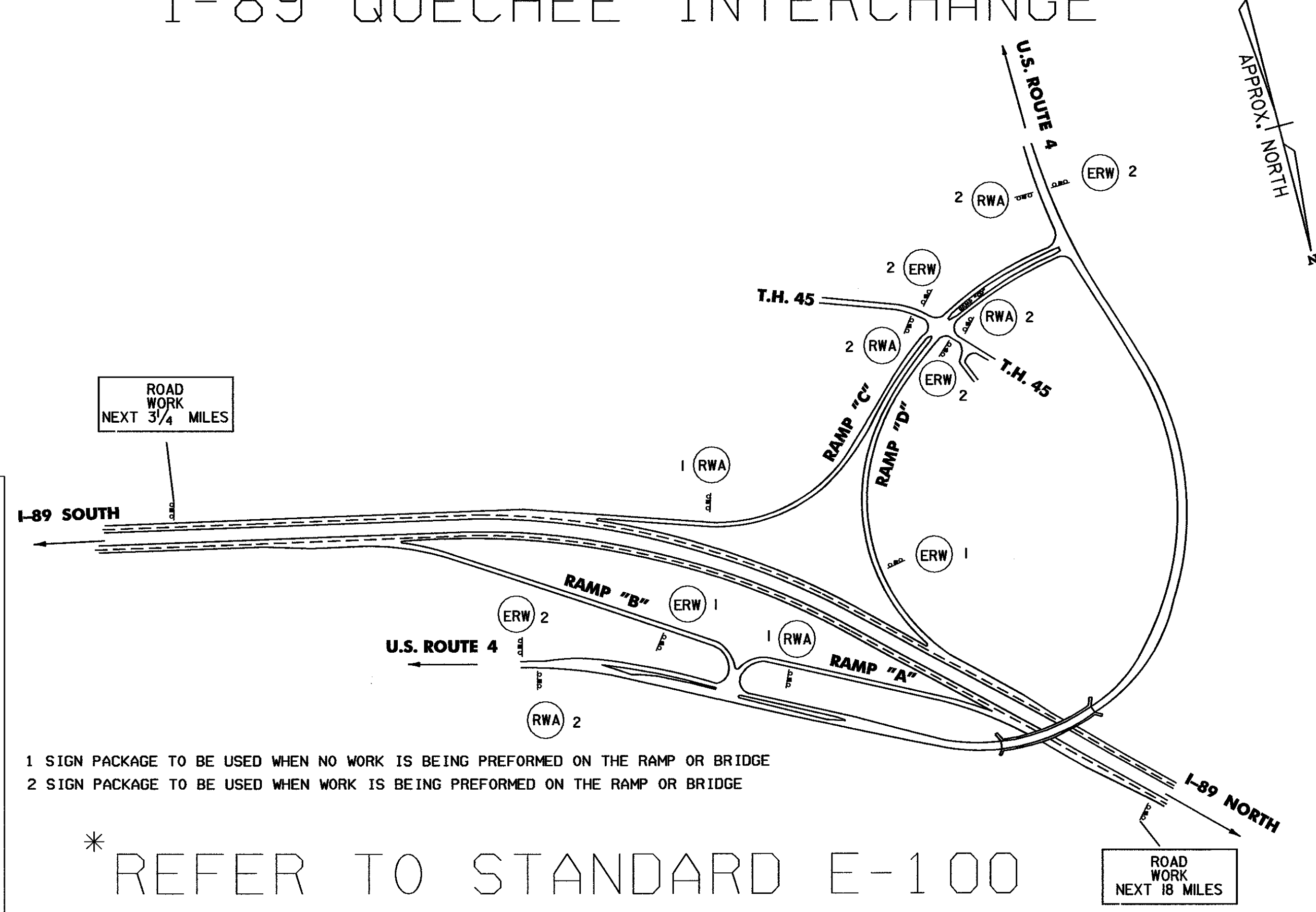

I-89 SHARON INTERCHANGE*

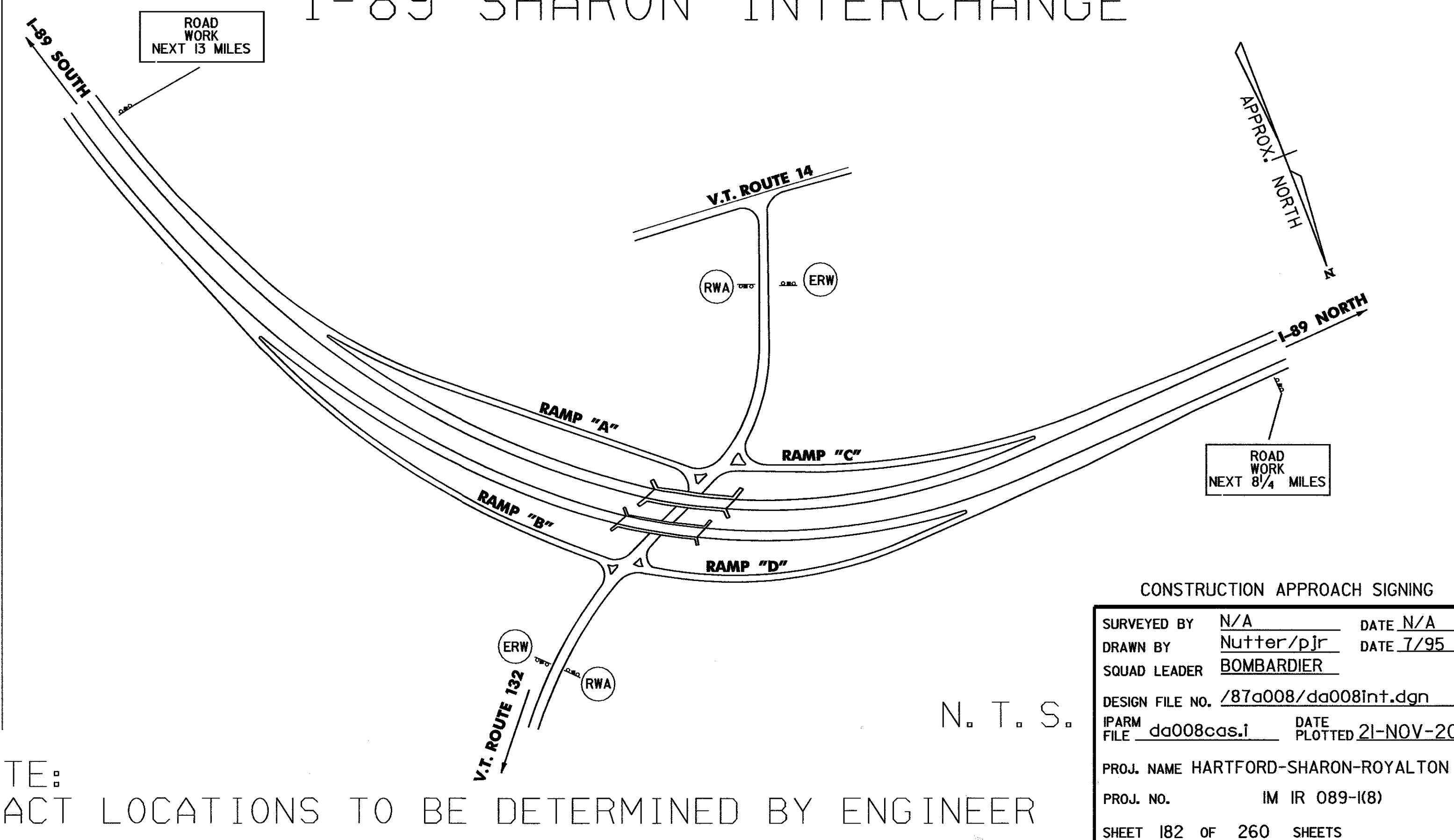

LEGEND

- RWA = ROAD WORK AHEAD
- ERW = END ROAD WORK
- RWN = ROAD WORK NEXT X MILES
- RW 500 = ROAD WORK 500 FT

1 SIGN PACKAGE TO BE USED WHEN NO WORK IS BEING PERFORMED ON THE RAMP OR BRIDGE
 2 SIGN PACKAGE TO BE USED WHEN WORK IS BEING PERFORMED ON THE RAMP OR BRIDGE

* REFER TO STANDARD E-100

NOTE: EXACT LOCATIONS TO BE DETERMINED BY ENGINEER

N. T. S.

CONSTRUCTION APPROACH SIGNING	
SURVEYED BY	N/A DATE N/A
DRAWN BY	Nutter/pjr DATE 7/95
SQUAD LEADER	BOMBARDIER
DESIGN FILE NO.	/87a008/da008int.dgn
IPARM FILE	da008cas.1 DATE PLOTTED 21-NOV-2000
PROJ. NAME	HARTFORD-SHARON-ROYALTON
PROJ. NO.	IM IR 089-1(8)
SHEET 182 OF 260 SHEETS	