

\* This dimension on interior beams varies according to the skew. See Detail "B" of SCB-D 7-65

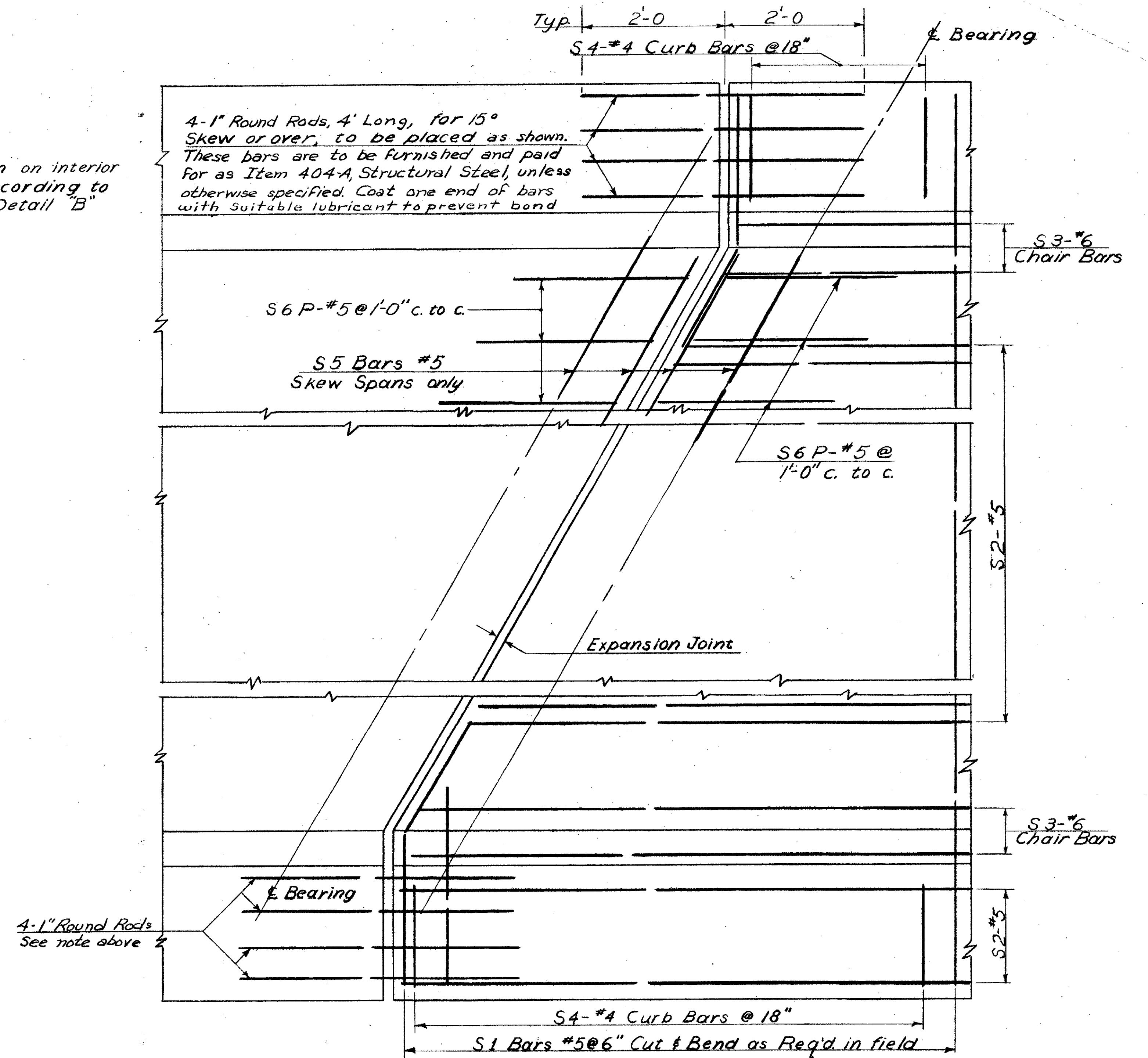

PLAN AT PIER

REINFORCEMENT LAYOUT AT PIER

REVISIONS & CORRECTIONS

Drawn By: *WT* 12/1/62 Revised-WT-1/25/65  
 Traced By: *WT* 12/1/62 Revised-WT-1/25/65  
 Checked By: *EFP WMS, RSH* 12/1/62 Rev. 1/25/65 WMS  
 Recommended *W.D. Bism* 2/4/65  
 For Approval *Bridge Engineer* Date  
 Recommended *W.D. Bism* 2/4/65  
 For Approval *Assist. Chief Engineer* Date  
 Approved By *A.S. Burt* 2/4/65  
*Chief Engineer* Date

DETAILS OF W BEAM BRIDGES  
 PLAN & REINFORCEMENT LAYOUT AT PIER

THIS SHEET IS FOR INFORMATION PURPOSES ONLY  
 HARTFORD-SHARON-ROYALTON IM 1R 089-1(8)

VERMONT  
 DEPARTMENT OF HIGHWAYS  
 STRUCTURE STANDARDS  
**SCB-D5-65**

Bridge Sheet No. ~~22~~ 167 Sheet 124 of 260