

FRAMING PLAN - SOUTHBOUND  
Scale: 1" = 10.000'

NOTES  
1. FOR FRAMING NOTES SEE SH. # BR-310.

| STRINGER SCHEDULE<br>SOUTHBOUND ROADWAY |          |                          |                           |                               |                          |            |
|---|----------|--------------------------|---------------------------|-------------------------------|--------------------------|------------|
|   | BEAM NO. | SKEW * ANGLE 00°-00'-00" | SPAN OF BEAMS OF BRGS FT. | LENGTH OF BEAMS OUT-OUT** FT. | DEAD LOAD DEFLECTION IN. | CAMBER IN. |
| SPAN NO. 1                              | B1       | 40-45-54.69              | 46.176                    | 47.02                         | 7/16                     | 1 1/8      |
|   | B2       | 41-01-14.40              | 46.352                    | 48.10                         | 1/2                      |            |
|   | B3       |                          |                           |                               |                          |            |
|   | B4       |                          |                           |                               |                          |            |
|   | B5       | 41-16-48.18              | 46.536                    | 48.37                         | 7/16                     |            |
| SPAN NO. 3                              | B11      | 41-57-15.10              | 70.997                    | 73.12                         | 1 5/8                    | 2 3/4      |
|   | B12      | 42-13-14.88              | 71.296                    | 73.09                         | 1 1/16                   |            |
|   | B13      |                          |                           |                               |                          |            |
|   | B14      |                          |                           |                               |                          |            |
|   | B15      | 42-29-28.80              | 71.603                    | 73.82                         | 1 9/16                   |            |
| SPAN NO. 5                              | B21      | 43-18-05.12              | 60.956                    | 63.20                         | 1 1/8                    | 2          |
|   | B22      | 43-34-54.48              | 61.240                    | 63.07                         | 1 1/4                    | 2 1/8      |
|   | B23      |                          |                           |                               |                          |            |
|   | B24      |                          |                           |                               |                          |            |
|   | B25      | 43-51-56.04              | 61.529                    | 63.79                         | 1 1/8                    | 2          |
| SPAN NO. 7                              | B31      | 44-32-17.55              | 60.856                    | 62.76                         | 1 1/8                    | 2          |
|   | B32      | 44-49-48.82              | 61.164                    | 63.04                         | 1 1/4                    | 2 1/8      |
|   | B33      |                          |                           |                               |                          |            |
|   | B34      |                          |                           |                               |                          |            |
|   | B35      | 45-07-35.85              | 61.481                    | 63.40                         | 1 1/8                    | 2          |

| STATIONS, OFFSETS & FIN GRADE AT COMPUTED POINTS SOUTHBOUND ROADWAY |              |                                 |                          |
|---|--------------|---------------------------------|--------------------------|
| POINT NO.   | STATION      | OFFSET FROM MAIN C. FT. - RIGHT | FIN. GRADE ELEVATION FT. |
| 13  | 780 + 62.000 | 40.000                          | 530.74                   |
| 14  | 780 + 63.297 | 40.000                          | 530.73                   |
| 20  | 781 + 10.320 | 40.000                          | 530.26                   |
| 21  | 781 + 09.012 | 39.989                          | 530.26                   |
| 22  | 781 + 11.651 | 39.983                          | 530.23                   |
| 37  | 781 + 83.300 | 40.000                          | 529.53                   |
| 38  | 781 + 81.968 | 39.983                          | 529.53                   |
| 39  | 781 + 84.661 | 39.986                          | 529.50                   |
| 54  | 782 + 46.420 | 40.000                          | 528.90                   |
| 55  | 782 + 45.058 | 39.985                          | 528.90                   |
| 56  | 782 + 47.810 | 39.985                          | 528.87                   |
| 75  | 783 + 08.133 | 40.000                          | 528.28                   |
| 76  | 783 + 09.540 | 40.000                          | 528.26                   |

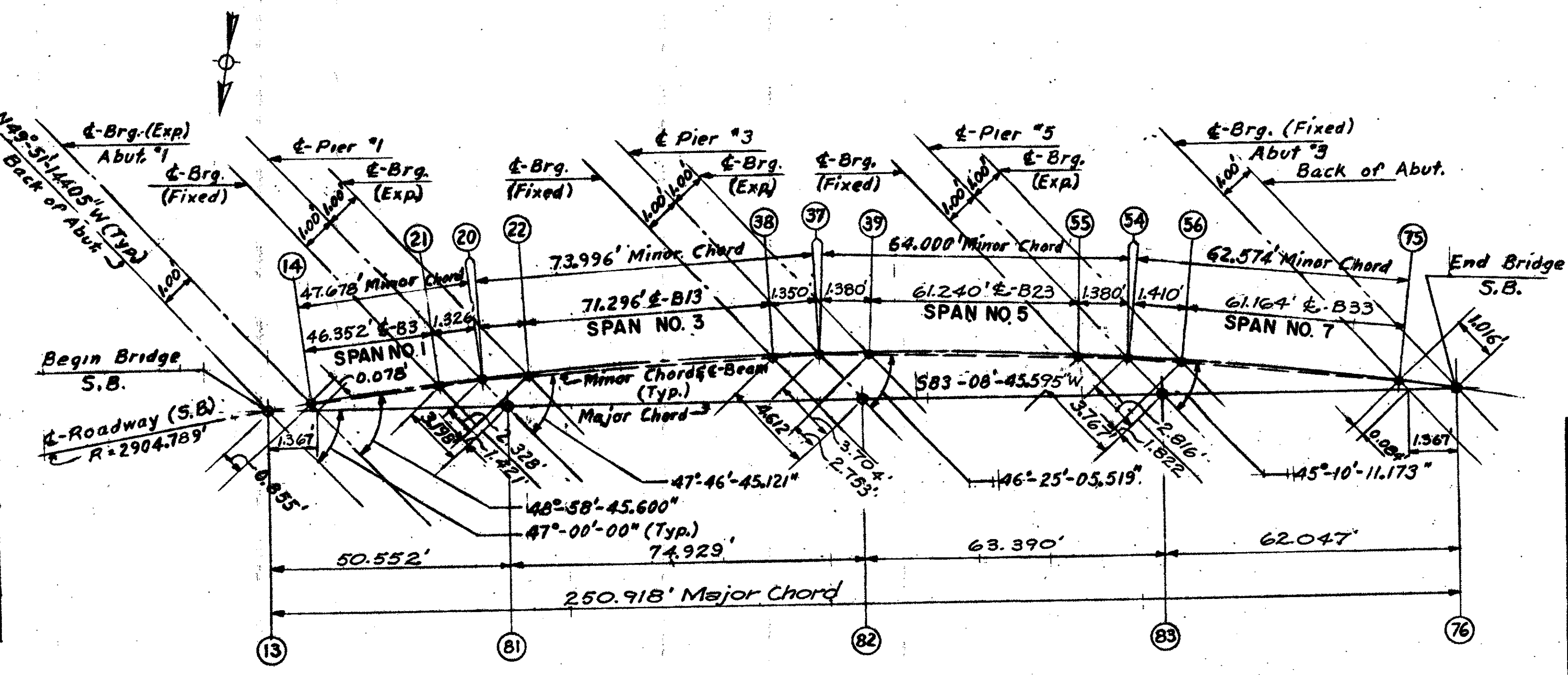

CURVE & CHORD LAYOUT - S.B. ROADWAY  
No Scale

THIS SHEET IS FOR INFORMATION PURPOSES ONLY  
HARTFORD-SHARON-ROYALTON 1M 1R 089-1(2)

STATE OF VERMONT  
DEPARTMENT OF HIGHWAYS

PROJECT SHARON - ROYALTON  
TOWN OF SHARON

ROUTE NO. 1-89 STA. 781 + 91.00

1-89 OVER SA 3 & C.V.R.R.

FRAMING PLAN SOUTHBOUND & TYPICAL SECTION

SCALE AS SHOWN

IN CHARGE ARNOLD KATZ

NOTES:  
\* Skew-Z is Computed Angle Between E-Bearing @ Abutment & Pier With a Line Normal to E of Beam.  
\*\* Out to Out Length of Beams to Be Verified By Steel Fabricator.