

Superstructure Plan - Spans #3 & #4
Scale: 1/8" = 1'-0"

See Br. 204 For Details of Spans #1 & #2

Notes

1. For Beam sizes and Cover Plate sizes and lengths see Standard Sheet SCB-30-65 & SCB-D7-65, Detail "C".
2. For additional details of diaphragms see Standard Sheet SCB-D7-65, Details "A", "D", "E".
3. For Typical Section of Superstructure see Br. 202
4. For additional Superstructure details see Standard Sheets SCB-D1-65 thru SCB-D9-65.
5. No Scuppers are to be used on this bridge.
6. For General Notes see Br. 200

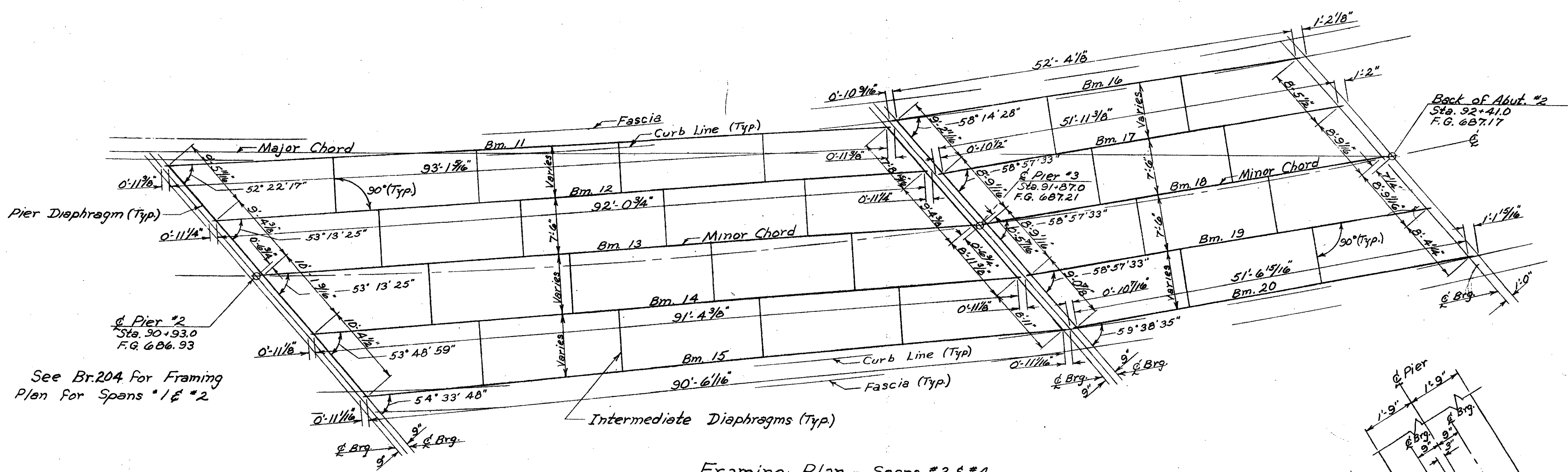

Framing Plan - Spans #3 & #4
Scale: 1/8" = 1'-0"

See Br. 204 For Framing Plan for Spans #1 & #2

BR #8

THIS SHEET IS FOR INFORMATION PURPOSES ONLY
HARTFORD-SHARON-ROYALTON IM. IR. 089-1(8)

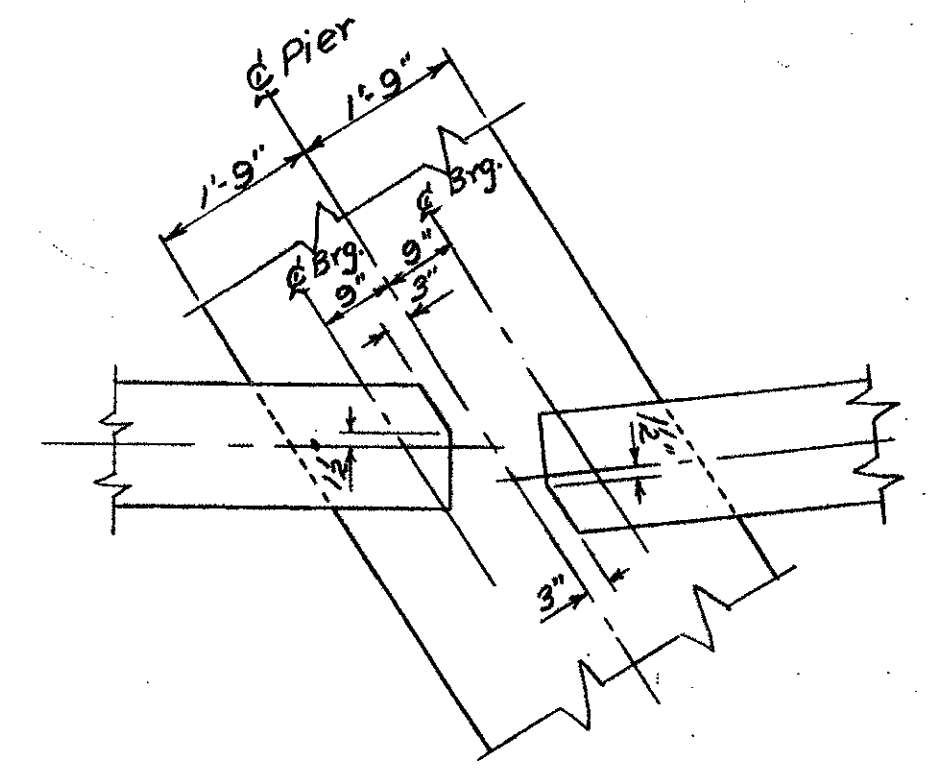

Details of WF Cut-offs @ Piers
Scale: 1/2" = 1'-0"
(Note: Cut top Flange only)

Br. 205 of 214

STATE OF VERMONT DEPARTMENT OF HIGHWAYS
TOWN OF Hartford
ROUTE No. U.S. #4
U.S. #4 over I 89
Superstructure - Spans #3 & #4 SCALE As noted