

Date Jan 18 1985 JAN 18 1985

INDEX OF SHEETS

1. TITLE SHEET
2. QUANTITIES AND GENERAL NOTES
3. REFERENCE SHEET - PLAN AND PROFILE
4. FRAMING PLAN
- 5-6. TYPICAL SECTIONS
- 7-10. REFERENCE SHEETS - EXISTING GIRDER DETAILS
- 11-13. INSPECTION WALKWAY DETAILS
14. INSPECTION WALKWAY CONNECTION DETAILS
15. INSPECTION WALKWAY FLOOR DETAILS
16. KNEE BRACING DETAILS FROM F.S. # 11-11 AND # 55-60
17. KNEE BRACING DETAILS FROM F.S. # 11-20 AND # 46-55
18. KNEE BRACING DETAILS FROM F.S. # 20-48
19. FIXED HINGE RETAINER DETAIL
20. EXPANSION HINGE RETAINER DETAILS
21. EXPANSION HINGE DRAINAGE DETAILS
22. FABRIC DRAINAGE THROUGH DETAILS AT EXPANSION JOINT
- 23-24. FIXED HINGE JOINT DETAILS
- 25-26. DEFLECTION JOINT DETAILS
27. MAIN LINE TRAFFIC CONTROL PLAN - ONE LANE CLOSED
28. MAIN LINE TRAFFIC CONTROL - DIVIDED HIGHWAY, ONE ROADWAY CLOSED
29. MAIN LINE TRAFFIC CONTROL PLAN - SUMMARY SHEET TRAFFIC SIGN
30. TRAFFIC CONTROL SIGN SUMMARY SHEET FOR RAMP

Blow & Cote Inc.  
Contractor  
Thomas J. Cote  
Signature  
V. J. Barone  
Title  
Transportation Secretary's Signature

STATE OF VERMONT  
AGENCY OF TRANSPORTATION

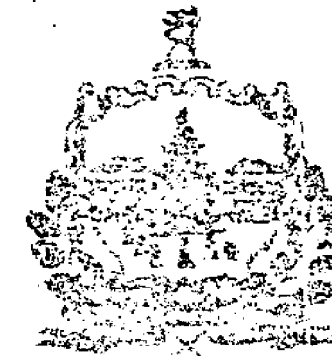

PROPOSED IMPROVEMENT  
BRIDGE PROJECT

TOWN OF HARTFORD  
COUNTY OF WINDSOR

ROUTE NO: I91 BRIDGE NO: 44N E S

PROJECT LOCATION: BEGINNING AT A POINT APPROXIMATELY 0.60 MILES NORTH OF THE WHITE RIVER, U.S. Rt. 4, INTERCHANGE AND EXTENDING NORTHERLY 0.23 MILES.

PROJECT DESCRIPTION: REHABILITATION OF THE EXISTING BRIDGES. SEE GENERAL NOTE #1 ON SH. P.

LENGTH OF STRUCTURE: 1178' NB + 1178' SB = 2,376 FEET  
LENGTH OF PARTICIPATION ROADWAY: FEET  
LENGTH OF NON-PARTICIPATION ROADWAY: FEET  
LENGTH OF PROJECT: 2,376 FEET

CONTRACT PLANS  
THESE PLANS DO NOT REFLECT  
CHANGES MADE ON THE PROJECT.

REFERENCE STANDARDS

STD. DWG. E-2	ROAD CONSTRUCTION APPROACH SIGNS	3/4/81 R
STD. DWG. E-6	ON-PROJECT CONSTRUCTION SIGNS	4/1/80 R
STD. DWG. E-7	DELIMITATION, BARRICADES AND DETOURS FOR CONSTRUCTION AREAS	2/2/83
STD. DWG. E-7A	BREAKAWAY BARRICADE DETAILS	4/8/82 R
STD. DWG. E-8	TYPICAL MAJOR MAINTENANCE OPERATION REGULATORY SIGNS	5/15/83 R
STD. DWG. E-13A	REGULATORY SIGNS	7/15/84
STD. DWG. E-13B	REGULATORY SIGNS	7/18/84
STD. DWG. E-13C	REGULATORY SIGNS	7/18/84
STD. DWG. E-13D	WARNING SIGNS	7/17/77 R
STD. DWG. E-13E	ALPHA BRIDGE RAILING DETAILS	7/17/77 R
STD. DWG. SB-04-76	DETAILS OF W BEAM BRIDGES	1/8/76
STD. DWG. SB-06-79	DETAILS OF W BEAM BRIDGES	1/3/79 R
STD. DWG. SB-07-71	DETAILS OF W BEAM BRIDGES	12/15/76 R

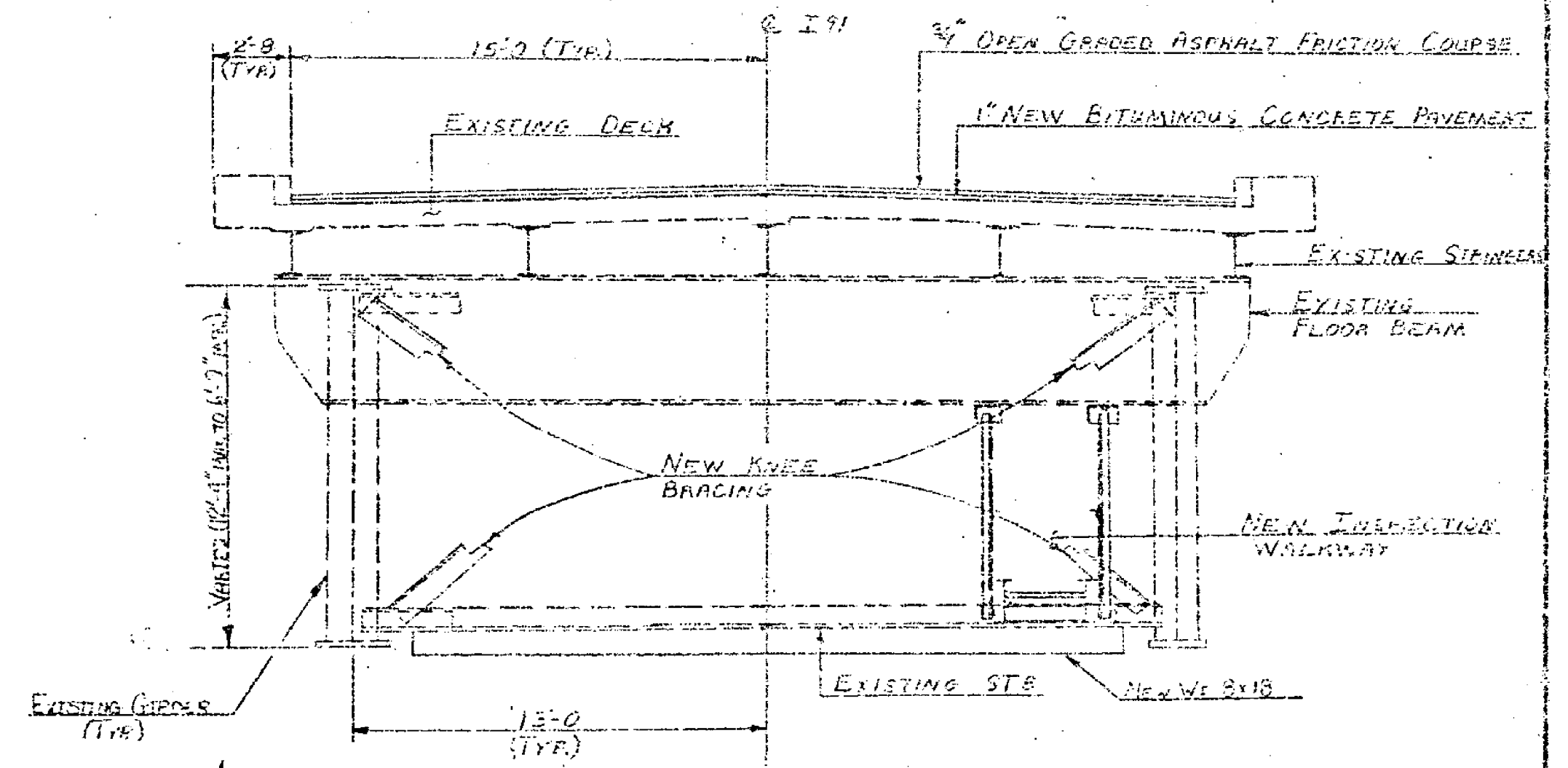
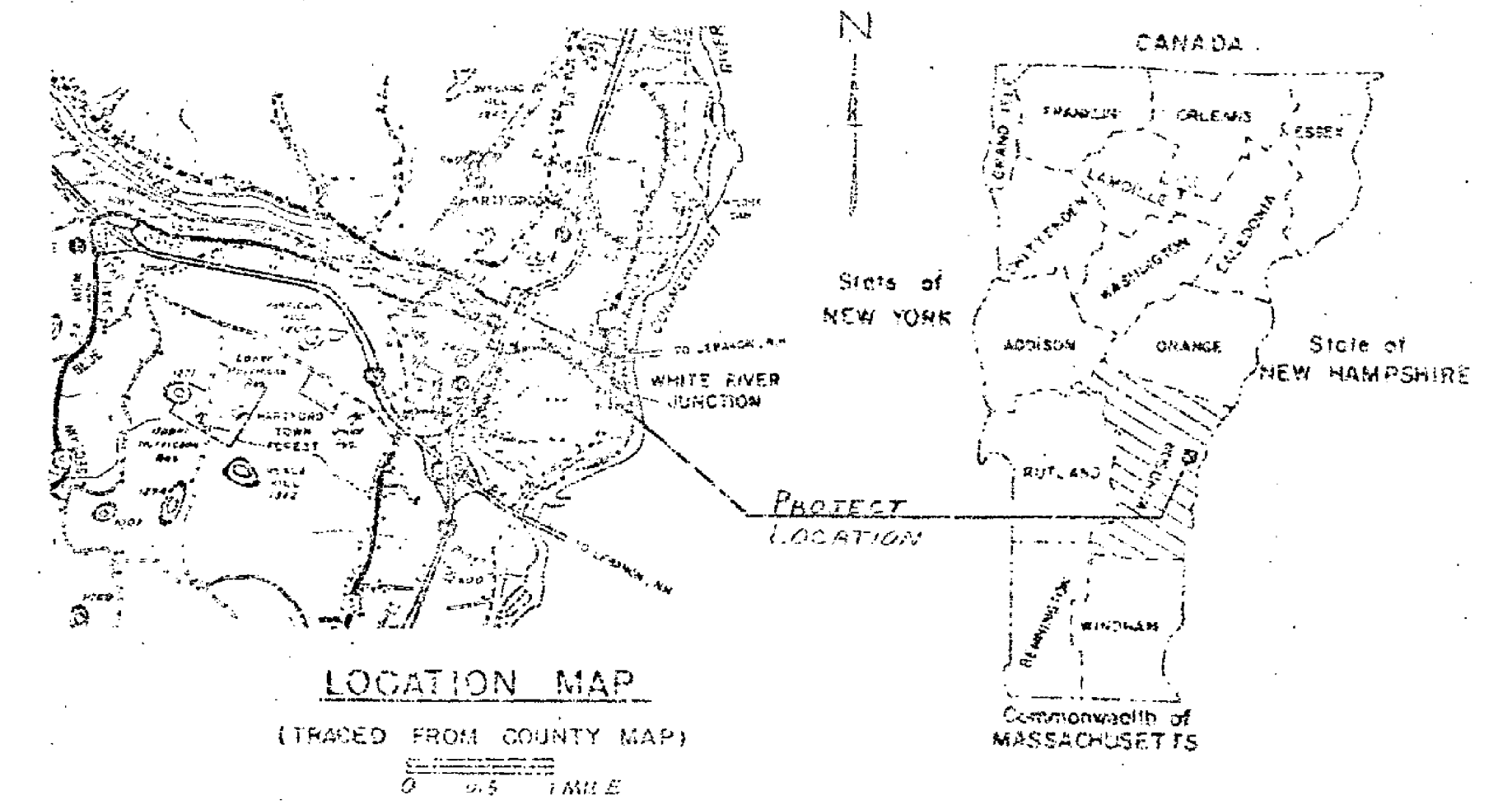

TRAFFIC DATA

1985 ADT 9600  
1985 DHV 1225  
D = 52'<sup>2</sup>  
T = 7' (ADT)  
T = 5' (DHV)

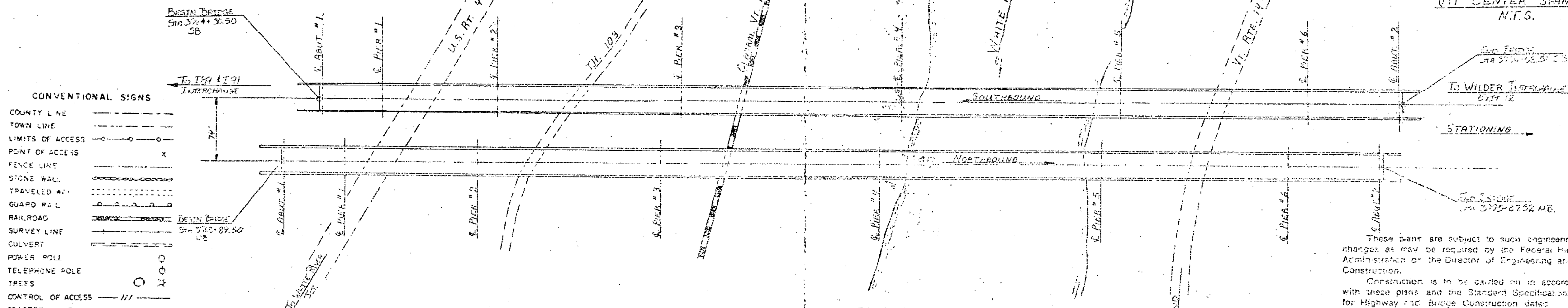

CONVENTIONAL SIGNS

COUNTY LINE	---
TOWN LINE	----
LIMITS OF ACCESS	○
POINT OF ACCESS	X
FENCE LINE	—X—X—X—
STONE WALL	—X—X—X—
TRAVELED A/R	=====
GUARD RAIL	=====
RAILROAD	=====
SURVEY LINE	-----
CULVERT	-----
POWER POLE	○
TELEPHONE POLE	○
TREES	○
CONTROL OF ACCESS	///
PROPERTY LINE	---
POW TAKING LINE	SR
SLOPE RIGHTS	○
TOP OF CUT	○
TOE OF SLOPE	○

DATUM

VERTICAL	N/A
HORIZONTAL	N/A

These plans are subject to such engineering changes as may be required by the Federal Highway Administration or the Director of Engineering and Construction.  
Construction is to be carried on in accordance with these plans and the Standard Specifications for Highway and Bridge Construction dated March, 1976, as approved by the Federal Highway Administration on October 27, 1976 for use on this project, including all subsequent revisions and such revised specifications and special provisions as are incorporated in these plans.

APPROVED BY ORDER OF THE STATE TRANSPORTATION BOARD	
APPROVED: <u>S. J. O'Neil</u> DIRECTOR OF ENGINEERING AND CONSTRUCTION	
PROJECT: HARTFORD	PROJECT NO: JR-91-2(1)
SHEET OF 30 SHEETS	