

INDEX OF SHEETS

1. TITLE SHEET
2. QUANTITY SHEET
3. LAYOUT SHEET
4. TYPICAL & PROFILE SHEET
5. MAINLINE TRAFFIC CONTROL SHEET
6. PAVING W/Traffic SIGN SUMMARY SHEET
7. CONSTRUCTION VEHICLE TRAFFIC CONTROL TYPICAL SHEET
8. SIGN SUMMARY PAVING TRUCK TURNING SHEET STANDARDS
9. E-2 ROAD CONSTRUCTION APPROXIMATE SIGNS 03/04/81 R
10. E-6 ON PROJECT CONSTRUCTION SIGNS 01/01/80 R
11. E-7 DELINEATION AND BARRICADES FOR CONSTRUCTION AREAS 02/02/83 R
12. E-7A TYP. TTT BARRICADE - HIGHWAY 04/08/82 R
13. E-8 TYPICAL MAJOR MAINTENANCE OPERATION 11/23/81 R
14. E-16 REGULATORY SIGNS - EXPRESSWAY 01/04/75 R
15. E-20 MARKING SIGNS 05/18/78 R
16. BLANK
- 17-19. ROADWAY CROSS SECTIONS

CONTRACTOR - FRANK W. WILCOX CONSTRUCTION CORP. P.O. BOX 429 BELLOW FALLS, VT. CONTRACT DATED - 5-25-83  
 CONSTRUCTION BEGAN - 6-20-83 CONSTRUCTION COMPLETED - 7-6-83 ACCEPTED - 7-12-83

RESIDENT ENGINEER - ALFRED G. DEVAUX RECORD PLANS - GEORGE J. LABAIR

ENHANCED ASPHALT-BITUMINOUS CO., INC. DOCCAWENTON, VT.

BITUMINOUS CONCRETE PAVEMENT - PIKE INDUSTRIES INC. WEST LEBANON, NH.

OPEN GRADED ASPHALT FRICTION COURSE - PIKE INDUSTRIES WEST LEBANON, NH.

# STATE OF VERMONT AGENCY OF TRANSPORTATION



## PROPOSED IMPROVEMENT TOWN OF THETFORD COUNTY OF ORANGE INTERSTATE 91

PROJECT LOCATION: PROJECT BEGINS ON INTERSTATE 91 NORTHBOUND LANE APPROXIMATELY 1.639 MILES NORTH OF THE NORWICH-THETFORD TOWN LINE AND CONTINUES NORTHERLY FOR .047 MILES.

PROJECT DESCRIPTION: RESTORING MINIMUM CLEARANCE TO BRIDGE 52 N, THETFORD-TOWN HIGHWAY 58, BY LOWERING THE SOUTHBOUND LANE OF INTERSTATE 91.

**NORTHBOUND TRAFFIC DATA**

1983 ADT 2770  
 DDHV 470  
 2003 ADT 4690  
 DDHV 740

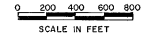
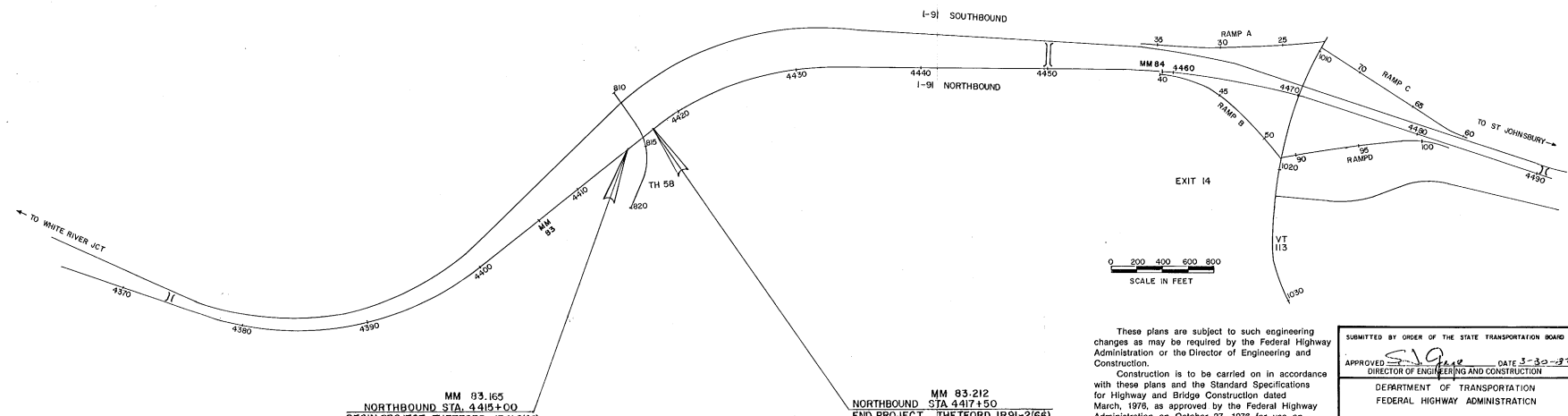
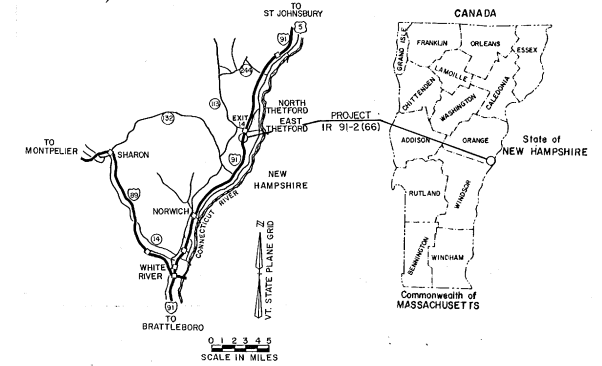

**CONVENTIONAL SIGNS**

- COUNTY LINE
- TOWN LINE
- LIMITS OF ACCESS
- POINT OF ACCESS
- FENCE LINE
- STONE WALL
- TRAVELED WAY
- GUARD RAIL
- RAILROAD
- SURVEY LINE
- CULVERT
- POWER POLE
- TELEPHONE POLE
- TREES
- CONTROL OF ACCESS
- PROPERTY LINE
- ROW TAKING LINE
- SLOPE RIGHTS
- TOP OF CUT
- TOE OF SLOPE

DATUM	
VERTICAL	NGVD 1929
HORIZONTAL	NAD 1927

These plans are subject to such engineering changes as may be required by the Federal Highway Administration or the Director of Engineering and Construction.

Construction is to be carried on in accordance with these plans and the Standard Specifications for Highway and Bridge Construction dated March, 1978, as approved by the Federal Highway Administration on October 27, 1978 for use on this project, including all subsequent revisions and such revised specifications and special provisions as are incorporated in these plans.

SUBMITTED BY ORDER OF THE STATE TRANSPORTATION BOARD	
APPROVED	DATE 3-30-83
DIRECTOR OF ENGINEERING AND CONSTRUCTION	
DEPARTMENT OF TRANSPORTATION	
FEDERAL HIGHWAY ADMINISTRATION	
APPROVED _____	DATE _____
DIVISION ADMINISTRATOR	
PROJECT IR # 91-2 (66)	
SHEET 1 OF 19 SHEETS	

DRAWING 44-17-10000-1



REMOVING & RESETTING GUARD RAIL  
NB 4415+00 RT - NB 4417+50 RT.

COLD PLANING-BITUMINOUS PAVEMENT  
NB 4415+00 - NB 4417+50

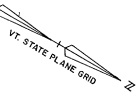
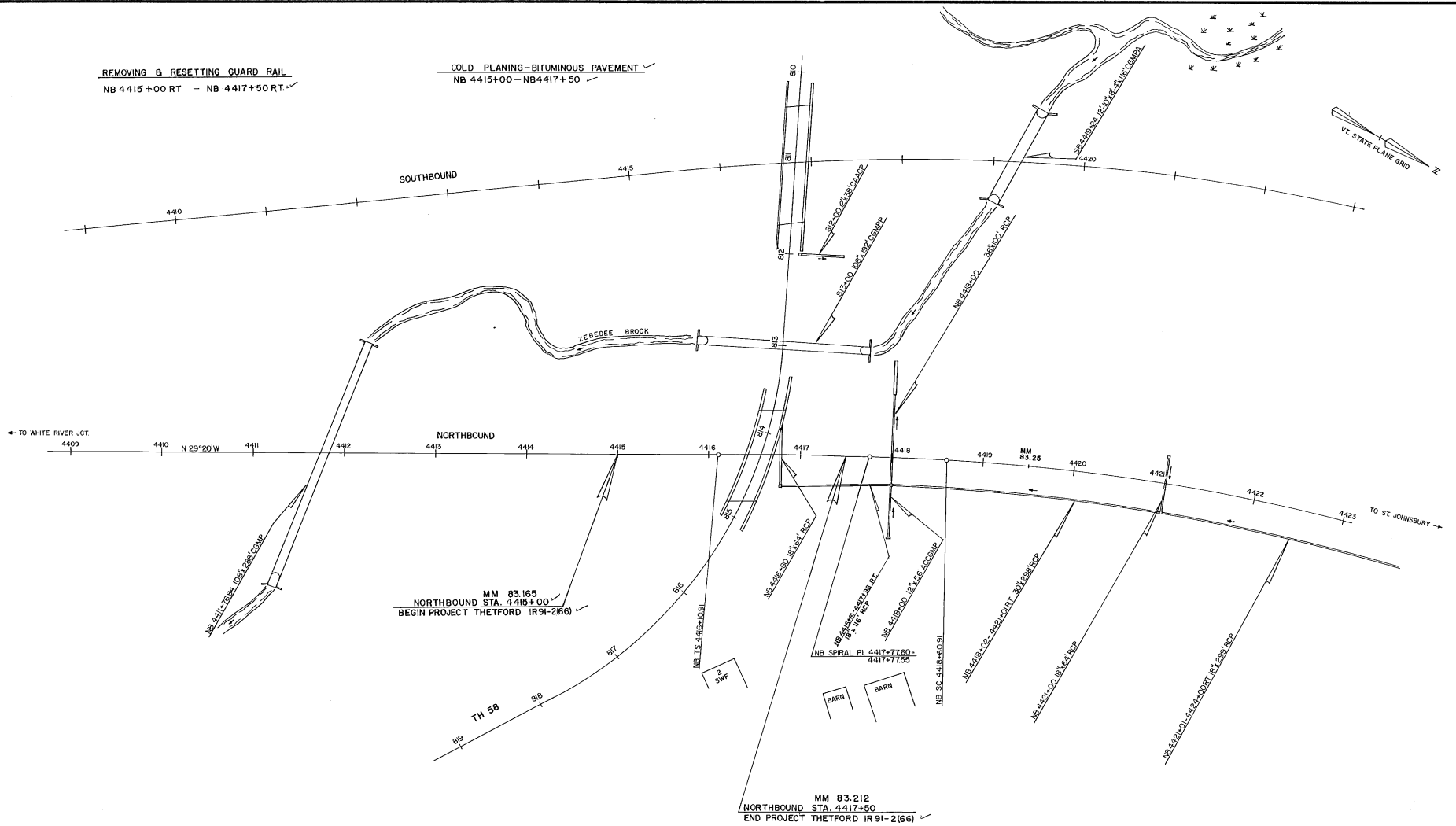

NOTE: FOR TIES SEE NEXT SHEET

DRAINAGE ITEMS SHOWN ARE FOR REFERENCE ONLY

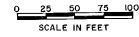

DATUM	
VERTICAL	NGVD 1929
HORIZONTAL	NAD 1927

SURVEYED BY TESSIER DATE 1-83  
 DRAWN BY S. JANAWICZ DATE 1-83  
 TRACED BY S. JANAWICZ DATE 1-83  
 THETFORD  
 PROJ. IR NO. 91-2 (66)  
 SHEET 2 OF 19

DATE	
BY	
APPROVED	
DESIGNED	
CHECKED	
IN CHARGE	
NO.	

DATE	
BY	
APPROVED	
DESIGNED	
CHECKED	
IN CHARGE	
NO.	

# TYPICAL SECTION

3/4" OPEN GRADED ASPHALT FRICTION COURSE, ITEM 409.25  
 2" BITUMINOUS CONCRETE PAVEMENT, ITEM 406.25, 2-1" COURSES  
 TYPE III

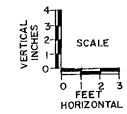
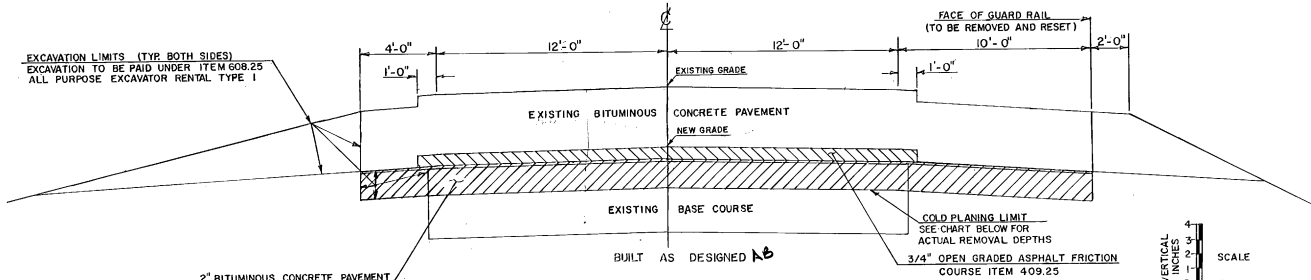

2" BITUMINOUS CONCRETE PAVEMENT  
 ITEM 406.25

STATION	EXISTING PROFILE	NEW FINISH GRADE	DIFF. FEET	BEAM CLEARANCE 12' LEFT	BEAM CLEARANCE 12' RIGHT	BEAM CLEARANCE PAVMT EDGE	TOTAL COLD PLANING DEPTH
4415+00	608.97	608.97	0				2.75"
+50	609.72	609.60	-0.12				4.19"
4416+00	610.43	610.22	-0.21				5.27"
+10.6	611.06	610.73	-0.33	16.05	16.06	16.18	6.71"
+491	611.19	610.85	-0.34	16.51	16.48	16.63	6.83"
+50	611.21	610.86	-0.35				6.95"
+57.7	611.32	610.97	-0.35	16.87	16.82	17.02	6.95"
+66.2	611.41	611.09	-0.32	17.21	17.13	17.34	6.59"
4417+00	611.78	611.56	-0.22				5.39"
+50	612.25	612.25	0				2.75"

NOTE: CROSSHATCH INDICATES NEW BITUMINOUS CONCRETE PAVEMENT.

ALL TIES ARE TO CONCRETE BOUNDS

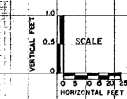
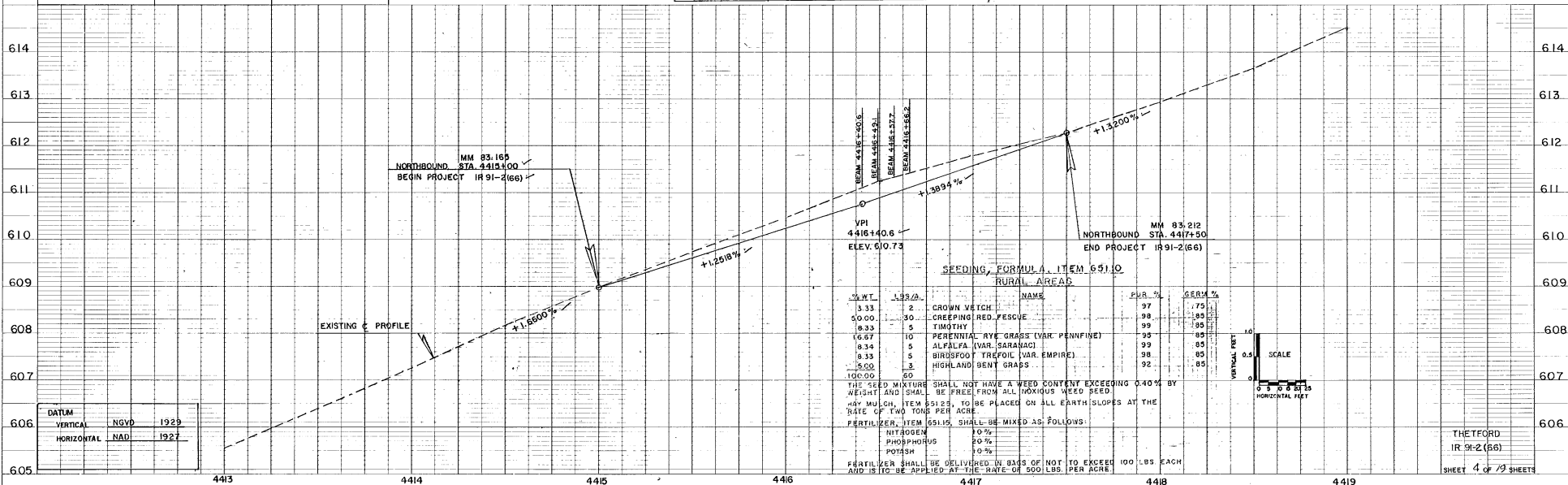
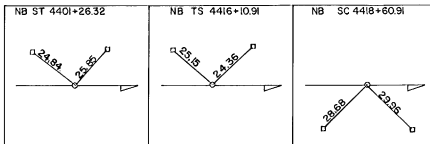

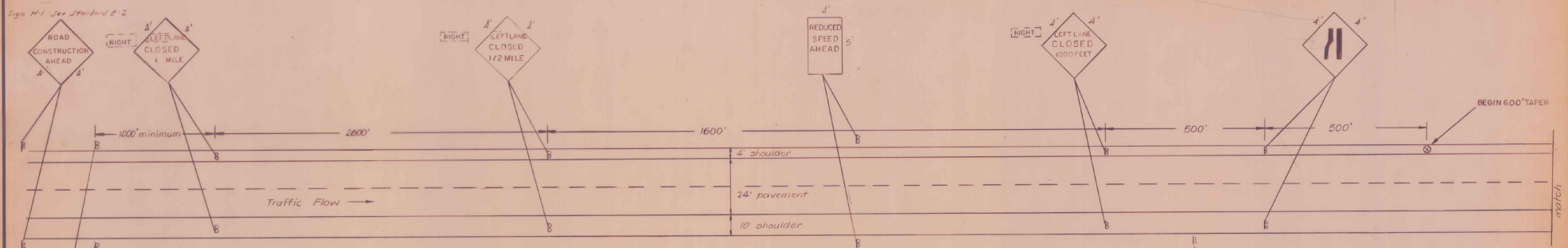

ROAD CONSTRUCTION  
NEXT \_\_\_\_\_ MILES

Sign #1-8 - See Standard E-2

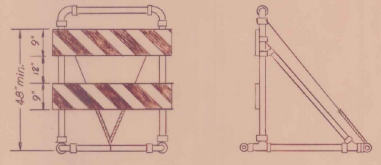

TYPE III (Breakaway) BARRICADE MODIFIED  
SEE STANDARD E-7A FOR DETAILS

Taper to be delineated by cones (28" minimum height),  
or by Type III Barricades (Modified).

FLASHING ARROW BOARD (48" x 96" minimum size)  
to be placed at end of 600' taper.  
The Flashing Arrow shall be mounted on a  
breakaway or yielding system.  
The Generator shall be separate from the  
Arrow Board and be located off the  
roadway shoulder. See Spec. Prov.

This Area to remain  
free of Obstructions

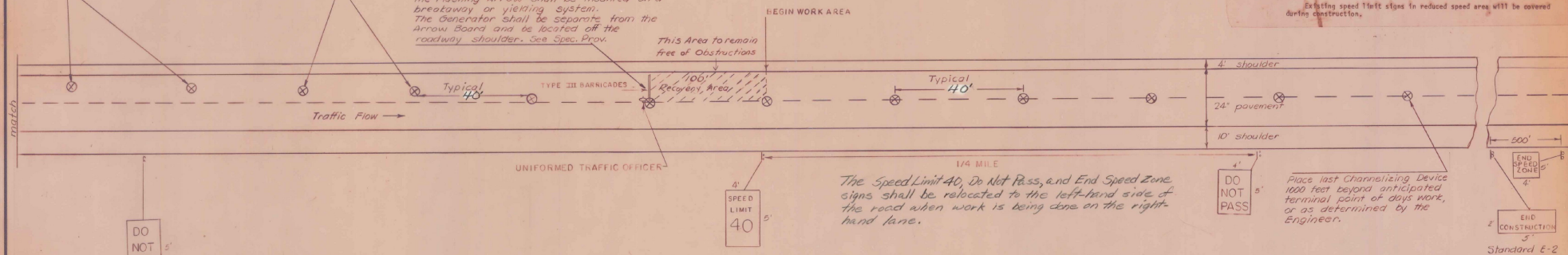

The Speed Limit 40, Do Not Pass, and End Speed Zone  
signs shall be relocated to the left hand side of  
the road when work is being done on the right-  
hand lane.

Place last Channelizing Device  
1000 feet beyond anticipated  
terminal point of days work,  
or as determined by the  
Engineer.

Standard E-2

**NOTES:**

- When working at or near the exit or entrance ramp, uniformed traffic officers shall be used to assist in controlling traffic.
- Exit ramps shall have traffic lanes delineated with 28" cones to indicate desired vehicle path. Taper lengths shall be at least 300 feet. Cone spacing shall be 40 feet.
- Cones shall be weighted at the base to prevent overturning and kept clean. Signs R-1 and R-3 will be in conformity with Standard E-2. All others will be moveable and will be removed during non-working hours.
- During periods of poor visibility, steady burn yellow lights mounted on Type III barricades (W/O) will be in place of cones.
- All signs will be placed before any work is done or equipment is on roadway.
- Contractor shall have barricades and signs for left side closure and right side closure on project before starting construction.
- Work crews' private vehicles will not park in or around working area. Contractor will provide parking for work crews' vehicles off project.
- Uniformed traffic officers will park on shoulder away from traffic.
- Existing speed limit signs in reduced speed area will be covered during construction.

DATUM	
VERTICAL	N/A
HORIZONTAL	N/A

\*Speed Limit 40\* to be installed at 1/2 mile increments for entire project length. \*Do Not Pass\* signs will be erected immediately in advance of and throughout the length of the work area, halfway between adjacent speed limit signs.

Refer to Project Special Provisions for speed zone enactment, refer to "Uniform Traffic Control Devices" Manual for tapers out to speed zone area.

NOT TO SCALE

MAINLINE TRAFFIC CONTROL PLAN		SURVEYED BY _____ DATE _____	
PAVING WITH TRAFFIC		DRAWN BY <u>PPP</u> DATE <u>2-12-87</u>	
		TRACED BY _____ DATE _____	
		THETFORD	
		PROJ. I/R NO 91-2(66)	
		SHEET 5 OF 19	

# SECTION 641 TRAFFIC SIGNS SUMMARY SHEET

MAINLINE PAVING

RAMP PAVING

IDENTIFICATION	NUMBER OF SIGNS	SIZE		TEXT	FOR SIGN DETAIL, SEE STANDARD OR SHEET NUMBER
		WIDTH	HEIGHT		
	2	4	4	LEFT LANE CLOSED 1 MILE	E-8
	8	18"	8"	RIGHT	E-8
	2	4	4	LEFT LANE CLOSED 1/2 MILE	E-8
	2	4	5	REDUCED SPEED AHEAD	
	2	4	4	LEFT LANE CLOSED 1000 FEET	E-8
	2	4	4		E-8
	2	4	4		E-8
	AS REQUIRED	4	5	DO NOT PASS	
	AS REQUIRED	4	5	SPEED LIMIT 40	E-16
	1	4	5	END SPEED ZONE	
	2	4	4	CAUTION PAVEMENT CHANGE	
	2	4	4	BUMP	

IDENTIFICATION	NUMBER OF SIGNS	SIZE		TEXT	FOR SIGN DETAIL, SEE STANDARD OR SHEET NUMBER
		WIDTH	HEIGHT		
	AS REQUIRED	4	4	LEFT LANE CLOSED AHEAD	E-8
	AS REQUIRED	18"	8"	RIGHT	E-8
	AS REQUIRED	4	4		E-6

SIGN NOTES: TRAFFIC SIGNS SHOWN ON THIS SHEET ARE TO BE SUBSIDIARY TO ITEM 641, TRAFFIC CONTROL. ADDITIONAL SIGNS, IF REQUIRED, THAT ARE NOT DETAILED WILL BE PAID AS ITEM 675.20 OR 675.25 AS DIRECTED BY THE ENGINEER. PROJECT SIGNS AS PER STANDARD E-2 AND E-6 WILL BE REQUIRED TO ESTABLISH PROJECT LIMITS AND AS RAMP SIGNING. SIGNS MAY BE ERRECTED ON FLANGED CHANNEL STEEL POSTS OR BREAKAWAY WOODEN POSTS.

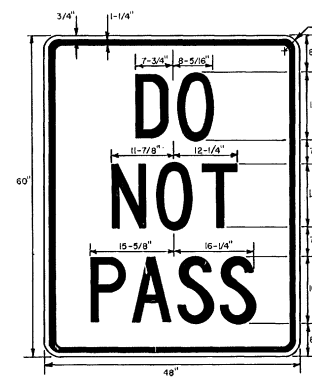
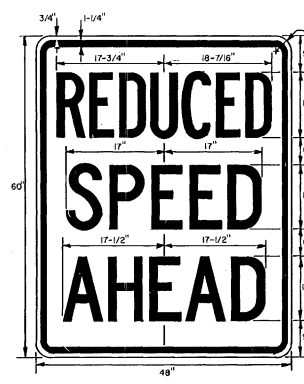
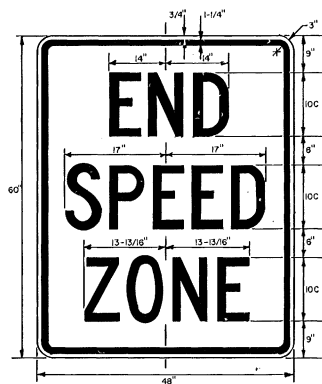

COLORS: LEGEND - BLACK (NON-REFLECTORIZED)  
BACKGROUND - WHITE (REFLECTORIZED)  
SEE STANDARD SHEET E-16 FOR MATERIAL SPECIFICATIONS

*Notes: Sign dimensions are in feet unless otherwise indicated.*

SECTION 641 PAVING WITH TRAFFIC SIGN SUMMARY SHEET		SURVEYED BY _____ DATE _____
		DRAWN BY RPR DATE 2-82
		TRACED BY LCG DATE 6-82
		THEFTORD
		PROJ. 1R NO. 91-2(66)
		SHEET 6 OF 12

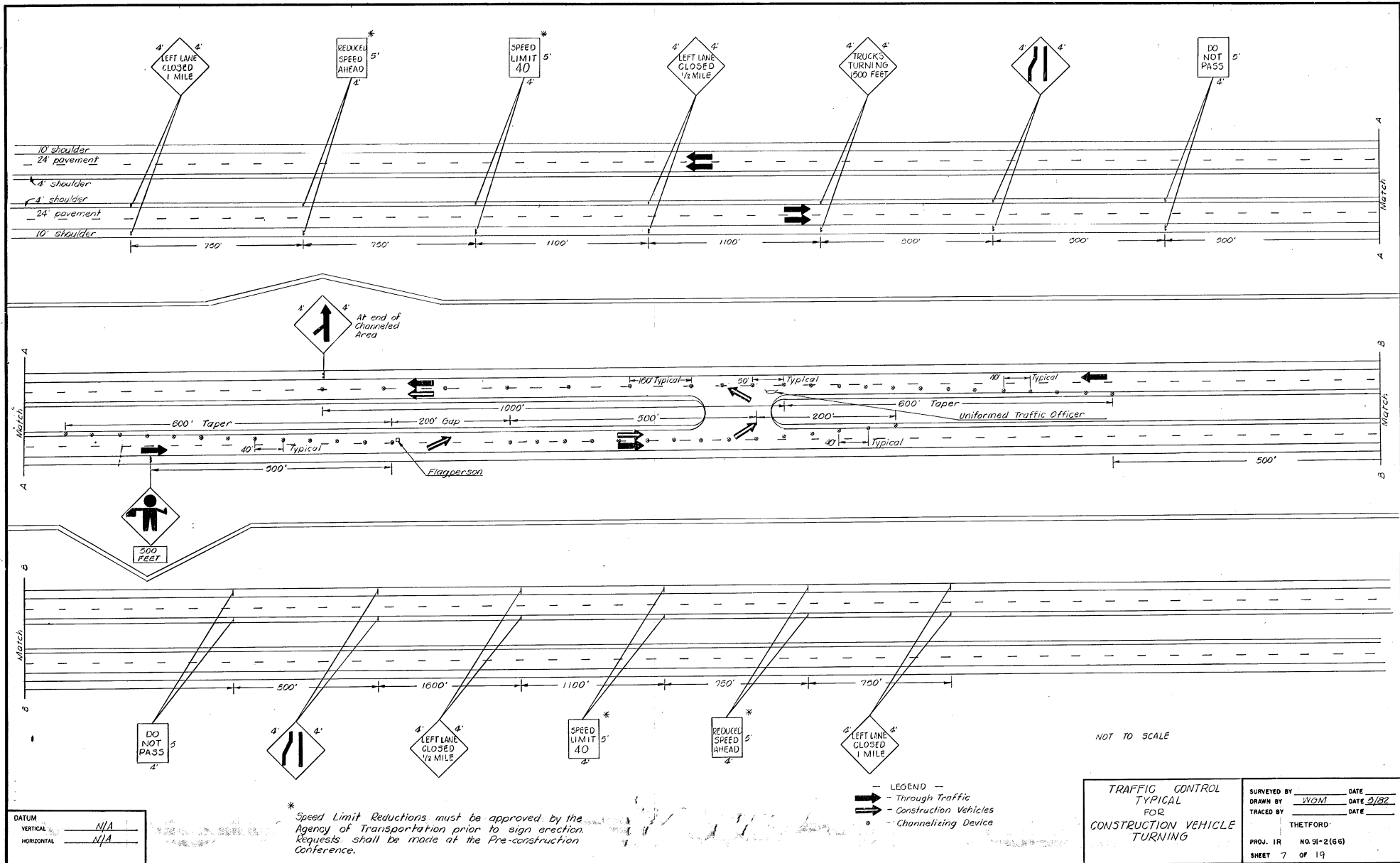

\* Speed Limit Reductions must be approved by the Agency of Transportation prior to sign erection. Requests shall be made at the Pre-construction Conference.

NOT TO SCALE

— LEGEND —  
 → Through Traffic  
 ⇨ Construction Vehicles  
 • Channelizing Device

**TRAFFIC CONTROL TYPICAL FOR CONSTRUCTION VEHICLE TURNING**

SURVEYED BY	DATE
DRAWN BY <u>WOM</u>	DATE <u>3/82</u>
TRACED BY	DATE
THETFORD	
PROJ. 1R	NO. 91-2(66)
SHEET 7	OF 19

DATUM  
 VERTICAL N/A  
 HORIZONTAL N/A





ORIGINAL  
 DATE  
 DRAWN BY  
 CHECKED BY  
 PROJECT NO.  
 SHEET NO.

ORIGINAL  
 DATE  
 DRAWN BY  
 CHECKED BY  
 PROJECT NO.  
 SHEET NO.

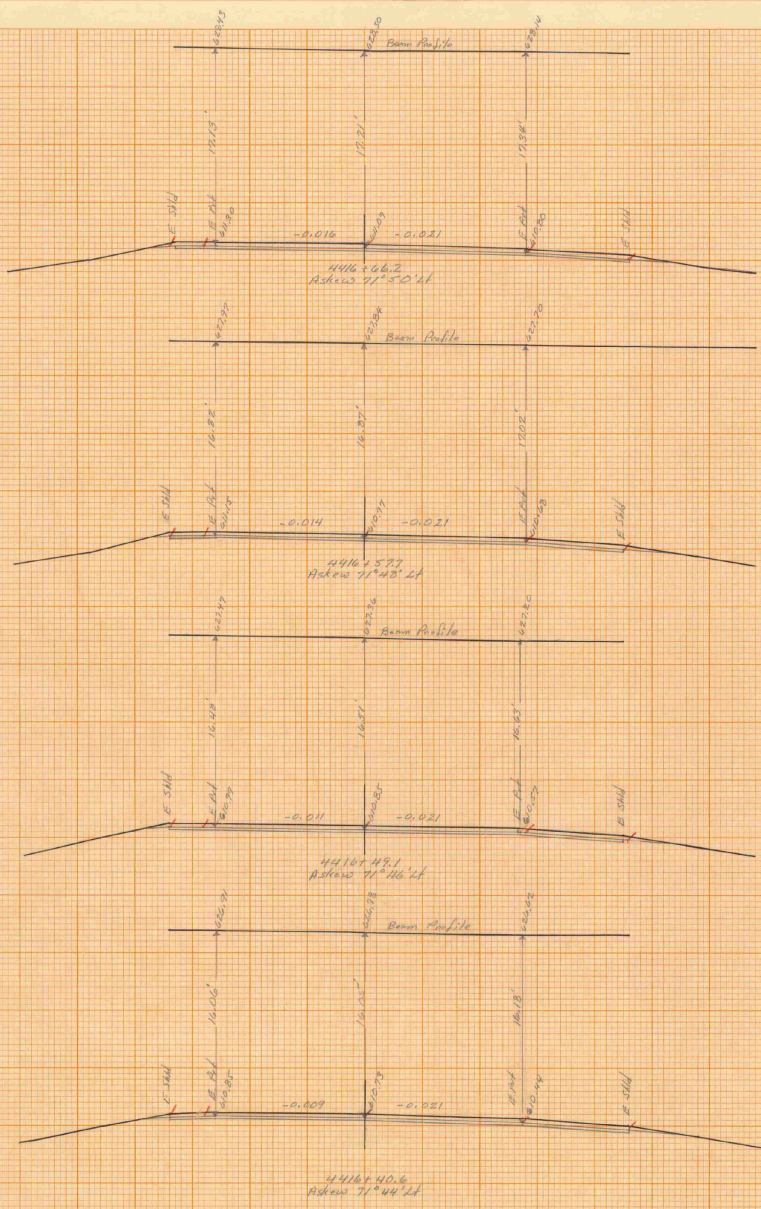

610

610

610

610

STA. 4416+40.6 STA. 4416+66.2  
 TOWN - SWTPRIB  
 PROJECT 118 NO. 21 (200)  
 SHEET 18 OF 19 SHEETS  
 HORIZ. AND VERT. SCALE  
 1" = 5' 1" = 10'  
 DRAWN BY - T. S. G. DATE - 11-28

Plot 009 11/28/28

FINAL SURVEY  
 DATE: \_\_\_\_\_  
 BY: \_\_\_\_\_  
 CHECKED: \_\_\_\_\_

FINAL SURVEY  
 DATE: \_\_\_\_\_  
 BY: \_\_\_\_\_  
 CHECKED: \_\_\_\_\_

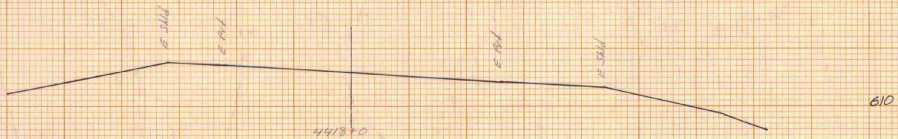

4417+50 MM83.812  
 END PROJECT  
 I.R. 91-2 (66)

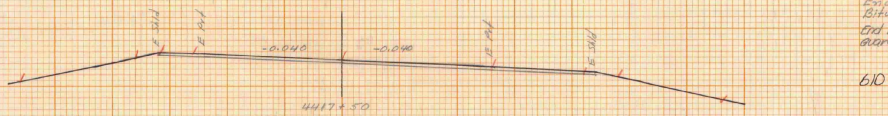

4417+50  
 End Cold Planing,  
 Bituminous Pavement  
 and Rebarbing and Resetting  
 Guard Rail



Plot 6587/11/1988

STA. 4417+0	IN 4418+0
TOWN SHEFFIELD	
PROJECT I.R. 91-2 (66)	
SHEET 19	OF 19
HORIZ. AND VERT. SCALE	
H	V
1" = 10'	1" = 10'
SURVEYED BY: T. M. L.	DATE: 7-88

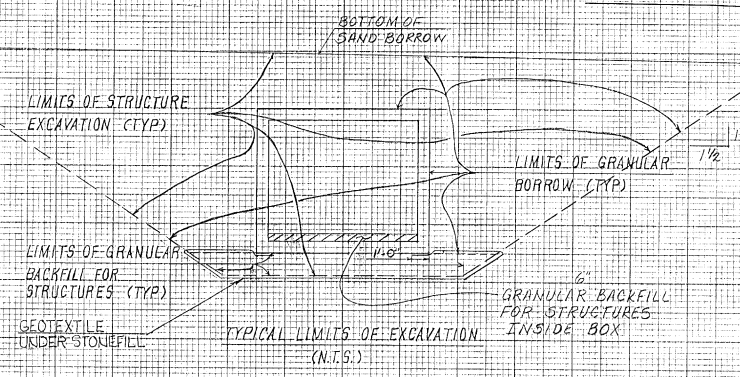
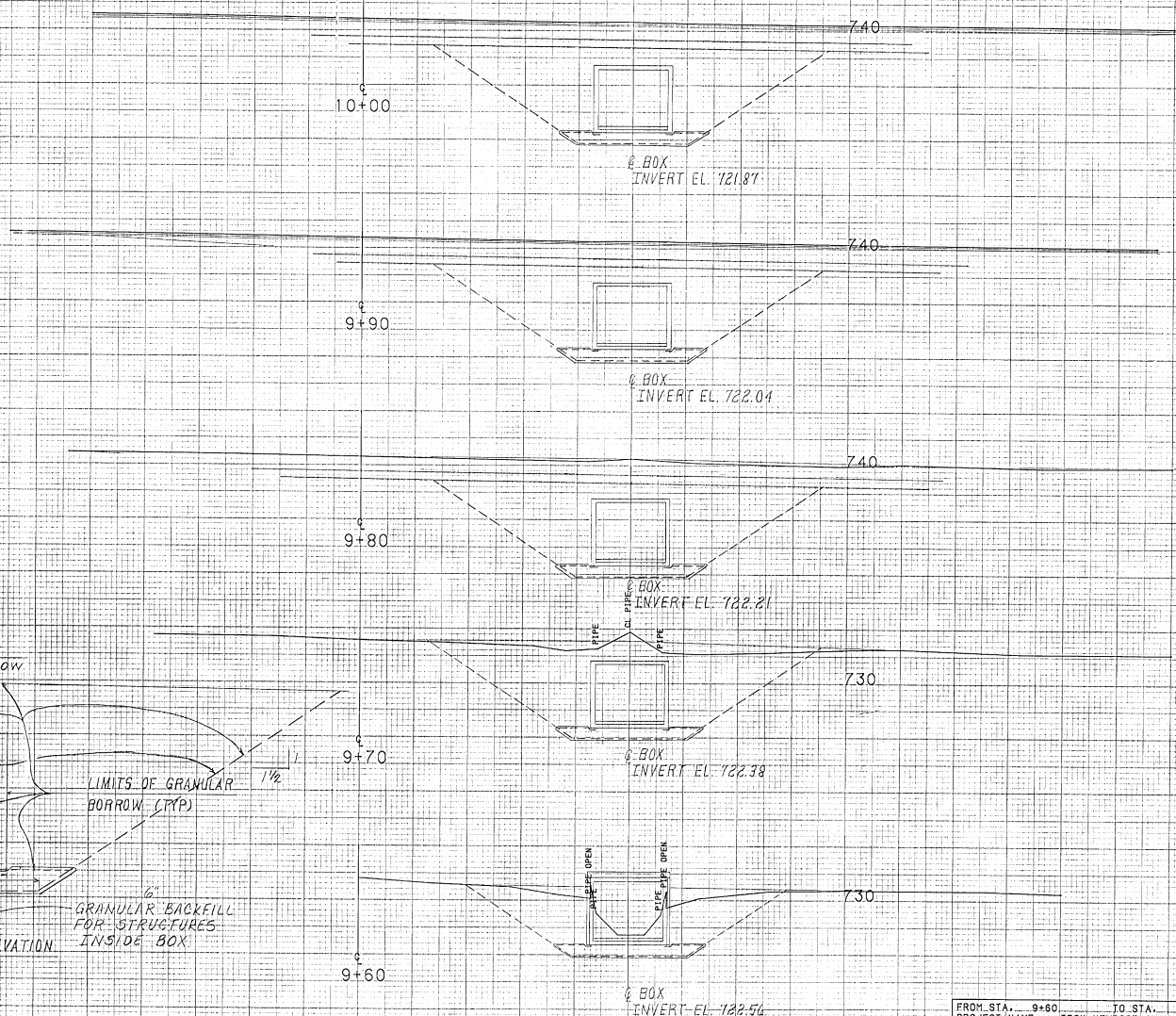

FROM STA. 9+60 TO STA. 10+00  
 PROJECT NAME TROY-NEWPORT CHAN  
 NO. F034-2(10)S PLOTTED 04/03/92  
 SURVEYED BY R. GILMAN 02/92 0361  
 SHEET 27 OF 29 SHEETS

SCALE 1" = 10 FEET

Vermont Agency of  
Transportation  
PHASE 1-INTERSTATE  
#122302-01  
INITIALS   
HANGER 553

Thetford  
IR-91-2 (66)

\*

1983

1983