

**STATE OF VERMONT
AGENCY OF TRANSPORTATION**

Date DEC 17 1988

KEITH Construction Inc.
Contractor

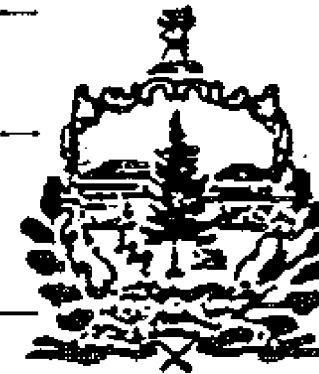

CONTRACT PLANS
THESE PLANS DO NOT REFLECT
CHANGES MADE ON THE PROJECT.

J. Kevin Hayes
Signature
Vice president
Title

Title **PROPOSED IMPROVEMENT**
RESURFACING PROJECT

Transportation Secretary's
Signature TOWN OF: MIDDLESEX-WATERBURY

COUNTY OF: WASHINGTON

ROUTE NO: I-89

ROUTE CLASS: INTERSTATE

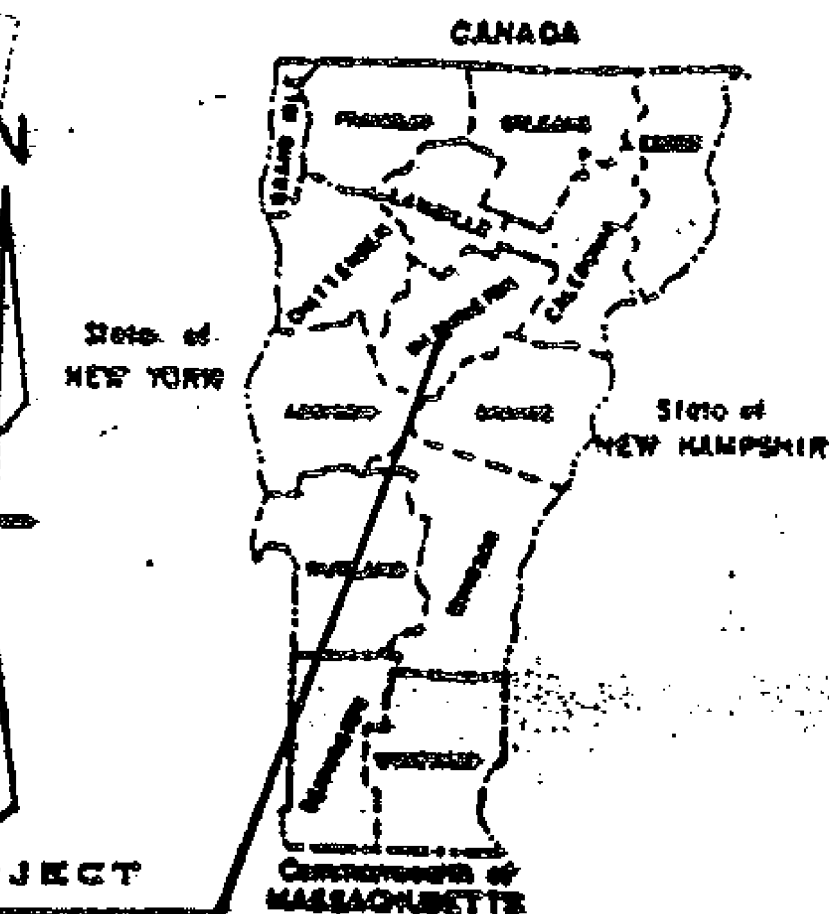
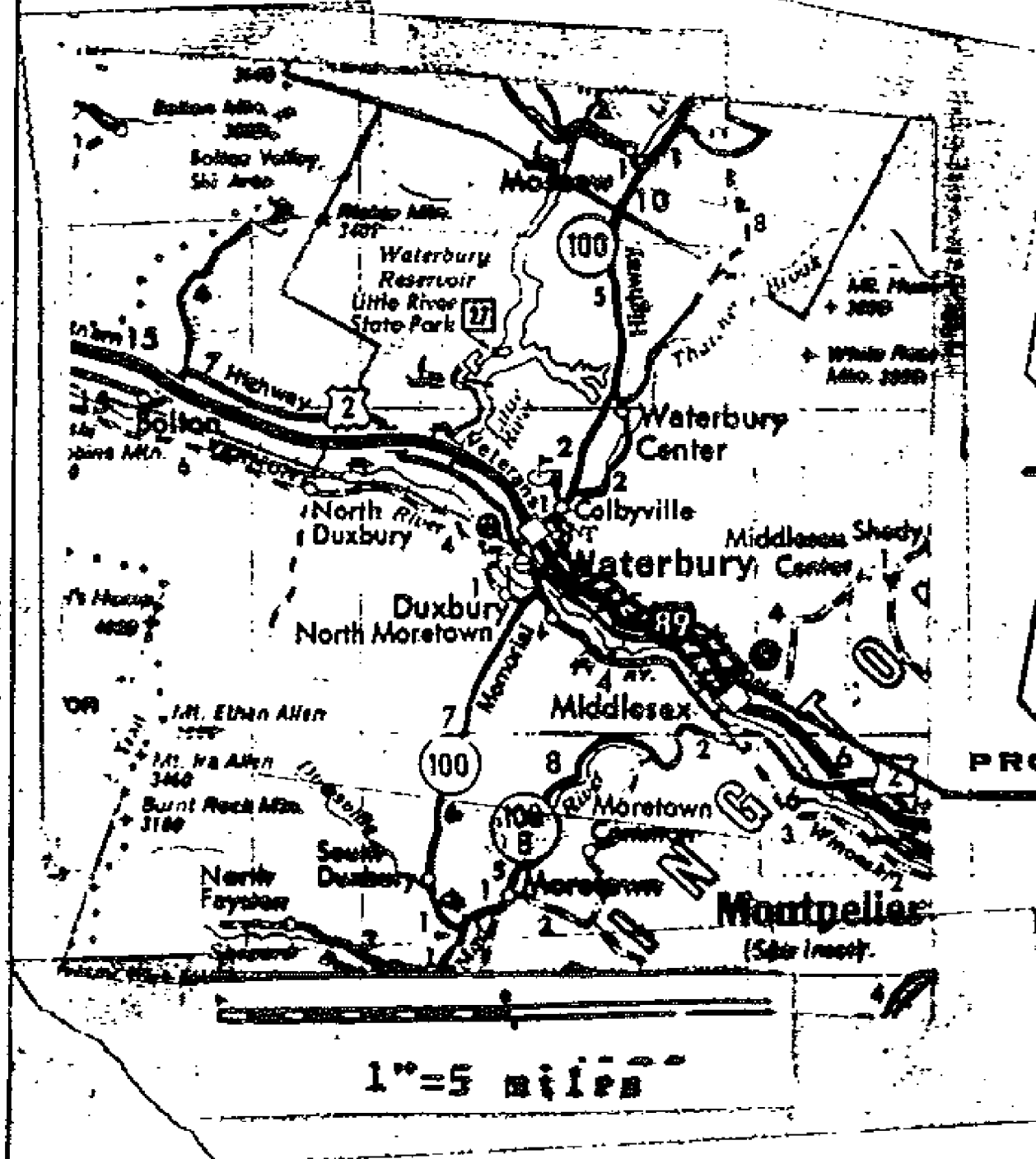

These plans are subject to such engineering changes as may be required by the Federal Highway Administration or the Director of Engineering and Construction.
Construction is to be carried on in accordance with these plans and the Standard Specifications for Highway and Bridge Construction dated March, 1976, as approved by the Federal Highway Administration on October 27, 1976 for use on this project, including all subsequent revisions and such revised specifications and special provisions as are incorporated in these plans.

SUBMITTED BY ORDER OF THE STATE TRANSPORTATION BOARD
APPROVED Frank E. [Signature] DATE DEC 29 1988
DIRECTOR OF ENGINEERING AND CONSTRUCTION
DEPARTMENT OF TRANSPORTATION
FEDERAL HIGHWAY ADMINISTRATION
APPROVED _____ DATE _____
DIVISION ADMINISTRATOR

SEE SHEET 2 FOR INDEX

PROJECT NO. IR 089-2(6)
SHEET 1 OF 34 SHEETS

INDEX OF SHEETS

1.	TITLE PAGE
2-2A	INDEX OF SHEETS
3	PROJECT DESCRIPTION AND LOCATION
4-5A	TYPICAL SECTIONS AND DESIGN DATA
6-7A	PROJECT LENGTH AND ITEM QUANTITIES
8	TEMPORARY PAVEMENT MARKING QUANTITIES
9	EXIT 9 DIAGRAM
10	MAINLINE SIGNING
11-12	SIGN SUMMARY SHEET
13	SIGN SUMMARY, DETAILS, AND QUANTITY SHEET
14	MAINLINE TRAFFIC CONTROL PLAN
15	MAINLINE TRAFFIC CONTROL SIGN SUMMARY
16	TRAFFIC CONTROL TYPICAL FOR CONSTRUCTION VEHICLE TURNING
17	CONSTRUCTION VEHICLE TURNING SIGN SUMMARY
18	TRAFFIC CONTROL SIGN SUMMARY SHEET FOR RAMPS

19	STANDARD SHEET	E-2	3-4-81R
20	STANDARD SHEET	E-6	4-1-80R
21	STANDARD SHEET	E-8	6-15-83R
22	STANDARD SHEET	E-12	12-3-82R
23	STANDARD SHEET	E-13	12-2-82R
24	STANDARD SHEET	E-14	3-3-83
25	STANDARD SHEET	E-14B	3-3-83
26	STANDARD SHEET	E-15B	12-27-84R
27	STANDARD SHEET	E-15C	7-18-84

Continued

INDEX OF SHEETS

28	STANDARD	SHEET	E-19	4-18-85
29	STANDARD	SHEET	E-19A	10-3-84
30	STANDARD	SHEET	E-23	2-10-83R
31	STANDARD	SHEET	E-24A	1-8-81R
32	STANDARD	SHEET	E-24B	4-28-78
33	STANDARD	SHEET	E-25	6-17-81R
34	STANDARD	SHEET	E-50	3-16-82R

PROJECT MIDDLESEX - WATERBURY

NO. IR 089-2(6)

SHEET 21 OF 34 SHEETS

PROJECT DESCRIPTION AND LOCATION

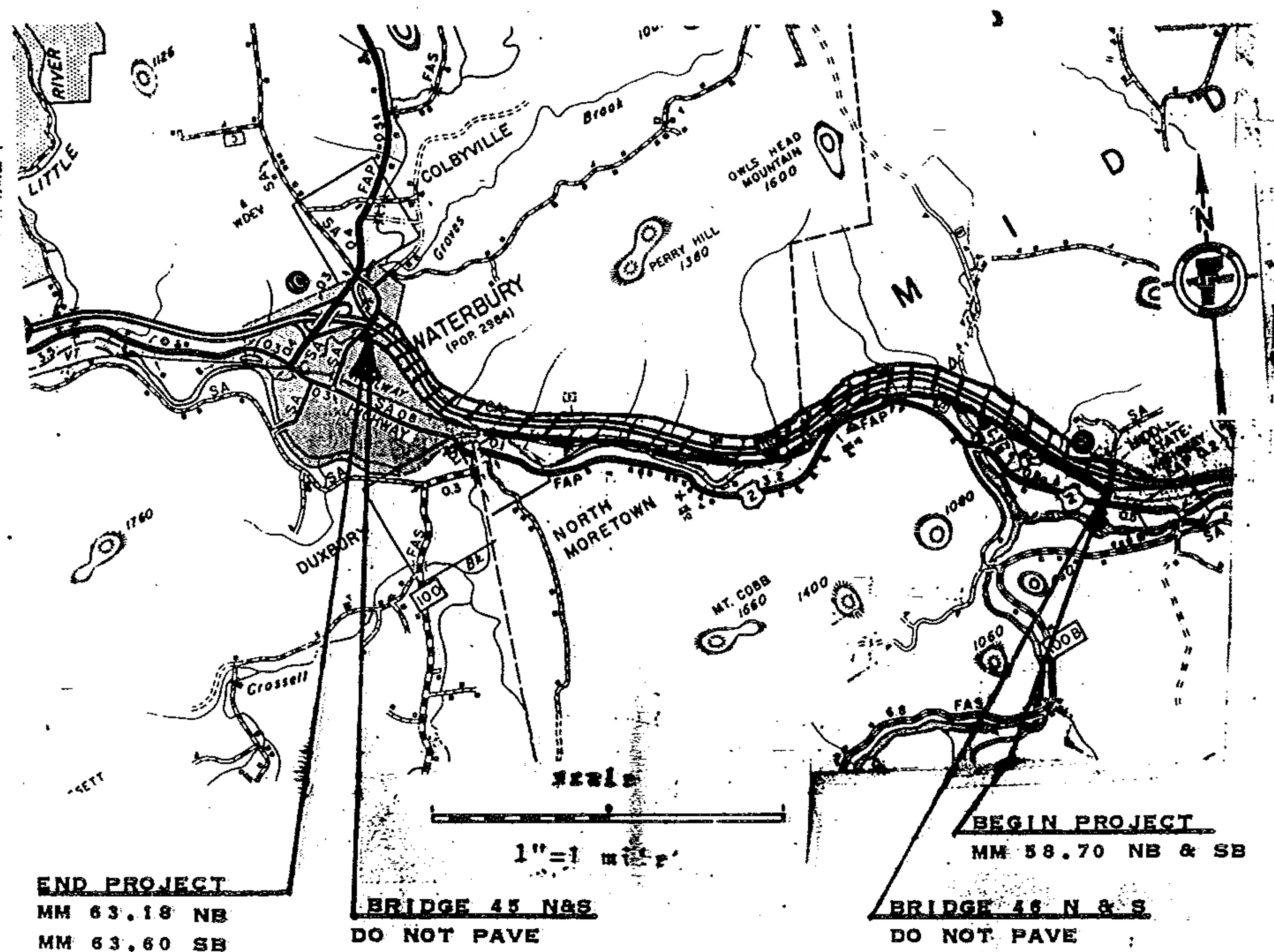

I 89 NORTHBOUND BEGINNING IN THE TOWN OF MIDDLESEX AT THE MIDDLESEX INTERCHANGE AT MM 58.70 AND EXTENDING 4.48 MILES TO MM 63.18 IN THE TOWN OF WATERBURY.

SOUTHBOUND BEGINNING IN THE TOWN OF MIDDLESEX AT THE MIDDLESEX INTERCHANGE AT MM 58.70 AND EXTENDING 4.90 MILES TO MM 63.60 IN THE TOWN OF WATERBURY.

ALSO RAMPS C AND D AT INTERCHANGE #9 AND PAVE ALL U-TURNS.

LENGTH OF PROJECT
NORTHBOUND 4.48 MILES = 23654 FEET
SOUTHBOUND 4.90 MILES = 25872 FEET

PROJECT MIDDLESEX-WATERBURY

NO. IR 089-2(6)

SHEET 3 OF 24 SHEETS

TYPICAL SECTIONS & DESIGN DATA

AS DIRECTED BY THE ENGINEER
ITEM 406.25 BITUMINOUS CONCRETE PAVEMENT
1/2" LEVELING COURSE TYPE III OR IV
1 1/2" WEARING COURSE ($\pm 1/4$ ") TYPE III

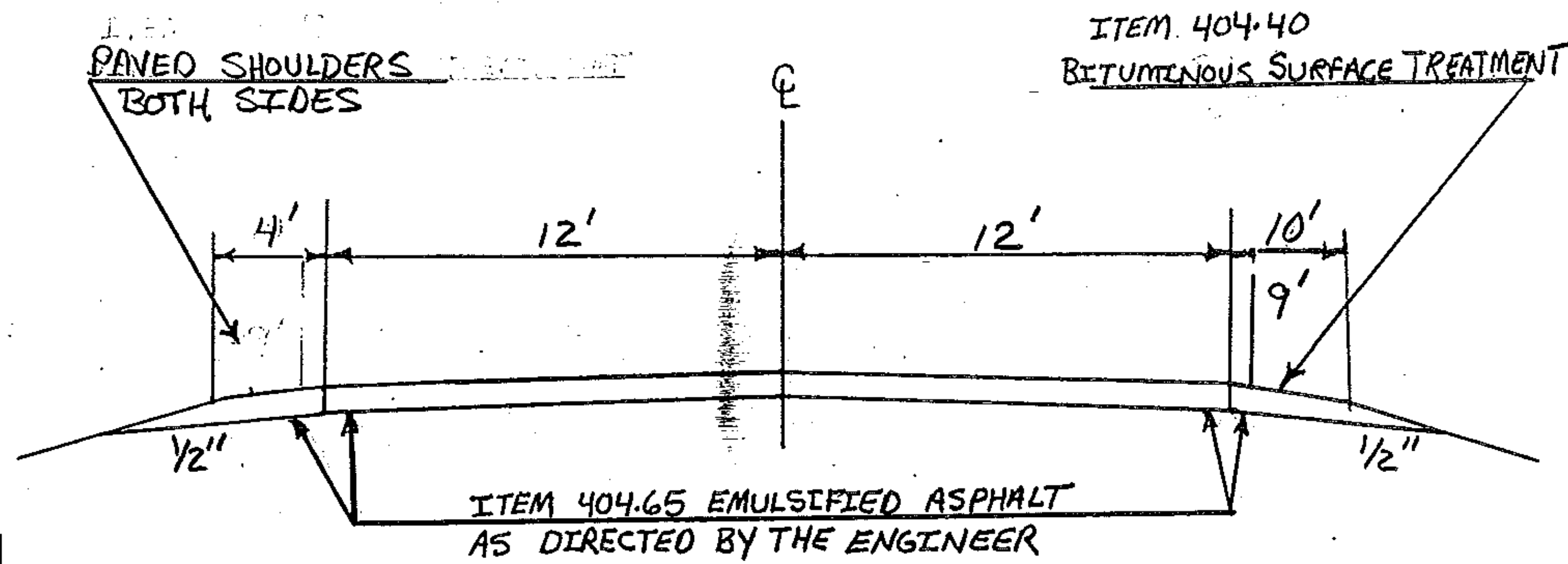

NORTHBOUND MM 58.70 ~ MM 61.5.0

1984 ADT 11300
V = 55

Note: Topsoil, Item 653.10 to be applied as directed by the Engineer.

PROJECT MIDDLESEX - WATERBURY

NO. IR 089-2 (6)
SHEET 4 OF 34

TYPICAL SECTIONS & DESIGN DATA

AS DIRECTED BY THE ENGINEER

ITEM 210.10 COLD PLANING BITUMINOUS PAVEMENT

ITEM 406.25 BITUMINOUS CONCRETE PAVEMENT

1" BINDER COURSE TYPE III OR IV, MM 61.50 ~ MM 63.18

1/2" WEARING COURSE (# 1/4") TYPE III

ITEM 404.40 BITUMINOUS SURFACE TREATMENT

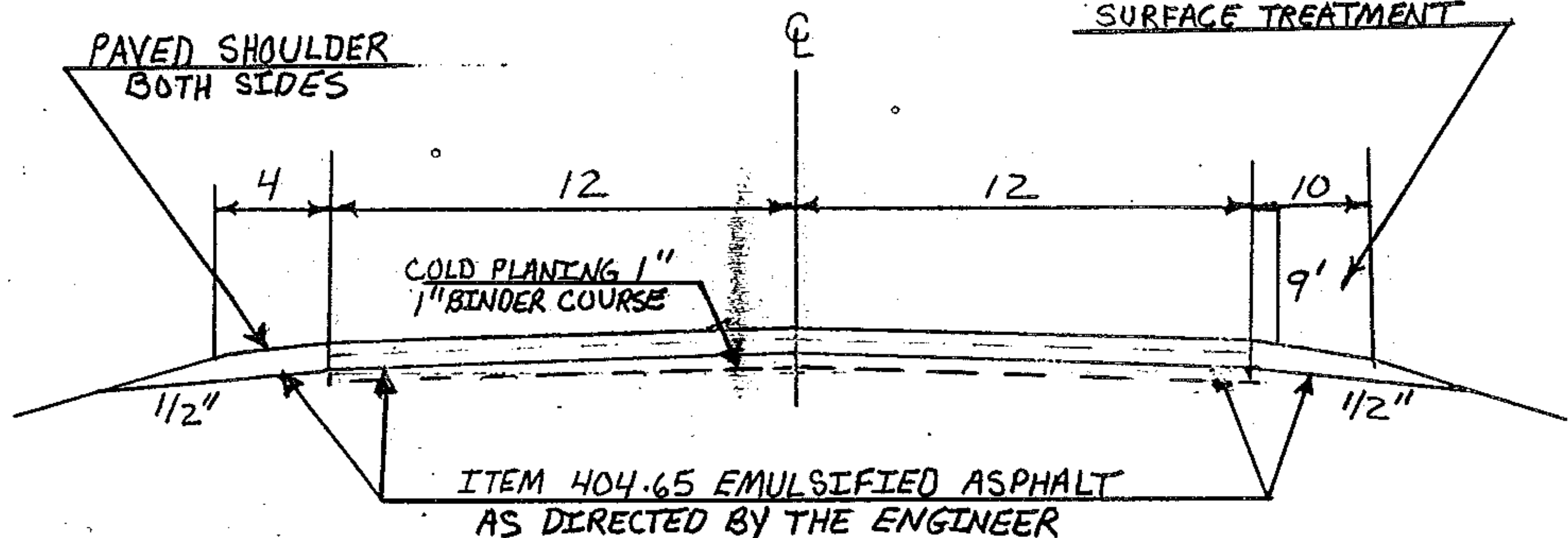

NOTE: AT MM 61.90 AND 62.40 N. BOUND & 62.40 S. B. THERE IS LOCALIZED SETTLEMENT. ANY ADDITIONAL PAVEMENT NEEDED IS TO BE PLACED AS DIRECTED BY THE ENGINEER. ALSO ANY ADJUSTMENT TO THE GUARDRAILS IN THESE AREAS TO BRING THE GUARDRAIL INTO CONFORMANCE WITH STANDARDS SHALL BE DONE AS DIRECTED BY THE ENGINEER.

THE COSTS OF ADJUSTING GUARDRAIL SHALL BE SUBSIDIARY TO OTHER CONTRACT ITEMS.

COLD PLANING AREA MM 61.50 ~ MM 63.18 N. BOUND

MM 58.70 ~ MM 63.60 S. BOUND

1984 ADT 11300

V=55

PROJECT MIDDLESEX-WATERBURY

NO. IR 089-2(6)
SHEET 5 OF 34

TYPICAL SECTIONS & DESIGN DATA

ITEM 406.25 BITUMINOUS CONCRETE PAVEMENT
 LEVELING COURSE TYPE III OR IV, (LEVEL COURSE 1/2")
 AS DIRECTED BY THE ENGINEER
 1" WEARING COURSE TYPE III

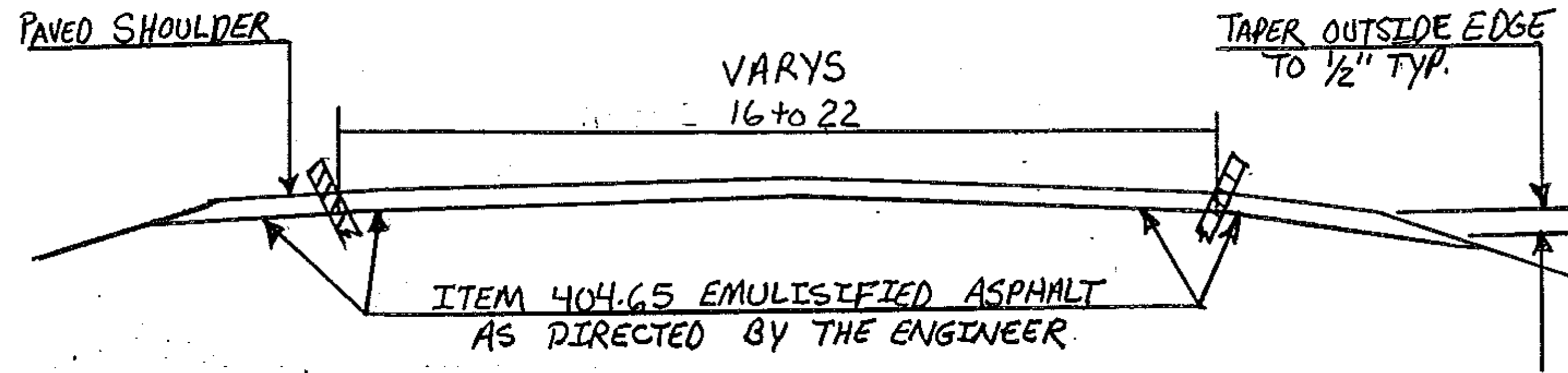

RAMP	LENGTH IN FEET	ADT (1982)	CURB RIGHT	CURB TO CURB	CURB LEFT	SHOULDER WIDTH	TRAVELWAY WIDTH	TOWN
C	100	220			0.00 TO 0.019	4	22	MIDDLESEX
C	50	220	0.00 TO 0.009			4	22	MIDDLESEX
C	428	220				4	16	MIDDLESEX
C	158	220	0.100 TO 0.130			4	16	MIDDLESEX
C	149	220				4	16	MIDDLESEX
D	762	215				4	16	MIDDLESEX
D	80	215		0.144 TO 0.159			22	MIDDLESEX
D	70	215		0.144 TO 0.157			22	MIDDLESEX

PROJECT LENGTHS AND ITEM QUANTITIES

ITEM DESCRIPTION	ITEM NUMBER																	REMARKS
	LENGTH	WIDTH	OVERLAY DEPTH	COLD PLANING	GRAVEL SHOULDERS	GRAVEL SHOULDERS	EMULSIFIED ASPHALT	BITUMINOUS CONCRETE PAVEMENT	CHANGE ELEV. OF CB, DL, OR MI	ALL PURPOSE EXC. RENTAL, TYPE I	POWER BROOM RENTAL	ENFORCED TRAFFIC OFFICERS	FLAGPERSONS	MOBILIZATION	TEMPORARY PAVEMENT	MARKING YELLOW	TEMP. PYMT. MKG. WHITE	
UNIT	FEET	FT	INCH	SY.	CY	TON	CY	TON	EA	HR	HR	HR	HR	LS	LF	LF		
U-TURNS							1	75										
PROJECT ESTIMATE					25	45	1	125	-	25	77	96	96					
ROUNDING				54	8	15	2	58	-	-	3	14	14			7		
TOTAL				92700	1000	1755	270	24100	10	25	80	975	975	1	51100	79020		
				✓	✓	✓	✓	✓	✓	✓	✓	✓	✓	✓	✓	✓		

PROJECT LENGTHS AND ITEM QUANTITIES

ITEM DESCRIPTION	LENGTH		WIDTH	BITUMINOUS SURFACE TREATMENT	TRAFFIC CONTROL	DURABLE 4" WHITE LINES	DURABLE 8" WHITE LINES	TOPSOIL						
	FT.	FT.	CWT	LS	LF	LF.	LF.	CY						
MM 58.70 ~ 63.18 (NORTH BOUND)			688		90	165		90						
MM 58.70 ~ 63.60 (SOUTH BOUND)			752		10	236		98						
RAMPS								10						
PROJECT ESTIMATE								5	5					
ROUNDING			5	10	4	1	2							
TOTAL			1445	1	110	405	5	205						
			✓	✓	✓	✓								

PROJECT LENGTHS AND ITEM QUANTITIES

ITEM NO	ITEM DESCRIPTION										
	PAINTED CURBS	DURABLE 24" STOP BAR	DURABLE LETTER IN WORD MARKING	TRAFFIC SIGNS, TYPE "A"	TRAFFIC SIGNS TYPE "B"	TRAFFIC SIGN POSTS, TYPE "A"	REMOVING SIGNS	ERECTING SALVAGED SIGNS, TYPE A			
	646.21	646.64	646.66	675.20	675.25	675.35	675.37	675.53	675.60		
UNIT	LF.	LF.	EA.	SF	SF	LB.	LB	EA	SF		
LOCATION											
PROJECT EST.	206	34	17	352.4 328.1	836 746	242	133.8	42 44	24.6 12.8		
ROUNDING	4			2.6 1.9	4	8	1.2	.4 1.7			
TOTAL	210 ✓	34 ✓	17 ✓	355 330	840 750	250	135	42 44	25 13		

MIDDLESEX -
PROJECT WATERBURY

NO. IR 089-2(6)

SHEET 7A OF 34

TEMPORARY 4" REFLECTORIZED YELLOW LINE

MILE	MILE	LT	RT	€		
NORTHBOUND						
58.70	63.18	23654				23654
RAMP "A"					645	645
					SUB-T	24299
SOUTHBOUND						
58.70	63.60		25872			25872
RAMP "D"					925	925
					SUB-T	26797
					TOTAL	51096

TEMPORARY 4" REFLECTORIZED WHITE LINE

NORTHBOUND						
58.70	63.18 (FINAL)	23654				23654
				5914		5914
ON COLD PLANED SURFACE				2218		2218
ON BINDER OR LEVELING COURSE				5914		5914
RAMP "A"					745	745
					SUB-T	38445
SOUTHBOUND						
58.70	63.60 (FINAL)	25872				25872
				6468		6468
ON LEVELING COURSE				6468		6468
RAMP "D"					1760	1760
					SUB-T	40568
SHEET 8 OF 34 SHEETS					TOTAL	79013

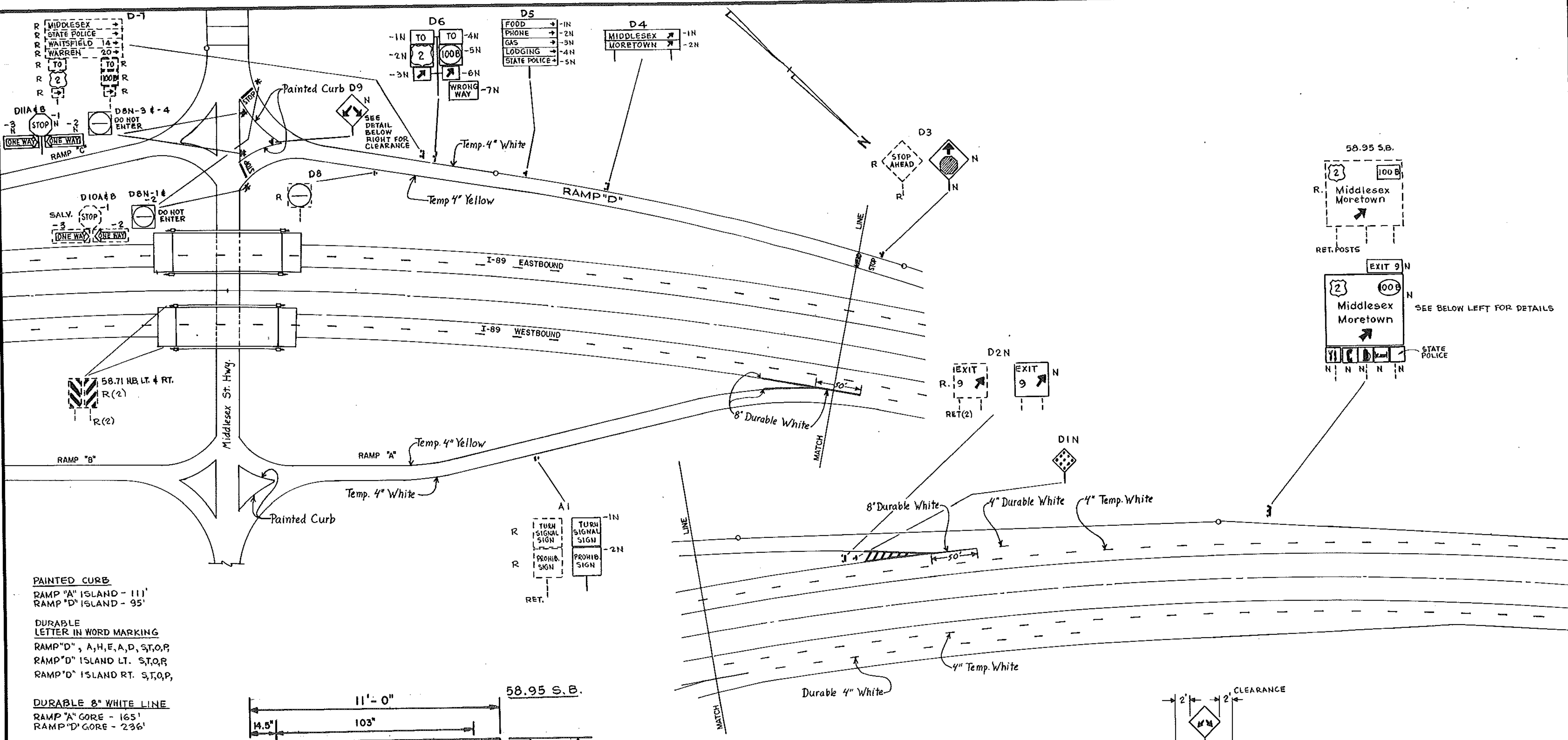

- PAINTED CURB**
 RAMP "A" ISLAND - 111'
 RAMP "D" ISLAND - 95'
- DURABLE LETTER IN WORD MARKING**
 RAMP "D", A, H, E, A, D, S, T, O, P
 RAMP "D" ISLAND LT. S, T, O, P
 RAMP "D" ISLAND RT. S, T, O, P,
- DURABLE 8" WHITE LINE**
 RAMP "A" GORE - 165'
 RAMP "D" GORE - 236'
- DURABLE 24" STOP BAR**
 RAMP "D" ISLAND LT. - 16'
 RAMP "D" ISLAND RT. - 18'

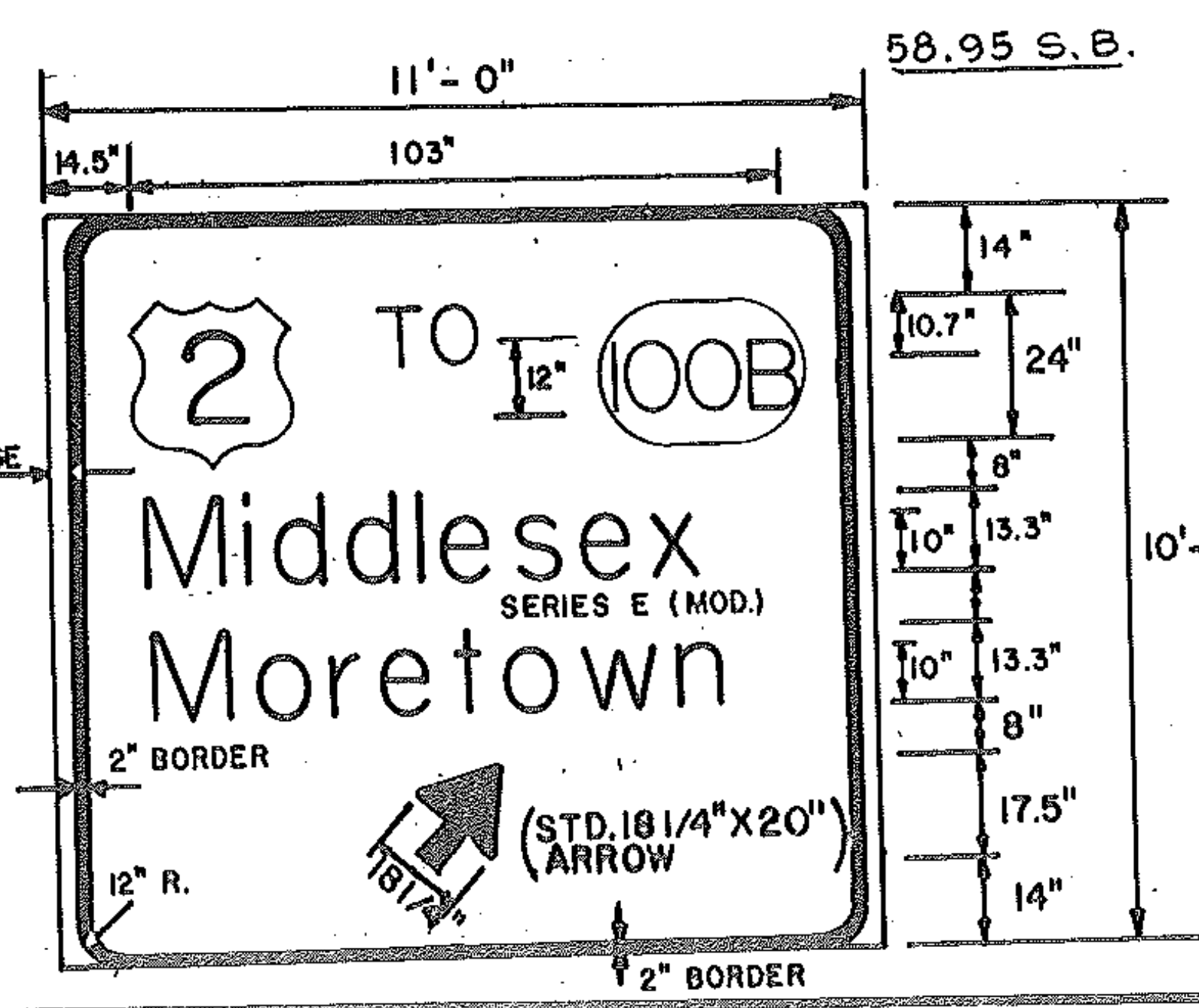

COLORS:
 TEXT, SYMBOLS, ARROW AND BORDER - WHITE, HIGH INTENSITY
 BACKGROUND - GREEN, REFLECT.
 SHIELD NUMERALS - BLACK

NOTE: MODIFICATION OF STANDARD E-14
 PLYWOOD AND ACRYLIC PLASTIC REFLECTORS WILL NOT BE ALLOWED FOR USE ON TYPE "B" SIGNS.

- LEGEND**
- [] EXISTING SIGN & POST
 - RET. RETAIN
 - R. REMOVE
 - SALV. SALVAGE
 - [] N NEW SIGN & POST

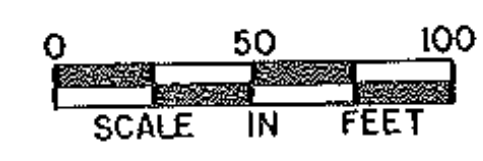
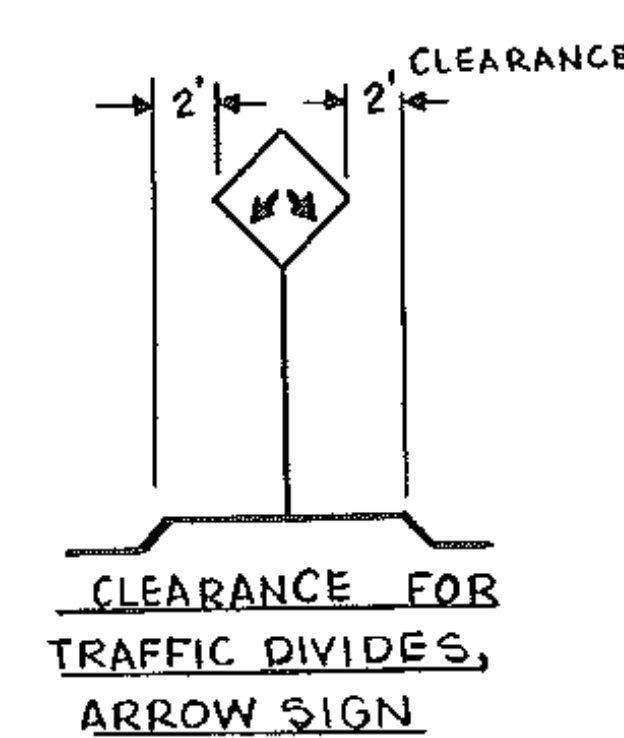

INTERCHANGE #9

SURVEYED BY _____ DATE _____
 DRAWN BY _____ DATE _____
 TRACED BY C. MURDOCK DATE 7-85

MIDDLESEX - WATERBURY
 PROJ. 1R NO 089-2(6)
 SHEET 9 OF 34

DATUM
 VERTICAL _____
 HORIZONTAL _____

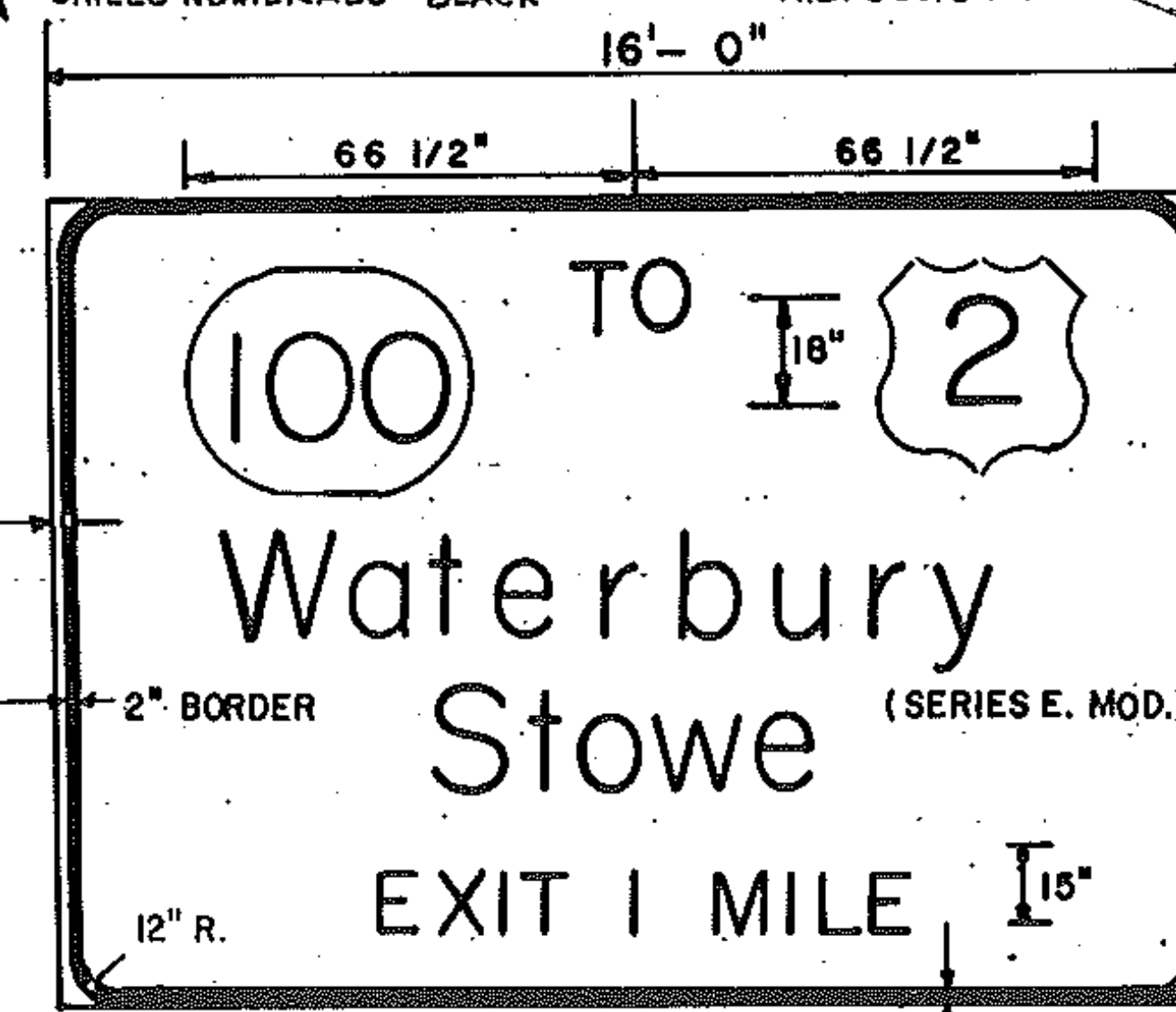
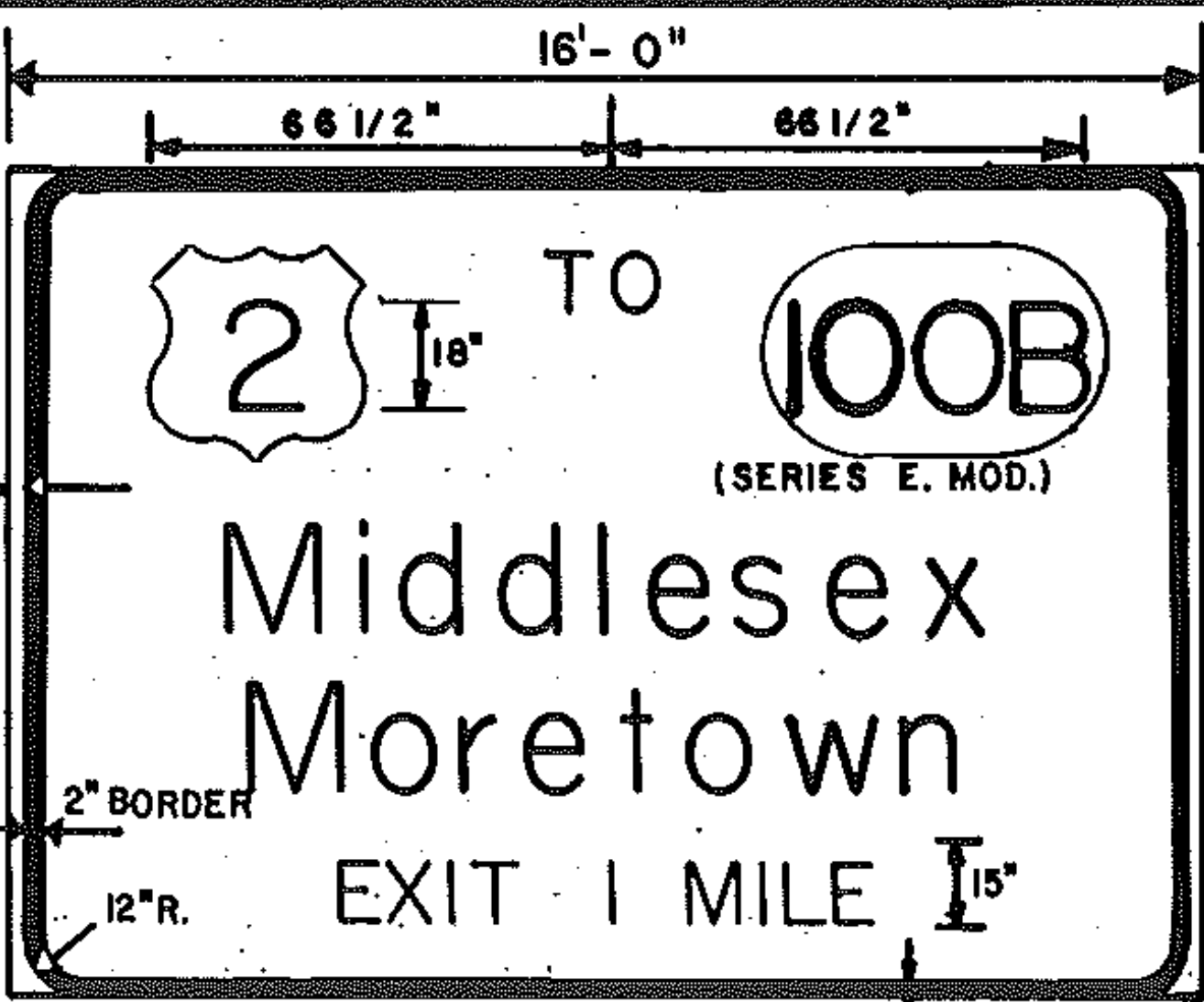

THESE TWO SIGNS SHALL HAVE "SEIBULITE" BRAND, ULTRALITE GRADE, LEGEND, BACKGROUND AND BORDERS. THIS MATERIAL IS TO BE USED UNDER A CATEGORY II WORK PLAN. (SEE SPECIAL PROVISIONS)

NOTE: MODIFICATION OF STANDARD R-14 PLYWOOD AND ACRYLIC PLASTIC REFLECTORS WILL NOT BE ALLOWED FOR USE ON TYPE "B" SIGNS.

COLORS: TEXT, SHIELDS AND BORDER - WHITE
BACKGROUND - GREEN
SHIELD NUMERALS - BLACK

FOR SIGNING IN INTERCHANGE AREA SEE SHEETS 9, 12 & 13 (SIGNS 58.70 NB LT. & RT., (A-1 AND (D-1 THRU D-10

THE "EXIT - " AND "NEXT EXIT - MILES" SIGNS WHICH ACCOMPANY THE TWO ABOVE PARENT SIGNS WILL HAVE LEGEND AND BACKGROUND OF 3M ENCAPSULATED LENS SHEETING FOR COMPARISON PURPOSES.

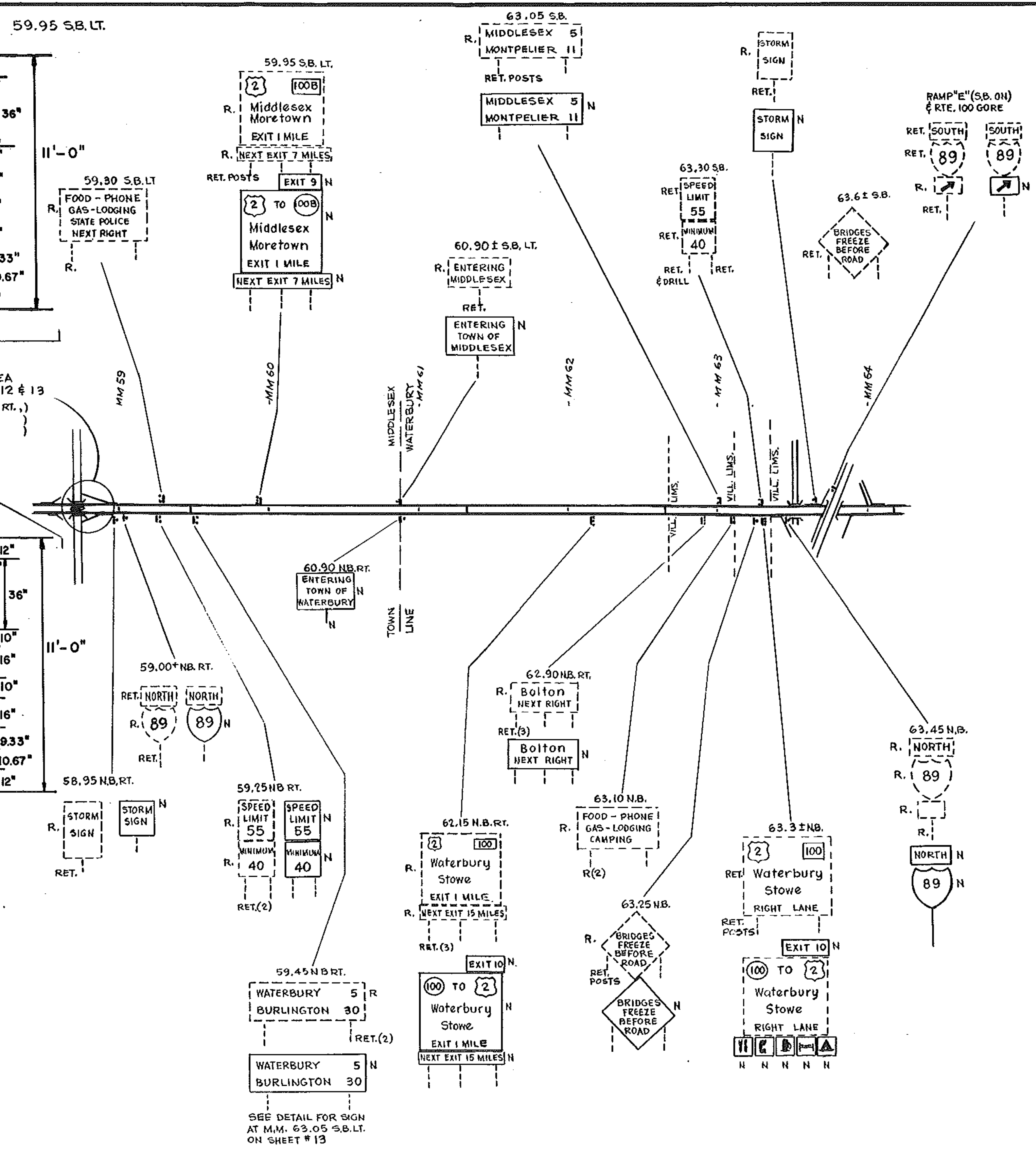

LEGEND

EXISTING
RET. RETAIN
R. REMOVE
SALV. SALVAGE
N NEW

MAINLINE SIGNING

SURVEYED BY _____ DATE _____
DRAWN BY S.M. DATE 8/7/85
TRACED BY _____ DATE _____

MIDDLESEX -
WATERBURY
PROJ. IR NO. 089-2(6)
SHEET 10 OF 34

DATUM

VERTICAL _____

HORIZONTAL _____

SEE DETAIL FOR SIGN AT M.M. 63.05 S.B.LT. ON SHEET # 13

NOTES:

When working at or near the exit or entrance ramps, Uniformed Traffic Officers shall be used to assist in controlling traffic. Lane closure signs shall be installed on entrance ramps.

Exit ramps shall have traffic lanes delineated with 28" cones to indicate desired vehicle path. Taper lengths shall be at least 320 feet. Cone spacing shall be 40 feet.

Cones shall be weighted at the base to prevent overturning and kept clean. Signs H-1 and H-3 will be in conformity with Standard E-2. All others will be moveable and will be removed during non-working hours.

During periods of poor visibility, steady burn yellow lights mounted on Channelizing Devices will be used in place of cones.

All signs will be placed before any work is begun or equipment put on roadway.

Contractor shall have Chan. Devices and signs for left side closure and right side closure on project before starting construction.

Work crews' private vehicles will not be parked in or around working area. Contractor will provide parking for work crews' vehicles off project.

Uniformed Traffic Officers will park their vehicles on the shoulder away from traffic.

Existing speed limit signs in reduced speed area will be ~~NOT BE PERMITTED~~

Channelizing devices other than cones or type III barricades (and) will be allowed as long as they conform to the MUTCD and are approved for use by the Resident Engineer in other than taper areas.

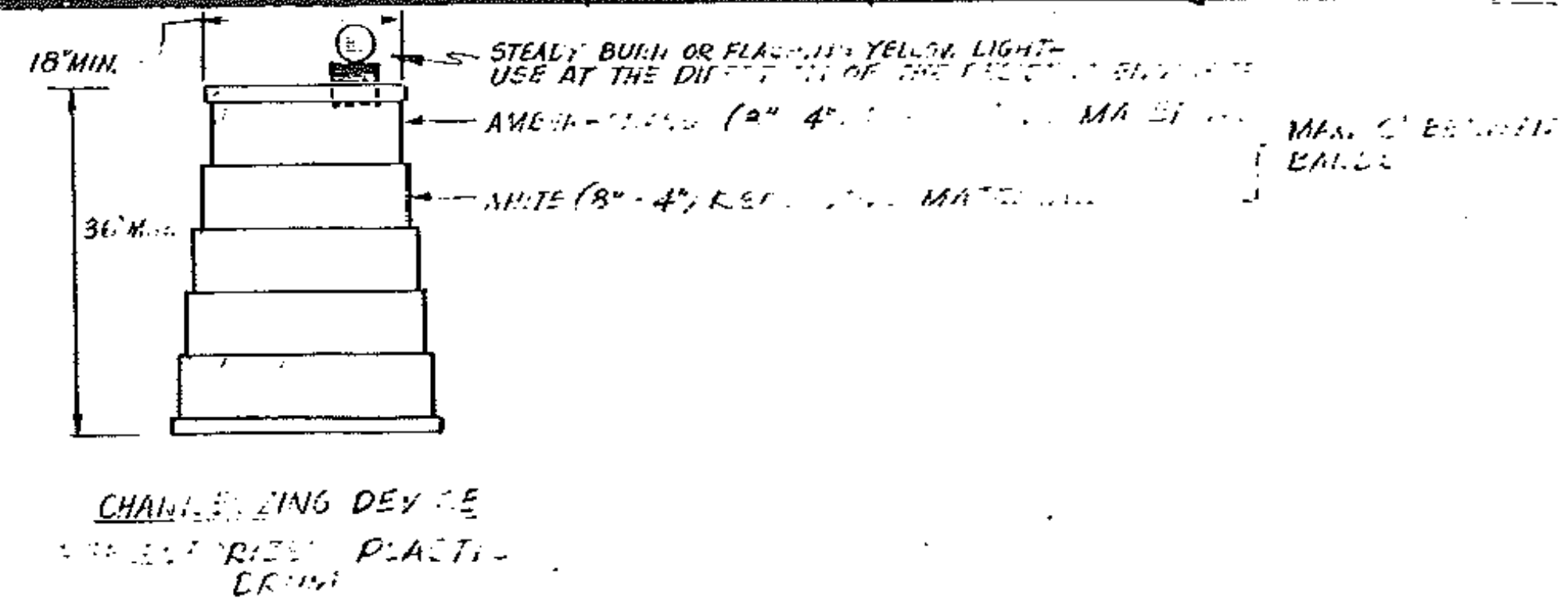

CHANNELIZING DEVICE
REFLECTORIZED PLASTIC DRUM

Flashing Arrow Board (48"x96" minimum size)
To be placed at end of 600' taper. The flashing arrow shall be mounted on a breakaway or yielding system.

SIGN H-1
SEE STANDARD SHEET E-2

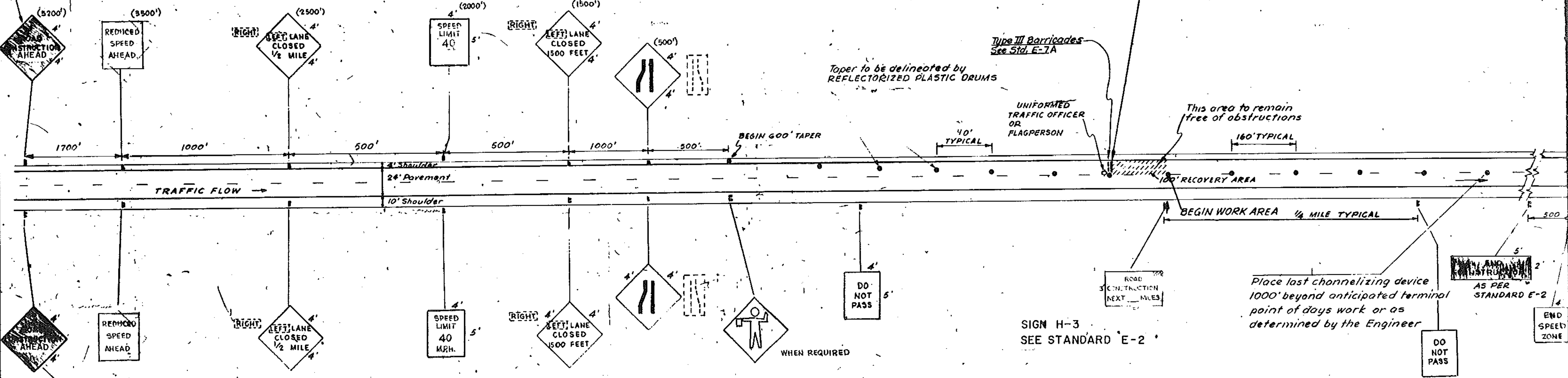

Type III Barricades
See Std. E-7A

Taper to be delineated by REFLECTORIZED PLASTIC DRUMS

UNIFORMED TRAFFIC OFFICER OR FLAGPERSON

This area to remain free of obstructions

BEGIN WORK AREA 1/4 MILE TYPICAL

Place last channelizing device 1000' beyond anticipated terminal point of days work or as determined by the Engineer

SIGN H-3
SEE STANDARD E-2

USE "LANE CLOSED 1 MILE" SIGN WHEN SIGN PACKAGE IS MOVED FORWARD.

"SPEED LIMIT 40" to be installed at 1/2 mile increments for entire work area. "DO NOT PASS" signs will be erected immediately in advance of, and throughout, the length of the work area, halfway between adjacent speed limit signs

Refer to Project Special Provisions for speed zone enactment. Refer to Uniform Traffic Control Devices Manual for tapers not in the speed zone area.

The "SPEED LIMIT 40", "DO NOT PASS" and "END SPEED ZONE" signs shall be located to the left hand side of the road when work is being done on the right-hand lane.

The "SPEED LIMIT 40" and other related signs shall be removed or covered when work is not in progress.

APPLICATION OF TAPE TO SIGN FACES WILL NOT BE PERMITTED.

NOT TO SCALE

NOTE: SHADED SIGNS INDICATED STATIONARY PROJECT SIGNS. PROJECT SIGNS TO REMAINING SIGNS. PROCESS FORWARD AT THE BEGINNING OF EACH WORK DAY.

DATUM	
VERTICAL	_____
HORIZONTAL	_____



MAINLINE TRAFFIC CONTROL PLAN	
SURVEYED BY	DATE
DRAWN BY	DATE
TRACED BY	DATE
MIDDLESEX - WATERBURY	
PROJ. I.R. NO. 089-2(6)	
SHEET 14 OF 34	

REV. 12/4/84 CHANGED SIGN SEQUENCE, SPACING, ADDED CHAN. DEVICE.
REV. 3/27/84 NOTES ADDED RE. SUBSTITUTION FOR BARRICADES.

SECTION 641 TRAFFIC SIGNS SUMMARY SHEET

MAINLINE PAVING

RAMP PAVING

IDENTIFICATION	NUMBER OF SIGNS	SIZE		TEXT	FOR SIGN DETAIL SEE STANDARD OR SHEET NUMBER
		WIDTH	HEIGHT		
	2	4	4	LEFT LANE CLOSED 1 MILE	E-8
	6 <i>OR AS REQUIRED</i>	18"	8"	RIGHT	E-8
	2	4	4	LEFT LANE CLOSED 1/2 MILE	E-8
	2	4	5	REDUCED SPEED AHEAD	THIS SHEET
	2 <i>OR AS REQUIRED</i>	4	4	LEFT LANE CLOSED 1500 FEET	E-8
	2	4	4		E-8
	2	4	4		E-8
	AS REQUIRED	4	5	DO NOT PASS	THIS SHEET
	AS REQUIRED	4	5	SPEED LIMIT 40	E-15B
	1	4	5	END SPEED ZONE	THIS SHEET
	AS REQUIRED	4	4	CAUTION PAVEMENT CHANGE	SEE E-6 FOR MATERIALS, ETC. THIS SHEET
	AS REQUIRED	4	4	BUMP	SEE E-6 FOR MATERIALS, ETC. THIS SHEET
	2	4	4	ROAD CONSTRUCTION AHEAD	E-2
	2	5	3	ROAD CONSTRUCTION NEXT ----- MILES	E-2
	1	4	4		E-6
	AS REQUIRED	4	4	HIGH OR LOW SHOULDER	THIS SHEET

IDENTIFICATION	NUMBER OF SIGNS	SIZE		TEXT	FOR SIGN DETAIL SEE STANDARD OR SHEET NUMBER
		WIDTH	HEIGHT		
	AS REQUIRED	4	4	LEFT LANE CLOSED AHEAD	E-8
	AS REQUIRED	18"	8"	RIGHT	E-8
	AS REQUIRED	4	4		E-6

SIGN NOTES: TRAFFIC SIGNS SHOWN ON THIS SHEET ARE TO BE SUBSIDIARY TO ITEM 641, TRAFFIC CONTROL. ADDITIONAL SIGNS, IF REQUIRED THAT ARE NOT DETAILED WILL BE PAID AS ITEM 675.20 OR 675.25 AS DIRECTED BY THE ENGINEER IF ITEMS ARE PART OF THE CONTRACT. PROJECT SIGNS AS PER STANDARD E-2 AND E-6 WILL BE REQUIRED TO ESTABLISH PROJECT LIMITS AND AS RAMP SIGNING. SIGNS SHALL BE ERECTED ON FLANGED CHANNEL STEEL POSTS*

* SIZE = 3 LBS/FT - MAXIMUM

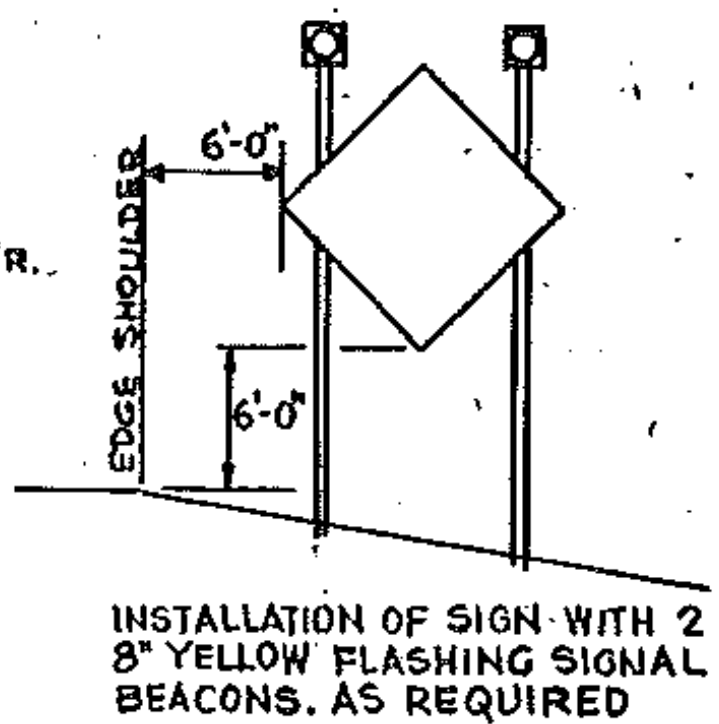
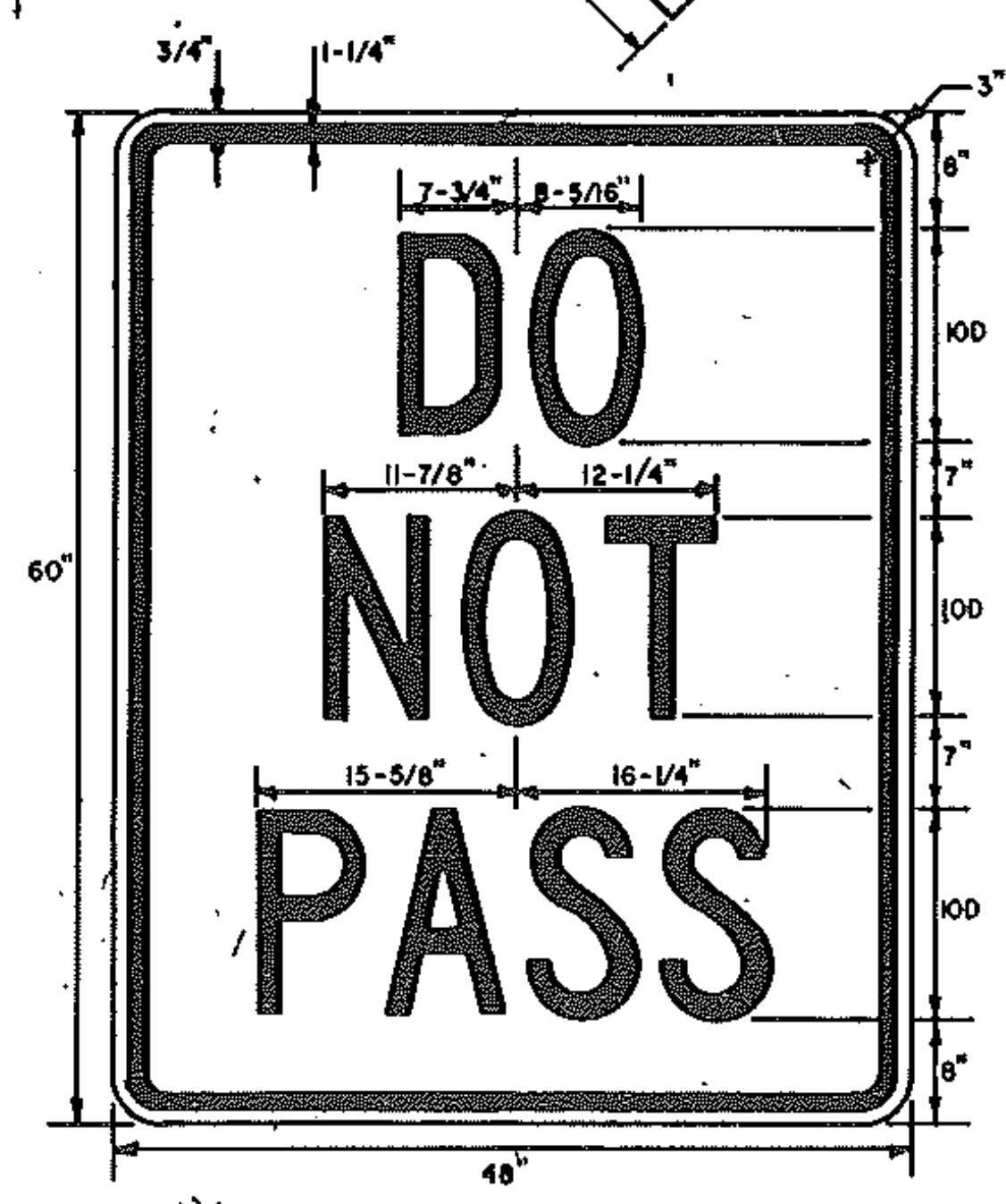
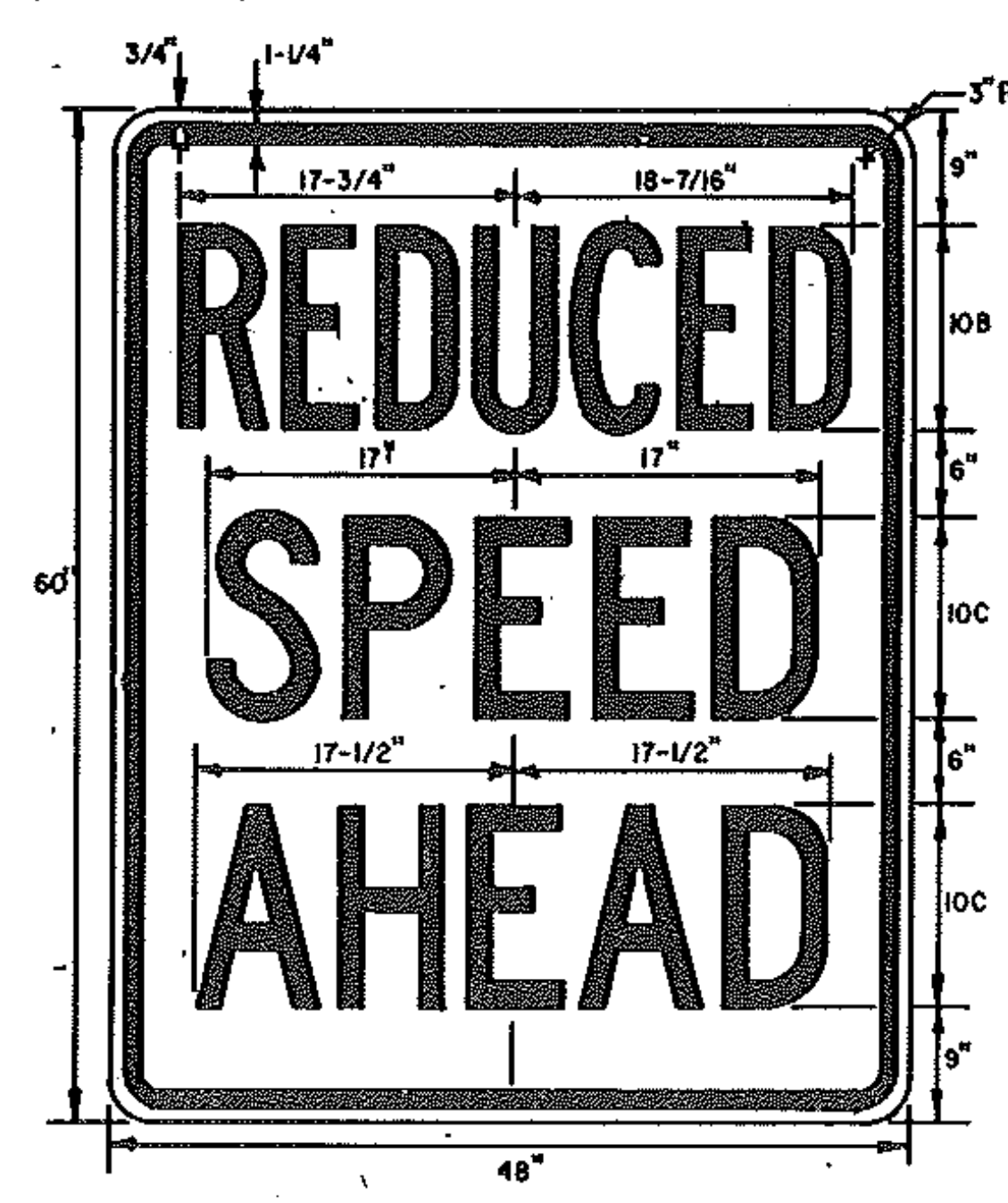
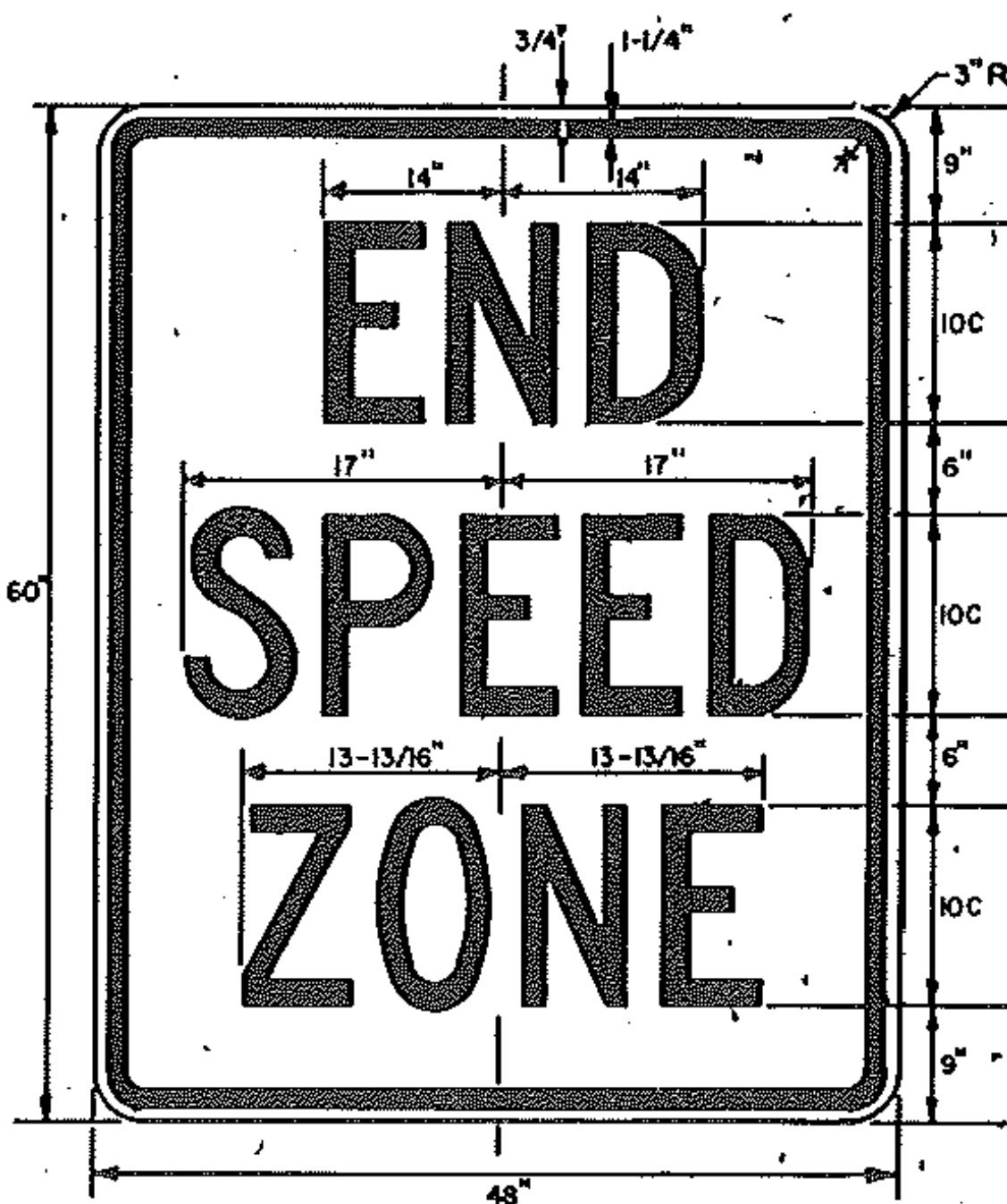
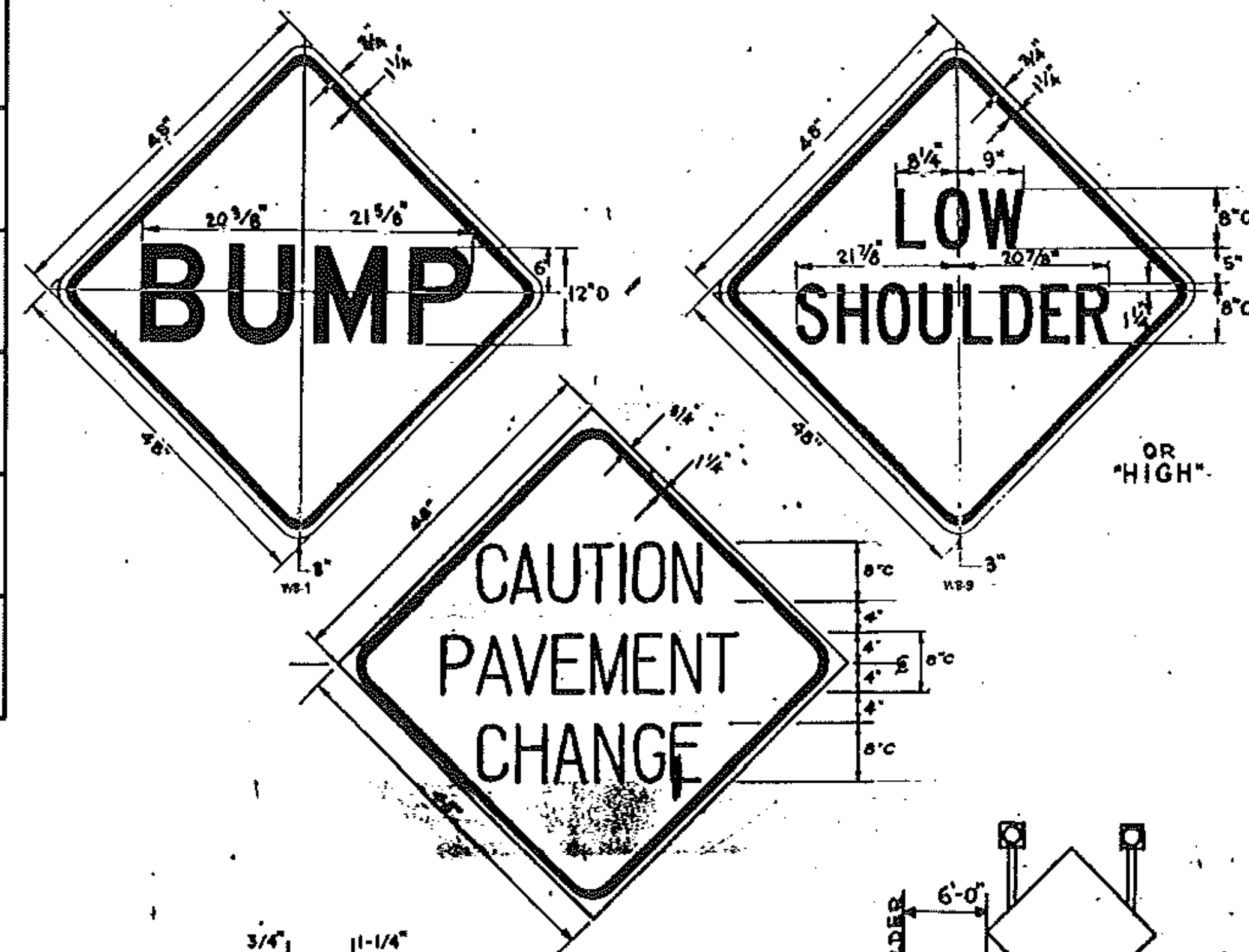

COLORS: LEGEND - BLACK (NON-REFLECTORIZED) BACKGROUND - WHITE (REFLECTORIZED) (SEE STANDARD SHEET E-15B FOR MATERIAL SPECIFICATIONS)

STANDARD E-2 LISTED FOR SIGN DETAIL ONLY, NOT MAINLINE PROJECT SIGNING.

SECTION 641 TRAFFIC SIGN SUMMARY SHEET MAINLINE TRAFFIC CONTROL PLAN	SURVEYED BY _____ DATE _____ DRAWN BY RPR DATE 2-82 TRACED BY LCG DATE 6-82 MIDDLESEX - WATERBURY PROJ. IR NO 089-2(6) SHEET 15 OF 34
---	--

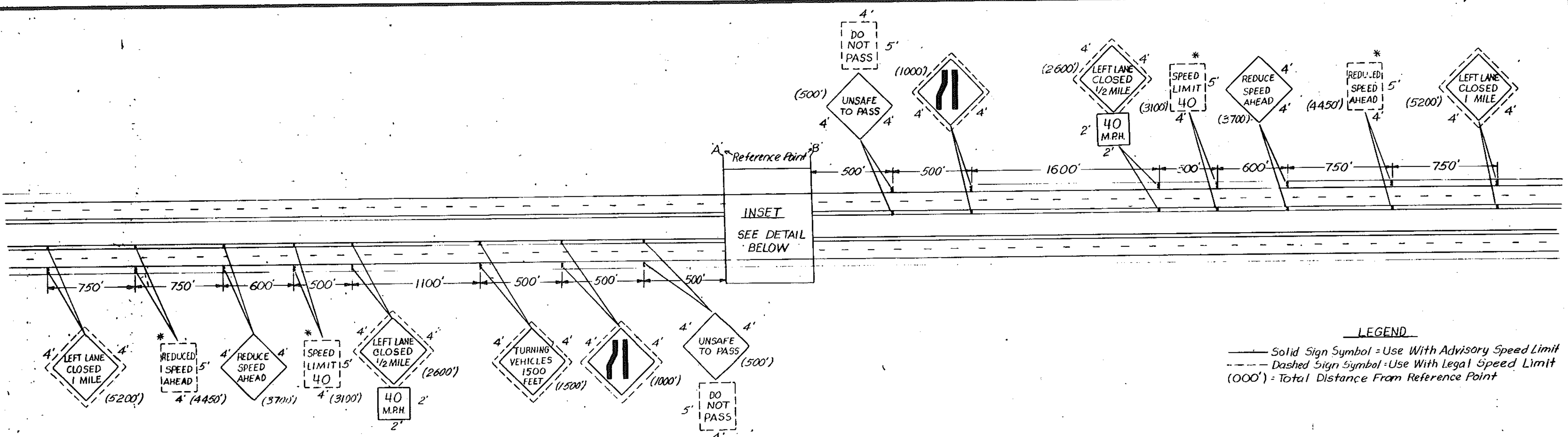

LEGEND
 ——— Solid Sign Symbol = Use With Advisory Speed Limit
 - - - - Dashed Sign Symbol = Use With Legal Speed Limit
 (000') = Total Distance From Reference Point

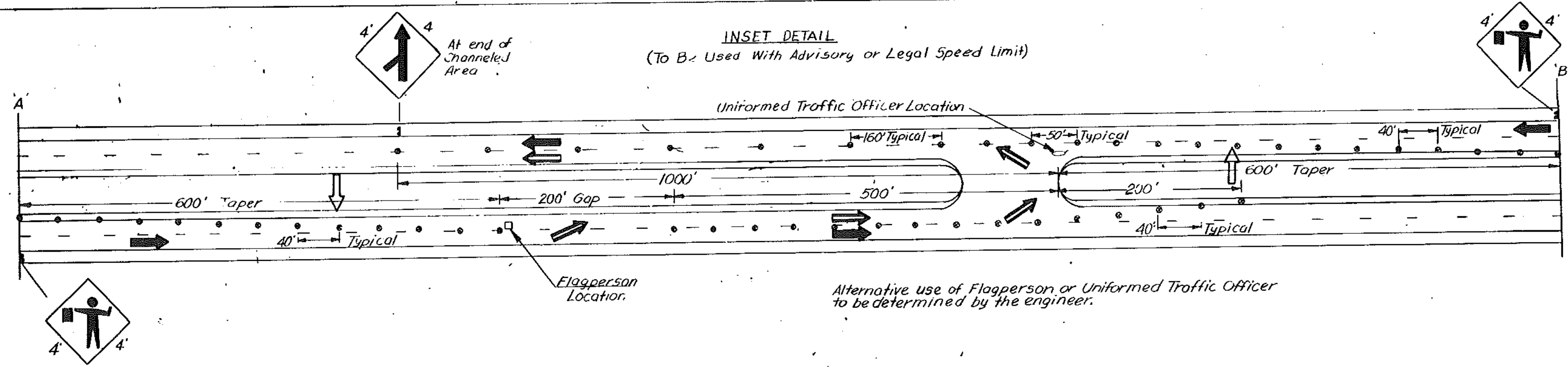

* Legal Speed Limit Reductions must be approved by the STATE TRAFFIC COMMITTEE prior to sign erection. Requests may be made prior to the Preconstruction Conference.

When signing for this operation interferes with that for work on the mainline, revisions may be made. The Resident Engineer will establish the appropriate sign requirements.

LEGEND
 → = Through Traffic
 → = Construction Vehicles
 ⊙ = Channelizing Device
 → = FLASHING ARROW PANEL
 NOT TO SCALE

TRAFFIC CONTROL TYPICAL FOR CONSTRUCTION VEHICLE TURNING		SURVEYED BY _____ DATE _____
		DRAWN BY <u>J.B.</u> DATE <u>3-15-85</u>
		TRACED BY _____ DATE _____
		MIDDLESEX - WATERBURY PROJ. IR NO. 089-2(0)
		SHEET 16 OF 34

DATUM	DATE 7/17/85
VERTICAL _____	FLASHING PANEL
HORIZONTAL _____	

SECTION

TRAFFIC SIGN SUMMARY SHEET

SIGN NOTES: THESE SIGNS ARE SUBSIDIARY TO OTHER ITEMS.

SIGNS SHALL BE ERECTED ON FLANGED CHANNEL STEEL POSTS. AT LEAST 6 FEET OUTSIDE THE SHOULDER POINT OR 2 FEET OUTSIDE GUARD RAIL, SIGNS FOR TEMPORARY USE MAY BE MOUNTED ON APPROVED PORTABLE SUPPORTS. THE SIGN SHALL BE MOUNTED SO THAT THE BOTTOM OF THE SIGN WILL BE AT LEAST 1 FOOT ABOVE ROAD LEVEL. THE INSTALLATION AND MAINTENANCE OF ALL SIGNS SHALL BE SUBJECT TO THE APPROVAL OF THE ENGINEER.

* 3 LBS./FT. - MAXIMUM

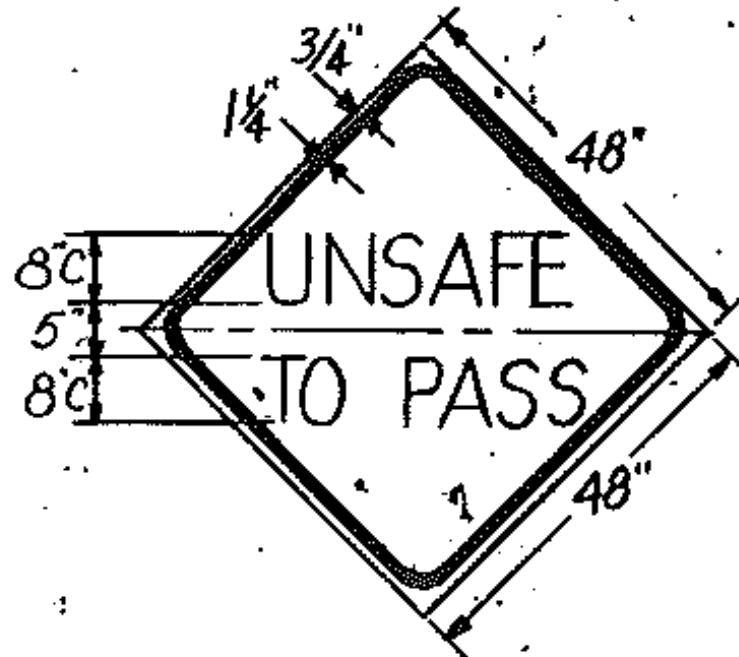
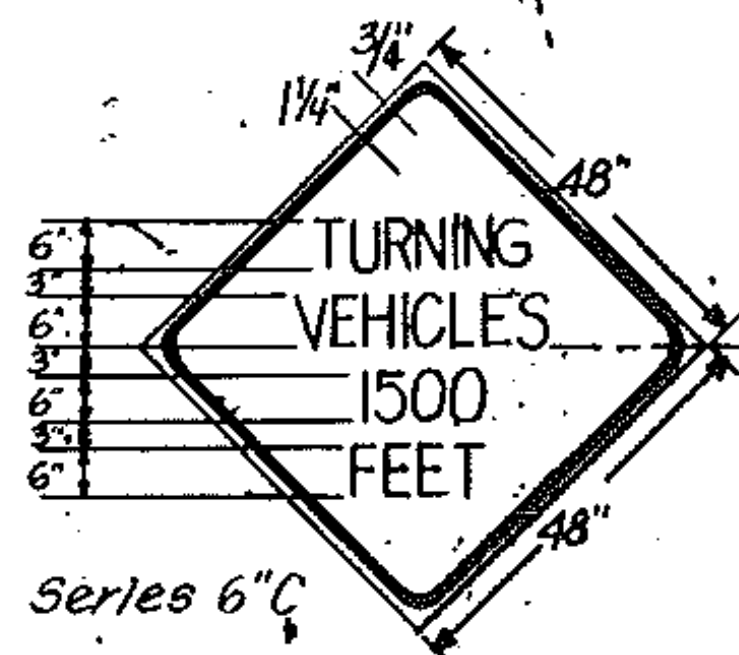
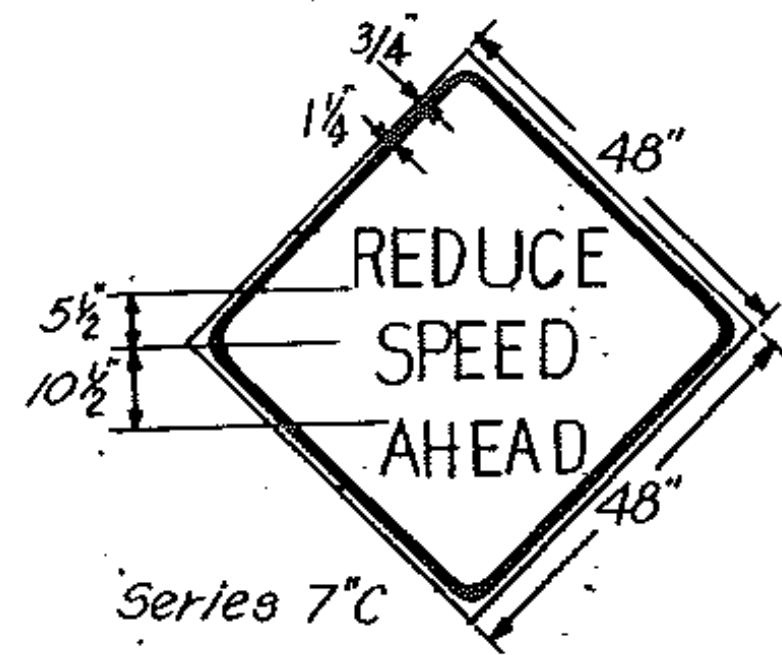

IDENTIFICATION	NUMBER OF SIGNS	SIZE		TEXT	FOR SIGN DETAIL SEE STANDARD OR SHEET NUMBER
		WIDTH	HEIGHT		
	4	4	4	LEFT LANE CLOSED 1 MILE RIGHT	E-8
	4	4	4	LEFT LANE CLOSED 1/2 MILE RIGHT	E-8
	1	4	4	TURNING VEHICLES 1500 FEET	THIS SHEET
	2	4	4		E-8
	2	4	4		E-6
	1	4	4		E-19
	2	4	4	REDUCE SPEED AHEAD	THIS SHEET
	2	2	2	40 MPH	E-8
	4	4	4	UNSAFE TO PASS	THIS SHEET
	2	4	5	REDUCED SPEED AHEAD	THIS SHEET
	2	4	5	SPEED LIMIT 40	E-15B
	2	4	5	DO NOT PASS	E-15A

ADVISORY

LEGAL

BORDER & LEGEND - BLACK (NON-REFL.)
BACKGROUND - ORANGE (REFL.-HIGH INT.)
FOR MATERIAL SPECS, SEE STD. E-8
(APPLIES TO ALL SIGN DETAILS ABOVE)

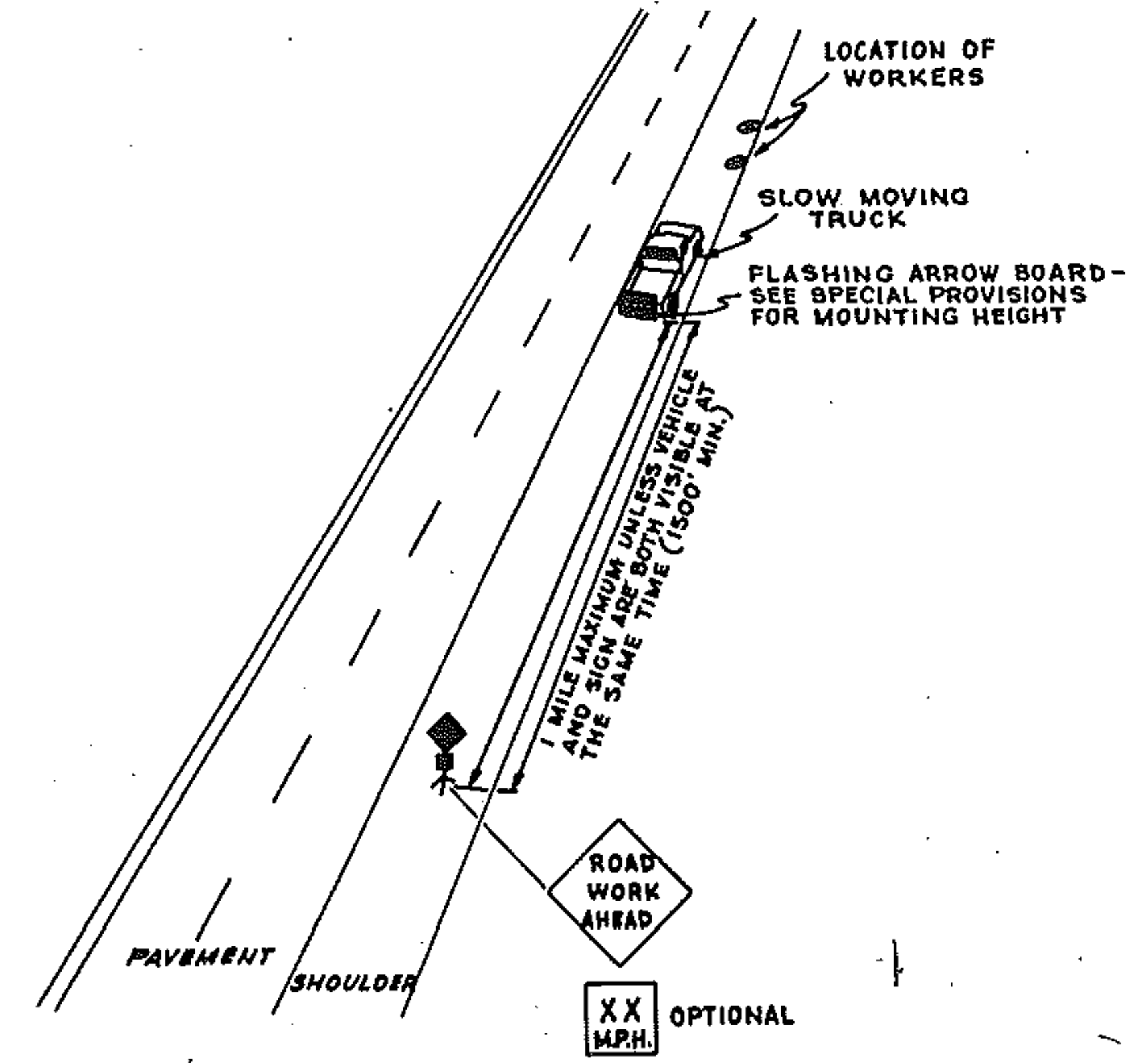

MOVING OPERATION LANE CLOSURE (Delineator Placement)

When delineators are being placed adjacent to the 4' shoulder the operation must be additionally protected by the standard "LEFT LANE CLOSED" sign package. The Contractor may elect to perform such work when the left lane is closed for other purposes.

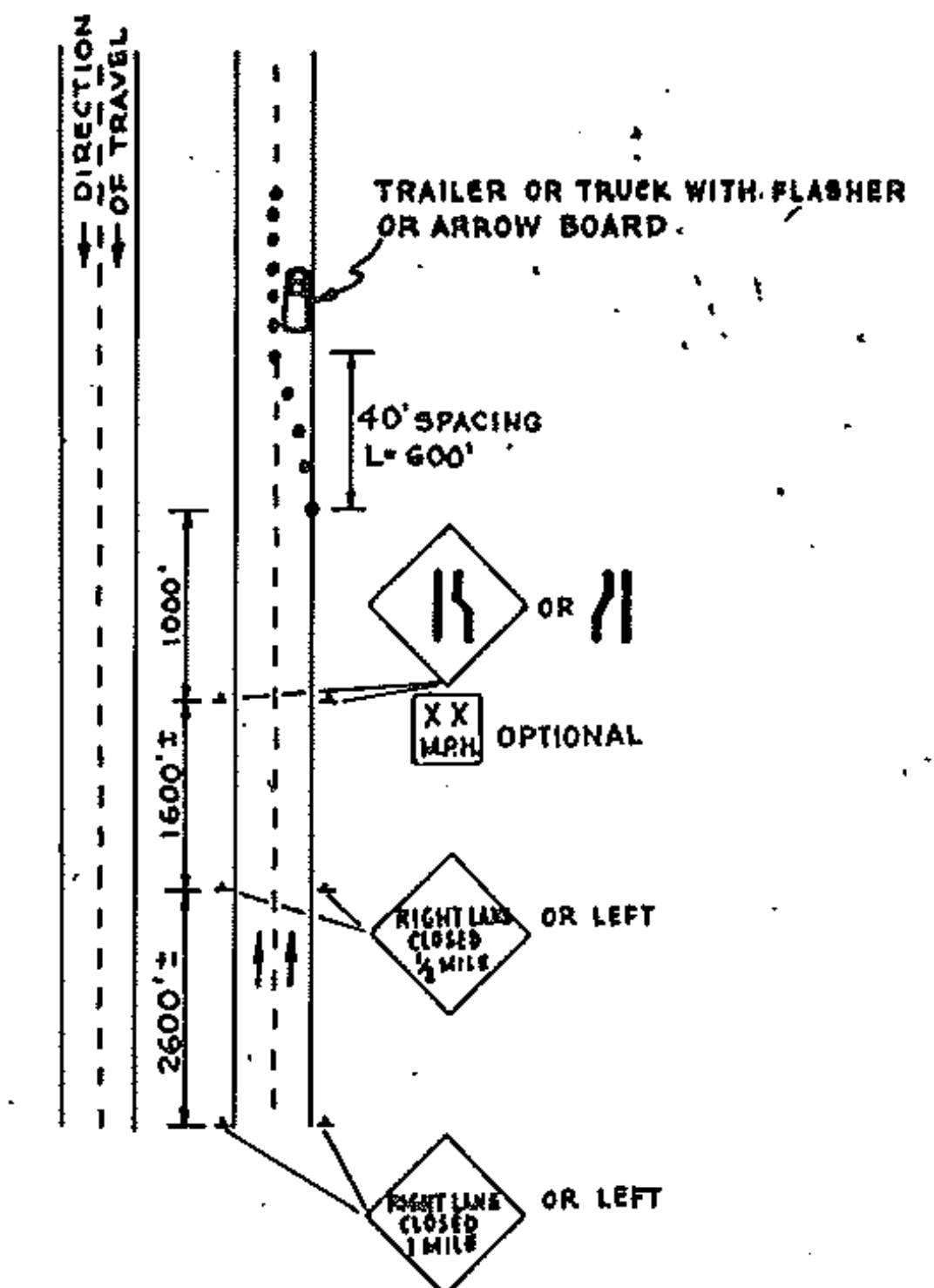

Typical application - daytime maintenance operations of short duration on a four-lane divided roadway where one lane is closed. To be used for bridge work where concern for legal speed zone signing is not a problem (low volume - adequate sight distance).

SIGN SUMMARY	SURVEYED BY _____	DATE _____
	DRAWN BY <u>JL</u>	DATE <u>3-15-85</u>
	TRACED BY _____	DATE _____
CONST. VEHICLE TURNING	MIDDLESEX - WATERBURY PROJ. I.R. NO. 089-2(4)	
	SHEET 17 OF 34	

