

INDEX OF SHEETS

1. TITLE PAGE
  2. CONSTRUCTION WARNING SIGNS
  3. E.31 FEDERAL AID CONSTRUCTION IDENTIFICATION SIGNS
  4. J.3 MINIMUM PLANTING DISTANCES
  5. J.5 BRACING OF TREES
  6. QUANTITY SHEET
- 7-14. PLAN SHEETS

STATE OF VERMONT  
DEPARTMENT OF HIGHWAYS

PROPOSED IMPROVEMENT  
INTERSTATE LANDSCAPE PROJECT  
TOWNS OF WEATHERSFIELD-WINDSOR-HARTLAND  
COUNTY OF WINDSOR  
INTERSTATE ROUTE 91  
BRATTLEBORO-WHITE RIVER JCT. ROAD

BEGINNING AT A POINT 1.700 MILES SOUTHERLY OF THE WEATHERSFIELD-WINDSOR TOWN LINE AND EXTENDING NORTHERLY 9.002 MILES

LENGTH OF PROJECT 9.002 MILES  
LENGTH OF PROJECT 47,529.77 FEET

NOTE:  
THE SPECIFIC LOCATION OF EACH SHRUB AND TREE WILL BE MADE BY THE STATE LANDSCAPE ENGINEER IN THE FIELD PRIOR TO ANY PLANTING BEING PERFORMED BY THE CONTRACTOR. SUCH LOCATIONS WILL BE IN ACCORDANCE WITH THE 1959 "GUIDE FOR SHOWING ROADSIDE IMPROVEMENTS ON PROJECT PLANS," THE 1961 A.A.S.H.O. PUBLICATION "A POLICY ON LANDSCAPE DEVELOPMENT FOR THE NATIONAL SYSTEM OF INTERSTATE AND DEFENSE HIGHWAYS," AND ANY OTHER SUPPLEMENTARY LOCATION REQUIREMENTS WHICH ARE NOW OR MAY BECOME EFFECTIVE.

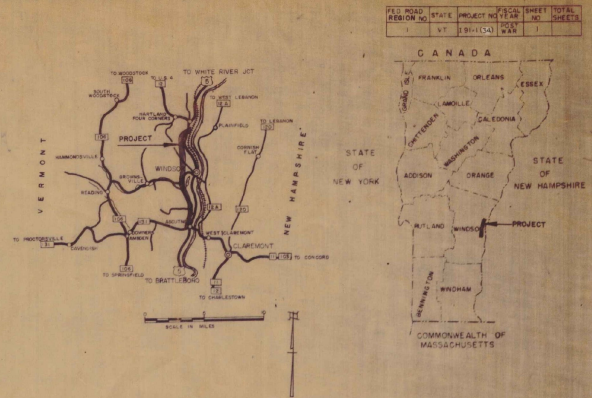

PROJECT NAME & NUMBER  
WEATHERSFIELD-WINDSOR-HARTLAND I 91-1(34)  
RECORD PLANS - MATERIALS  
BIGELOW NURSERIES, NORTHBORO, MASS.  
BAKEN NURSERY, INC., TARIFFVILLE, CONN.

CONTRACTOR - MCCARTHY'S TREE LANDSCAPING AND SPRAYING SERVICE, NORTH ADAMS, MASS.  
RESIDENT ENGINEER - F.R. MCGOY  
RECORD PLANS - L.R. MASURE  
CONTRACT DATED - 12/13/66  
STARTED - 5/8/67  
COMPLETED - 7/12/68  
ACCEPTED - 7/12/68

WEATHERSFIELD-WINDSOR-HARTLAND I 91-1(34)  
CONTRACTOR - MCCARTHY'S TREE LANDSCAPING & SPRAYING SERVICE, NORTH ADAMS, MASS.  
CONSTR. COMP. - JULY 12, 1968  
RECORD PLANS - L. R. MASURE



CONVENTIONAL SIGNS

COUNTY LINE	---
TOWN LINE	----
FENCE LINE	.....
STONE WALL	-----
UNFENCED PROPERTY	.....
GUARD RAIL	-----
TRAVELED WAY	-----
RAILROAD	-----
RETAINING WALL	-----
CENTER LINE	-----
SURVEY LINE	-----
QUILT	-----
DROP INLET	-----
TROWLEY POLE	-----
POWER POLE	-----
TELEPHONE POLE	-----
TREES	-----
WEDGE	-----

CURVE DATA		F A CONSTRUCTION IDENTIFICATION SIGNS - A	
DEFLECTION OF ANGLE	D	TITLE	SCALE
DEGREE OF CURVE <td>D</td> <td>TYPICAL <td>1" = 2000'</td> </td>	D	TYPICAL <td>1" = 2000'</td>	1" = 2000'
RADIUS OF CURVE <td>R</td> <td>PLAN <td>1" = 20'</td> </td>	R	PLAN <td>1" = 20'</td>	1" = 20'
TANGENT DISTANCE <td>T</td> <td>PROFILE HORIZONTAL <td>1" = 1"</td> </td>	T	PROFILE HORIZONTAL <td>1" = 1"</td>	1" = 1"
LENGTH OF CURVE <td>L</td> <td>VERTICAL <td>1" = 1"</td> </td>	L	VERTICAL <td>1" = 1"</td>	1" = 1"
EXTERNAL DISTANCE <td>E</td> <td>GROSS SECTIONS <td>1" = 1"</td> </td>	E	GROSS SECTIONS <td>1" = 1"</td>	1" = 1"
POINT OF INTERSECTION <td>PI</td> <td></td> <td></td>	PI		
POINT OF CURVE <td>PC</td> <td></td> <td></td>	PC		
POINT OF TANGENT <td>PT</td> <td></td> <td></td>	PT		
POINT ON TANGENT <td>POT</td> <td></td> <td></td>	POT		
POINT ON SUB-TANGENT <td>POS</td> <td></td> <td></td>	POS		

THESE PLANS ARE SUBJECT TO SUCH REVISIONS AS MAY BE REQUIRED BY THE BUREAU OF PUBLIC ROADS OR THE COMMISSIONER OF HIGHWAYS.  
CONSTRUCTION IS TO BE CARRIED ON IN ACCORDANCE WITH THESE PLANS AND THE STANDARD SPECIFICATIONS FOR HIGHWAY AND BRIDGE CONSTRUCTION DATED APRIL, 1964, AS APPROVED BY THE BUREAU OF PUBLIC ROADS ON OCTOBER 12, 1964, INCLUDING ALL SUBSEQUENT APPROVED REVISIONS AND SUCH REVISED SPECIFICATIONS AND SPECIAL PROVISIONS AS ARE INCORPORATED IN THESE PLANS.

DEPARTMENT OF COMMERCE BUREAU OF PUBLIC ROADS	
APPROVED	DATE
DIVISION ENGINEER	DATE
PROJECT I NO. 91-1(34)	
SHEET 1 OF 14 SHEETS	

APPROVED: <i>[Signature]</i> DISTRICT ENGINEER DATE: 7/9/66	APPROVED: <i>[Signature]</i> DISTRICT ENGINEER DATE: 7/14/66	APPROVED: <i>[Signature]</i> DISTRICT ENGINEER DATE: 7/7/66	APPROVED: <i>[Signature]</i> DISTRICT ENGINEER DATE: 7/28/66	APPROVED: <i>[Signature]</i> DISTRICT ENGINEER DATE: 9/12/66	APPROVED: <i>[Signature]</i> DISTRICT ENGINEER DATE: 7/28/66	APPROVED: <i>[Signature]</i> DISTRICT ENGINEER DATE: 9/12/66
---	--	---	--	--	--	--

INDEX OF SHEETS

1. TITLE PAGE
2. CONSTRUCTION WARNING SIGNS
3. E-31 FEDERAL AID CONSTRUCTION IDENTIFICATION SIGNS
4. J-3 MINIMUM PLANTING DISTANCES
5. J-5 BRACING OF TREES
6. QUANTITY SHEET
- 7-14. PLAN SHEETS

Dated 13 November 1966  
McCarthy Inc., Landscape Planning Service  
330 Eagle Street, North Colton, Mass.  
Thomas L. McCarthy, Owner  
Contractor  
Thomas L. McCarthy  
 By Order of Commissioner of Highways  
 Commissioner of Highways

STATE OF VERMONT  
 DEPARTMENT OF HIGHWAYS

PROPOSED IMPROVEMENT

INTERSTATE LANDSCAPE PROJECT

TOWNS OF WEATHERSFIELD-WINDSOR-HARTLAND  
 COUNTY OF WINDSOR  
 INTERSTATE ROUTE 91  
 BRATTLEBORO-WHITE RIVER JCT. ROAD

BEGINNING AT A POINT 1.700 MILES SOUTHERLY OF THE  
 WEATHERSFIELD-WINDSOR TOWN LINE AND EXTENDING  
 NORTHERLY 9.002 MILES

LENGTH OF PROJECT 9.002 MILES  
 LENGTH OF PROJECT 47,529.77 FEET

NOTE:  
 THE SPECIFIC LOCATION OF EACH SHRUB AND TREE WILL BE MADE BY THE STATE  
 LANDSCAPE ENGINEER IN THE FIELD PRIOR TO ANY PLANTING BEING PERFORMED BY  
 THE CONTRACTOR. SUCH LOCATIONS WILL BE IN ACCORDANCE WITH THE 1959 "GUIDE  
 FOR SHOWING ROADSIDE IMPROVEMENTS ON PROJECT PLANS," THE 1961 A.A.S.H.O.  
 PUBLICATION "A POLICY ON LANDSCAPE DEVELOPMENT FOR THE NATIONAL SYSTEM OF  
 INTERSTATE AND DEFENSE HIGHWAYS," AND ANY OTHER SUPPLEMENTARY LOCATION REQUIREMENTS  
 WHICH ARE NOW OR MAY BECOME EFFECTIVE.

FILE NO.	STATE	PROJECT NO.	FILE NO.	SHEET NO.	TOTAL SHEETS
91-134	VT	91-134	1000	1	1

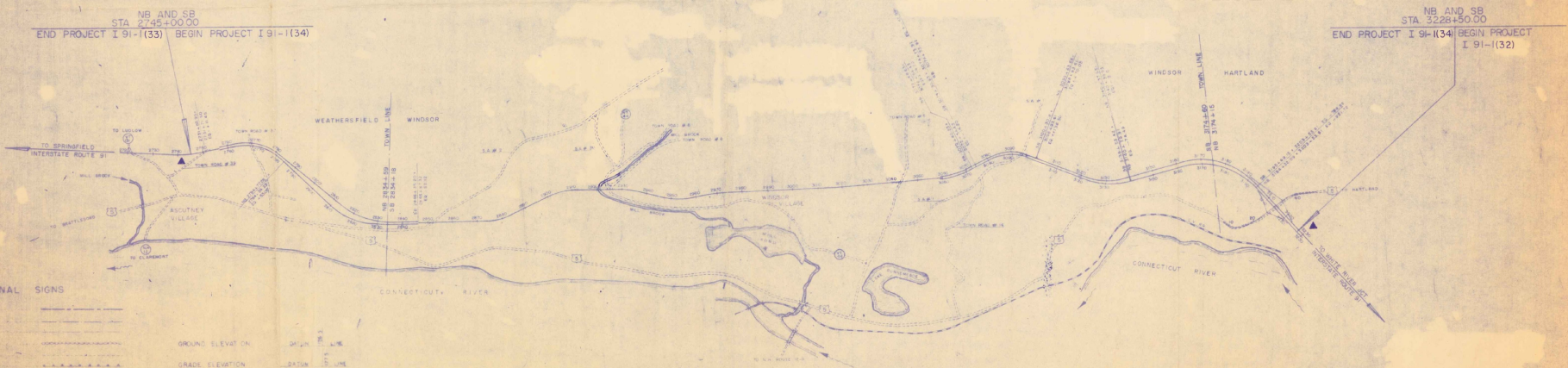
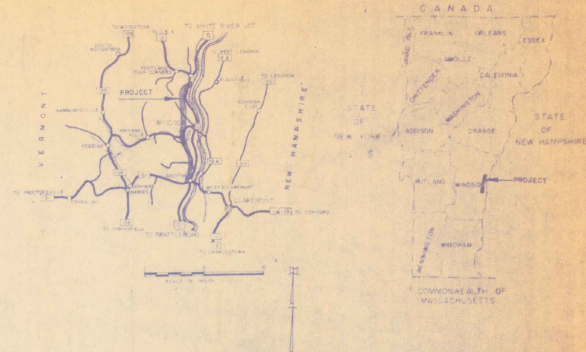

CONVENTIONAL SIGNS

COUNTY LINE	GROUND ELEVATION	SCALE
TOWN LINE	GRADE ELEVATION	DATE
FENCE LINE	CURVE DATA	DEFLECTION OF ANGLE
STONE WALL	DEFLECTION OF ANGLE	DEGREE OF CURVE
UNFENCED PROPERTY	FACUS OF CURVE	R
GUARD RAIL	TANGENT DISTANCE	T
TRAVELED WAY	LENGTH OF CURVE	L
RAILROAD	EXTERNAL DISTANCE	E
RETAINING WALL	POINT OF INTERSECTION	PI
CENTER LINE	POINT OF CURVE	PC
SURVEY LINE	POINT OF TANGENT	PT
GULVERT	POINT ON TANGENT	PO T
DROP INLET	POINT ON SUB-TANGENT	POST
TROLLEY POLE		
POWER POLE		
TELEPHONE POLE		
TREES		
HEDGE		

F A CONSTRUCTION IDENTIFICATION SIGNS

SCALES

TITLE	2000'
VERTICAL	"
PLAN	1" = 20'
PROFILE HORIZONTAL	"
VERTICAL	"
CROSS SECTIONS	"

THESE PLANS ARE SUBJECT TO SUCH REVISIONS AS MAY BE  
 REQUIRED BY THE BUREAU OF PUBLIC ROADS OF THE COMMISSIONER  
 OF HIGHWAYS.  
 CONSTRUCTION IS TO BE CARRIED ON IN ACCORDANCE WITH  
 THESE PLANS AND THE STANDARD SPECIFICATIONS FOR HIGHWAY AND BRIDGE  
 CONSTRUCTION DATED APRIL, 1964, AS APPROVED BY THE BUREAU OF  
 PUBLIC ROADS ON OCTOBER 12, 1964, INCLUDING ALL SUBSEQUENT  
 APPROVED REVISIONS AND SUCH REVISED SPECIFICATIONS AND SPECIAL  
 PROVISIONS AS ARE INCORPORATED IN THESE PLANS.

DEPARTMENT OF COMMERCE  
 BUREAU OF PUBLIC ROADS

APPROVED \_\_\_\_\_ DATE \_\_\_\_\_

DIVISION ENGINEER \_\_\_\_\_ DATE \_\_\_\_\_

PROJECT I NO. 91-134

SHEET 14 SHEETS

DIST. 2 APPROVED <u>RO Munn</u> DISTRICT ENGINEER DATE <u>9/17/66</u>	APPROVED <u>W J Donahat</u> DISTRICT ENGINEER DATE <u>7/17/66</u>	DIST. 4 APPROVED <u>W H Chase</u> DISTRICT ENGINEER DATE <u>7/17/66</u>	APPROVED <u>R Lumb</u> DISTRICT ENGINEER DATE <u>7/28/66</u>	APPROVED <u>C W Stebbins</u> ASST. CHIEF ENGINEER DATE <u>9/12/66</u>	APPROVED <u>G M Rowe</u> DISTRICT ENGINEER DATE <u>7/28/66</u>	APPROVED <u>R H Currier</u> DISTRICT ENGINEER DATE <u>9/12/66</u>
--	---	--	--	---	--	---

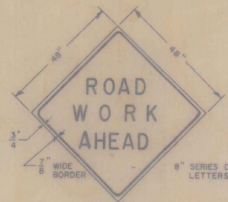

SIGN A  
BLACK ON YELLOW  
NON-REFLECTORIZED

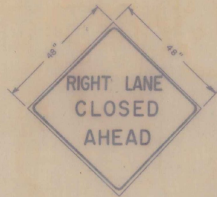

SIGN B  
BLACK ON YELLOW  
NON-REFLECTORIZED

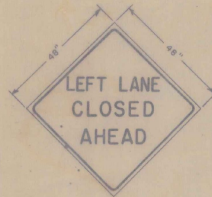

SIGN C  
BLACK ON YELLOW  
NON-REFLECTORIZED



THESE SIGNS CONFORM WITH THE NATIONAL STANDARDS SET FORTH IN THE UNIFORM MANUAL ON TRAFFIC CONTROL DEVICES (1961 EDITION) FOR CONSTRUCTION AND MAINTENANCE OPERATIONS. THEY ARE INTENDED FOR THE PROTECTION OF THE TRAVELING PUBLIC AS WELL AS THE CONTRACTOR'S FORCES. ON HIGH-SPEED EXPRESSWAYS IT IS ESSENTIAL THAT THE CONDITION OF THE SIGNS AND THE METHOD OF DISPLAYING THEM BE GIVEN MAXIMUM CONSIDERATION.

BECAUSE THE PLANTING OF LANDSCAPE MATERIAL IS A PROGRESSIVE OPERATION, THE SIGNS MUST BE MOVED PERIODICALLY IN ACCORDANCE WITH THE REQUIREMENTS NOTED ON THE PLANS OR ORDERED BY THE ENGINEER.

- ▲ SIGNS SHALL BE MOUNTED ON MOVEABLE STANDARDS.
- ▲ WHEN IN USE THEY SHALL BE LOCATED ON THE SHOULDER 4 FEET OUT FROM THE EDGE OF THE PAVEMENT.
- ▲ SIGNS AND CONES SHALL NOT BE LEFT IN PLACE ON THE SHOULDER OR PAVEMENT DURING PERIODS WHEN WORK IS NOT UNDER WAY.

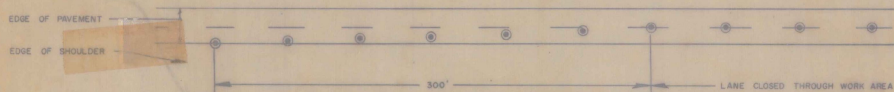

WHEN THE RIGHT LANE IS WHOLLY OR PARTIALLY CLOSED, 18" RUBBER CONES SPACED 50' APART SHALL BE USED IN ADVANCE OF AND THROUGH THE WORK AREA AS SHOWN ABOVE. THE CONES SHALL BE MOVED ALONG WITH THE FLAGMAN AS THE WORK PROGRESSES.

FIG. 2

THE SAME APPLIES TO THE LEFT HAND LANE WHEN IT IS WHOLLY OR PARTIALLY CLOSED.

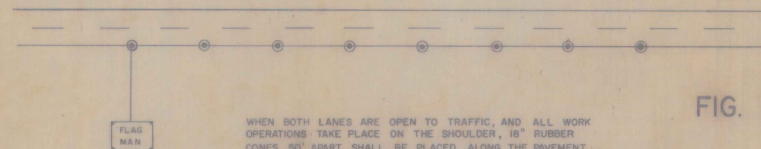

WHEN BOTH LANES ARE OPEN TO TRAFFIC, AND ALL WORK OPERATIONS TAKE PLACE ON THE SHOULDER, 18" RUBBER CONES 50' APART SHALL BE PLACED ALONG THE PAVEMENT EDGE THROUGH THE WORK AREA AS SHOWN ABOVE. THE CONES SHALL BE MOVED ALONG WITH THE FLAGMAN AS THE WORK PROGRESSES.

FIG. 3

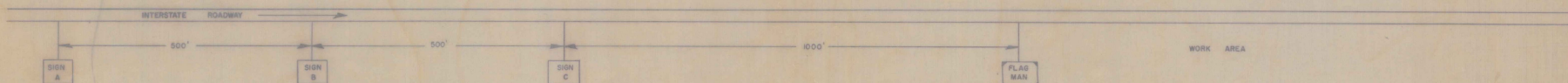

SIGN "B" TO BE USED ONLY IF THE RIGHT LANE IS WHOLLY OR PARTIALLY CLOSED. (SEE FIG. 2 ABOVE) WHEN NOT USED, THE DISTANCE BETWEEN SIGNS "A" AND "C" SHALL BE 1000 FT.

THE SAME APPLIES TO THE LEFT HAND LANE WHEN IT IS WHOLLY OR PARTIALLY CLOSED.

FIG. 1

AS THE WORK PROGRESSES ALONG THE HIGHWAY, THE FLAGMAN WILL MOVE WITH IT. WHEN THE DISTANCE BETWEEN SIGN "C" AND THE FLAGMAN BECOMES 1 MILE, ALL THE SIGNS SHALL BE MOVED FORWARD.

STATE OF VERMONT  
VERMONT DEPARTMENT OF HIGHWAYS

WEATHERSFIELD-WINDSOR-HARTLAND

CONSTRUCTION  
WARNING  
SIGNS

SURVEYED BY: \_\_\_\_\_ DATE: \_\_\_\_\_  
DRAWN BY: \_\_\_\_\_ DATE: \_\_\_\_\_  
TRACED BY: *ps* DATE: 5/29/55

PROJ. I NO. 91-1(34)  
SHEET 2 OF 14





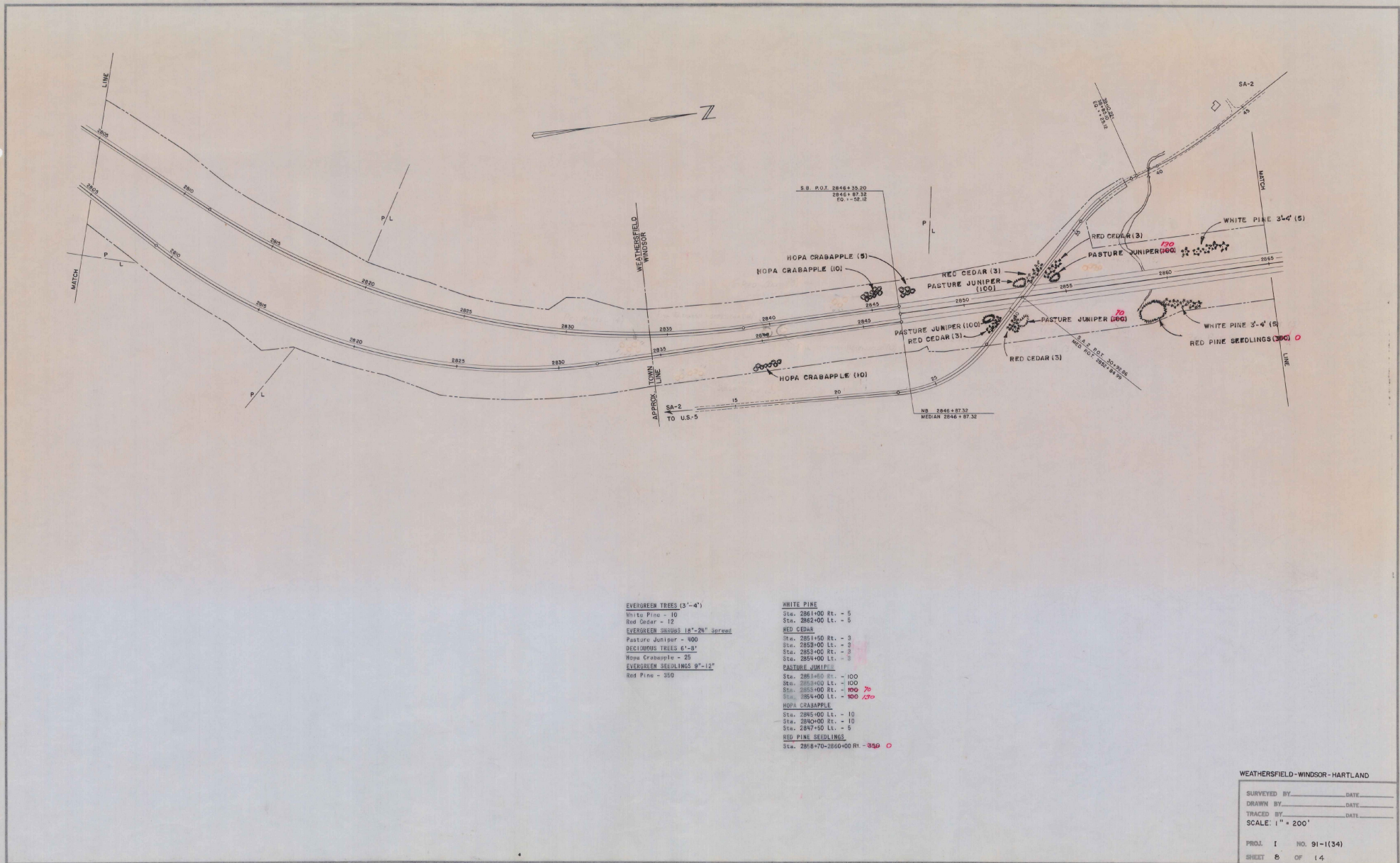

EVERGREEN TREES (3'-4')  
 White Pine - 10  
 Red Cedar - 12  
 EVERGREEN SHRUBS 18"-20" Spread  
 Pasture Juniper - 400  
 DECIDUOUS TREES 6'-8'  
 Hopa Crabapple - 25  
 EVERGREEN SEEDLINGS 9"-12"  
 Red Pine - 250

WHITE PINE  
 Sta. 2861+00 Rt. - 5  
 Sta. 2862+00 Lt. - 5  
 RED CEDAR  
 Sta. 2851+50 Rt. - 3  
 Sta. 2852+00 Lt. - 3  
 Sta. 2853+00 Rt. - 3  
 Sta. 2854+00 Lt. - 3  
 PASTURE JUNIPER  
 Sta. 2861+50 Rt. - 100  
 Sta. 2862+00 Lt. - 100  
 Sta. 2863+00 Rt. - 100  
 Sta. 2864+00 Lt. - 100  
 HOPA CRABAPPLE  
 Sta. 2865+00 Lt. - 10  
 Sta. 2866+00 Rt. - 10  
 Sta. 2867+50 Lt. - 5  
 RED PINE SEEDLINGS  
 Sta. 2818+70-2850+00 Rt. - 250

WEATHERSFIELD-WINDSOR-HARTLAND  
 SURVEYED BY \_\_\_\_\_ DATE \_\_\_\_\_  
 DRAWN BY \_\_\_\_\_ DATE \_\_\_\_\_  
 TRACED BY \_\_\_\_\_ DATE \_\_\_\_\_  
 SCALE: 1" = 200'  
 PROJ. I NO. 91-(134)  
 SHEET 6 OF 14  
 D-7

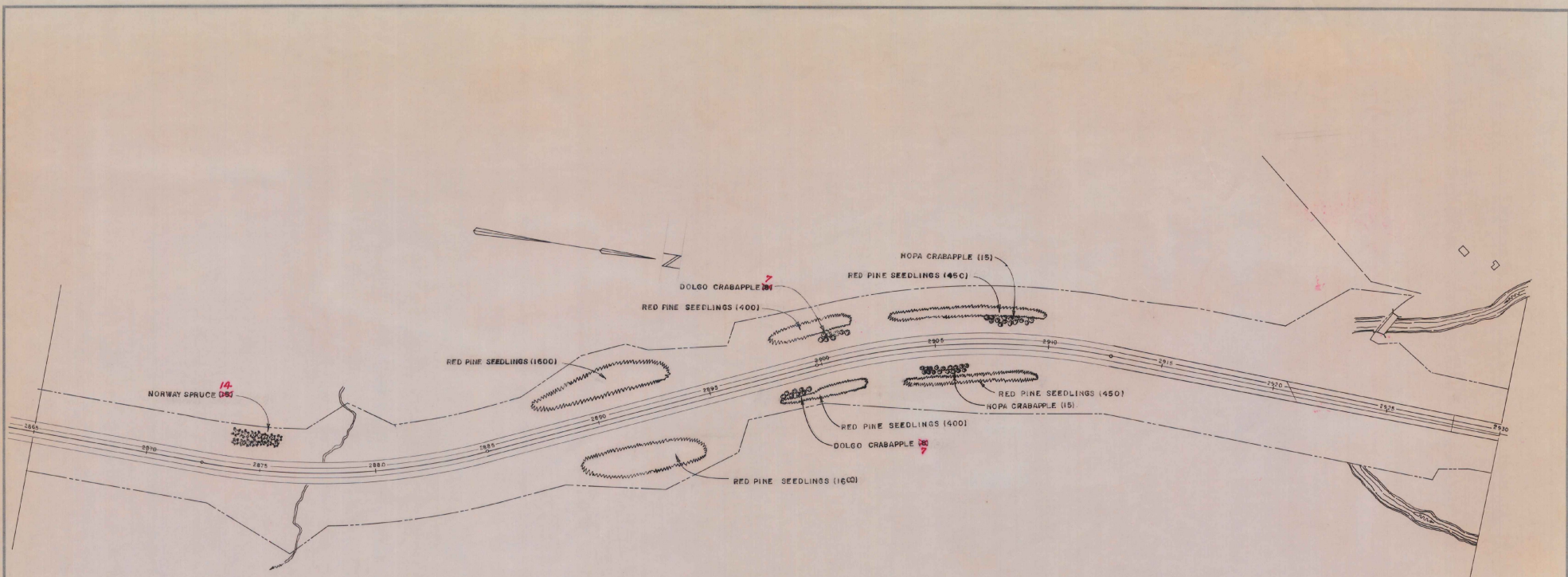

EVERGREEN SEEDLINGS (9"-12")  
 Red Pine - 4000  
 EVERGREEN TREES 3"-8"  
 Norway Spruce - 15  
 DECIDUOUS TREES 6"-8"  
 Nopa Crabapple - 30  
 Dolgo Crabapple - 16

RED PINE SEEDLINGS  
 Sta. 2898+00-2902+00 Lt. - 400  
 Sta. 2898+00-2902+00 Rt. - 400  
 Sta. 2903+00-2910+00 Lt. - 450  
 Sta. 2903+00-2910+00 Rt. - 450  
 Sta. 2889+00-2898+50 Lt. - 1600  
 Sta. 2887+50-2893+50 Lt. - 1600  
 NORWAY SPRUCE  
 Sta. 2873+50-2876+00 Lt. - 14  
 NOPA CRABAPPLE  
 Sta. 2904+00-2906+70 Rt. - 15  
 Sta. 2907+50-2908+50 Lt. - 15  
 DOLGO CRABAPPLE  
 Sta. 2898+00-2899+50 Rt. - 16  
 Sta. 2800+00-2901+50 Lt. - 16

WEATHERFIELD-WINDSOR-HARTLAND

SURVEYED BY \_\_\_\_\_ DATE \_\_\_\_\_  
 DRAWN BY \_\_\_\_\_ DATE \_\_\_\_\_  
 TRACED BY \_\_\_\_\_ DATE \_\_\_\_\_

PROJ. 2 NO. 91-1(34)  
 SHEET 9 OF 14

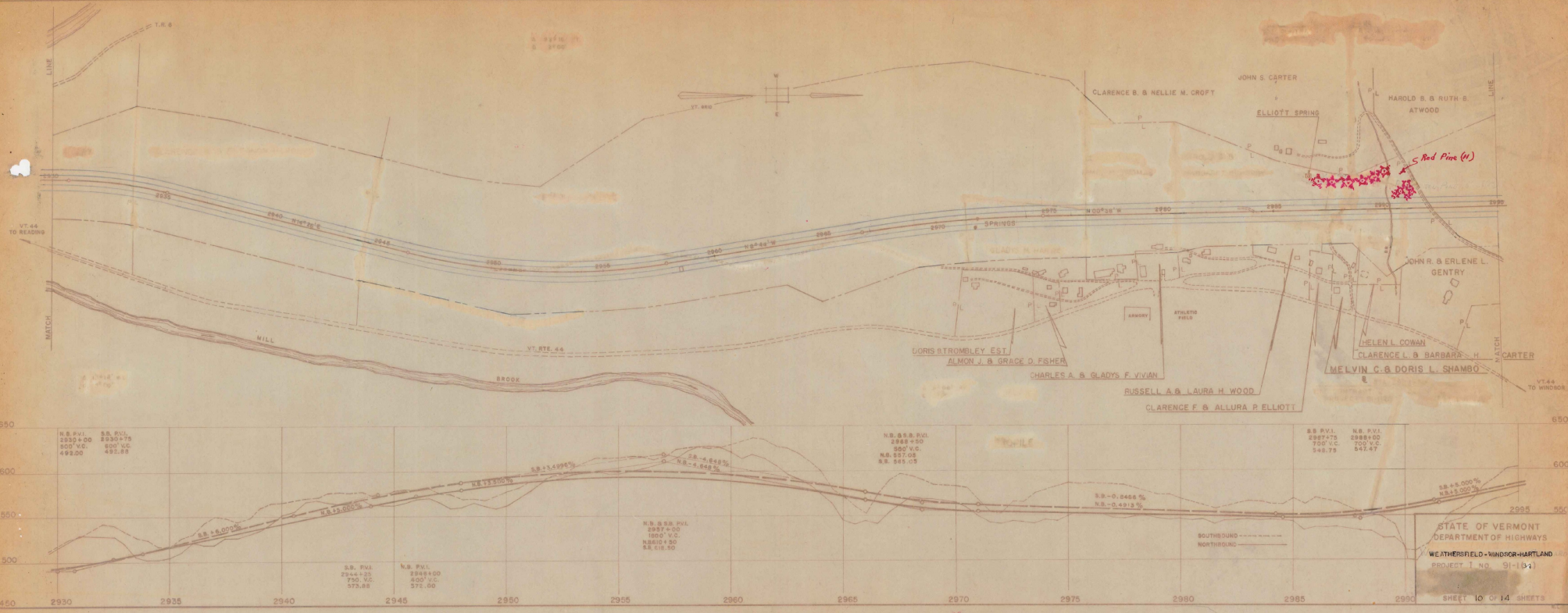

STATE OF VERMONT  
DEPARTMENT OF HIGHWAYS  
WEATHERFIELD-WINDSOR-HARTLAND  
PROJECT 1 NO. 91-13-1  
SHEET 10 OF 14 SHEETS

Red Pine (11)  
St 2987+50-2991+50 11 11

4 3750  
0 0715

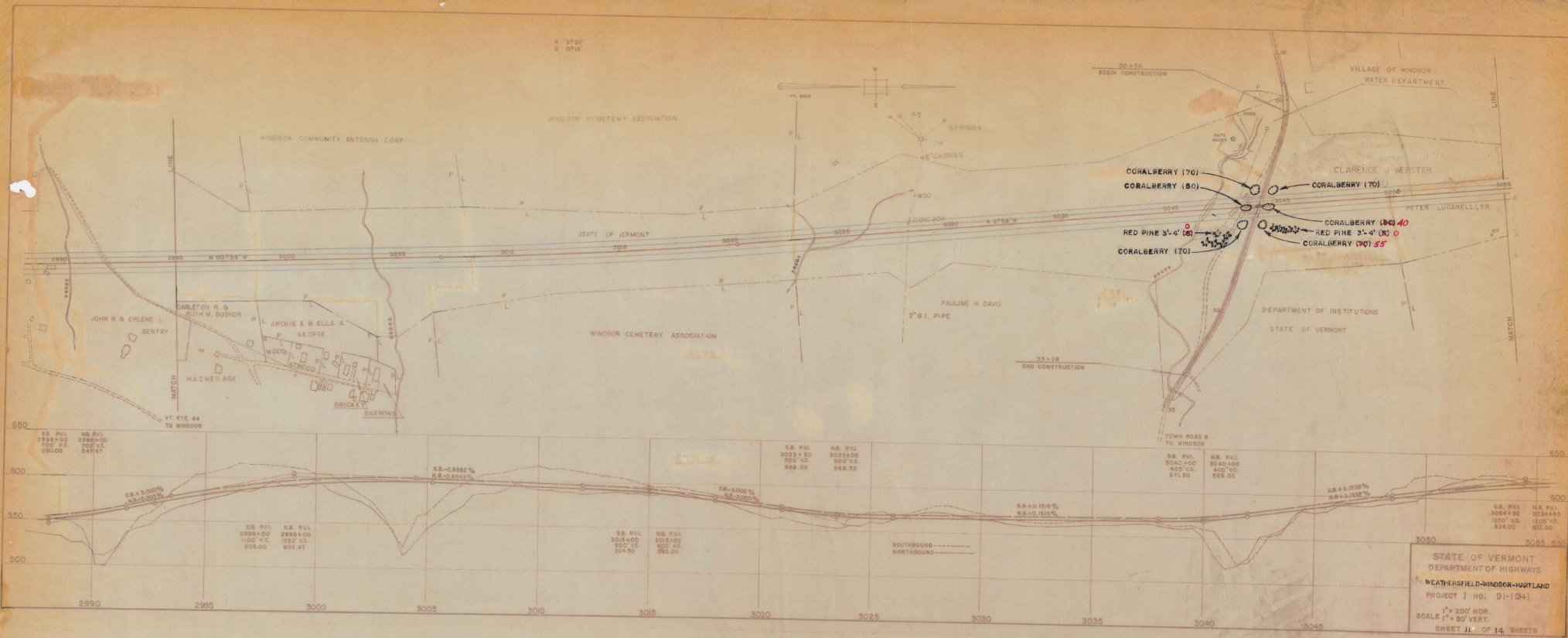

DECIDUOUS SHRUBS 1 1/2"-2"  
Coralberry - 280 350  
EVERGREEN TREES 3 1/2"  
See Plan - 14 0

CORALBERRY  
Sta. 3043+20 Rt. - 70  
Sta. 3043+50 Med. - 50  
Sta. 3043+80 Lt. - 70  
Sta. 3044+00 Rt. - 70 30"  
Sta. 3044+20 Med. - 30 40"  
Sta. 3044+60 Lt. - 70  
RED PINE  
Sta. 3043+30 Rt. - X  
Sta. 3045+00 Rt. - X } moved to sta. 3133+00 - 3151+50 (AK)



N.B.S.S.  
 1 36"x48" LT  
 0 3"

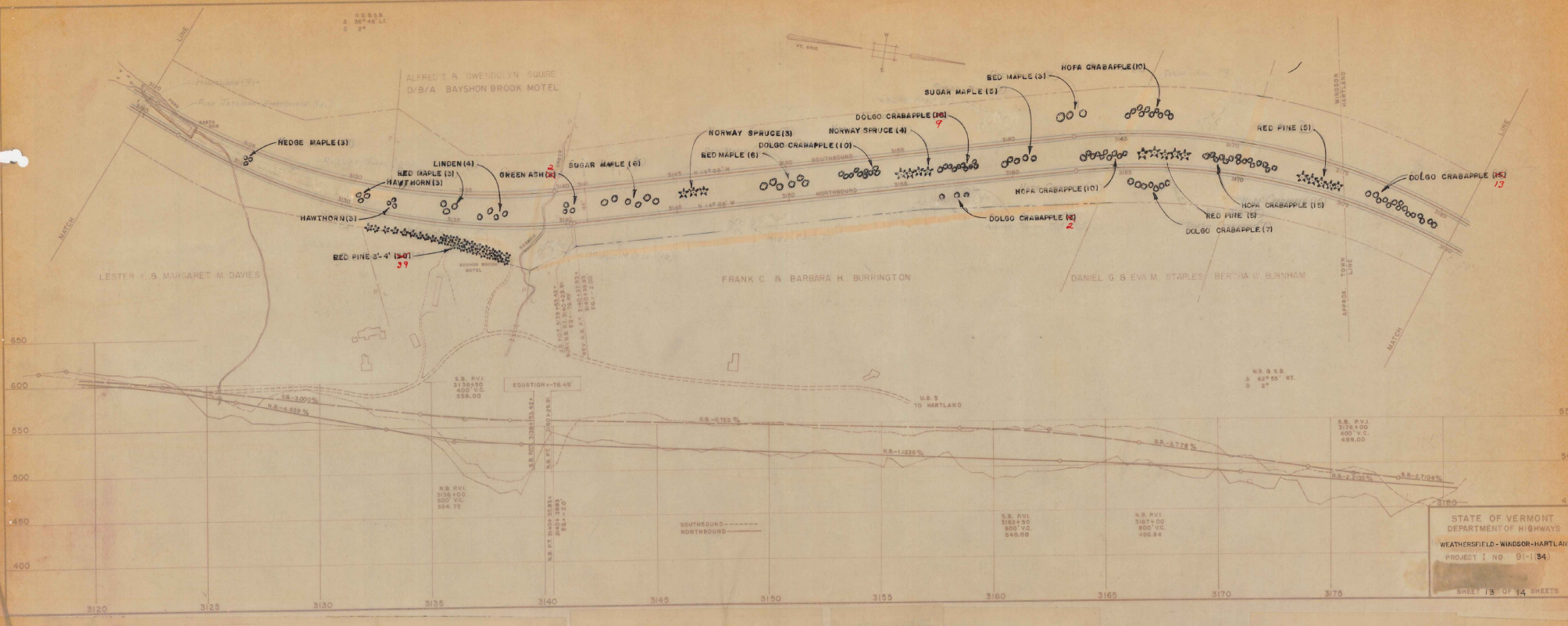

STATE OF VERMONT  
 DEPARTMENT OF HIGHWAYS  
 WEATHERSFIELD-WINDSOR-HARTLAND  
 PROJECT NO. 91-134  
 SHEET 13 OF 14 SHEETS

EVERGREEN TREES 31'-4'  
 Red Pine - 30 49  
 Norway Spruce - 7  
 DECIDUOUS TREES 10'-12'  
 Sugar Maple - 11  
 Red Maple - 12  
 Green Ash - X 2  
 Linden - 4  
 DECIDUOUS TREES 6'-8'  
 Dolgo Crabapple - 16 41  
 Hopa Crabapple - 35  
 Hawthorn - 6  
 Hedge Maple - 3

RED PINE  
 Sta. 315+00-3136+50 Rt. - 30 49  
 Sta. 3166+00-3168+00 Med. - 5  
 Sta. 3173+00-3175+00 Med. - 5  
 NORWAY SPRUCE  
 Sta. 3145+00-3146+50 Med. - 3  
 Sta. 3155+00-3156+50 Med. - 4  
 SUGAR MAPLE  
 Sta. 3161+70-3144+20 Med. - 6  
 Sta. 3169+80-3161+20 Med. - 5  
 RED MAPLE  
 Sta. 3184+00 Med. - 3  
 Sta. 3189+00-3151+00 Med. - 9  
 Sta. 3162+50-3163+50 Lt. - 3  
 GREEN ASH  
 Sta. 3140+50 Med. - X 2  
 LINDEN  
 Sta. 3185+50-3136+80 Med. - 4  
 DOLGO CRABAPPLE  
 Sta. 3152+00-3158+10 Med. - 10  
 Sta. 3167+00-3158+20 Rt. - X 2  
 Sta. 3165+00-3167+00 Lt. - 7  
 Sta. 3176+50-3169+00 Med. - 16 13  
 Sta. 3157+00-3158+70 Med. - 16 7

HOPA CRABAPPLE  
 Sta. 3163+20-3165+30 Med. - 10  
 Sta. 3165+20-3167+40 Lt. - 10  
 Sta. 3165+60-3171+50 Med. - 15  
 HAWTHORN  
 Sta. 3132+00 Med. - 3  
 Sta. 3130+50 Med. - 3  
 HEDGE MAPLE  
 Sta. 3125+25 Med. - 3

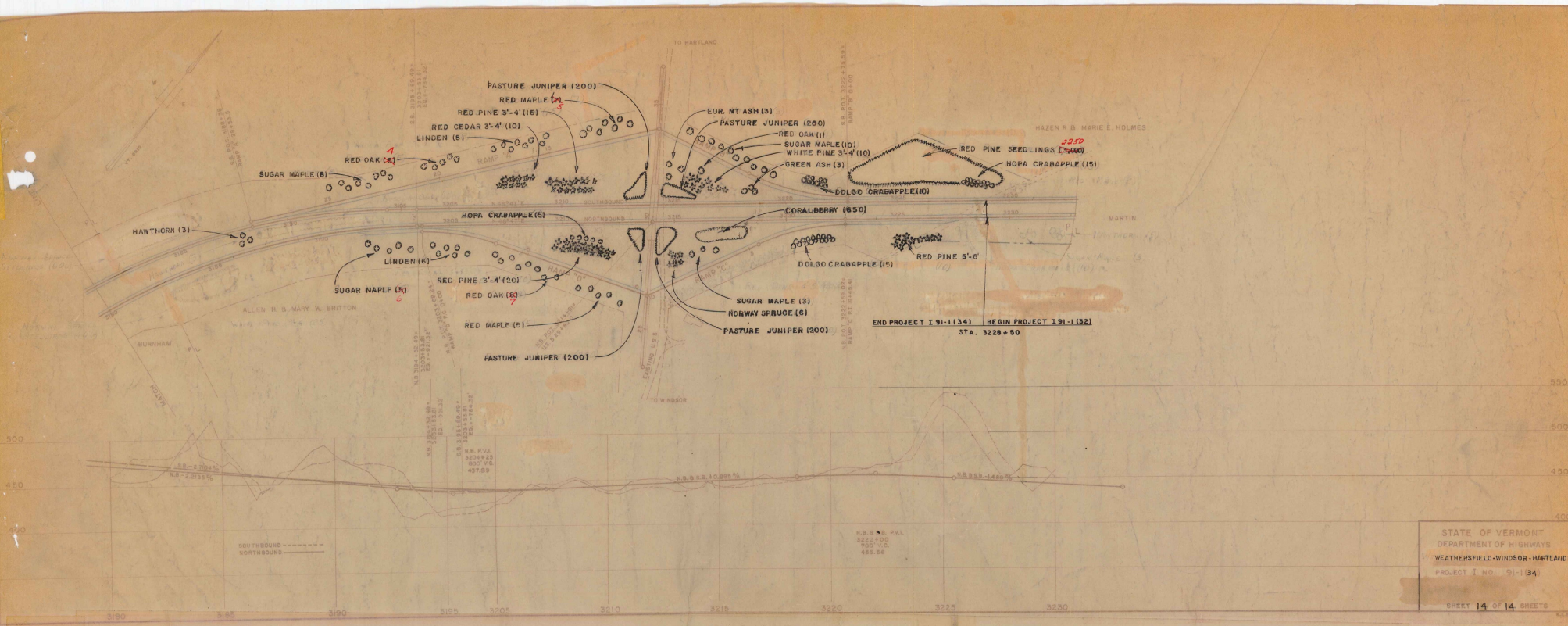

STATE OF VERMONT  
 DEPARTMENT OF HIGHWAYS  
 WEATHERFIELD-WINDSOR-HARTLAND  
 PROJECT I. NO. 91-134  
 SHEET 14 OF 14 SHEETS

- EVERGREEN TREES 5'-6'**  
 Red Pine - 10
- EVERGREEN TREES 3'-4'**  
 Red Pine - 05  
 White Pine - 10  
 Red Cedar - 10  
 Norway Spruce - 6
- EVERGREEN SEEDLINGS**  
 Red Pine - 3000
- EVERGREEN SHRUBS 18"-24" Spread**  
 Pasture Juniper - 800
- DECIDUOUS TREES 10'-12'**  
 Sugar Maple - 26  
 Linden - 16  
 Red Maple - 12  
 Red Oak - 14  
 Green Ash - 3
- DECIDUOUS TREES 6'-8'**  
 Hopa Crabapple - 20  
 Dolgo Crabapple - 25  
 European Mountain Ash - 3
- DECIDUOUS SHRUBS 1 1/2'-2'**  
 Coralberry - 650

- RED PINE 5'-6'**  
 Sta. 3225+00 Rt. - 30 9
- RED PINE 3'-4'**  
 Sta. 3209+50-3212+00 Lt. - 15  
 Sta. 3210+00-3212+00 Rt. - 20
- WHITE PINE**  
 Sta. 3216+50 Lt. - 10
- RED CEDAR**  
 Sta. 3207+50-3209+00 Lt. - 10
- NORWAY SPRUCE**  
 Sta. 3215+00 Rt. - 6
- RED PINE SEEDLINGS**  
 Sta. 3223+00-3230+00 Lt. - 3000 2250
- PASTURE JUNIPER**  
 Sta. 3213+00 Lt. - 200  
 Sta. 3213+30 Rt. - 200  
 Sta. 3214+70 Rt. - 200  
 Sta. 3215+00 Lt. - 200
- SUGAR MAPLE**  
 Sta. 3192+00-3193+00 Lt. - 5  
 Sta. 3192+00-3194+00 Rt. - 5  
 Sta. 3215+50-3219+50 Lt. - 10  
 Sta. 3216+00 Rt. - 3

- LINDEN**  
 Sta. 3204+00-3206+00 Rt. - 6  
 Sta. 3207+00-3210+00 Lt. - 8
- RED MAPLE**  
 Sta. 3210+50-3212+50 Lt. - X 5  
 Sta. 3210+50-3212+50 Rt. - 5
- RED OAK**  
 Sta. 3204+00-3205+50 Lt. - X 4  
 Sta. 3207+00-3210+00 Rt. - X 7  
 Sta. 3216+20 Lt. - 1
- GREEN ASH**  
 Sta. 3216+50 Lt. - 3
- HOPA CRABAPPLE**  
 Sta. 3210+50-3211+70 Rt. - 5  
 Sta. 3223+00-3229+50 Lt. - 15
- DOLGO CRABAPPLE**  
 Sta. 3220+50-3222+40 Rt. - 15  
 Sta. 3220+50-3221+80 Lt. - 10
- HAWTHORN**  
 Sta. 3186+50 Med. - 3
- EUROPEAN MOUNTAIN ASH**  
 Sta. 3215+00 Lt. - 3
- CORALBERRY**  
 Sta. 3216+00-3218+30 Rt. - 650

INDEX OF SHEETS

- 1-PROJECT TITLE SHEET
- 2-TYPICALS
- 3-13 LAYOUTS
- 14-26 PROFILES
- 27-59 CROSS SECTIONS

STATE OF VERMONT  
AGENCY OF TRANSPORTATION



PROPOSED IMPROVEMENT  
TOWN OF WILLISTON  
COUNTY OF CHITTENDEN

U.S. ROUTE 2 (F.A.U., PRINCIPAL AND MINOR ARTERIALS)  
VT. ROUTE 2A (F.A.U., PRINCIPAL AND MINOR ARTERIALS)

BEGINNING AT THE INTERSECTION OF U.S. ROUTE 2 AND VERMONT ROUTE 2A AT TAFT CORNERS IN WILLISTON AND EXTENDING WEST ON U.S. ROUTE 2 APPROXIMATELY 0.365 MILES, EAST ON U.S. ROUTE 2 APPROXIMATELY 0.213 MILES, NORTH ON VT. ROUTE 2A APPROXIMATELY 0.275 MILES, AND SOUTH ON VT. ROUTE 2A APPROXIMATELY 0.369 MILES

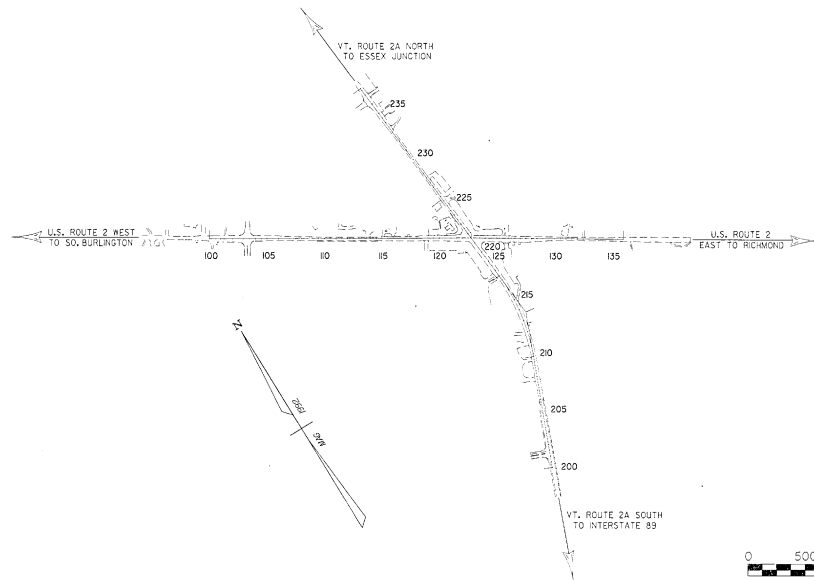
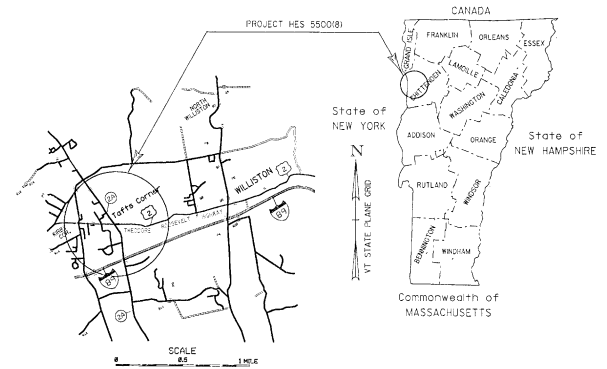

CONVENTIONAL SIGNS

- COUNTY LINE
- TOWN LINE
- LIMITS OF ACCESS
- POINT OF ACCESS
- FENCE LINE
- STONE WALL
- TRAVELED WAY
- GUARD RAIL
- RAILROAD
- SURVEY LINE
- CULVERT
- POWER POLE
- TELEPHONE POLE
- TREES
- CONTROL OF ACCESS
- PROPERTY LINE
- R.O.W. TAKING LINE
- SLOPE RIGHTS
- TOP OF CUT
- TOE OF SLOPE

DATUM  
VERTICAL \_\_\_\_\_  
HORIZONTAL \_\_\_\_\_



THESE PLANS ARE SUBJECT TO SUCH ENGINEERING CHANGES AS MAY BE REQUIRED BY THE FEDERAL HIGHWAY ADMINISTRATION OR THE CHIEF ENGINEER. CONSTRUCTION IS TO BE CARRIED ON IN ACCORDANCE WITH THESE PLANS AND THE STANDARD SPECIFICATIONS FOR CONSTRUCTION DATED 1930, AS APPROVED BY THE FEDERAL HIGHWAY ADMINISTRATION ON MARCH 15, 1950 FOR USE ON THIS PROJECT, INCLUDING ALL SUBSEQUENT REVISIONS AND SUCH REVISED SPECIFICATIONS AND SPECIAL PROVISIONS AS ARE INCORPORATED IN THESE PLANS.

SUBMITTED BY ORDER OF THE STATE TRANSPORTATION BOARD

APPROVED \_\_\_\_\_ DATE \_\_\_\_\_  
DIRECTOR OF ENGINEERING

DEPARTMENT OF TRANSPORTATION  
FEDERAL HIGHWAY ADMINISTRATION

APPROVED \_\_\_\_\_ DATE \_\_\_\_\_  
DIVISION ADMINISTRATOR

PROJECT \_\_\_\_\_

SHEET 1 OF \_\_\_\_\_ SHEETS

Vermont Agency of  
Transportation  
PHASE 1-INTERSTATE  
#122302-01  
INITIALS   
HANGER 408 ONE

Landscaping

19 66  
68

Weatherfield-Windsor-Hartland

I-91-1 (34)

19 66  
68