

1. By ERM  
 Checked by A.J.I.  
 Drawn by M.J.B.  
 Date 11/15/89

EARTH BACKFILL  
 FOR 41+20 TO 41+40 "WIDE" IS  
 FILL TO CUT FRAMES.

Ramp A  
 Sta 211+6

Sta 207+40 L.S.D.  
 Begin Three Cable Guard Rail  
 With Steel Posts

9'x11'-0" BOX CULVERT  
 310 LF ASKEW 45° LT,  
 SEE STRUCTURAL DRAWINGS SHEET NO 125

Sta 208+00 Rt. Square  
 18'x108' A.C.C.G.M.P. W/RCOI W/PC  
 W/2-25" ELBOWS W/24" COLLARS AT ALL JOINTS.

N.B. & S.B.

DRAWN BY B.P. E.F.W. A.J.I.  
 CHECKED BY M.J.B.  
 PROJECT I 89-3 (14)  
 SHEET 33 OF 160  
 SCALE  
 HOR. 1 IN. = 10 FT.  
 VERT. 1 IN. = 10 FT.  
 STAGE I Cont. 3

I-89-3(14) I-89-3(17)  
 Stage 2 Construction  
 Sheet 33 of 167

Sta. 2030+69 Median  
 Three Cable Guard Rail  
 with Steel Posts

Sta. 2030+60 Lt. SB  
 End Three Cable Guard Rail  
 With Steel Posts

Sta. 2030+68.98 Stop Roadway Begin Bridge

Sta. 2030+60 Rt. NB  
 End Three Cable Guard Rail  
 With Steel Posts

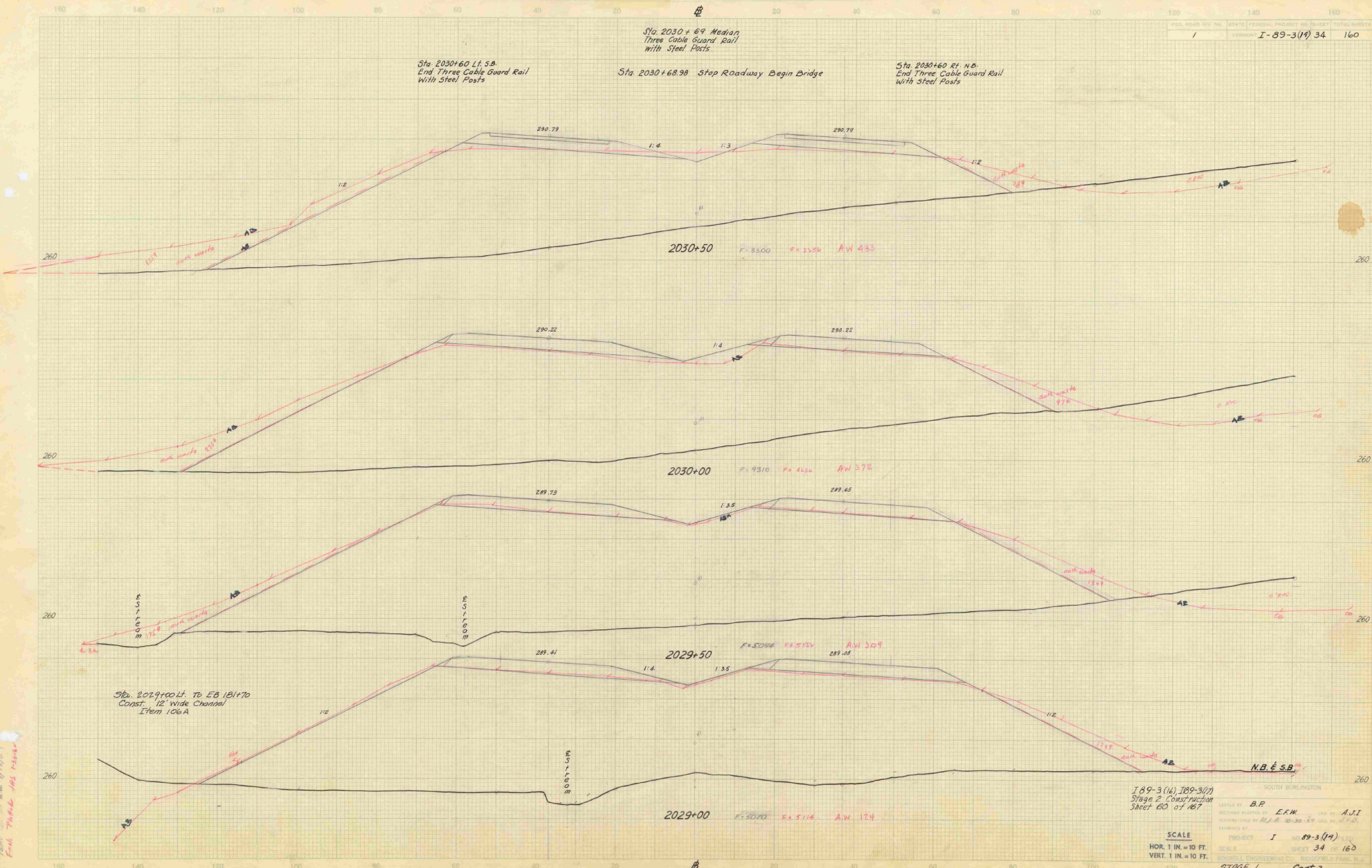

E.F.W. 6/15/97  
 Checked by A.J.I. 6/15/97  
 Drawn by B.M. 7/1/97  
 Final Tables 1/15/98

FED. ROAD DIST. NO.	STATE	FEDERAL PROJECT NO.	SHEET	TOTAL SHEETS
1	I-89-3(14)	35	160	

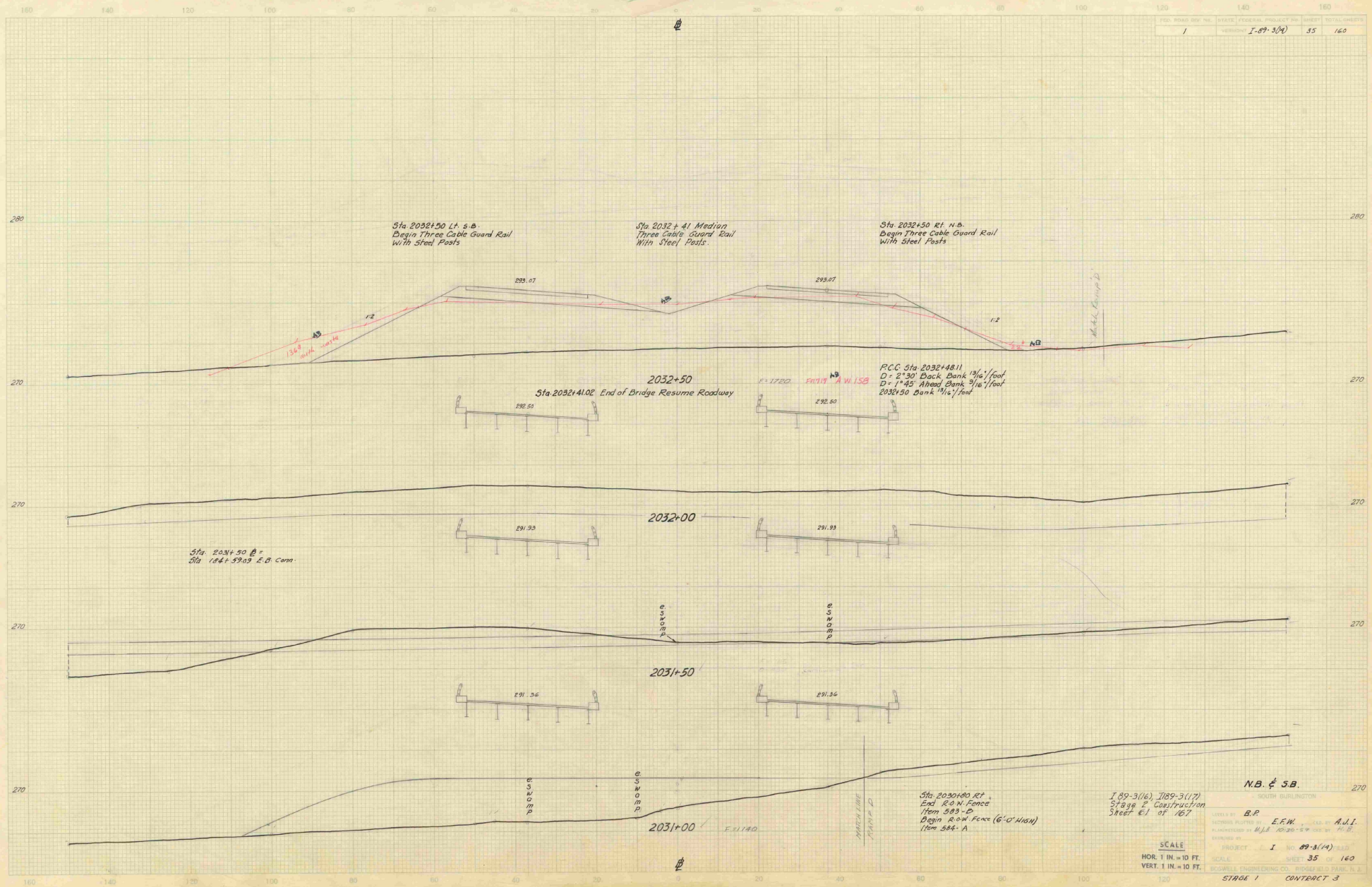

C.B. Pflieger, E.P.M. 4/11/79  
 L.S. 4/11/79, A.J.I. 4/11/79, W.L. 4/11/79  
 T.M. 4/11/79, B.W. 4/11/79  
 R.M. 4/11/79, W.L. 4/11/79

**N.B. & S.B.**  
 SOUTH BURLINGTON  
 DESIGNED BY: B.R. E.F.W. A.J.I.  
 PLANNED BY: W.J.B. 10/30/57  
 PROJECT: I-89-3(14)  
 SCALE: SHEET 35 OF 160  
 SOGUELL ENGINEERING CO., INDEPENDENCE, PA., U.S.A.

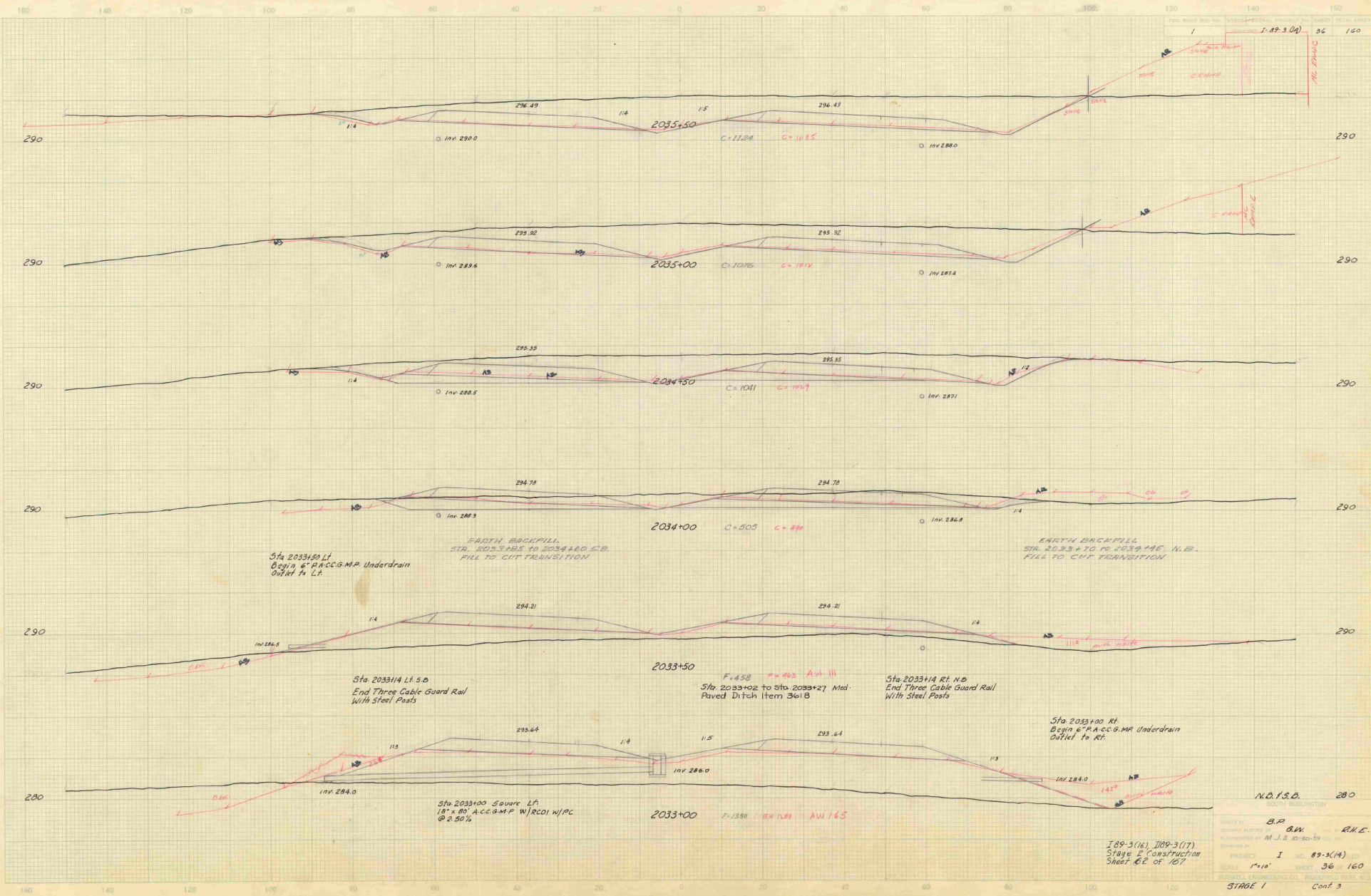

Sta 2033+50 Lt  
Begin 6" P.A.C.C.G.M.P. Underdrain  
Outlet to Lt.

EARTH BACKFILL  
Sta. 2033+50 TO 2034+00 C.B.  
FILL TO CUT TRANSITION

EARTH BACKFILL  
Sta. 2033+50 TO 2034+00 M.E. N.E.  
FILL TO CUT TRANSITION

Sta 2033+14 Lt S.O.  
End Three Cable Guard Rail  
With Steel Posts

2033+50  
F=4.58 P=105 - Aut III  
Sta. 2033+02 to Sta. 2033+27 Mod.  
Paved Ditch Item 361B

Sta. 2033+14 Rt. N.O.  
End Three Cable Guard Rail  
With Steel Posts

Sta 2033+00 Rt.  
Begin 6" P.A.C.C.G.M.P. Underdrain  
Outlet to Rt.

Sta 2033+00 Square Lt  
18" x 80" Acc.G.M.P. W/RCOI W/PC  
@ 2.50%

2033+00  
F=13.88 P=100 - Aut III  
AW 165

N.O.F.S.O. SOUTH BURLINGTON

DATE BY  
DESIGNED BY B.P. G.W. R.H.C.  
CHECKED BY M.J.B. 10-50-59  
PROJECT I NO. 89-3(A)  
SCALE 1"=10' SHEET 36 160  
BOSWELL ENGINEERING CO. BOSTON FIELD PARK BLDG.  
STAGE 1 Cont. 3

J. 89-3(A) J. 89-3(17)  
Stage 2 Construction  
Sheet 66 of 167

Handwritten notes in the left margin, including 'Check stationing', 'Temp. Ch. by 0.0 7/1/60', and 'Final Stationing 1/1/60'.



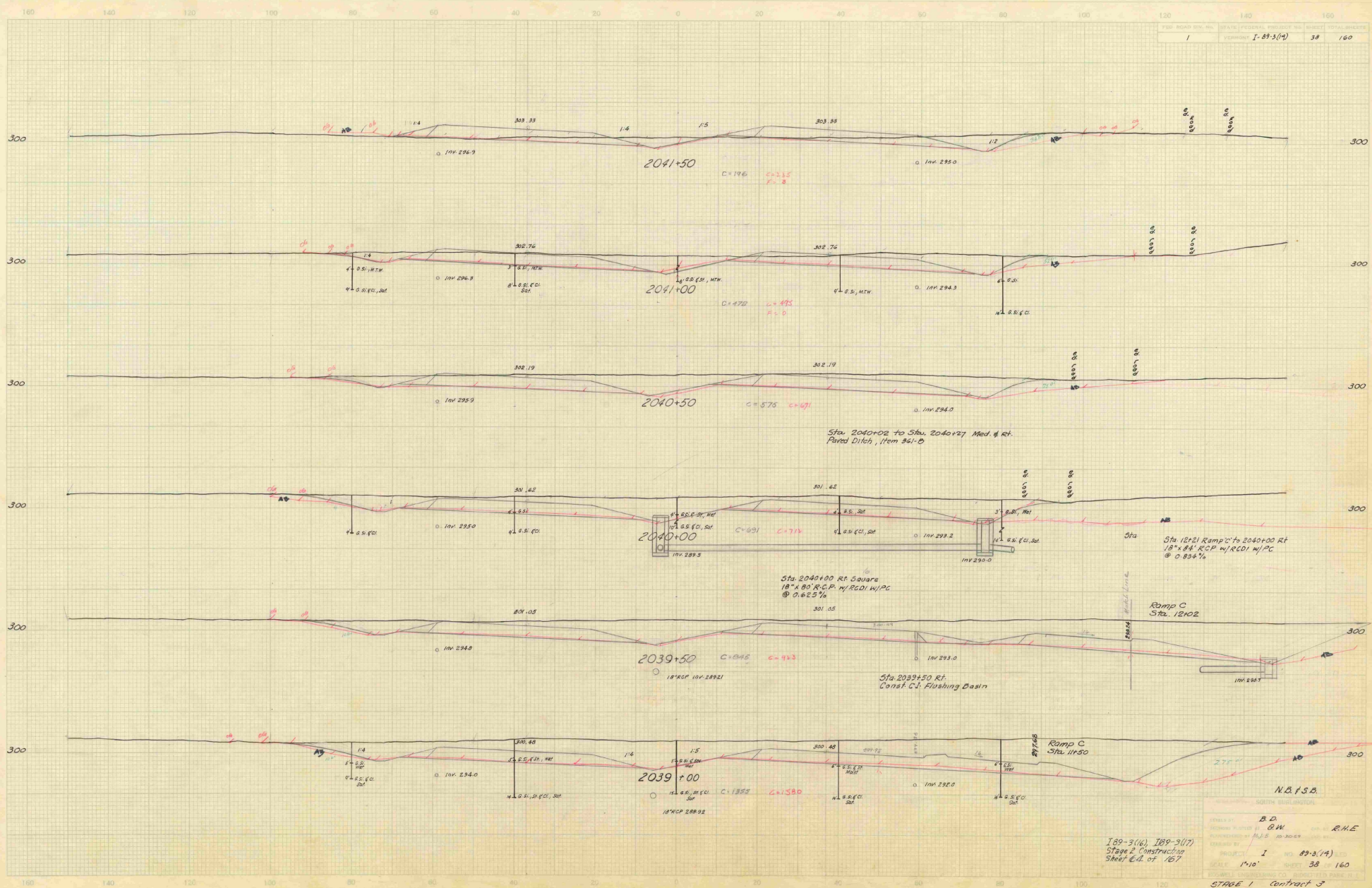

C.I. Flushing Basin  
 18" R.C.P. w/ R.C.D. w/ P.C.  
 Temp. C.I. by 8.11.11/11/11  
 Paul Thibault HAS  
 Date: 11/11/11

N.B.F.S.A.  
 DRAWN BY: B.D.  
 CHECKED BY: B.W.  
 PROJECT NO.: I-89-3(17)  
 SHEET NO.: 38  
 TOTAL SHEETS: 160  
 SCALE: 1"=10'  
 DATE: 11/11/11  
 STAGE 1 Contract 3



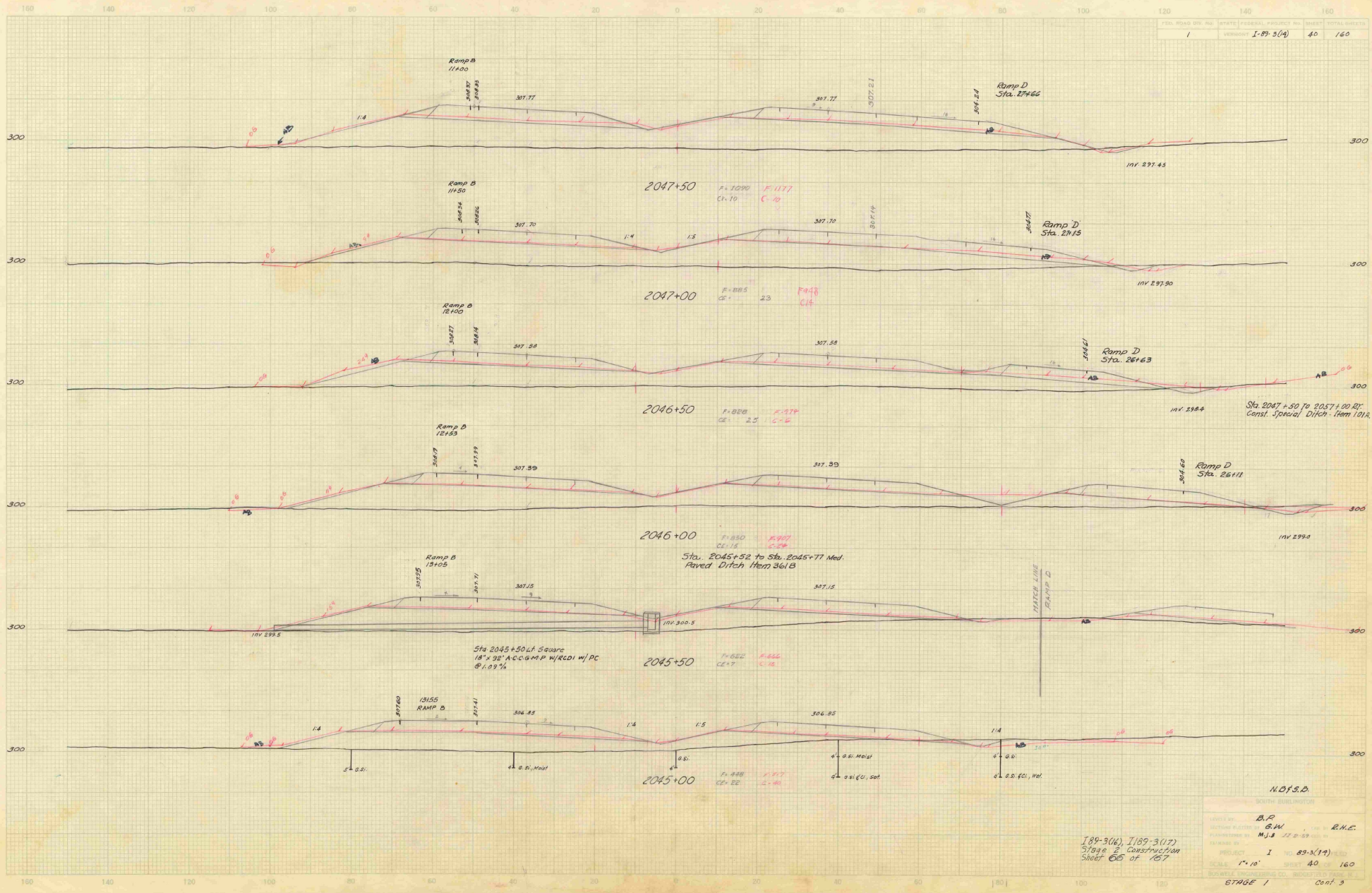

189-3(4), I-89-3(17)  
 Stage 2 Construction  
 Sheet 40 of 167

189-3(4), I-89-3(17)  
 Stage 2 Construction  
 Sheet 40 of 167

N.O.S.D.  
 SOUTH BURLINGTON  
 DRAWN BY: B.P.  
 CHECKED BY: B.M. R.H.C.  
 PROJECT: I-89-3(17)  
 SHEET: 40 OF 160  
 SCALE: 1" = 10'  
 STAGE 1  
 Cont. 3

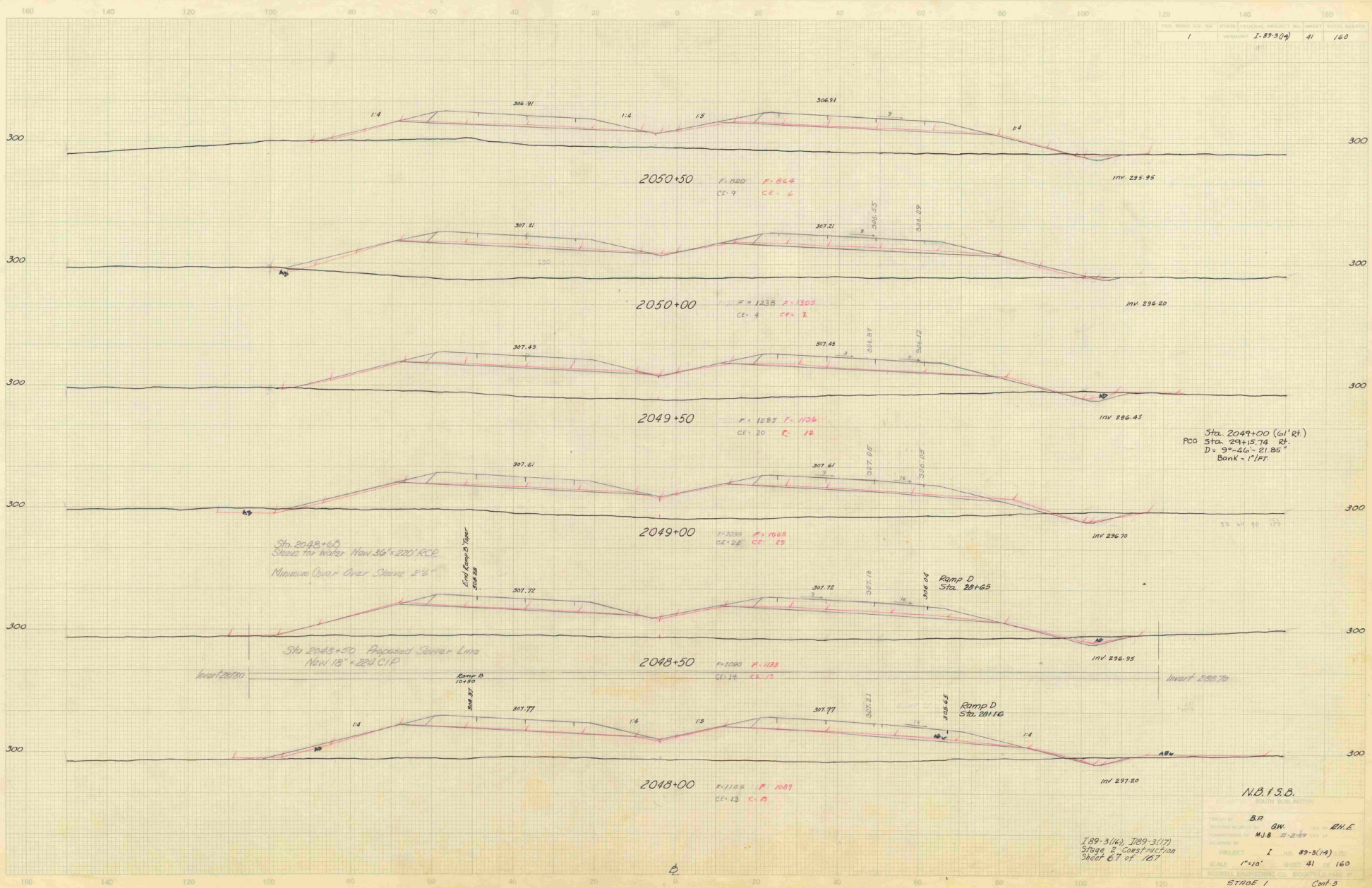

Sta. 2049+00 (at Rt)  
 POB Sta. 20+15.74 RT  
 D = 9'-46" - 21.85"  
 Bank = 1' FT.

N.B. I.S.B.

I-89-3(14), I-89-3(17)  
 Stage 2 Construction  
 Sheet 67 of 167  
 PROJECT I NO. 89-3(14)  
 SCALE 1"=10'  
 SHEET 41 OF 160  
 STAGE 1 Cont-3

18  
 19  
 20  
 21  
 22  
 23  
 24  
 25  
 26  
 27  
 28  
 29  
 30  
 31  
 32  
 33  
 34  
 35  
 36  
 37  
 38  
 39  
 40  
 41  
 42  
 43  
 44  
 45  
 46  
 47  
 48  
 49  
 50  
 51  
 52  
 53  
 54  
 55  
 56  
 57  
 58  
 59  
 60  
 61  
 62  
 63  
 64  
 65  
 66  
 67  
 68  
 69  
 70  
 71  
 72  
 73  
 74  
 75  
 76  
 77  
 78  
 79  
 80  
 81  
 82  
 83  
 84  
 85  
 86  
 87  
 88  
 89  
 90  
 91  
 92  
 93  
 94  
 95  
 96  
 97  
 98  
 99  
 100

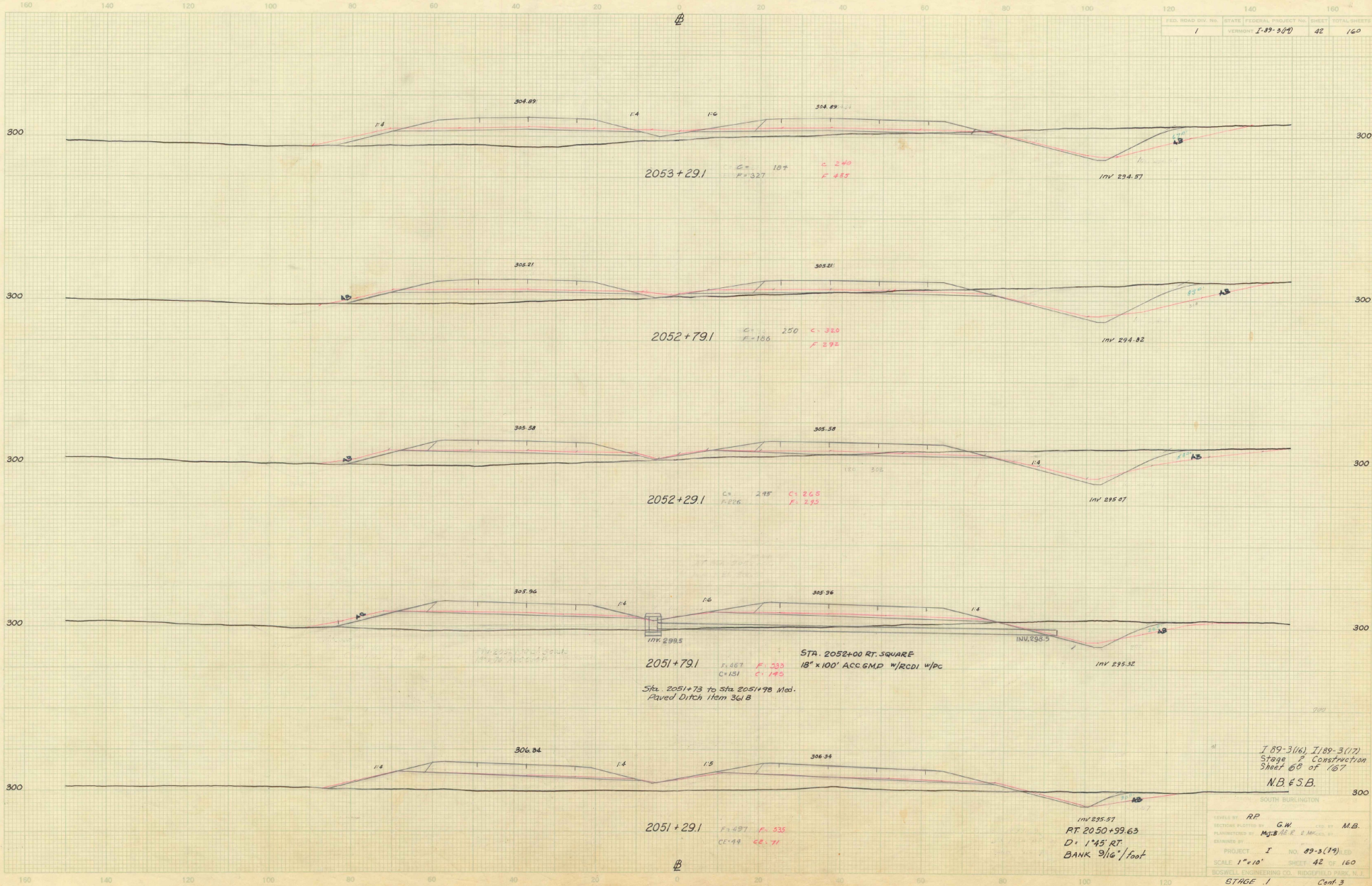

OS Prepared by G.W. 6-5-53  
 G.S. Check by M.B. 6-5-53  
 Approved by M.B. 6-17-53

I 89-3(16), I 89-3(17)  
 Stage 2 Construction  
 Sheet 42 of 167  
 N.B. & S.B.  
 SOUTH BURLINGTON  
 DESIGNED BY RP G.W. M.B.  
 PLANNED BY M.B. M.B. M.B.  
 DRAWN BY  
 PROJECT I NO. 89-3(17)  
 SCALE 1"=10' SHEET 42 OF 160  
 SOUTH BURLINGTON ENGINEERING CO., BIDDINGFIELD, VERM. U.S.A.  
 STAGE 1 Cont. 3

FED. ROAD DIV. NO.	STATE	FEDERAL PROJECT NO.	SHEET	TOTAL SHEETS
1	VERMONT	I-89-3(14)	43	160

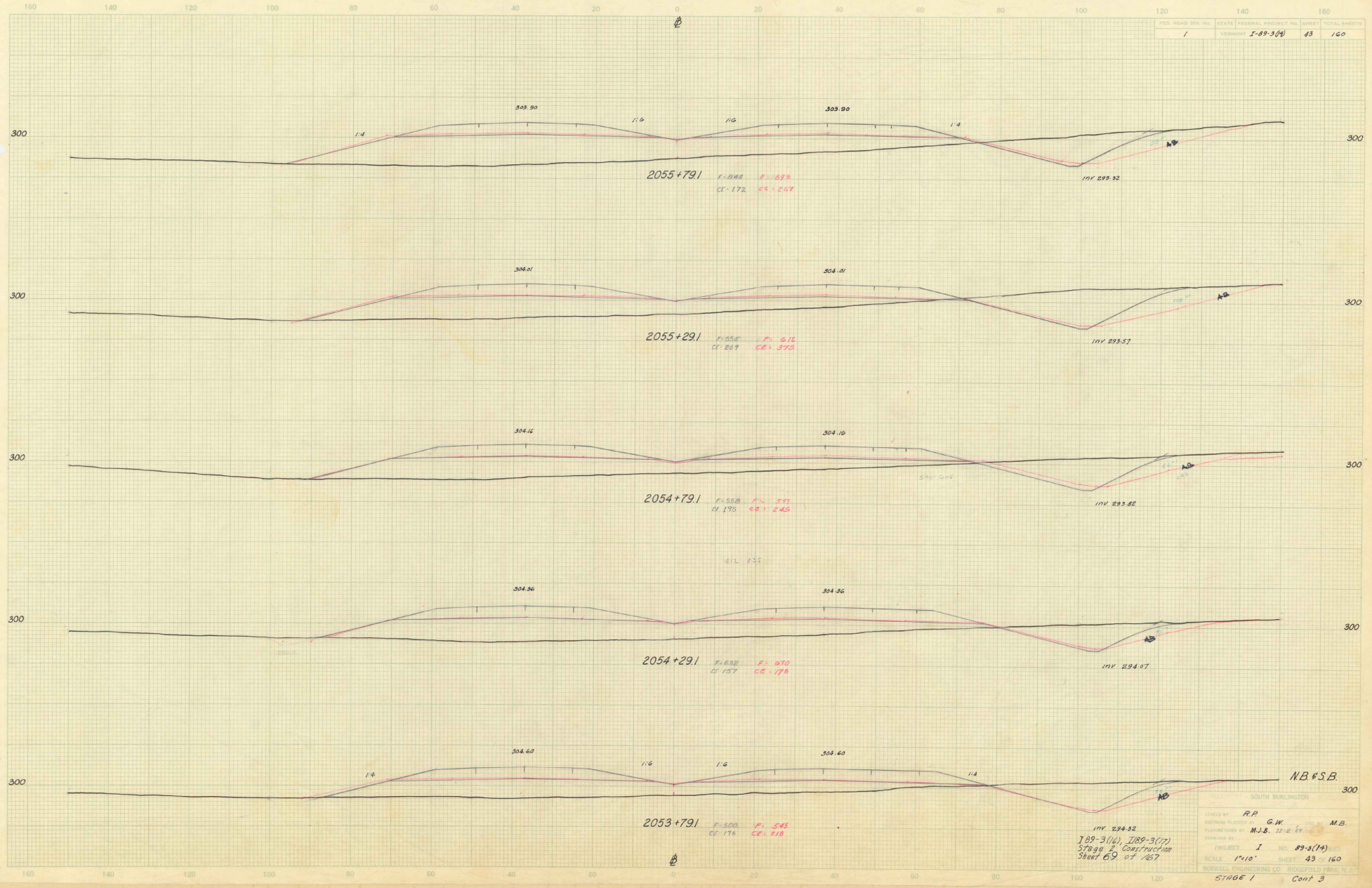

C.C. PLOTTER BY G.W. 6/29/53  
 O.G. CURV. BY M.J.B. 6/29/53

INV 294.32  
 I-89-3(14), I-89-3(17)  
 STAGE 2 CONSTRUCTION  
 SHEET 69 OF 167

SOUTH BURLINGTON  
 DRAWN BY: R.P.  
 CHECKED BY: G.W.  
 M.B.  
 PROJECT: I  
 NO: 89-3(14)  
 SCALE: 1"=10'  
 SHEET: 43 OF 160  
 BORWELL ENGINEERING CO. BRIDGEFIELD PARK, N.H.  
 STAGE 1  
 Cont 3

FED. ROAD DIST. NO.	STATE	FEDERAL PROJECT NO.	SHEET	TOTAL SHEETS
1		1-89-3(7)	44	160

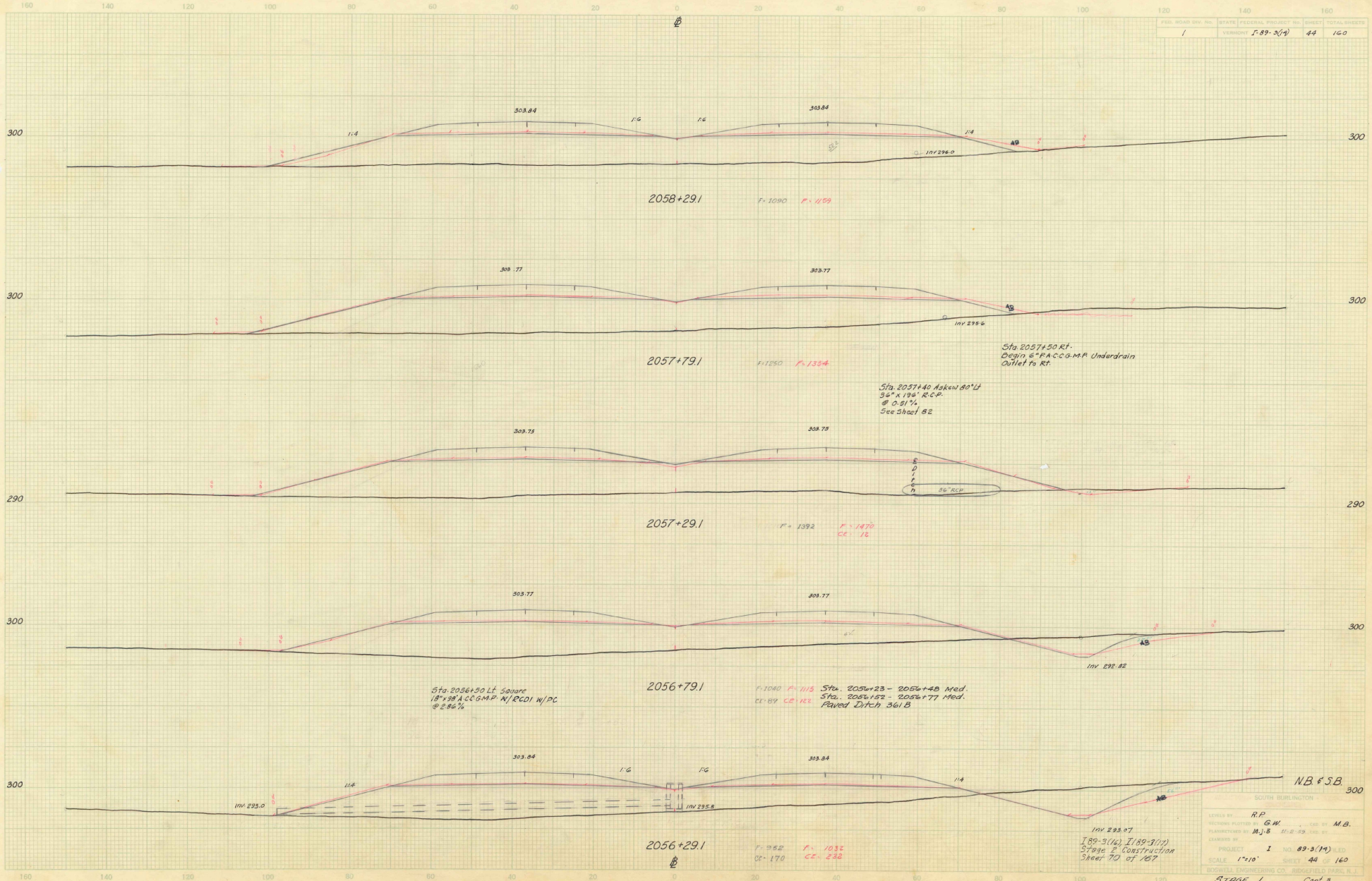

O.G. Plotted by G.W. 8/13/53  
 O.C. Drawn by M.H. 8/13/53

SOUTH BURLINGTON  
 DESIGNED BY R.P.  
 CHECKED BY G.W.  
 DRAWN BY M.J.B.  
 PROJECT I NO. 89-3(14)  
 SCALE 1"=10' SHEET 44 OF 160  
 BOSWELL ENGINEERING CO. BIRKBEFIELD PARK, N.H.  
 STAGE 1 Cont 3

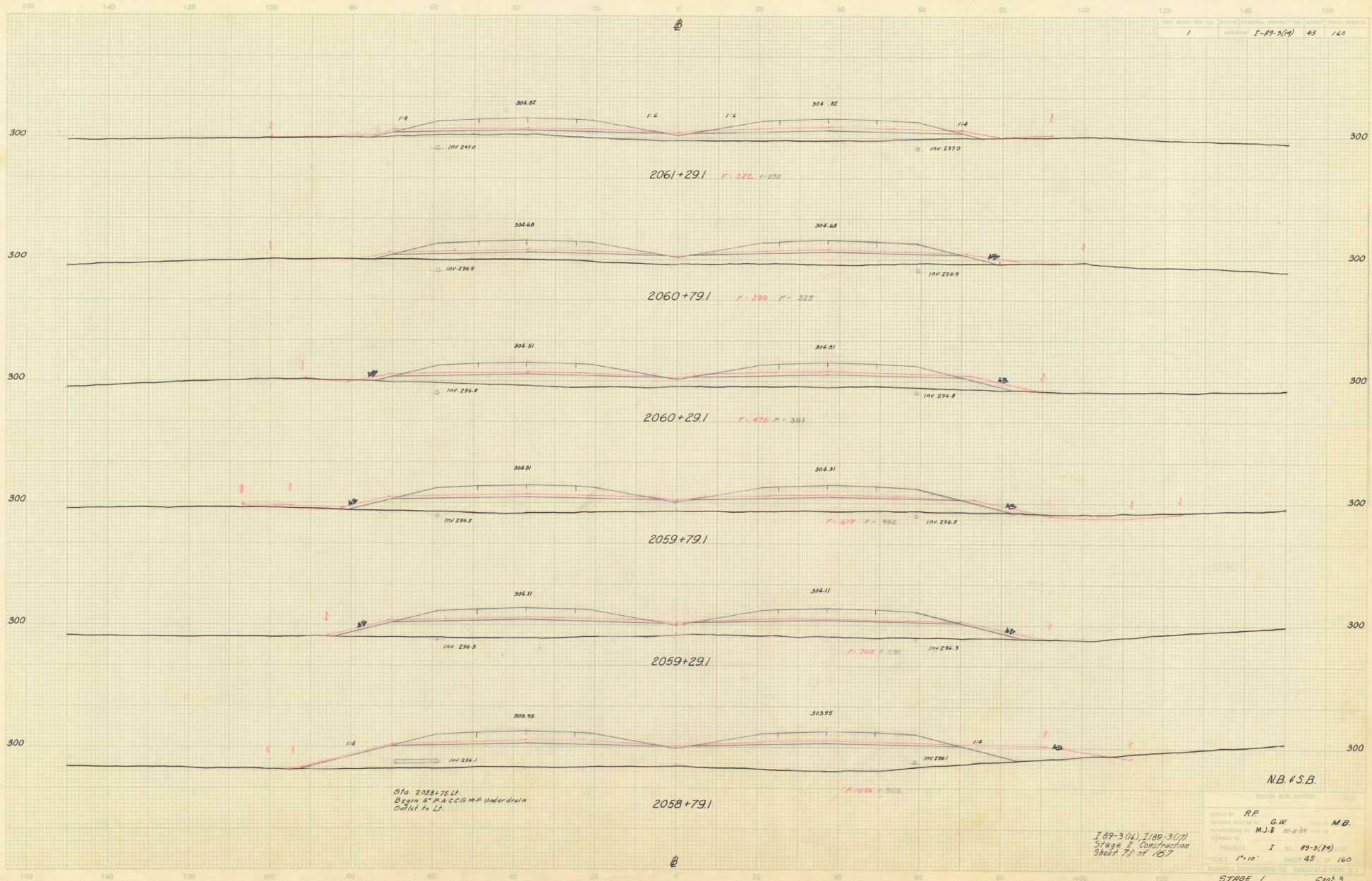

Sta. 2058+75 Lt.  
Begin 6" P.A.C.C. M.P. Underdrain  
Outlet to Lt.

I 89-3 (14), I 89-3 (17)  
Stage 1 Construction  
Sheet 71 of 167

**NB # S.B.**

SOUTH BURLINGTON

DESIGNED BY	RP	CHECKED BY	MB
REVISIONS FILED BY	GW	DATE	11-2-59
PLANNED BY	M.J.B.	SCALE	1" = 10'
PROJECT	I	NO.	89-3(14)
SCALE	1" = 10'	SHEET	45 OF 160
BURWELL ENGINEERING CO. BRIDGEFIELD PARK, N.			

STAGE 1 Cont 3

O.G. Plotted by G.W. 6-8-59  
 D.G. Cont. by M.J.B. 6-5-59

FED. ROAD DIV. NO.	STATE	FEDERAL PROJECT NO.	SHEET	TOTAL SHEETS
1			46	160

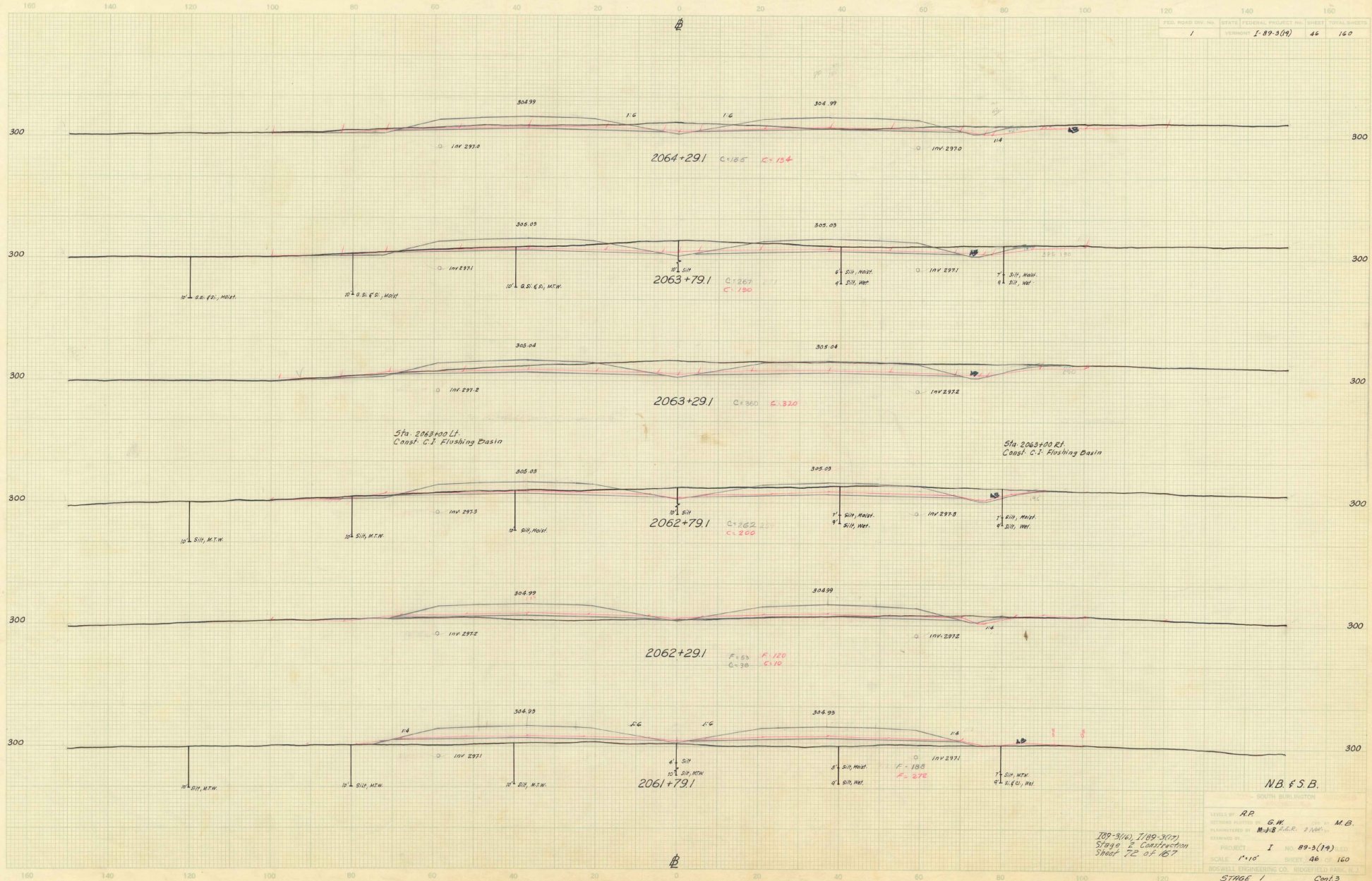

OG Profile by G.W.G./Bldg  
 OG Data by M.J.B. 9/25/53

N.B. F.S.B.  
 SOUTH BURLINGTON  
 LEVELS BY RR  
 DESIGNER BY G.W.G.  
 CHECKED BY M.J.B.  
 PROJECT I NO. 89-3(19)  
 SCALE 1"=10' SHEET 46 OF 160  
 ROWELL ENGINEERING CO. INCORPORATED  
 STAGE 1 Cont. 3

FED. ROAD DIST. NO.	STATE	FEDERAL PROJECT NO.	SHEET TOTAL
1		1-89-3(17)	47 / 160

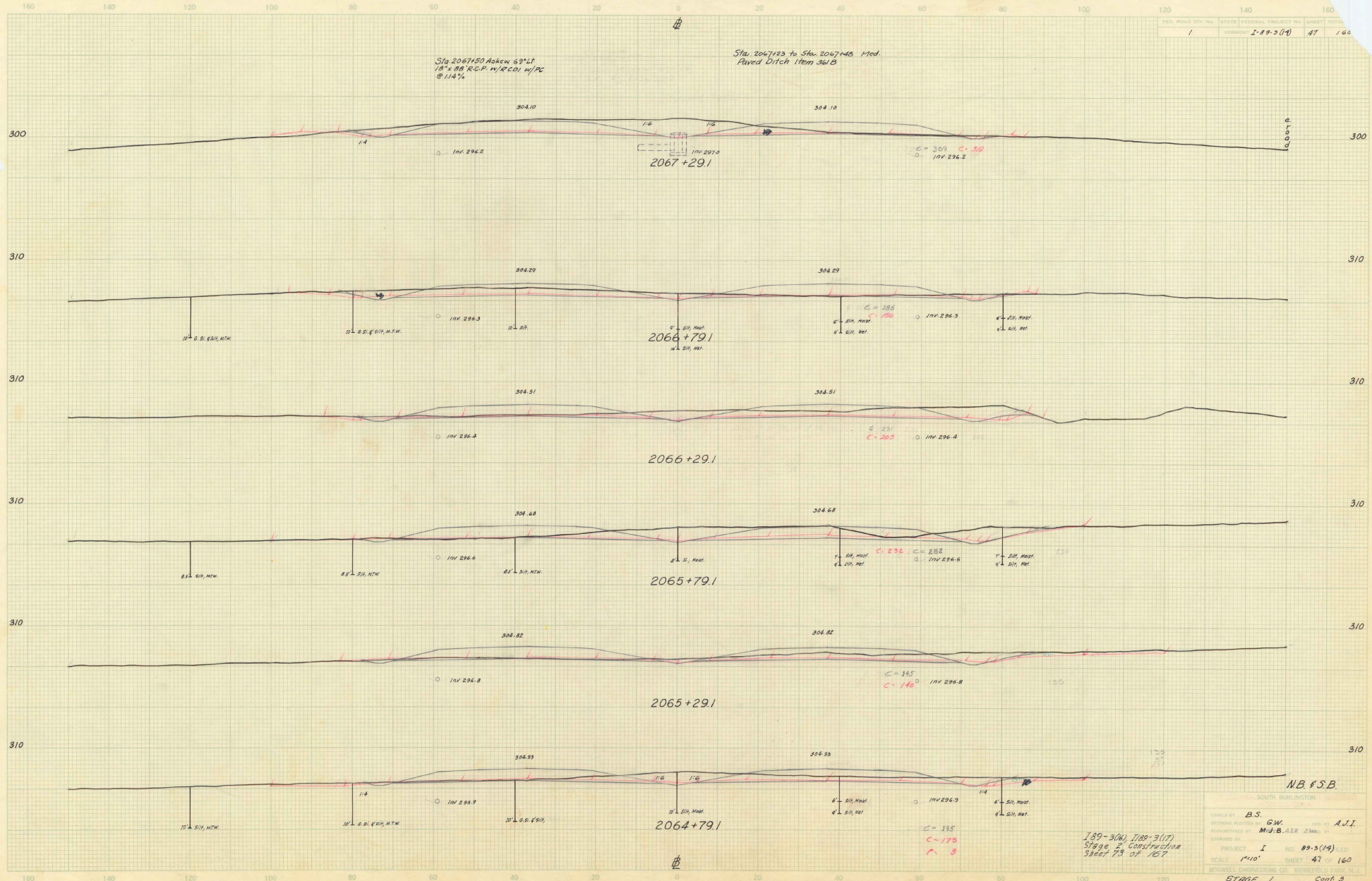

Sta. 2067+50 A&RW 63°11'  
 13" x 88' R.C.P. W/RCOI W/PC  
 @ 1.14%

Sta. 2067+85 to Sta. 2067+88 Med.  
 Paved Ditch 17cm 361.5

0.6' above by G.W. elev. 174  
 0.6' above by M.S. elev. 174  
 4/10/89

NB F.S.B.

SOUTH BURLINGTON

DESIGNED BY: B.S. G.W. CHECKED BY: A.J.I.  
 DRAWN BY: M.J.B. P.L.R. 2/10/89

PROJECT: I NO. 89-3(17) LED  
 SCALE: 1"=10' SHEET: 47 OF 160

BROOKS ENGINEERING CO. BIRCHFIELD PARK, N.J.

STAGE 1 Cont 3

189-3(17) 1789-3(17)  
 Stage 2 Construction  
 Sheet 73 of 167

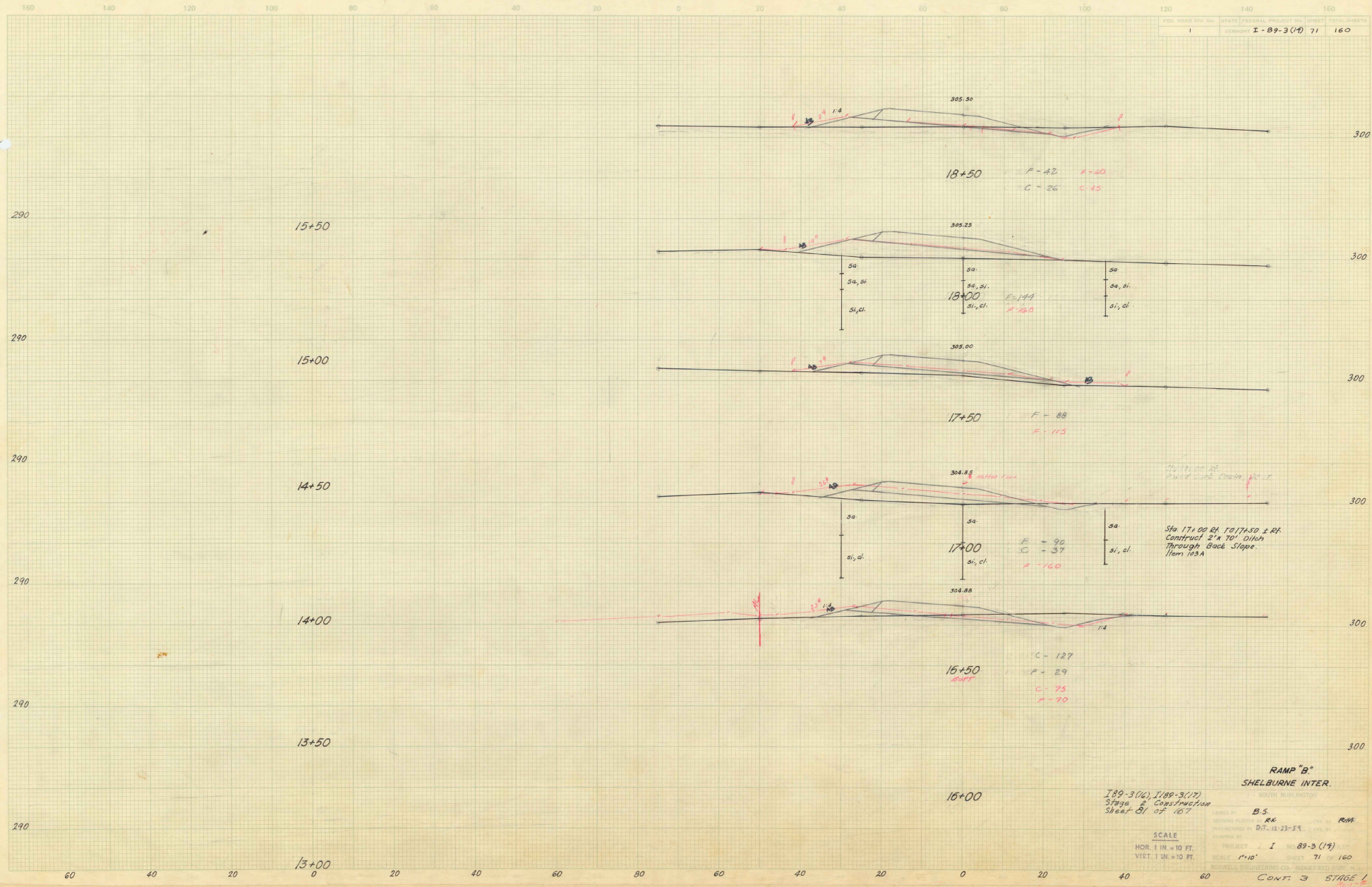

Temporary Station  
 Placed on station in  
 the vicinity of the  
 terminal station area  
 (see notes)

**RAMP "B"**  
**SHELBURNE INTER.**  
 SOUTH BURLINGTON  
 LEVEL BY B.S.  
 DRAWN BY R.K.  
 REVISIONS BY D.T. 12-23-59  
 PROJECT I 89-3 (17)  
 SCALE 1" = 10'  
 SHEET 71 OF 160  
 SCALE  
 HOR. 1 IN. = 10 FT.  
 VERT. 1 IN. = 10 FT.  
 CIVIL ENGINEERING CO. BURLINGTON, VT.  
 CONT. 3 STAGE 1

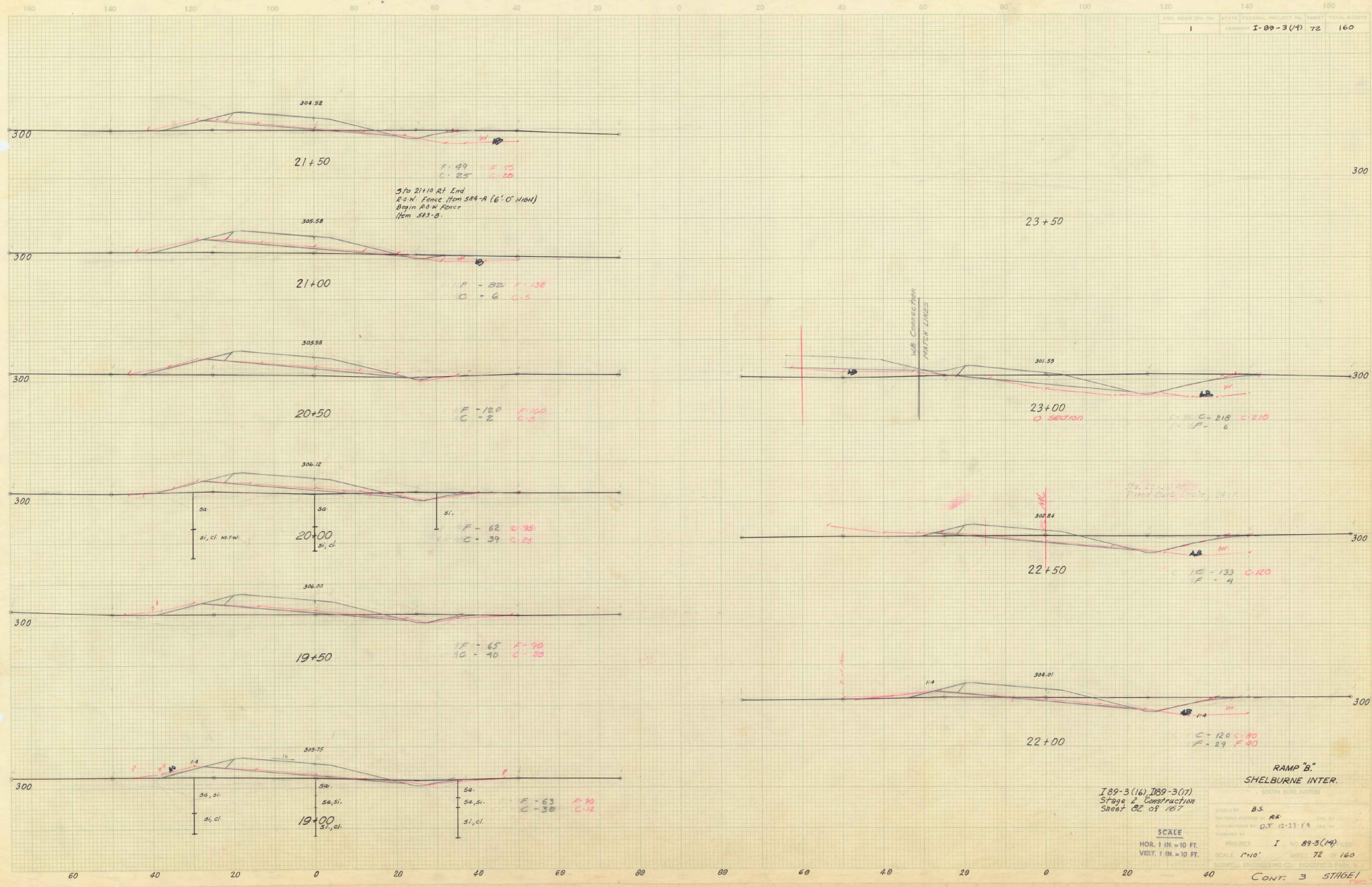

REVISIONS  
 1. PLANNING  
 2. DESIGN  
 3. CONSTRUCTION  
 4. AS-BUILT  
 5. FINAL

**RAMP "B."**  
 SHELburne INTER.  
 SOUTH BURLINGTON

I-89-3(16), I-89-3(17)  
 Stage 2 Construction  
 Sheet 72 of 167

SCALE  
 HOR. 1 IN. = 10 FT.  
 VERT. 1 IN. = 10 FT.

PROJECT I-89-3(16)  
 SHEET 72 of 160  
 SOUTH BURLINGTON CO., VERMONT

CONT. 3 STAGE 1

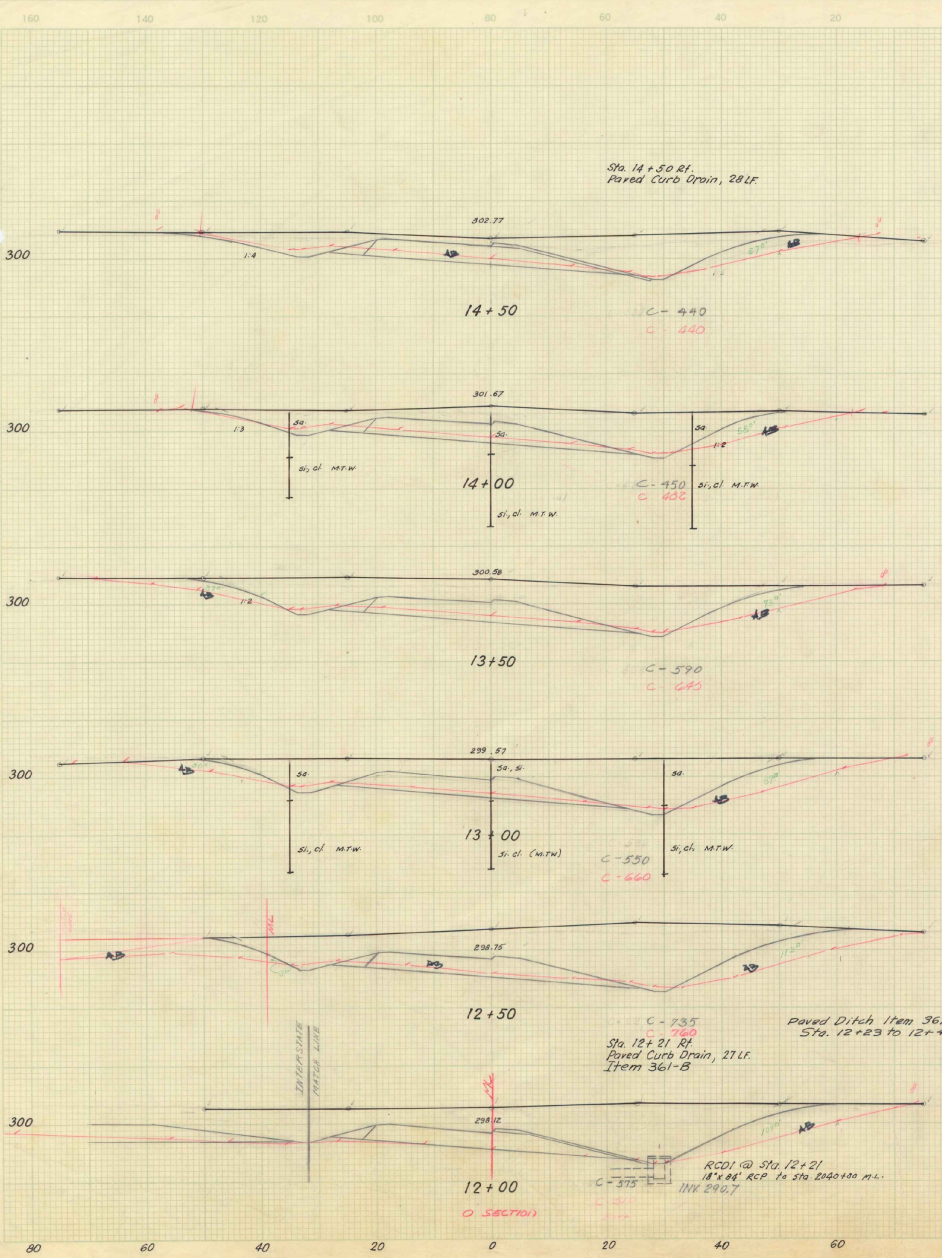

FOR CONTINUATION OF RAMP "C" SECTIONS SEE RAMP "D" & "E" COMBINED (SHEET No. 71)

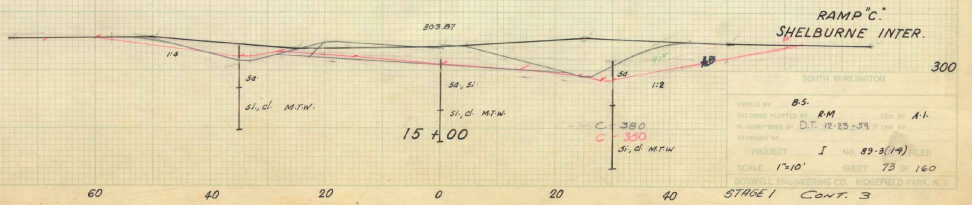

I-89-3(16), I-89-3(17)  
Stage 2 Construction  
Sheet 83 of 167

**RAMP "C" SHELburne INTER.**

SOUTH BURLINGTON

DATE: 85. RM  
 DRAWN BY: D.T. 12-23-59  
 PROJECT: I-89-3(14)  
 SCALE: 1"=10' SHEET: 73 - 160  
 SHEET: 73 - 160

STAGE 1 CONT. 3

C.B. DRAWN BY ERIC D.E. TEMPLE HARRIS, 1958

FED. ROAD DIST. NO.	STATE	FEDERAL PROJECT NO.	SHEET	TOTAL SHEETS
1	VERMONT	1-89-30(4)	74	160

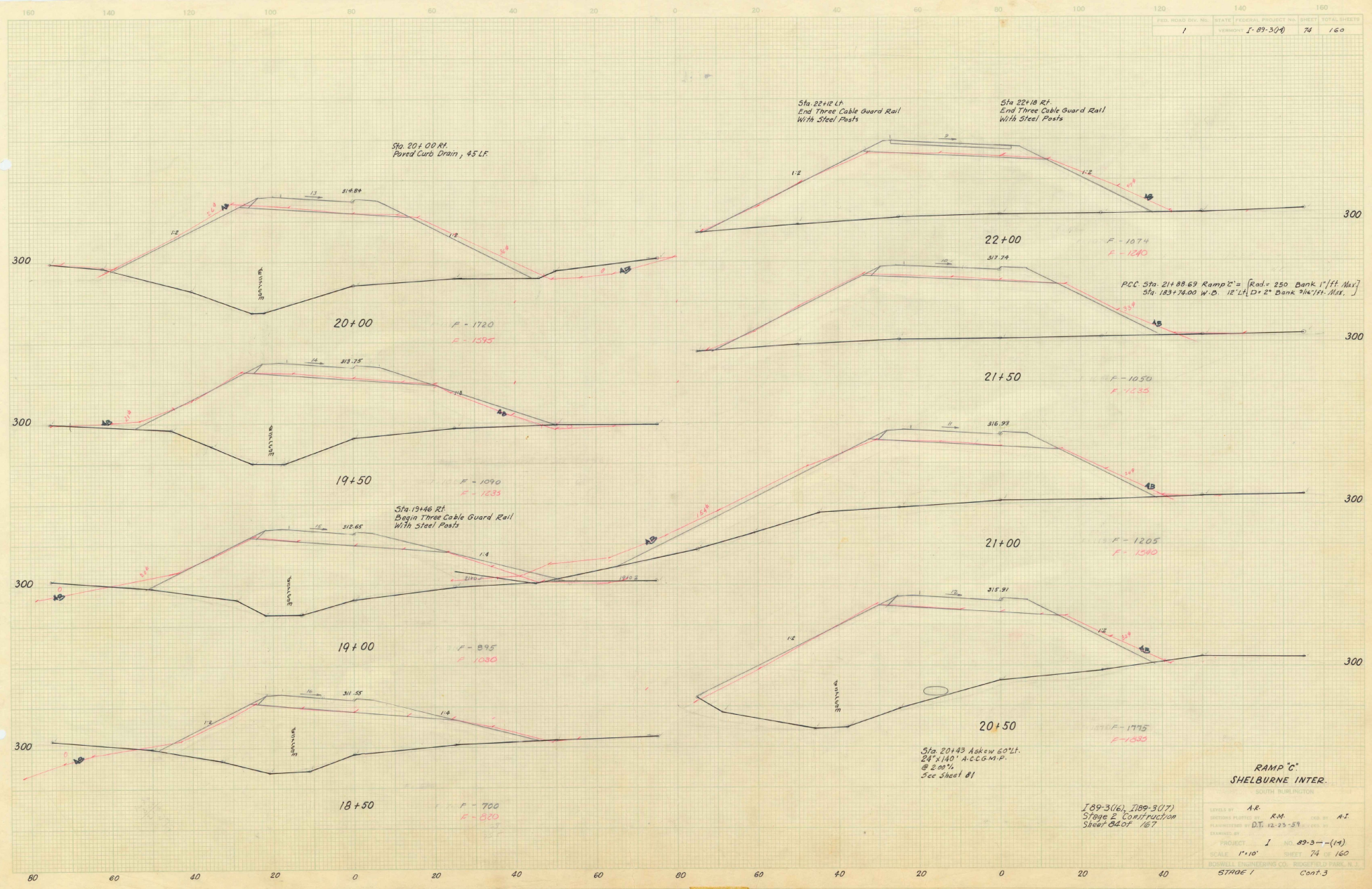

Sta. 20+00 Rt.  
Paved Curb Drain, 45 LF.

Sta. 22+12 LF  
End Three Cable Guard Rail  
With Steel Posts

Sta. 22+18 Rt.  
End Three Cable Guard Rail  
With Steel Posts

PCC Sta. 21+88.69 Ramp C's (Rad. = 250 Bank 1' ft. Max.)  
Sta. 183+74.00 W.D. 12' L.D. 2" Bank 3/4" ft. Max.

Sta. 19+46 Rt.  
Begin Three Cable Guard Rail  
With Steel Posts

Sta. 20+43 Asken 60' L.  
24' x 140' ACCOM. C.  
@ 2.00%  
See Sheet 81

**RAMP "C"**  
**SHELBURNE INTER.**

SOUTH BURLINGTON

[89-3(16), 189-3(17)]  
Stage 2 Construction  
Sheet 84 of 167

DESIGNED BY: A.R.  
CHECKED BY: R.M.  
PLANNED BY: D.T. 12-23-59  
DRAWN BY:  
PROJECT: I NO. 89-3-(14)  
SCALE: 1"=10'  
SHEET: 74 of 160  
SOUTH BURLINGTON, VERMONT  
STAGE 1 Cont. 3

D.O. Checked by [unclear] & M.E.  
 [unclear] [unclear] STA [unclear]

Flw

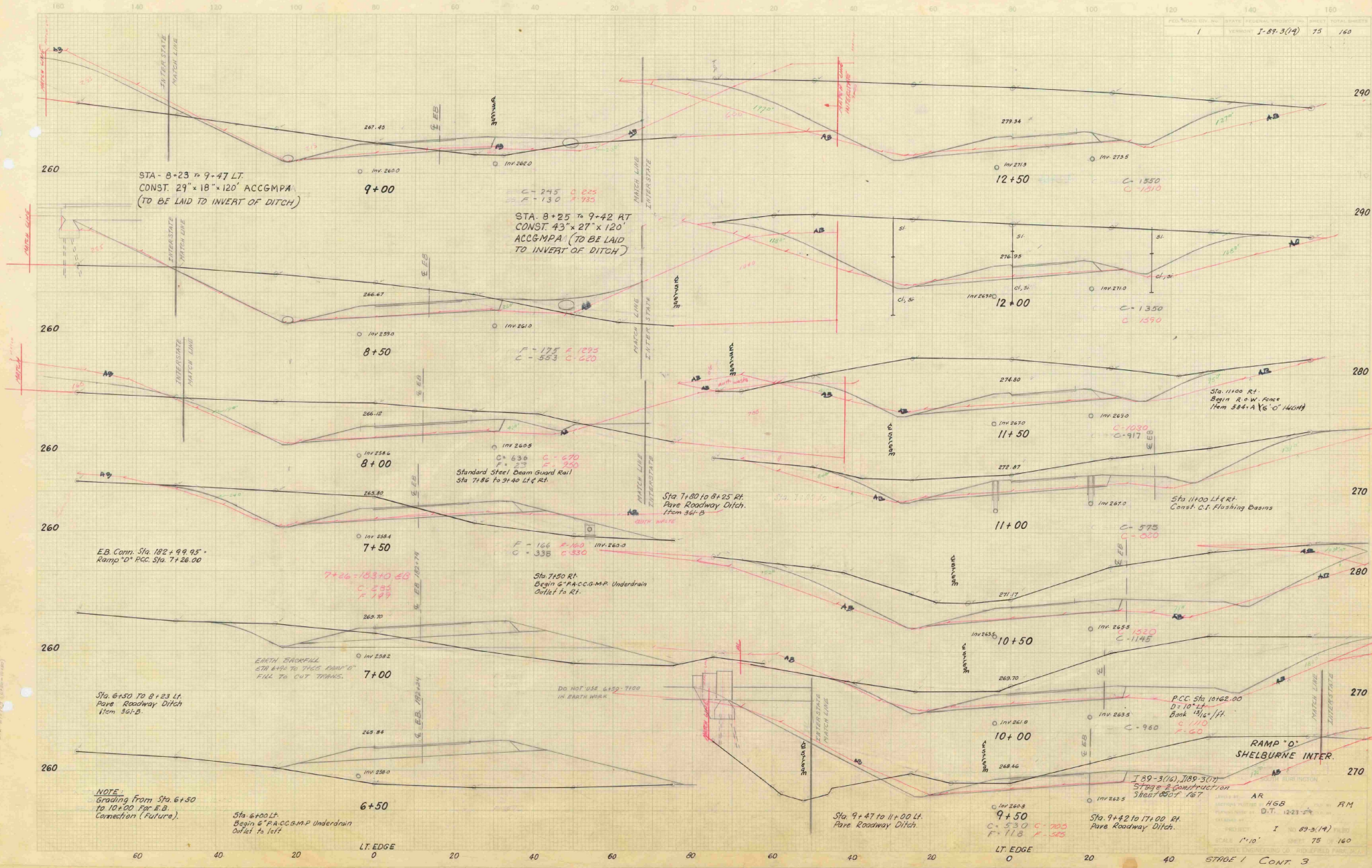

STA 8+23 to 9+47 LT.  
CONST. 29" x 18" x 120" ACCGMPA  
(TO BE LAID TO INVERT OF DITCH)

STA 8+25 to 9+42 RT  
CONST. 43" x 27" x 120"  
ACCGMPA (TO BE LAID  
TO INVERT OF DITCH)

E.B. Conn. Sta. 182 + 99.95 -  
Ramp "D" P.C. Sta. 7+26.00

Sta. 6+50 to 8+23 Lt.  
Pave Roadway Ditch  
15m. 361.5

NOTE:  
Grading From Sta. 6+50  
to 10+00 For E.B.  
Connection (Future).

Sta. 8+00 Lt.  
Begin 6" P.A.C.C.G.M.P. Underdrain  
Outlet to left

Standard Steel Beam Guard Rail  
Sta. 7+46 to 8+40 41.6 ft.

Sta. 7+80 to 8+25 Rt.  
Pave Roadway Ditch.  
From 361.5

Sta. 7+50 Rt.  
Begin 6" P.A.C.C.G.M.P. Underdrain  
Outlet to Rt.

DO NOT USE 6.50-7.00  
IN EARTH WORK

Sta. 9+47 to 11+00 Lt.  
Pave Roadway Ditch.

Sta. 9+42.10 171.00 Rt.  
Pave Roadway Ditch.

P.C. Sta. 10+62.00  
D=10' Lt.  
Bank 1/2" off.

I 89-3(10) 1189-3(10)  
Stage 2 Construction  
Sheet 0007 167

RAMP "D"  
SHELBOURNE INTER.

AR  
H.S.B.  
D.T. 1023-24  
RM

I 89-3(14)  
SCALE 1"=10'  
SHEET 75 160

STAGE 1 CONT 3

FED. ROAD DIV. NO.	STATE	FEDERAL PROJECT NO.	SHEET	TOTAL SHEETS
1	VERMONT	I-89-3(17)	76	160

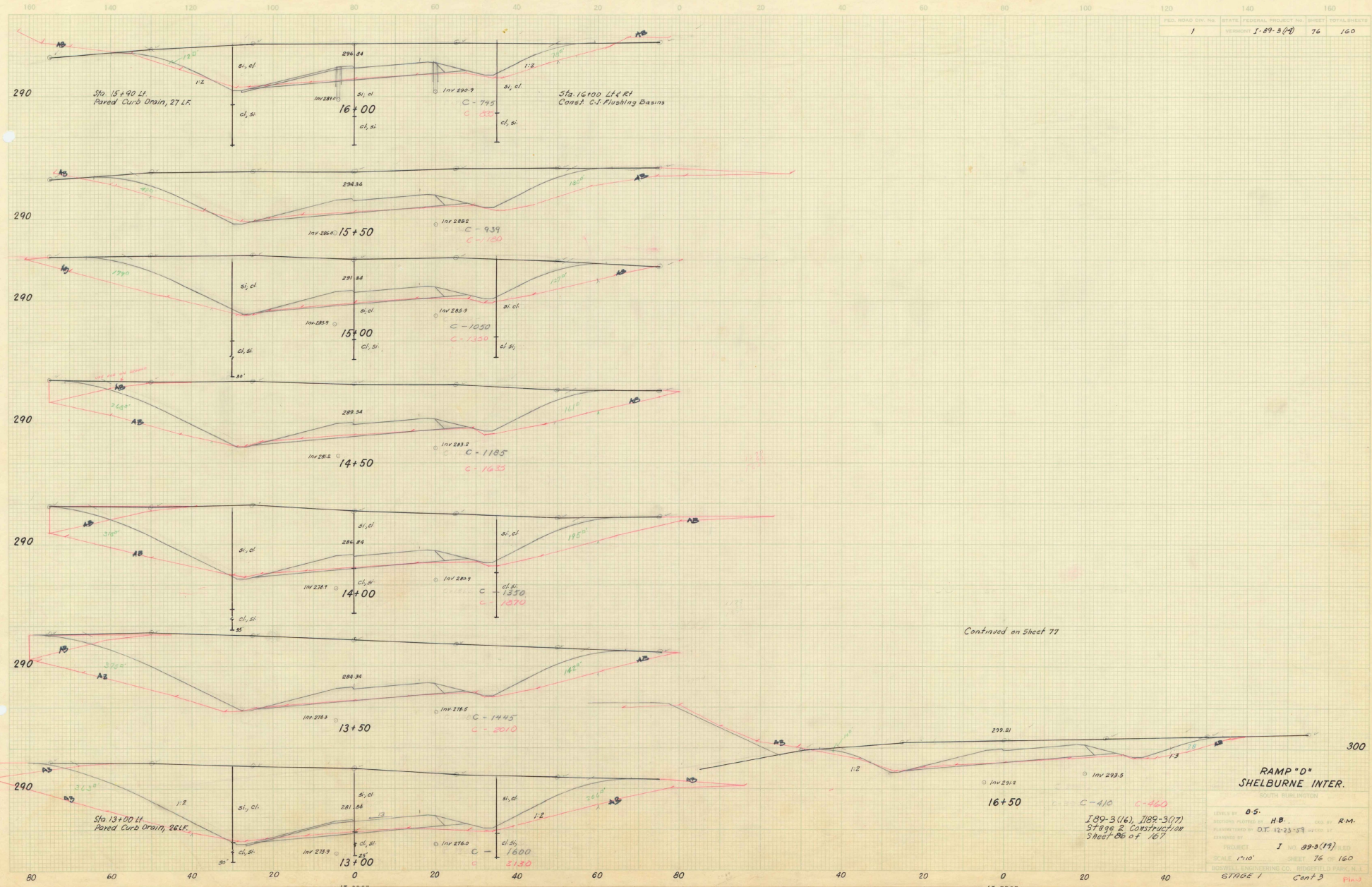

Continued on Sheet 77

**RAMP "D"**  
**SHELBURNE INTER.**

SCALE 1"=10'  
STAGE 1 Cont 3

PLOTTED BY: R.C. & S.T.C.  
 CHECKED BY: [illegible]  
 DATE: 11/11/69

I-89-3(16), I-89-3(17)  
 STAGE 2 Construction  
 Sheet 86 of 167

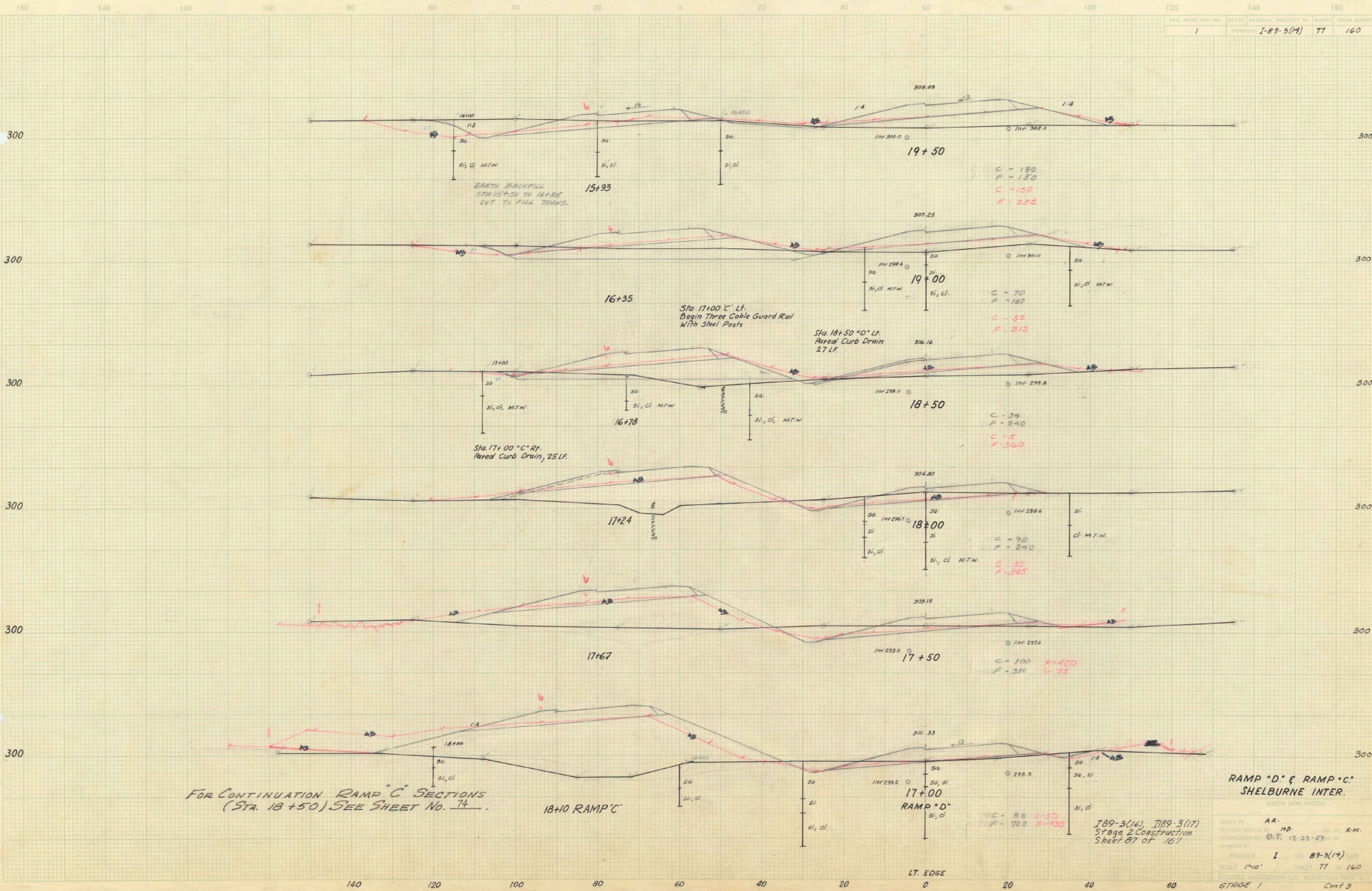

FOR CONTINUATION RAMP "C" SECTIONS  
(STA. 18+50) SEE SHEET NO. 78

18+10 RAMP "C"

LT. EDGE

RAMP "D" & RAMP "C"  
SHELburne INTER.

DESIGNED BY AR.  
CHECKED BY D.T.  
DATE 12-23-57  
PROJECT I NO. 89-3(19)  
SCALE 1"=10'  
SHEET 77 OF 160  
STAGE 1 Cont 3

789-3(16), 789-3(17)  
Stage 2 Construction  
Sheet 87 of 167

C.D. PARTIAL  
 S.O. CHECKED  
 TEMP. P.L.C. 7/2/59

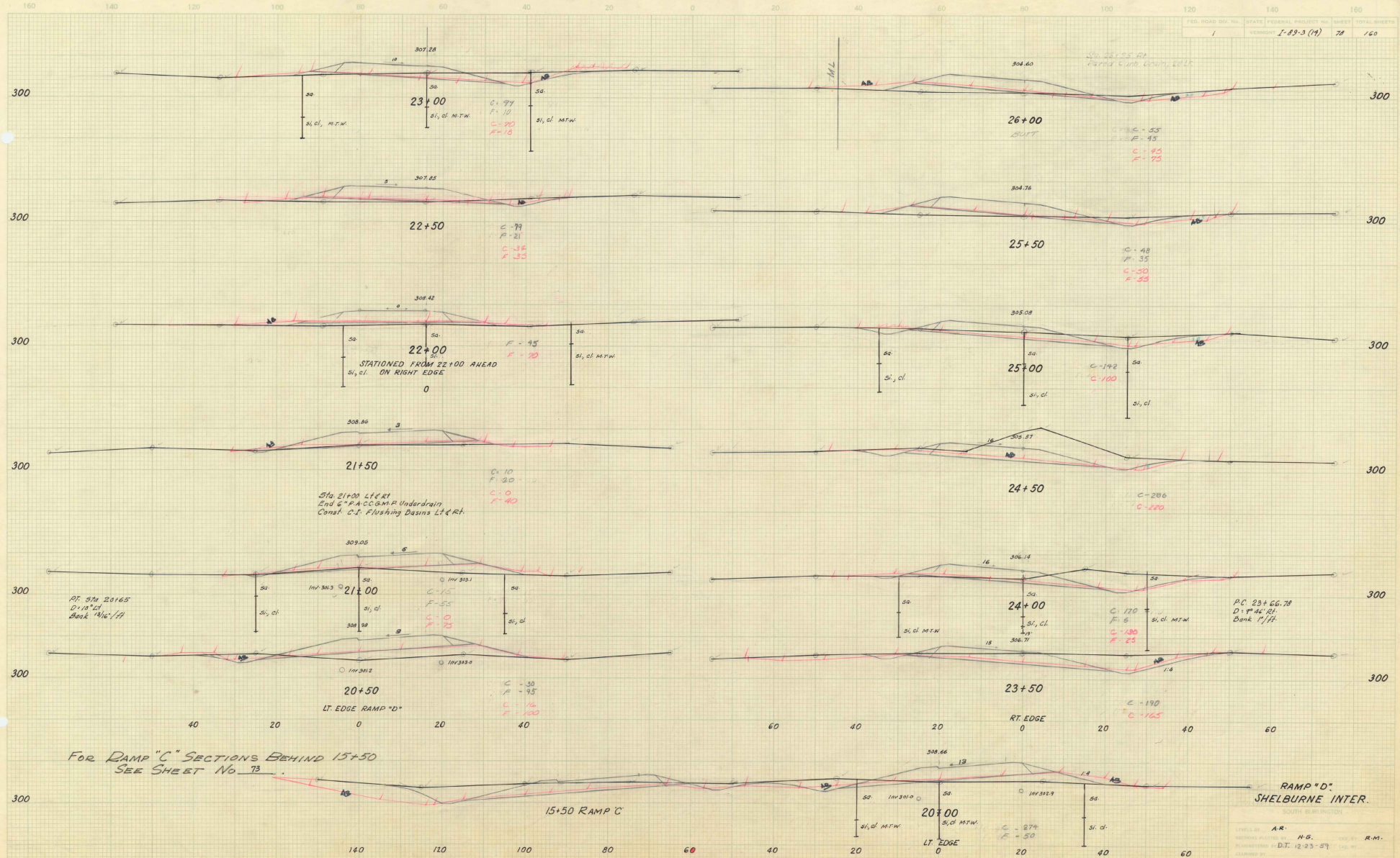

FOR RAMP "C" SECTIONS BEHIND 15+50  
SEE SHEET No. 73

PROJECT I NO. 89-3 (A)  
SCALE 1"=10'  
SHEET 78 OF 160  
STAGE 1 Cont. 3

D.G. RUMBLE, P.E., RUC & FIC  
 100 N. BURLINGTON ST., BURLINGTON, VT. 05401  
 TEL. 252-2221  
 FAX. 252-2221

FED. ROAD DIST. NO.	STATE	FEDERAL PROJECT NO.	SHEET	TOTAL SHEETS
1	Vermont	I-89-3(4)	79	160

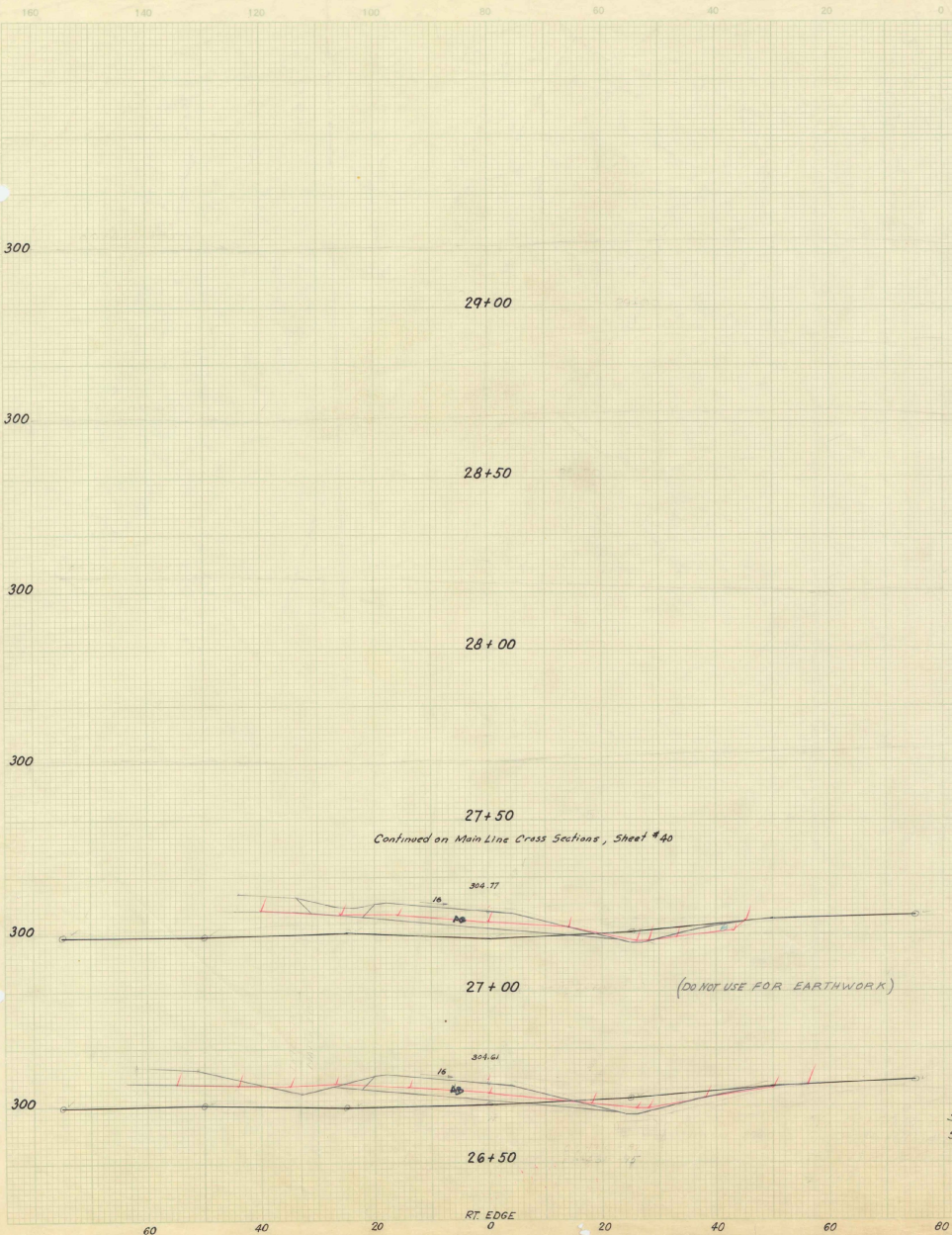

OS PLANNED BY R.C. & ETC.  
 ALL CHECKED BY R.C. & ETC.  
 ALL WORKING DRAWINGS BY R.C. & ETC.

STAGE 2 FINISHED GRADES SHOWN  
 STAGE 1 SUBGRADE ELEVATIONS 2.67 FEET  
 (2.8') BELOW  
 ITEMS ABOVE SUBGRADE NOT PART OF STAGE 1 CONSTRUCTION

I 89-3(16) I 89-3(17)  
 Stage 2 Construction  
 Sheet 89 of 167

**RAMP "D"**  
**SHELBURNE INTER.**  
 SOUTH BURLINGTON  
 DESIGNED BY AR NB  
 CHECKED BY D.T. OK  
 PROJECT I NO. 89-3(4)  
 SCALE 1"=10' SHEET 79 OF 160  
 STAGE 1 CONT. 3

FINAL SUPPLY  
 DATE BOOK  
 NO. OF SHEETS  
 SHEET NO.

DATE  
 NO. OF SHEETS  
 SHEET NO.

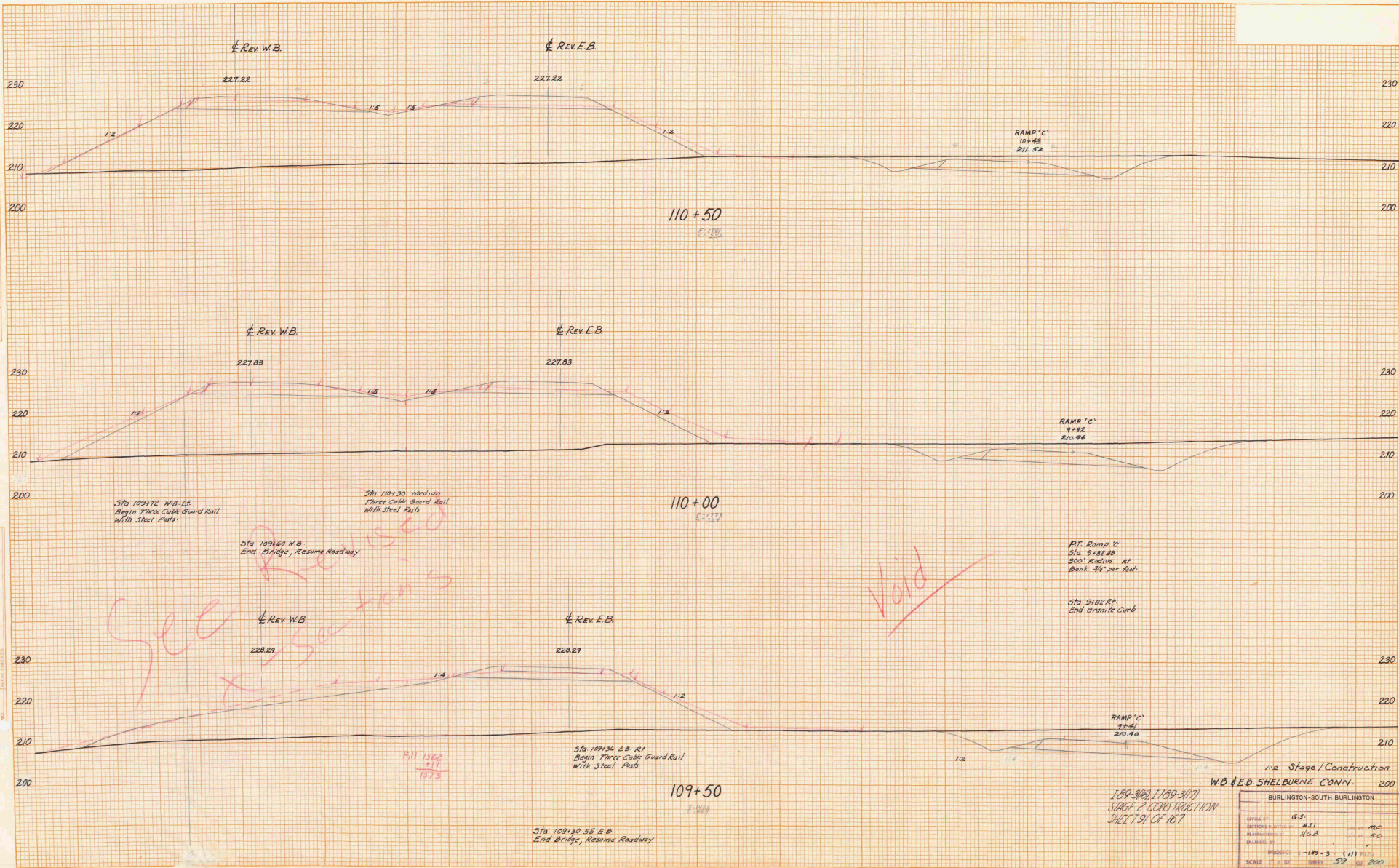

*See Revised Section*

*Void*

Sta. 109+36 E.O. R.F.  
 Begin Three Cable Guard Rail  
 With Steel Posts

Sta. 109+30.56 E.O.  
 End Bridge, Resume Roadway

PT. RAMP 'C'  
 Sta. 9+82.88  
 300' RADIUS RT.  
 BANK 3% PER FOOT

Sta. 9+82.87  
 End Granite Curb

1/2 Stage / Construction  
 W.B. & E.O. SHELBURNE CONN. 200  
 189-316, 189-317  
 STAGE 2 CONSTRUCTION  
 SHEET 59 OF 167

BURLINGTON-SOUTH BURLINGTON	
OFFICE NO.	G.S.
SECTION & POSITION	A.T.
DATE	1918
BY	R.O.
PROJECT	1-189-3- (111) F.R.D.
SCALE	1" = 20' HORIZ. 1" = 20' VERT.
BOSWELL ENGINEERING CO. RIDGEFIELD PARK N.J.	

PLAN  
 SUMMARY  
 DATE  
 DRAWN BY  
 CHECKED BY  
 NO.

PLAN  
 SUMMARY  
 DATE  
 DRAWN BY  
 CHECKED BY  
 NO.

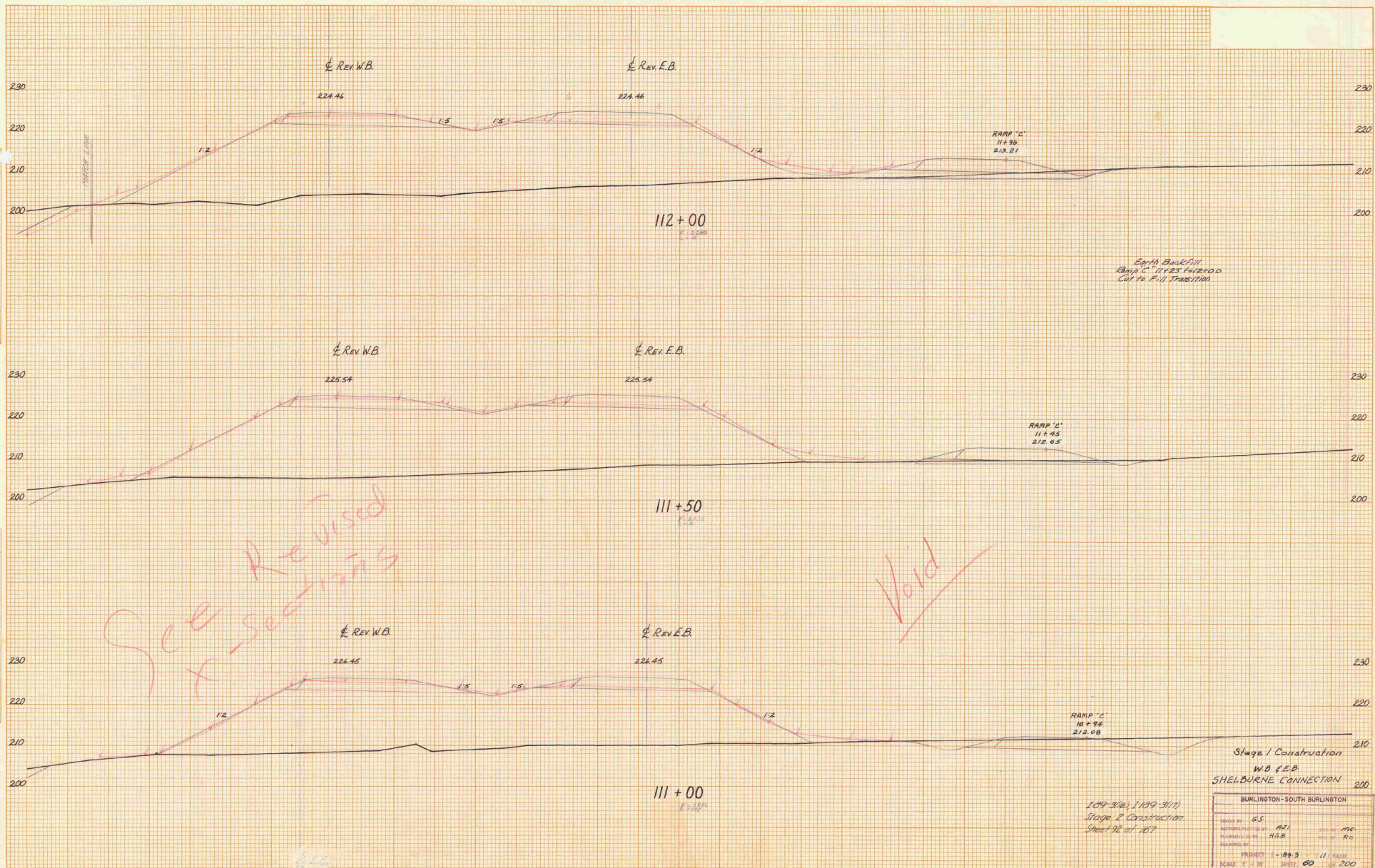

Extra Backfill  
 Bump Up 112+00  
 Cut to Full Transition

Stage 1 Construction  
 W.B. & E.B.  
 SHELBOURNE CONNECTION

109-316, 109-317  
 Stage 2 Construction  
 Sheet 92 of 167

BURLINGTON-SOUTH BURLINGTON			
DESIGN BY	GS	CHECKED BY	MC
APPROVED BY	ASL	DATE	09
PLANNED BY	HSB	SCALE	1" = 20'
PROJECT	1-189-3	SHEET	92
BOSWELL ENGINEERING CO. RIDGEBROOK PARK, N.Y.			

Final plot by Paul 2/11/82  
 Paul 2/11/82

FINAL SURVEY BOOK NO. 100  
 DATE: 1/10/1917  
 PROJECT: BURLINGTON-SOUTH BURLINGTON

FINAL SURVEY BOOK NO. 100  
 DATE: 1/10/1917  
 PROJECT: BURLINGTON-SOUTH BURLINGTON

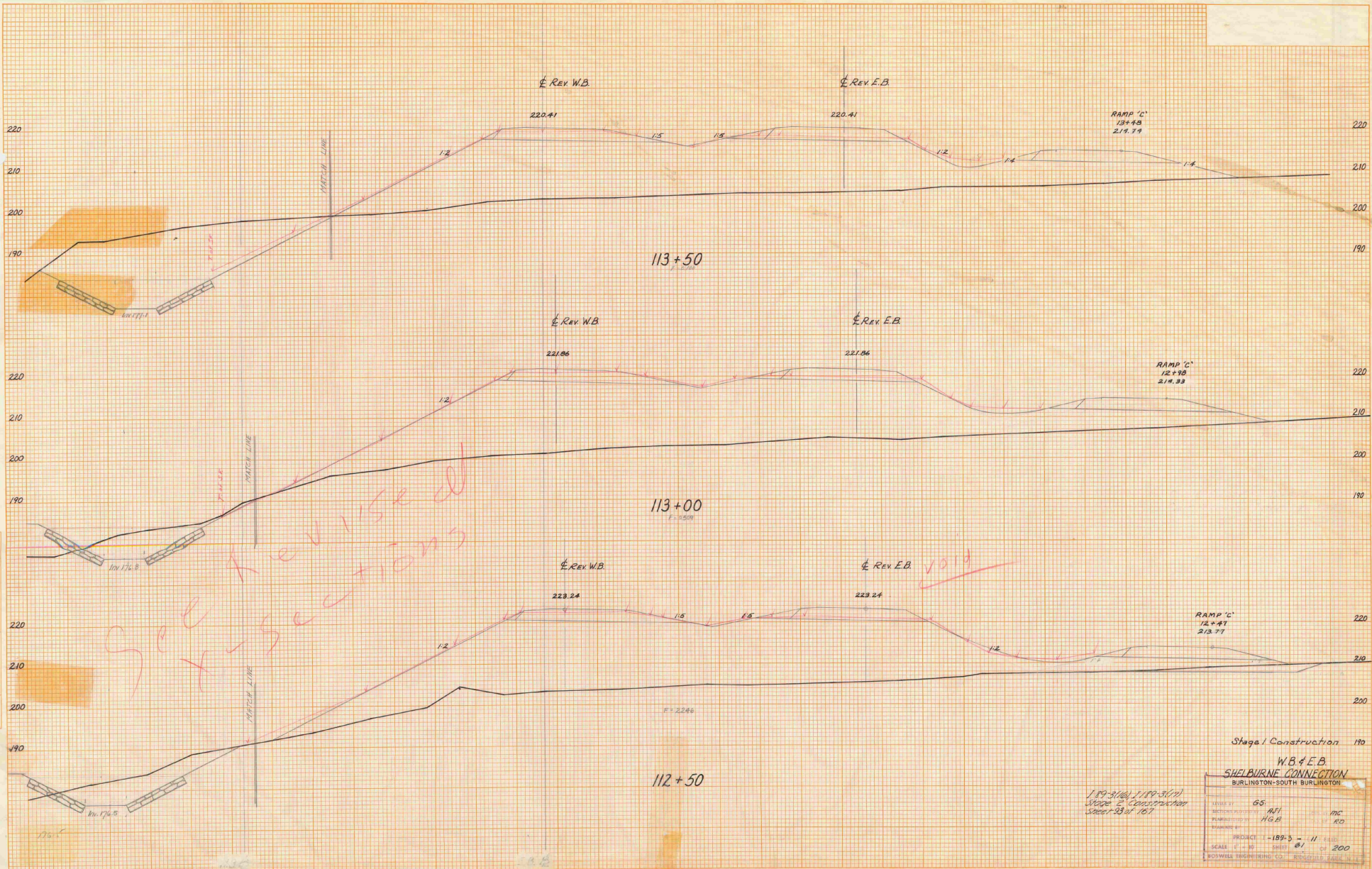

*See Revised Section*

Stage 1 Construction  
 W.B. & E.B.  
 SHELburnE CONNECTION  
 BURLINGTON-SOUTH BURLINGTON

DESIGNED BY	65	CHECKED BY	MC
PREPARED BY	ATL	APPROVED BY	RD
DATE	1/10/17	PROJECT	189-D - 11
SCALE	1" = 40'	SHEET	81
BOYD & BROTHERS CO.		BURLINGTON, VERMONT	

*189-D (11) 110-3(11)  
 Stage 1 Construction  
 Sheet 81 of 167*

**NOTE:**

Stage 2 Finished Grades Shown  
 Stage 1 Subgrade Elevation 2.67 Feet  
 (2 Ft. 8 in.) Below  
 Items Above Subgrade Not Part of  
 Stage 1 Contract

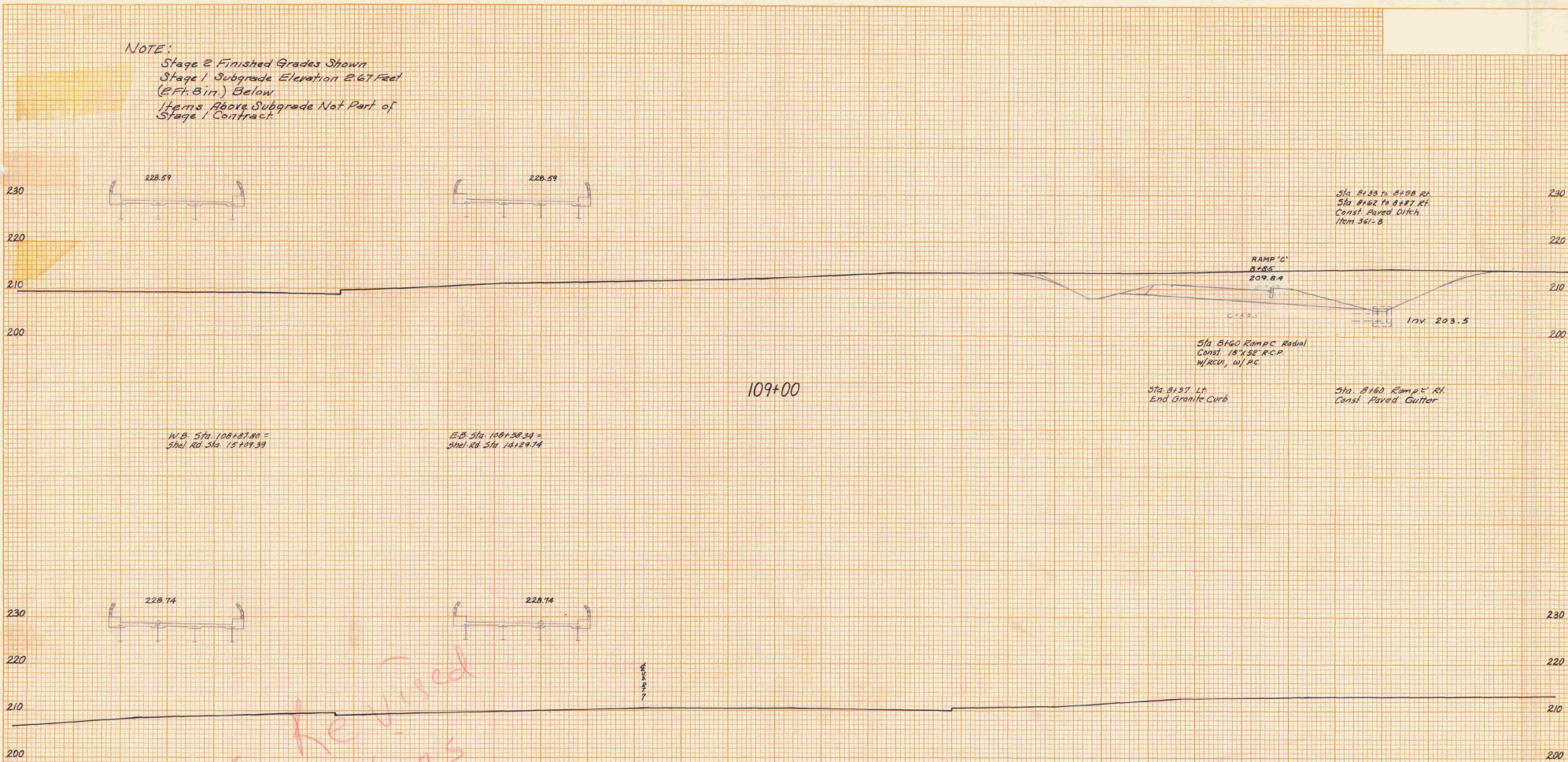

W.B. Sta 100+37.80 =  
 50ft. to Sta. 15+19.39

E.B. Sta 100+30.32 =  
 50ft. to Sta. 14+19.74

109+00

Sta 8157 L.P.  
 End Granite Curb

Sta. 8160 Ramp C Rt.  
 Const. Paved Gutter

*Get Revised  
 x-sections*

*void*

108+50

Stage 1 Construction  
 W.B. & E.B. SHELburne  
 CONNECTION

W.B. Rev

E.B. Rev

189-3162.1 (189-317)  
 STAGE 2 CONSTRUCTION  
 SHEET 90 OF 167

BURLINGTON-SOUTH BURLINGTON			
DATE:	6.5.		
DESIGNER:	A.J.I.	MC	
ENGINEER:	H.G.B.	RO	
PROJECT:	189-3	11	
SHEET:	90	167	
SCALE:	1" = 20'		
BOSWELL ENGINEERING, CO. 1100 STATE ST. BURLINGTON, VT.			

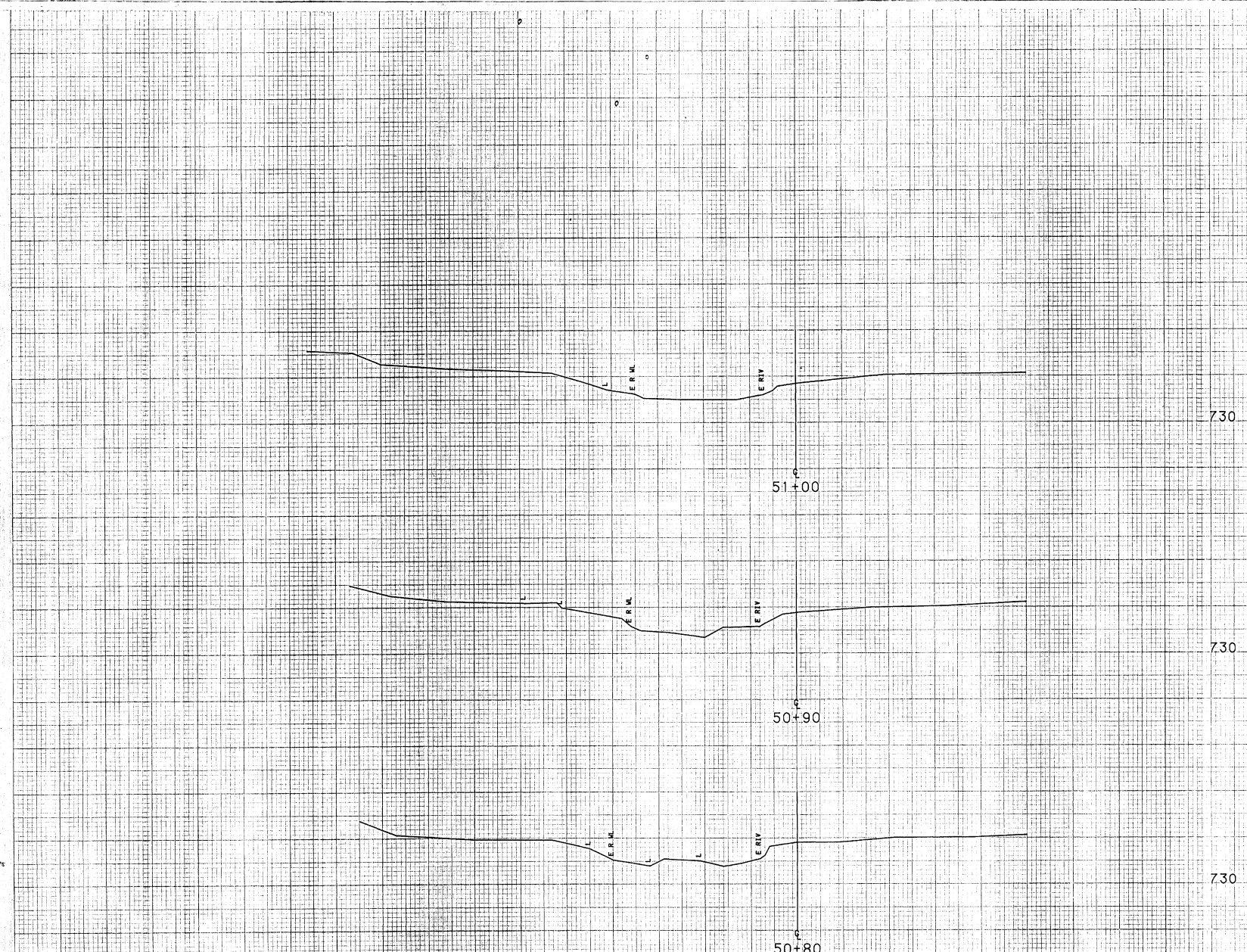

FROM STA. 50+80 TO STA. 51+00  
 PROJECT NAME MIDDLETOWN SPRINGS CHAMMEL  
 NO. BR21443 (25) PLOTTED 04/24/91  
 SURVEYED BY GILMAN 04/91 0342  
 SHEET OF SHEETS

SCALE 1" = 10' FEET

\* C/3  
19 61  
62

Williston - So. Burlington  
I-89-3 (14) C/3

19 61  
62