

Note: For Details of Deck Construction see BR 109  
For railing Details see SB-R1-64 and SB-R2-65  
For Curb Details see SCB-06-67

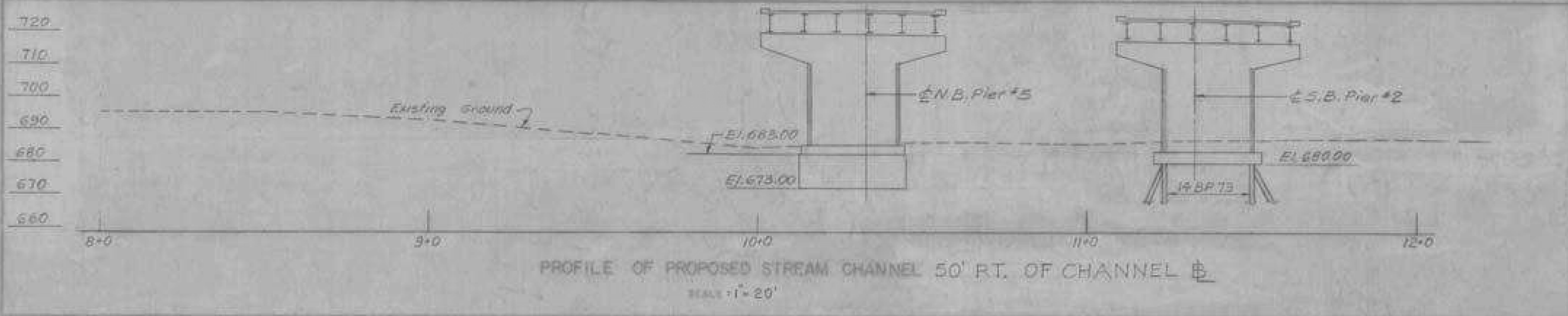
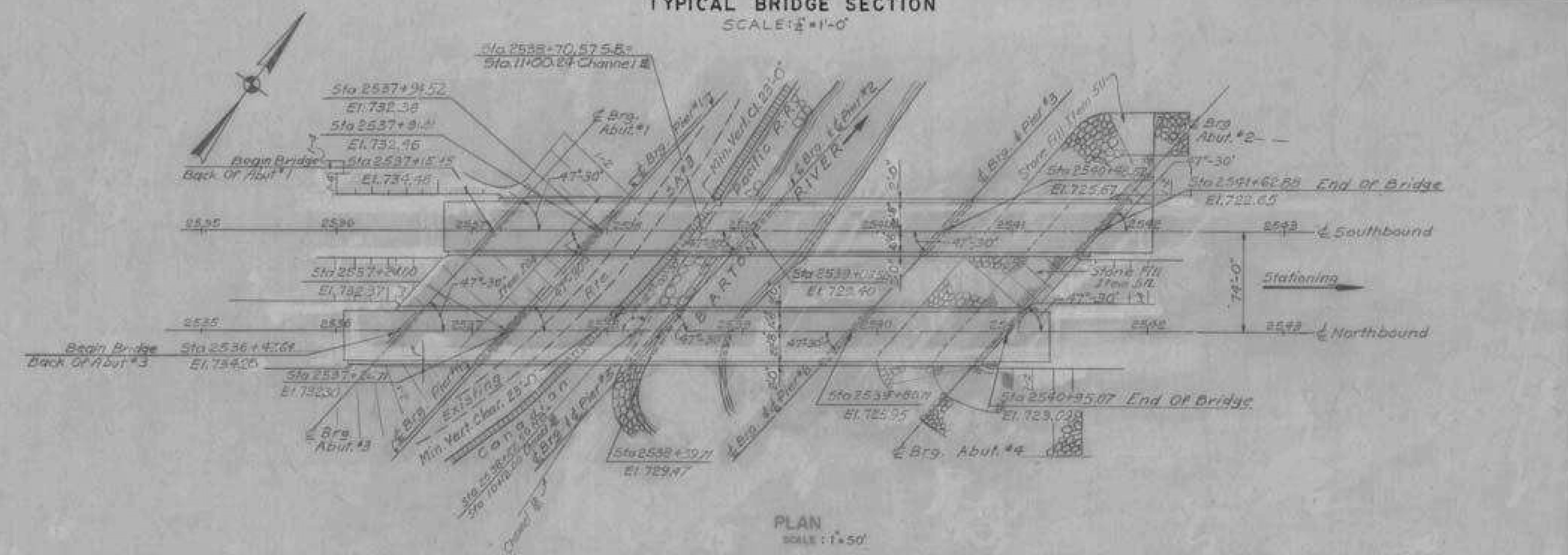
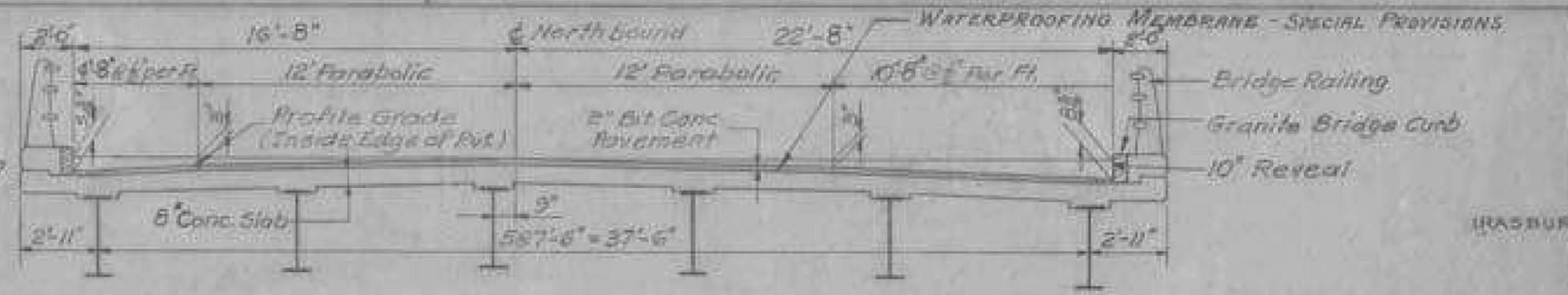

ROADWAY NO.	I-91	NAME OF HIGHWAY	INTERSTATE
STRUCTURE NO.		COUNTY	ORLEANS
		TOWN	IRASBURG
PROJECT NO.	I-91-3(B)	LOCATION	I-91 OVER BARTON RIVER, C.P.R.R. and Irasburg SA '3

EXISTING STRUCTURE	
1 RATED LOADING OF EXISTING STRUCTURE	N.A.
2 TYPE OF EXISTING STRUCTURE	N.A.
3 UNDERCLEARANCE ELEVATION OF EXISTING STRUCTURE	N.A.
4 WHAT DISPOSITION SHOULD BE MADE OF EXISTING STRUCTURE?	N.A. COST OF REMOVAL N.A.
5 SHOULD EXISTING STRUCTURE BE USED TO MAINTAIN TRAFFIC DURING CONSTRUCTION OF NEW STRUCTURE?	N.A.
6 SHOULD NEW TEMPORARY STRUCTURE BE BUILT?	N.A.
7 HIGHWAY HIGH WATER SURFACE ELEV. AT EXISTING STRUCTURE	N.A. WATERWAY TO ORDINARY H.W. N.A.
8 EXTREME HIGH WATER AT EXISTING STRUCTURE	N.A. WATERWAY TO EXTREME H.W. N.A.
9 SPAN OF EXISTING BRIDGE	N.A. WATERWAY TO EXTREME H.W. STRUCTURE TYPE 1800 SF
10 TYPE OF FOUNDATION UNDER EXISTING ABUTMENTS	N.A.
11 DOES ALL WATER AT FLOOD ELEVATION PASS THROUGH EXISTING STRUCTURE?	N.A.
12 IF NOT AT WHAT ELEVATION IS RELIEF AFFORDED?	N.A.
13 ADDITIONAL WATERWAY AREA PROVIDED	N.A.

NEW STRUCTURE	
1 RECOMMENDED TYPE OF STRUCTURE	ONE SINGLE SPAN COMB. 3000 WIDE 2 GIRDER (CONTINUOUS) CONC.
2 RECOMMENDED CLEAR SPAN OR SPANS	75.0-113.0-141.0-113.0
3 MEASURED PARALLEL TO & NEW HIGHWAY	75.0-113.0-141.0-113.0
4 MEASURED AT RIGHT ANGLES TO & STREAM	55.0-84.0-104.0-84.0
5 ARE THERE OBJECTIONS TO A PIER IN THE STREAM UNDER YES OR NO	No
6 ORDINARY HIGH WATER SURFACE ELEV. AT NEW STRUCTURE	697.0
7 EXTREME HIGH WATER SURFACE ELEV. AT NEW STRUCTURE	697.0 SOURCE OF INFORMATION COMPILED
8 IS ALL WATER INTENDED TO PASS THROUGH NEW STRUCTURE?	Yes
9 DOES STREAM SEARCH ITS MAXIMUM HIGH WATER ELEVATION FREELY?	No IS ORDINARY FLOOD SAFETY? No
10 LOW WATER SURFACE ELEV. AT NEW STRUCTURE	690.0
11 DRAINAGE AREA IN ACRES ABOVE STRUCTURE	99.3/2 CHARACTER OF TERRAIN ROLLING
12 IS STREAM EVER DRY?	No
13 VELOCITY OF STREAM AT HIGH WATER STAGE	6.21 C.F.S. ESTIMATED DISCHARGE 1000 C.F.S.
14 AREA FULL OPENING	1282.3 SF AREA BELOW OBSTACLE H.W. 1000 SF
15 CHARACTER OF SOILS	DRIFT NAME IS MEDIUM
16 ESTIMATED DRAINAGE AREA ABOVE NATURAL OR ARTIFICIAL OBSTACLE	135.8 SQ. MI.
17 VERTICAL CLEARANCE ABOVE FLOOD ELEVATION	18 FT. BOTH SIDES
18 ARE SIDEWALKS REQUIRED? & 20 OR WAYS SIDE?	No
19 RECOMMENDED TYPE OF FAVEMENT	2 BITUMINOUS CONCRETE, 8" CONCRETE
20 TRAFFIC TO BE MAINTAINED UNDER PIER NO.	N.A. ONE OR TWO WAYS PROBABLE COST
21 PROBABLE COST OF CLEANING AND GRUBBING STREAM CHANNEL AT STRUCTURE SITE	\$1000.
22 SHOULD PROVISIONS BE MADE FOR PUBLIC UTILITIES?	No
23 ESTIMATED ALLOWABLE LOAD ON FOUNDATIONS	SHOULD PILES BE USED? * EST. LTR. *

FOUNDATION INFORMATION	
OBTAINED FOR DESIGN PURPOSES ONLY, AND THE STATE ASSUMES NO RESPONSIBILITY WHATSOEVER FOR THE SUFFICIENCY OR ACCURACY OF THE INFORMATION SHOWING BUILDERS MAY BE ENCOUNTERED AT ANY PIER OR ABUTMENT LOCATION.	
Pier No. 4 & 5	5 Tons / 5 P.
Abutment No. 2	12 BP 53 110' Long
Abutment No. 1 & 3	12 BP 53 20' Long; 58 Tons / Pile Max.
Abutment No. 4	12 BP 53 100' Long
Pier No. 1	14 BP 73 20' Long
Pier No. 2	14 BP 73 30' Long
Pier No. 3	14 BP 73 25' Long
Pier No. 6	14 BP 73 45' Long

**Design Stresses:**  
Concrete  $f'_c = 3000$  p.s.i.  $f_c = 1200$  p.s.i.  
Structural Steel  $f_s = 20,000$  p.s.i. (A-36) others per AASHTO Specs  
Reinforcing Steel  $f_s = 20,000$  p.s.i. Tension  
 $f_c = 15,000$  p.s.i. Compression  
Welding per A.W.S. Specs.  
**Design Loading:** HS 20-44

Stage 2 Construction  
Br. 103 OF 120

RECOMMENDED FOR APPROVAL	<i>[Signature]</i> 7-15-69	DATE
RECOMMENDED FOR APPROVAL	<i>[Signature]</i> 9-15-69	DATE
RECOMMENDED FOR APPROVAL	<i>[Signature]</i> 9-15-69	DATE
APPROVED BY	<i>[Signature]</i> 9/15/69	DATE

CHANGED ROADWAY WIDTH FROM 38'0" TO 39'4"  
CHANGED CURB WIDTH FROM 2'-8" TO 2'-0" 9/15/69

STATE OF VERMONT	BR 107
DEPARTMENT OF HIGHWAYS	
PROJECT	BARTON - DERBY
ROUTE NO	I-91 STA. 2539'
	I-91 OVER BARTON RIVER, C.P.R.R. & IRASBURG SA '3
PRELIMINARY INFORMATION SHEET	
PROJECT	EMPT 91-3(20) SHEET 110 OF 175

IRASBURG  
IM DECK (46)  
BRIDGE NO. 107N  
SHEET 35 OF 49  
FOR REFERENCE ONLY