

PLAN  
 UNLIMITED  
 NOTE BOOK  
 INVENT CHECKED  
 NO. 00000000  
 DATE 7/1/66

CONTROL OF ACCESS COMPLETE ON THIS SHEET

R=1400' R=500'  
 D=4°08'33" D=11°27'33"  
 L=8°03'46" L=20°43'54"  
 T=98.67' T=91.68'  
 L=197.01' L=180.92'  
 E=3.45' E=8.30'

Bank=1/4 Per Ft. Bank=1/4 Per Ft.

FOR SA 3 PROFILE SEE SHEET 97.

JUTE MATTING  
 ITEM 603

Med 2541+88 - 2544+00  
 Med 2545+00 - 2547+00  
 Med 2548+00 - 2550+00  
 Med 2550+00 - 2552+00

PROPERTY LINE FENCE  
 W/STEEL POSTS ITEM 589 B Mod

SB 2536+00 - 2539+05 LT  
 NB 2536+00 - 2539+60 RT  
 SB 2541+30 - 2552+00 LT  
 NB 2540+30 - 2552+00 RT

DEMOLITION AND DISPOSAL OF  
 BUILDING MOD ITEM 588

SB 2538+00 RH

STANDARD STEEL BEAM GUARD  
 RAIL W/STEEL POSTS ITEM 545-A

54" x 9" 920 - 111.00 LF (2" x 4")

TREATED TIMBER CURB  
 ITEM 558

NB 2540+16 - 2546+00 RT  
 NB 2549+15 - 2551+00 LT

THREE CABLE GUARD  
 RAIL W/ LIGHT STEEL POSTS  
 ITEM 538

NB 2541+46 - 2546+00 RT  
 NB 2549+15 - 2551+00 LT

BRIDGE DAILING FOR BRIDGE  
 APPROACH ITEM 572

NB 2536+00 - 2536+57 LT  
 NB 2536+00 - 2536+08 RT  
 SB 2536+00 - 2536+72 RT  
 SB 2536+10 - 2537+31 LT  
 NB 2541+27 - 2542+89 LT  
 NB 2540+21 - 2541+33 RT  
 SB 2541+35 - 2543+90 RT  
 SB 2542+01 - 2544+26 LT

Jute Matting  
 SB 2551+00 - 2551+20

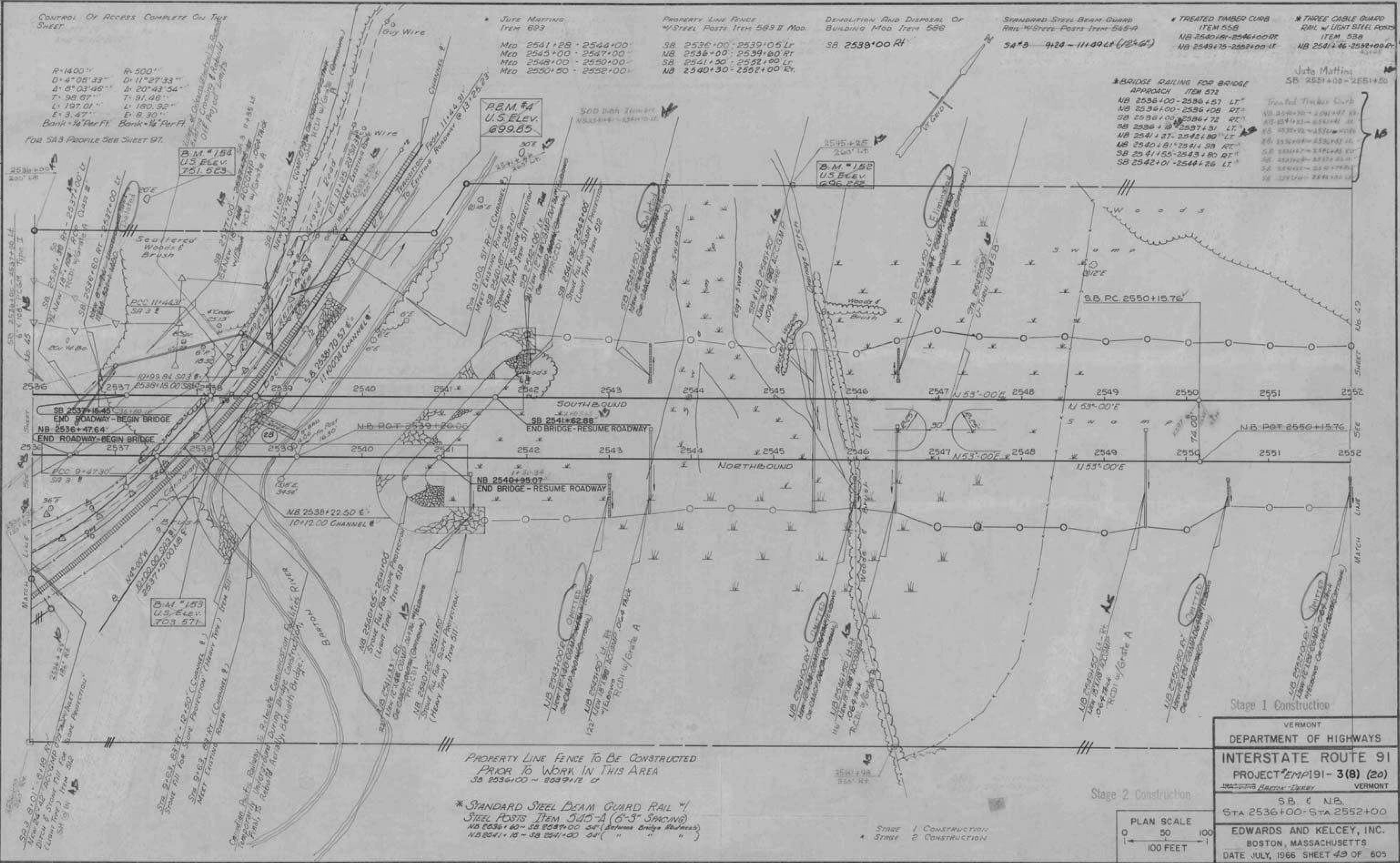

PROPERTY LINE FENCE TO BE CONSTRUCTED  
 PRIOR TO WORK IN THIS AREA  
 SB 2536+00 - 2549+12 LT

\* STANDARD STEEL I-BEAM GUARD RAIL W/  
 STEEL POSTS ITEM 545-A (6" x 3" SPACING)  
 NB 2536+00 - SB 2549+00 54" (Between Bridge Railings)  
 NB 2541+15 - SB 2541+00 54" ( " " " )

Stage 1 Construction

Stage 2 Construction

PLAN SCALE  
 0 50 100  
 100 FEET

VERMONT DEPARTMENT OF HIGHWAYS INTERSTATE ROUTE 91 PROJECT EMP191-3(8) (20) VERMONT
S.B. & N.B. STA 2536+00 - STA 2552+00
EDWARDS AND KELCEY, INC. BOSTON, MASSACHUSETTS DATE JULY, 1966 SHEET 49 OF 605

Sheet 60 of 173 Sheets

IRASBURG  
 IM DECK(46)  
 BRIDGE NO. 107N  
 SHEET 32 OF 49  
 FOR REFERENCE ONLY