

STATE OF VERMONT AGENCY OF TRANSPORTATION



PROPOSED IMPROVEMENT TOWNS OF BERLIN & MONTPELIER COUNTY OF WASHINGTON INTERSTATE ROUTE 89 (NB)(PRINCIPAL ARTERIAL - NHS)

BEGINNING IN THE TOWN OF BERLIN AT MM 47.370 AND EXTENDING NORTHERLY
ALONG INTERSTATE ROUTE 89 (NORTHBOUND LANE) FOR A DISTANCE OF
27,086.40 FEET (5.130 MILES) TO MM 52.500 IN THE TOWN OF MONTPELIER.

LENGTH OF ROADWAY = 27,086.40 FEET (5.130 MILES)
LENGTH OF PROJECT = 27,086.40 FEET (5.130 MILES)

WORK TO BE PERFORMED UNDER THIS PROJECT INCLUDES SURFACE PREPARATION INVOLVING
PATCHING, POT HOLE REPAIR, CRACK SEALING, HOT-IN-PLACE RECYCLING AND OVERLAYING WITH
A THIN BITUMINOUS SURFACE TREATMENT, TRAFFIC MARKINGS AND OTHER HIGHWAY RELATED ITEMS.

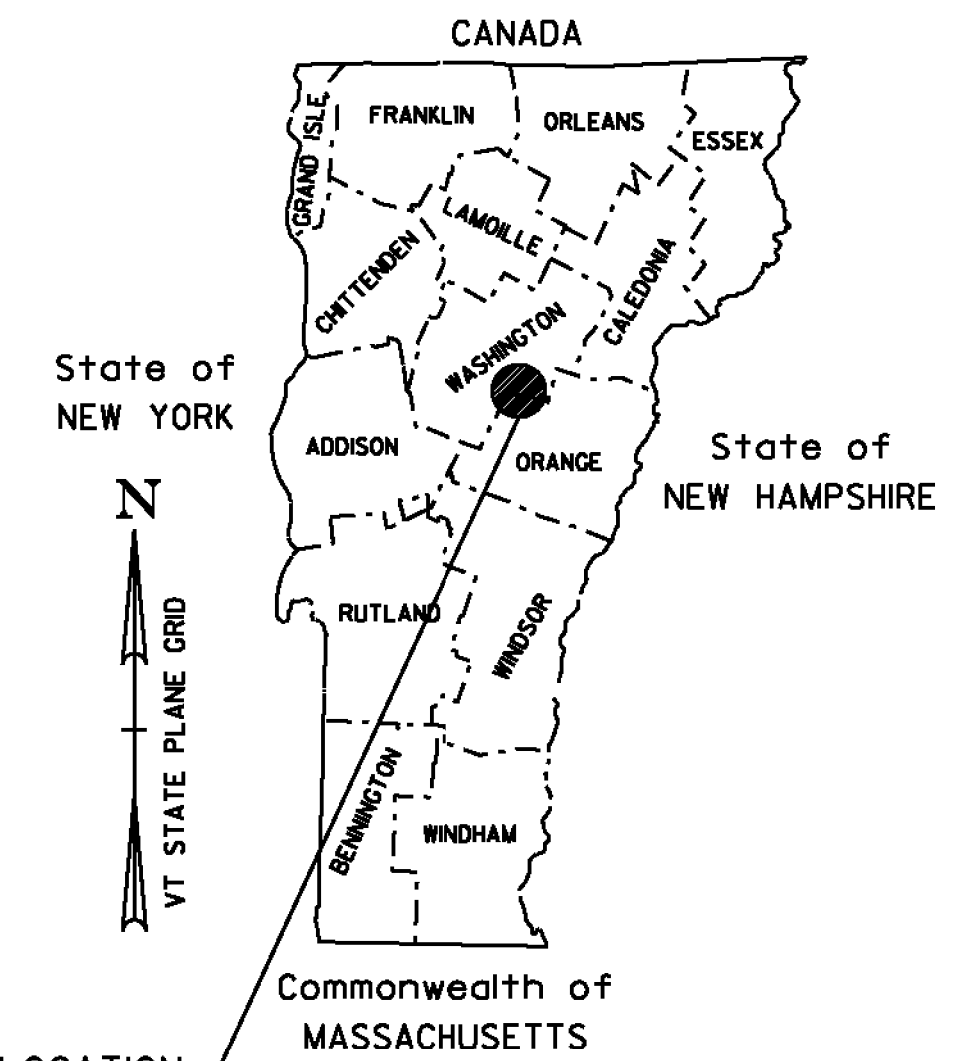

PROJECT LOCATION
BERLIN-MONTPELIER
IM SURF(45)

TRAFFIC DATA						
I-89 NORTHBOUND	2014 AADT	2024 AADT	2014 DHV	2024 DHV	FLEXIBLE ESALS (2014-2024)	FLEXIBLE ESALS (2014-2034)
BEGIN PROJECT TO EXIT 7	9000	9600	1100	1200	2,408,000	5,447,000
EXIT 7 TO END PROJECT	10,800	11,600	1300	1400	5,123,000	11,939,000

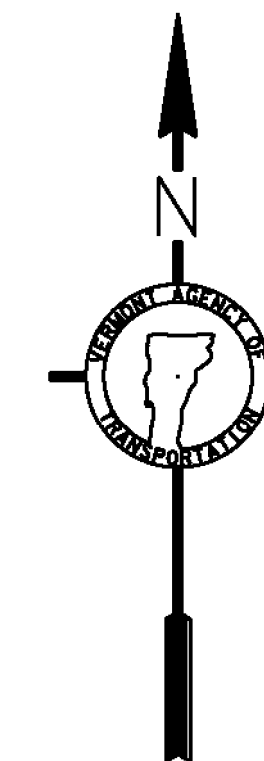
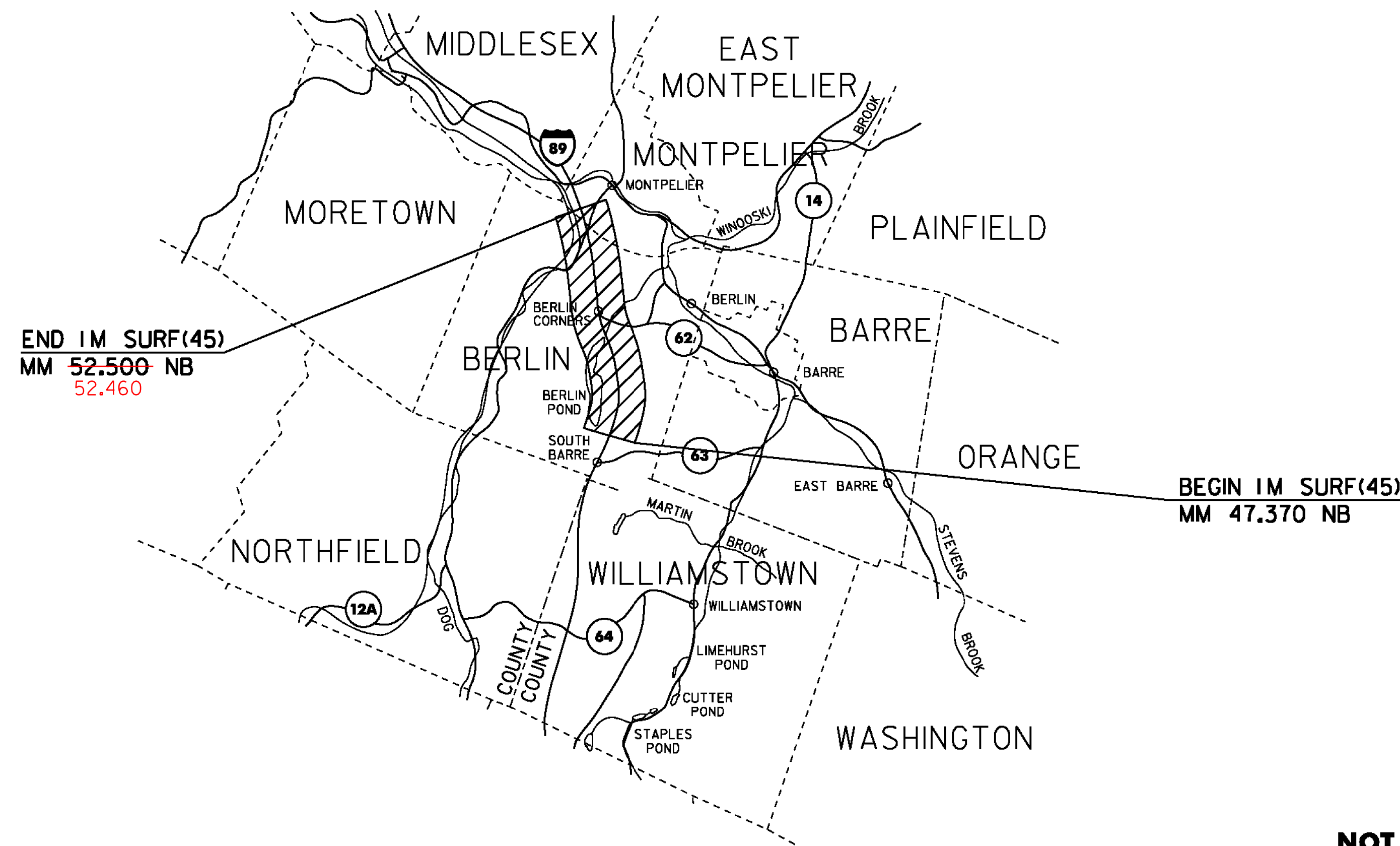

THESE PLANS ARE SUBJECT TO SUCH ENGINEERING CHANGES AS MAY BE REQUIRED BY THE FEDERAL HIGHWAY ADMINISTRATION OR THE DIRECTOR OF PROGRAM DEVELOPMENT.
CONSTRUCTION IS TO BE CARRIED ON IN ACCORDANCE WITH THESE PLANS AND THE STANDARD SPECIFICATIONS FOR CONSTRUCTION DATED 2011, AS APPROVED BY THE FEDERAL HIGHWAY ADMINISTRATION ON JULY 20, 2011 FOR USE ON THIS PROJECT, INCLUDING ALL SUBSEQUENT REVISIONS AND SUCH REVISED SPECIFICATIONS AND SPECIAL PROVISIONS AS ARE INCORPORATED IN THESE PLANS.

QUALITY ASSURANCE PROGRAM : LEVEL I	
SURVEYED BY :	NA
SURVEYED DATE :	NA
DATUM	
VERTICAL	NA
HORIZONTAL	NA

PROJECT MANAGER :	JONATHAN C. HARRINGTON, P. E.
PROJECT NAME :	BERLIN-MONTPELIER
PROJECT NUMBER :	IM SURF (45)
SHEET	24 OF 64

NOT TO SCALE