

INDEX OF SHEETS
SEE SHEET 2 FOR INDEX OF SHEETS

STATE OF VERMONT AGENCY OF TRANSPORTATION

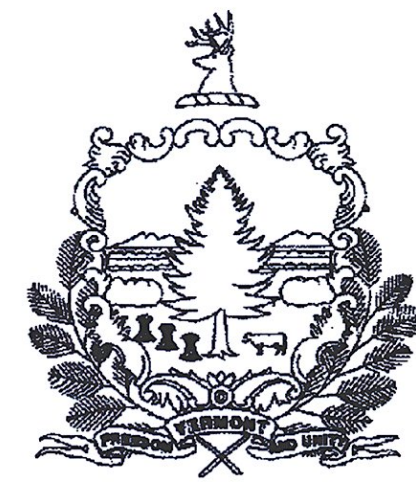

PROPOSED IMPROVEMENTS TOWNS OF BERLIN, BARRE CITY, MONTPELIER, HARTFORD & SHARON COUNTIES OF WINDSOR & WASHINGTON INTERSTATE ROUTE 89 (NB)(NHS) & VT. ROUTE 62 (EB & WB)

**BERLIN - BARRE CITY
COUNTY OF WASHINGTON
NH SURF (44)
SEE SHEET 7
FOR ADDITIONAL PROJECT INFORMATION**

**BERLIN-MONTPELIER
COUNTY OF WASHINGTON
IM SURF (45)
SEE SHEET 24
FOR ADDITIONAL PROJECT INFORMATION**

**HARTFORD-SHARON
COUNTY OF WINDSOR
IM SURF (46)
SEE SHEET 40
FOR ADDITIONAL PROJECT INFORMATION**

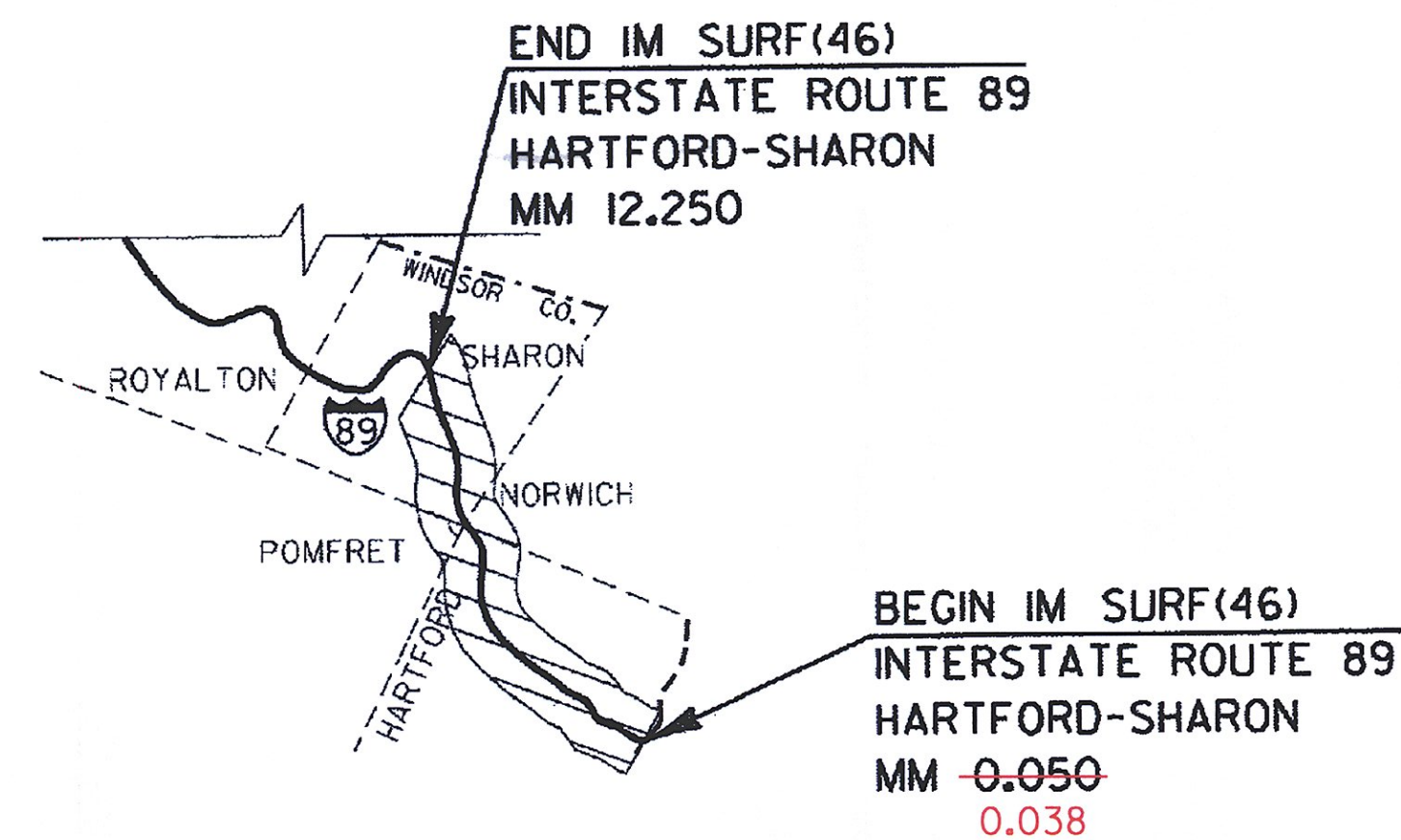
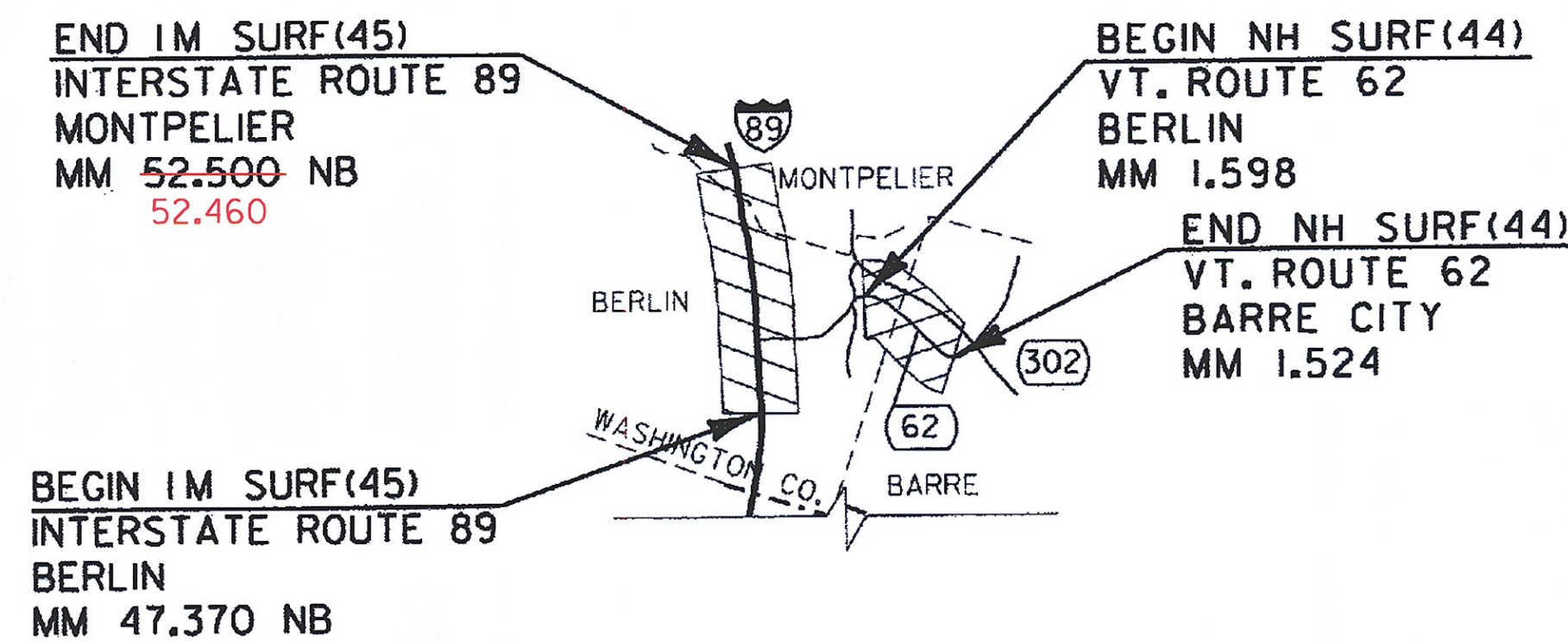
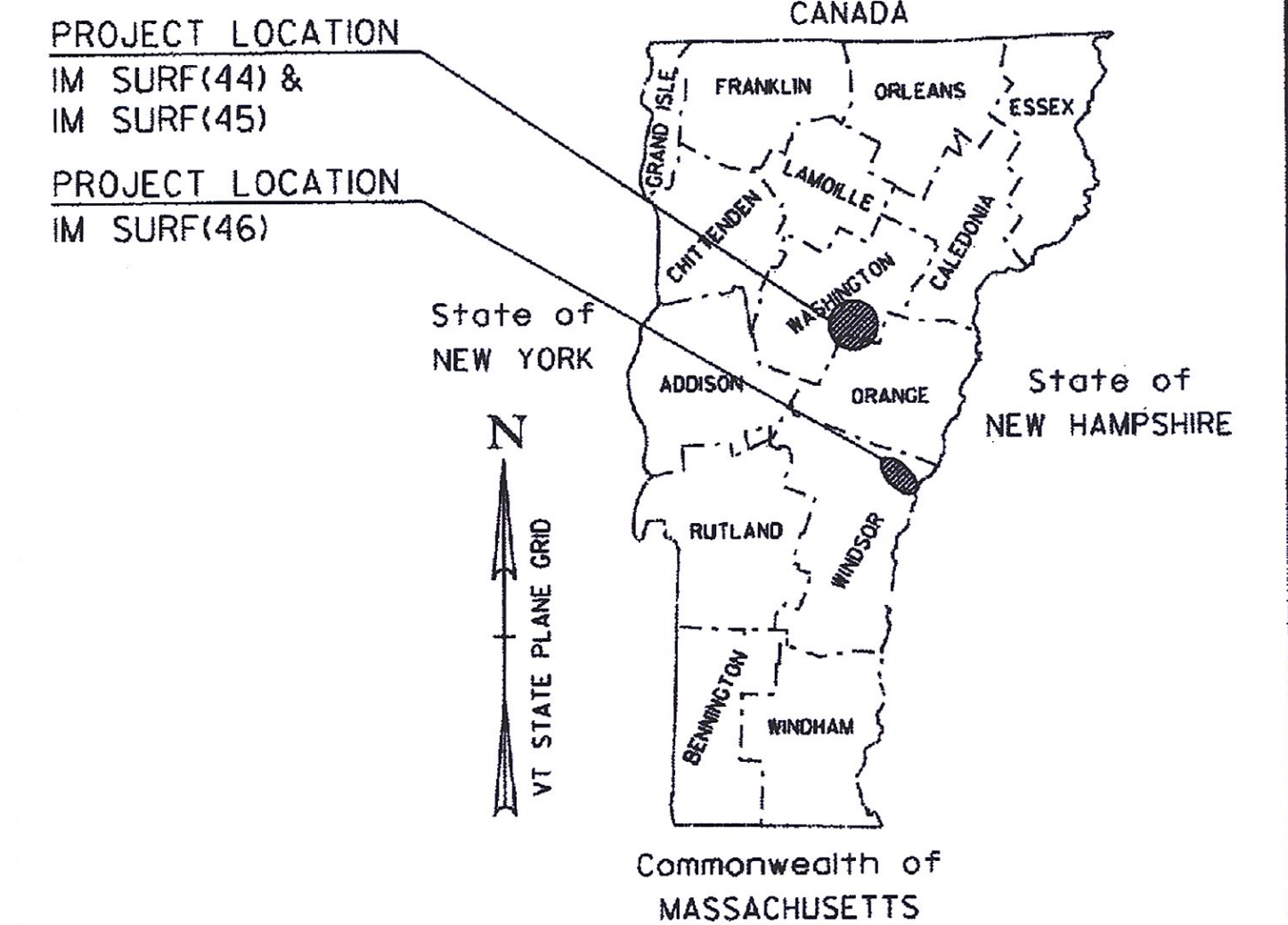

NOT TO SCALE

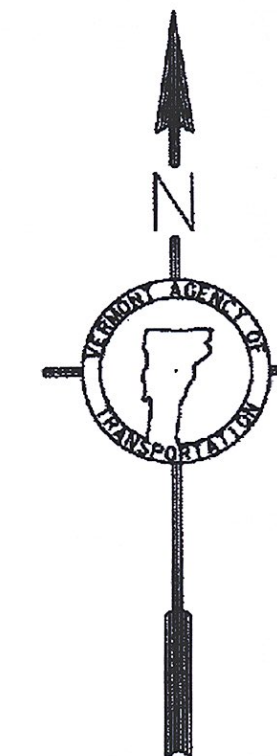

THESE PLANS ARE SUBJECT TO SUCH ENGINEERING CHANGES AS MAY BE REQUIRED BY THE FEDERAL HIGHWAY ADMINISTRATION OR THE DIRECTOR OF PROGRAM DEVELOPMENT.
CONSTRUCTION IS TO BE CARRIED ON IN ACCORDANCE WITH THESE PLANS AND THE STANDARD SPECIFICATIONS FOR CONSTRUCTION DATED 2011, AS APPROVED BY THE FEDERAL HIGHWAY ADMINISTRATION ON JULY 20, 2011 FOR USE ON THIS PROJECT, INCLUDING ALL SUBSEQUENT REVISIONS AND SUCH REVISED SPECIFICATIONS AND SPECIAL PROVISIONS AS ARE INCORPORATED IN THESE PLANS.

QUALITY ASSURANCE PROGRAM : LEVEL I	
SURVEYED BY :	NA
SURVEYED DATE :	NA
DATUM	
VERTICAL	NA
HORIZONTAL	NA

RECORD PLANS	
CONTRACTOR:	ALL STATES ASPHALT, INC. - SUNDERLAND, MA
RESIDENT ENGINEER:	SANDRA SCHMITT
CONSTRUCTION BEGAN:	SEPTEMBER 9, 2014
CONSTRUCTION COMPLETE:	JULY 23, 2015
RECORD PLANS BY:	SANDRA SCHMITT & AARON JAMES
I HEREBY CERTIFY THAT ALL THE CONSTRUCTION REQUIRED BY THIS SET OF DRAWINGS HAS BEEN ACCOMPLISHED AS INDICATED HEREIN.	
BY <i>Sandra E. Schmitt</i>	RESIDENT ENGINEER
DATE <i>06-24-16</i>	
NOTE: Any further information concerning final quantities, amounts or other details relative to this project may be found by contacting Vtrans Records Management.	

DIRECTOR OF PROGRAM DEVELOPMENT	
APPROVED <i>Kevin A. Marchisio</i>	DATE <i>5/23/14</i>
PROJECT MANAGER : JONATHAN C. HARRINGTON, P.E.	
PROJECT NAME : BERLIN-BARRE CITY, BERLIN-MONTPELIER & HARTFORD-SHARON	
PROJECT NUMBER : NH SURF (44), IM SURF (45) & IM SURF (46)	
SHEET 1 OF 64 SHEETS	