

GENERAL TRAFFIC CONTROL NOTES

1. THE CONTRACTOR SHALL SUBMIT A TRAFFIC CONTROL PLAN TO THE ENGINEER AND VAOT HIGHWAY SAFETY AND DESIGN SECTION FOR REVIEW ONE MONTH PRIOR TO PERFORMING ANY CONSTRUCTION ACTIVITY. THE PLAN SHALL INCLUDE PROVISIONS FOR IMPLEMENTATION AND MAINTENANCE OF TRAFFIC CONTROL FOR ALL WORK ASSOCIATED WITH THIS PROJECT. UPON WRITTEN APPROVAL FROM THE ENGINEER, THE CONTRACTOR SHALL IMPLEMENT THE TRAFFIC CONTROL PLAN AND COMMENCE CONSTRUCTION ACTIVITIES. ALL COSTS ASSOCIATED WITH THE DEVELOPMENT AND ANY NECESSARY REVISION OF A TRAFFIC CONTROL PLAN SHALL BE PAID FOR UNDER CONTRACT ITEM 900.645 SPECIAL PROVISION (TRAFFIC CONTROL, ALL-INCLUSIVE).
 2. TRAFFIC CONTROL PLANS ARE INTENDED TO BE DEVELOPED IN CONJUNCTION WITH VAOT STANDARD SHEETS, SECTION 6 OF THE LATEST EDITION OF THE MANUAL ON UNIFORM TRAFFIC CONTROL DEVICES (MUTCD) AND ITS REVISIONS, AND AT THE DISCRETION OF THE ENGINEER.
 3. LOCATIONS OF TEMPORARY TRAFFIC CONTROL DEVICES ARE APPROXIMATE, ACTUAL LOCATIONS SHALL BE DETERMINED IN THE FIELD BY THE ENGINEER.
 4. PORTABLE CHANGEABLE MESSAGE SIGN LOCATION AND MESSAGES ARE TO BE APPROVED BY THE ENGINEER.
 5. ALL SIGNS ASSOCIATED WITH THE TEMPORARY WORK ZONE SHALL BE GATE POSTED AND SHALL BE VISIBLE TO THE TRAVELING PUBLIC FOR THE DURATION OF THE CLOSURE.
 6. TEMPORARY TRAFFIC BARRIER SHALL BE USED FOR THE WORK ZONE AS INDICATED IN THE TRAFFIC CONTROL SHEET AND PAID FOR UNDER CONTRACT ITEM 900.645 SPECIAL PROVISION (TRAFFIC CONTROL, ALL-INCLUSIVE). ANY INTERIM REMOVING AND SETTING OF THE TEMPORARY TRAFFIC BARRIER SHALL BE INCIDENTAL TO CONTRACT ITEM 900.645 SPECIAL PROVISION (TRAFFIC CONTROL, ALL-INCLUSIVE).
 7. THE TEMPORARY TRAFFIC BARRIER SHALL BE PLACED TWO FEET OUTSIDE THE EXISTING NORTHBOUND PASSING LANE, THROUGH THE LENGTH OF THE WORK AREA AND SHALL HAVE A 1:16 TAPER EXTENDING OUTSIDE OF THE CLEAR ZONE (30 FEET OUTSIDE TRAVELED WAY). IF IT IS NOT POSSIBLE TO GET THE TEMPORARY TRAFFIC BARRIER OUTSIDE OF THE CLEAR ZONE THEN AN IMPACT ATTENUATOR SHALL BE USED AND WILL BE INCIDENTAL TO THE ITEM 900.645 SPECIAL PROVISION (TRAFFIC CONTROL, ALL-INCLUSIVE).
 8. ONCE TRAFFIC CONTROL DEVICES HAVE BEEN INSTALLED, THE CONTRACTOR SHALL BEGIN WORK IMMEDIATELY AND PROCEED IN A TIMELY MANNER THROUGH TO COMPLETION OF CONSTRUCTION IN ORDER TO MINIMIZE HAZARD AND INCONVENIENCE TO THE TRAVELING PUBLIC AS DIRECTED BY THE ENGINEER.
 9. ALL SIGNS, BARRICADES, AND OTHER TRAFFIC CONTROL DEVICES SHALL BE CLEANED WEEKLY. ADDITIONAL CLEANING WILL BE AT THE DISCRETION OF THE ENGINEER. EXISTING PERMANENT SIGNS THAT CONTRADICT TEMPORARY TRAFFIC CONTROL SIGNS SHALL BE REMOVED AND REPLACED OR COVERED FOR THE PERIOD OF TIME THAT THE TRAFFIC CONTROL PLAN IS IMPLEMENTED. COST FOR THIS WORK SHALL BE CONSIDERED INCIDENTAL TO CONTRACT ITEM 900.645 SPECIAL PROVISION (TRAFFIC CONTROL, ALL-INCLUSIVE).
 10. THE CONTRACTOR IS NOTIFIED THAT ALL ROADWAYS INCLUDED IN AND ASSOCIATED WITH THIS PROJECT ARE SUBJECT TO OCCASIONAL USE AND TRAVEL BY EMERGENCY RESPONSE VEHICLES. THE CONTRACTOR SHALL MAKE AND IMPLEMENT PLANS AND PROCEDURES DESIGNED TO ENSURE SWIFT AND UNIMPEDED TRAVEL OF EMERGENCY RESPONSE VEHICLES THROUGH CONSTRUCTION ZONES AND SHALL SUBMIT THEM TO THE ENGINEER. ANY COSTS ASSOCIATED WITH SUCH PLANS AND PROCEDURES SHALL BE INCIDENTAL TO CONTRACT ITEM 900.645 SPECIAL PROVISION (TRAFFIC CONTROL, ALL-INCLUSIVE).
- II. THE PRICE BID FOR ITEM 900.645 SPECIAL PROVISION (TRAFFIC CONTROL, ALL-INCLUSIVE) SHALL ACCOUNT FOR ALL EQUIPMENT, LABOR, AND MATERIALS NECESSARY TO IMPLEMENT AND PROVIDE FOR TRAFFIC CONTROL, WITH THE EXCEPTION OF THE FOLLOWING ITEMS WHICH SHALL BE PAID FOR SEPARATELY:
- 630.10 UNIFORMED TRAFFIC OFFICERS - HR
 - 630.15 FLAGGERS - HR
 - 641.15 PORTABLE CHANGEABLE MESSAGE SIGN - EACH
 - 641.16 PORTABLE ARROW BOARD - EACH

LEGEND

- DIRECTION OF TRAFFIC
- IM 091-3(51) PROJECT AREA
- TEMPORARY TRAFFIC BARRIER
- PAVEMENT MARKING MASK
- TEMPORARY PAVEMENT MARKING TAPE
- CHANNELIZING DEVICE
- ARROW BOARD
- SIGN AND POSTS
- PORTABLE CHANGEABLE MESSAGE SIGN

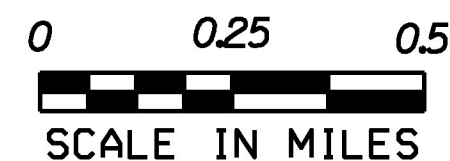
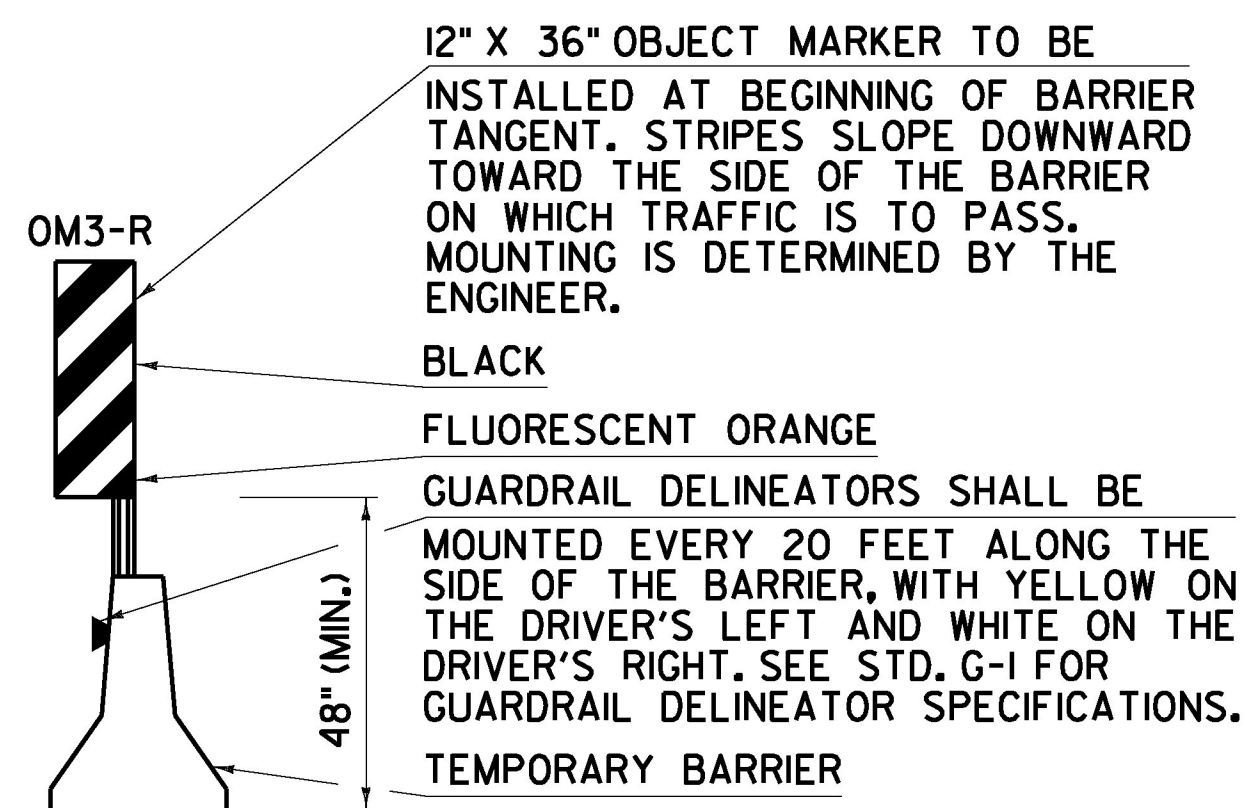

PROJECT NAME: LYNDON	PLOT DATE: 2/1/2017
PROJECT NUMBER: IM 091-3(51)	DRAWN BY: J. HEALD
FILE NAME: z13a370+cp.dgn	CHECKED BY: J. SHIELDS
PROJECT LEADER: D. GOZALKOWSKI	TRAFFIC CONTROL SHEET 1
DESIGNED BY: J. OLSEN	SHEET 34 OF 35