

GENERAL NOTES

1. For additional General Notes, see Std. Sh. SCB-DI-71
2. Elevation Datum is sea level based on nearest U.S. Government vertical control.
3. Superstructure Concrete shall be Concrete Class A, Item 501.2.0. All other concrete shall be Concrete Class B, Item 501.2.5
4. For construction joint details see SCB-D6-71, Det. B.
5. No scuppers shall be used on this structure.
6. Reinforcing steel shall have 3" clear cover in abutment footings and 2" elsewhere except where otherwise noted.
7. Wingwall concrete shall not be placed above adjacent bridge seat elevation until beams have been profiled and final grade established by the Engineer.
8. Abutment No. 2 & 4 backwalls shall be coated with Paint Waterproofing. Bridge seats at Abutments No. 2 & 4 shall be coated with Epoxy Coating Compound. Backwalls & bridge seats at Abutments No. 1 & 3 and all other exposed abutment concrete not otherwise treated shall be coated with Water Repellent.
9. Concrete at ends of wings adjacent to deck shall not be placed until expansion joints or waterstops are set. This may be done with a blocked-out section or an additional construction joint full length of wing.

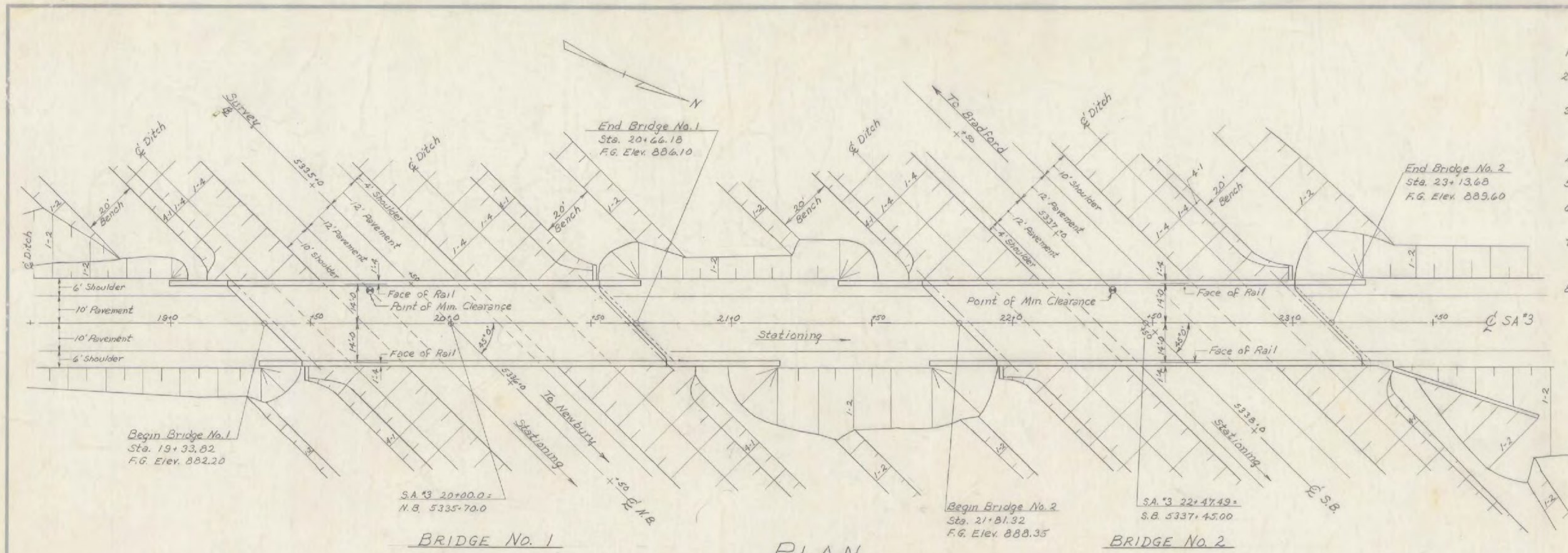

PLAN
Scale: 1" = 20'

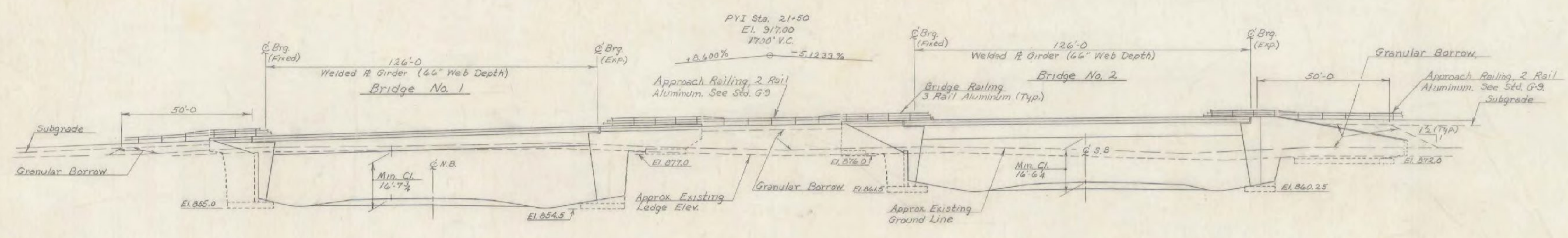

ELEVATION
Scale: 1" = 20'

REFERENCE DRAWINGS

- Plan Sheet I 91 N.B. & S.B. Sta. 5323+0 to Sta. 5339+0
- Profile Sheets I 91 N.B. & S.B. Sta. 5323+0 to Sta. 5339+0
- SA #3 Sta. 12+0 to Sta. 37+0
- Section Sheets I 91 N.B. Sta. 5334+0 to Sta. 5338+50
- I 91 S.B. Sta. 5336+50 to Sta. 5339+0
- SA #3 Sta. 19+0 to Sta. 24+50

STANDARD DRAWINGS

- G-9
- SB-R1-71 Sh. 1 of 2 8-24-71
- SB-R1-71 Sh. 2 of 2 10-5-71 R
- SCB-D1-71 12-14-71
- SCB-D4-71 12-14-71
- SCB-D6-71 Det. A&B 12-14-71
- SCB-D9-71 Det. B 12-14-71

LIST OF BRIDGE SHEETS

- BR. 101 Plan, Elevation, & General Notes
- BR. 102 Quantity Sheet
- BR. 103 Preliminary Information Sheet
- BR. 104 Boring Log
- BR. 105 Framing Plan & Details
- BR. 106 Typical Section, Curb & Railing Layout
- BR. 107 Joint Details
- BR. 108 Bearing Devices
- BR. 109 Abutment No. 1
- BR. 110 Abutment No. 1 - Details
- BR. 111 Abutment No. 2
- BR. 112 Abutment No. 2 - Details
- BR. 113 Abutment No. 3
- BR. 114 Abutment No. 3 - Details
- BR. 115 Abutment No. 4
- BR. 116 Abutment No. 4 - Details
- BR. 117 Abutment No. 4 Right Wing
- BR. 118-121 Reinforcing Schedules

BRADFORD - NEWBURY
IM BPNT (14)
PROJECT BRIDGE 62
SHEET 20 OF 26
FOR INFORMATION ONLY

STATE OF VERMONT
DEPARTMENT OF HIGHWAYS

PROJECT BRADFORD - NEWBURY
TOWN OF BRADFORD **BR-62**

ROUTE NO. I 91 STA. 5336+50

STATE AID NO. 3 OVER I 91

PLAN, ELEVATION & GENERAL NOTES
SCALE AS NOTED

SECTION SUPERVISOR J. WOOD

DRAWN BY W. TRIPP CHECKED BY R. SHATTUCK

PROJECT NO. I 91-2(11) CONT. 2
SHEET 84 OF 347 BR. 101