

REMOVING SIGNS  
 TYPE A: 11  
 TYPE B: 1

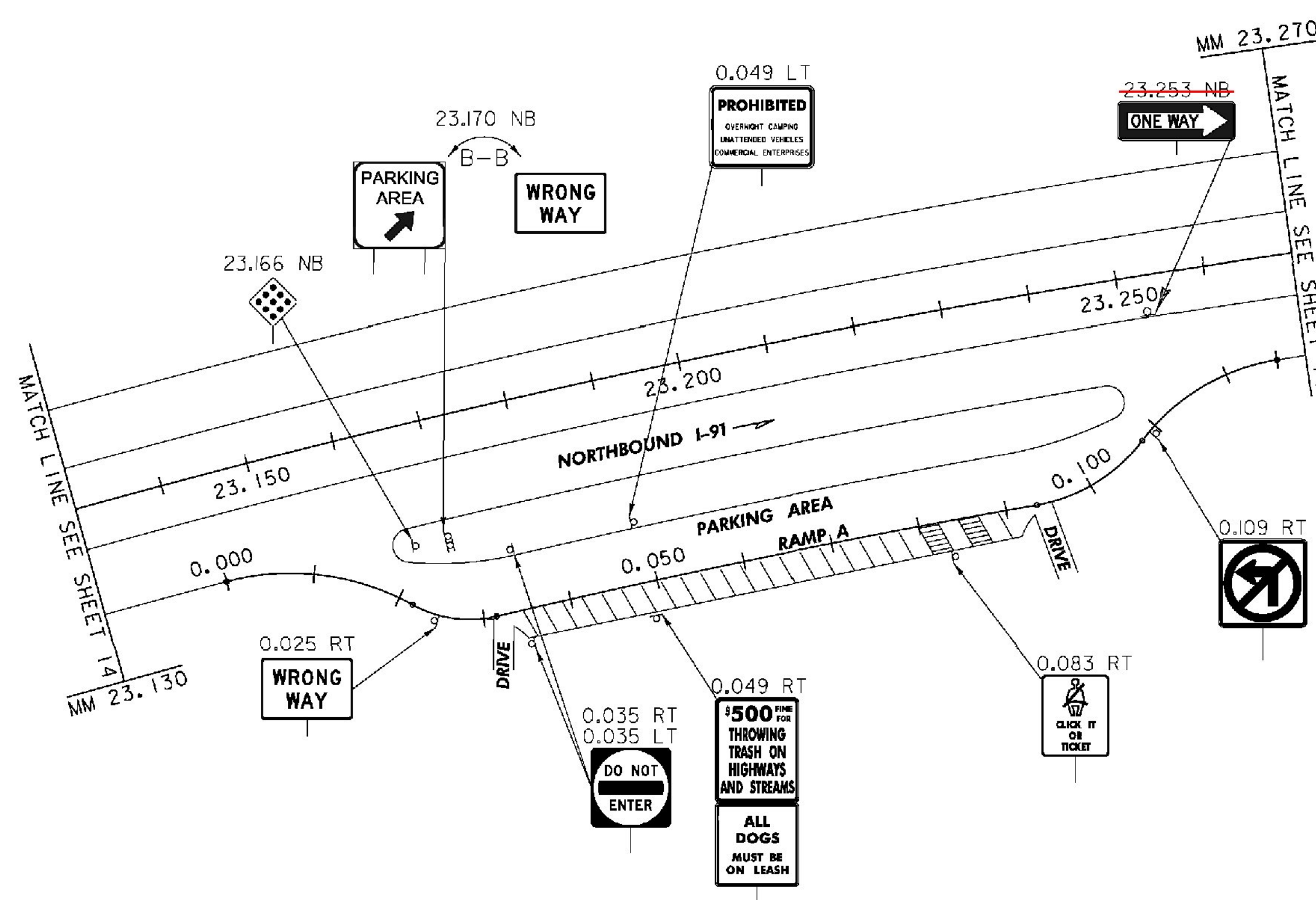

LEGEND  
 [RET] - RETAIN  
 [R&S] - REMOVE & SALVAGE

ALL SIGNS AND POSTS WILL BE REMOVED UNLESS OTHERWISE NOTED

PROJECT NAME: GUILFORD-ROCKINGHAM	PLOT DATE: 4/17/2014
PROJECT NUMBER: IMG SIGN(44)	DRAWN BY: S. FORTIER
FILE NAME: z12A528parking.dgn	CHECKED BY: D. MUNRO
DESIGNED BY: J. SMITH	
NB PARKING AREA MM 23.2 EXISTING SIGNS	SHEET 34 OF 157

**CLD CONSULTING ENGINEERS**  
 540 Commercial Street, Manchester, NH 03101  
 (603) 868-8223 • Fax: (603) 868-8802  
 clc@cldeengineers.com • www.cldeengineers.com  
 Maine • New Hampshire • Vermont

NOT TO SCALE

CLD 12-0350 MODEL: Existing Parking NB MM 23.2