

REMOVING SIGNS
 TYPE A: 5
 TYPE B: 6
 BRIDGE PLAQUE: 2

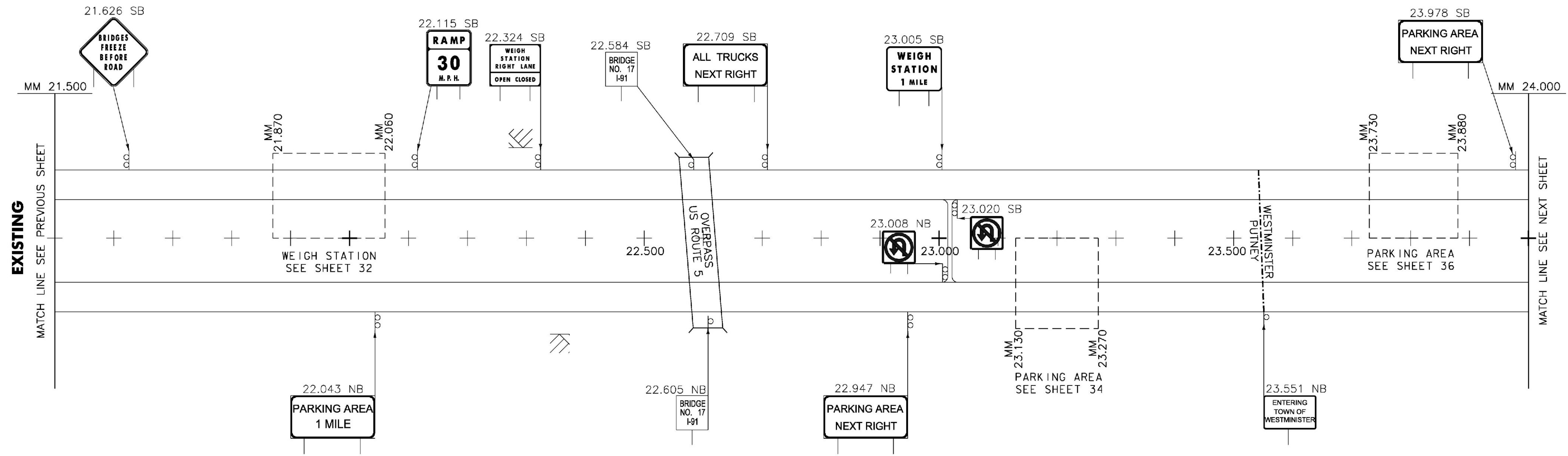

ALL EXISTING SIGNS AND POSTS TO BE REMOVED UNLESS OTHERWISE NOTED

LEGEND
 [RET] - RETAIN
 [R&S] - REMOVE & SALVAGE

SPECIAL PROVISION (SOLAR-POWERED FLASHING BEACON ASSEMBLY, WEIGH STATION)
 22.709 SB

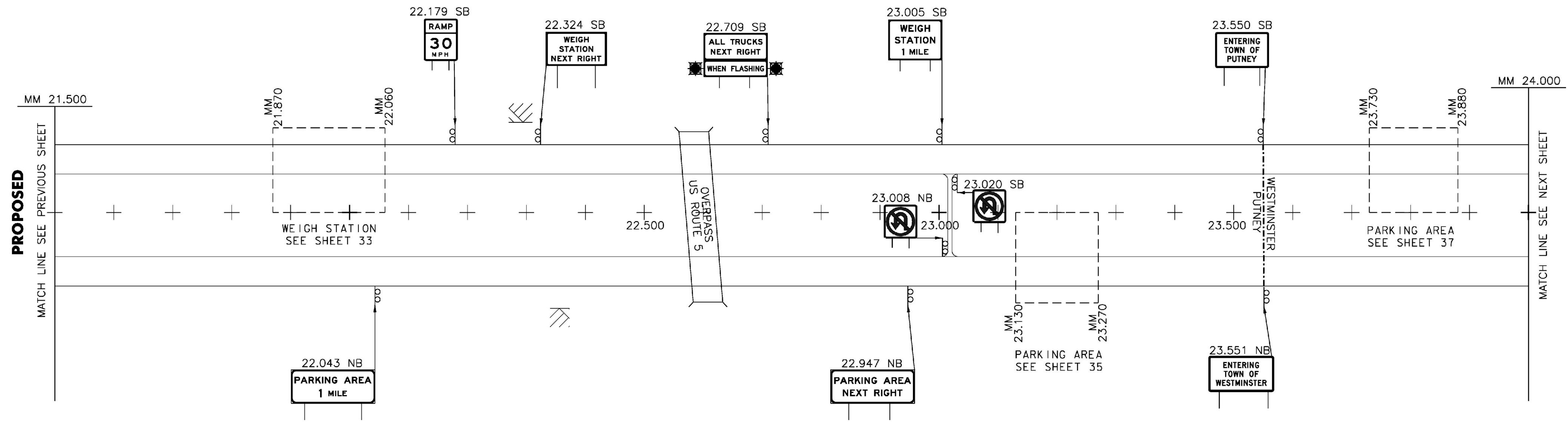

ALL PROPOSED SIGNS ARE NEW UNLESS OTHERWISE NOTED

NOT TO SCALE

LEGEND
 [RET] - RETAIN
 [SALV] - SALVAGE

CLD
 CONSULTING ENGINEERS
 540 Commercial Street, Manchester, NH 03101
 (603) 668-8223 • Fax: (603) 668-8802
 cid@clidengineers.com • www.clidengineers.com
 Maine • New Hampshire • Vermont

PROJECT NAME:	GUILFORD-ROCKINGHAM
PROJECT NUMBER:	IMG SIGN(44)
FILE NAME:	z12A528mainline.dgn
PROJECT LEADER:	C. GREGORY
DESIGNED BY:	J. SMITH
MAINLINE SIGN LAYOUT 10	
PLOT DATE:	4/17/2014
DRAWN BY:	S. GOODWIN
CHECKED BY:	D. MUNRO
SHEET	14 OF 157

CLD 12-0350 MODEL: 10