

137

137

INDEX OF SHEETS

SHEET NO.	TITLE
1	TYPICAL IMPROVEMENT (INTERSTATE)
2	TYPICAL PAVEMENT
3	TYPICAL CROSS SECTIONS (RAMPS)
4	TYPICAL CROSS SECTIONS (LA. ROAD #1)
5-7	ALIGNMENT DATA SHEETS
8	TEMPORARY APPROACH TRANSITION SHEET
9-10	QUANTITY SHEETS (ITEMS)
11-12	QUANTITY SHEETS (ITEMS)
13-16	GRADE SHEETS
17-22	EARTHWORK SHEETS
23	BLANK
24-70	PLAN AND PROFILE SHEET
71	BLANK
72	BLANK
73	A-61 (DRILLING AND BLASTING OF SOLID ROCK, SUBGRADE)
74	B-1 (BANKING TABLES)
75	B-5 (TYPICAL SLOPE GRADING)
76	B-6 (MUCK EXCAVATION)
77	BLANK
78	B-15 (ENTRANCE AND EXIT TERMINALS)
79	BLANK
80	B-17 (DETAILS OF U-TURNS)
81	D-2 (UNDERDRAM AND HEADWALLS)
82	D-3 (LAITE MATINGS AND GUTTERS)
83	D-4 (ELBOWS AND FLUSHING BASINS)
84	BLANK
85	D-8 (DROP INLETS)
86	D-10 (DROP INLET TOPS)
87	D-11 (DROP INLET GRATES AND COVERS)
88	D-16 (PRECAST REINFORCED CONCRETE CURB DROP INLETS)
89	E-1 (BARRICADES, SIGNS AND LIGHTS) ROADWAY
90	E-2 (BARRICADES, SIGNS AND LIGHTS) BRIDGE
91	E-31 (CONSTRUCTION IDENTIFICATION SIGNS)
92	E-3 (THREE CABLE GUARD RAIL WITH STEEL POSTS)
93	E-4 (PLANK GUARD RAIL)
94	J-1 (BOUNDARY MARKERS)
95	J-4 (FIELD OFFICE)
96	BLANK
97	SB-20-60
98	SB-21-56
99-102	SB-30-62
103-104	SB-55-62
105	SB-30-62
106-114	SCB-D1 THROUGH D6-62
115	BLANK
116	6" x 8" x 8" R.C. BOX (TEAM PASS STA 554+00)
117	PLAN SECTION-DETAILS
118	REINFORCING STEEL DETAILS
119	INTERSTATE BRIDGE OVER MISSISSQUOI RIVER
120	BR 200 SUPERSTRUCTURE PLAN AND ELEVATION
121	BR 201 BRIDGE QUANTITY SHEET
122	BR 202 PRELIMINARY INFORMATION SHEET
123	BR 203 BORINGS
124	BR 204 FRAMING AND RAILING PLAN
125	BR 205 DETAILS OF ABUTMENT NO. 1

SHEET NO.	TITLE
125	BR 206 DETAILS OF ABUTMENT NO. 2
126	BR 207 DETAILS OF PIER NO. 1
127	BR 208 DETAILS OF PIER NO. 2
128	BR 209 APPROACH SLAB NO. 1 (STD STR. SB-AS-62)
129	BR 210 APPROACH SLAB NO. 2 (STD STR. SB-AS-62)
130	BR 211 REINFORCING STEEL SCHEDULE
130-134	BR 212-216 CHANNEL SECTIONS
135	AB INTERSTATE BRIDGE OVER ST. J. AND L.C. RR.
136	BR 301 PLAN ELEVATION
137	BR 302 BRIDGE QUANTITY SHEET
138	BR 303 PRELIMINARY INFORMATION SHEET
139	BR 304 BORING LOGS
140	BR 305 APPROACH SLABS NO. 3 AND NO. 4
141	BR 306 ABUTMENTS NO. 3 AND NO. 4
142	BR 307 PIERS NO. 3 AND NO. 4
143	BR 308 REINFORCING STEEL SCHEDULE
144	AB INTERSTATE BRIDGE OVER VT. RTE 78
145	BR 400 PRELIMINARY INFORMATION SHEET
146	BR 401 PLAN AND ELEVATION
147	BR 402 BORINGS
148	BR 403 DETAILS OF ABUTMENTS (NORTH AND SOUTH)
149	BR 404 DETAILS OF PIERS NO. 1 AND NO. 2
150	BR 405 REINFORCING STEEL SCHEDULE
151	BR 406 APPROACH SLAB NO. 1 (STD STR. SB-AS-62)
152	BR 407 APPROACH SLAB NO. 2 (STD STR. SB-AS-62)
153	BR 408 OVER INTERSTATE 89
154	BR 500 PLAN AND ELEVATION
155	BR 501 PRELIMINARY INFORMATION SHEET
156	BR 502 BORINGS
157	BR 503 DETAILS OF ABUTMENT NO. 1
158	BR 504 DETAILS OF ABUTMENT NO. 2
159	BR 505 REINFORCING STEEL SCHEDULE
160	BLANK
161-166	CROSS SECTIONS

STATE OF VERMONT
DEPARTMENT OF HIGHWAYS
Proposed Improvement

INTERSTATE PROJECT
RIGHT LANE CONSTRUCTION - STAGE I
TOWNS OF SWANTON & HIGHGATE
COUNTY OF FRANKLIN
ST. ALBANS, VT - PHILIPSBURG, QUE ROAD
PROJECT I 89-3 (32)

Dated February 27, 1964
Robert Sandy Gravel Co. Inc.
Contractor
Walter H. Conroy
Contractor
Missouri St. Stevedore
By Order of Commissioner of Highways

Beginning at a point 1.824 miles southerly of the Swanton-Highgate Town Line and extending northerly 4.736 miles.
Length of Roadway 24,328.22 Feet = 4.608 Miles
Length of Bridge 679.18 Feet = 0.128 Miles
Length of Project 25,007.40 Feet = 4.736 Miles

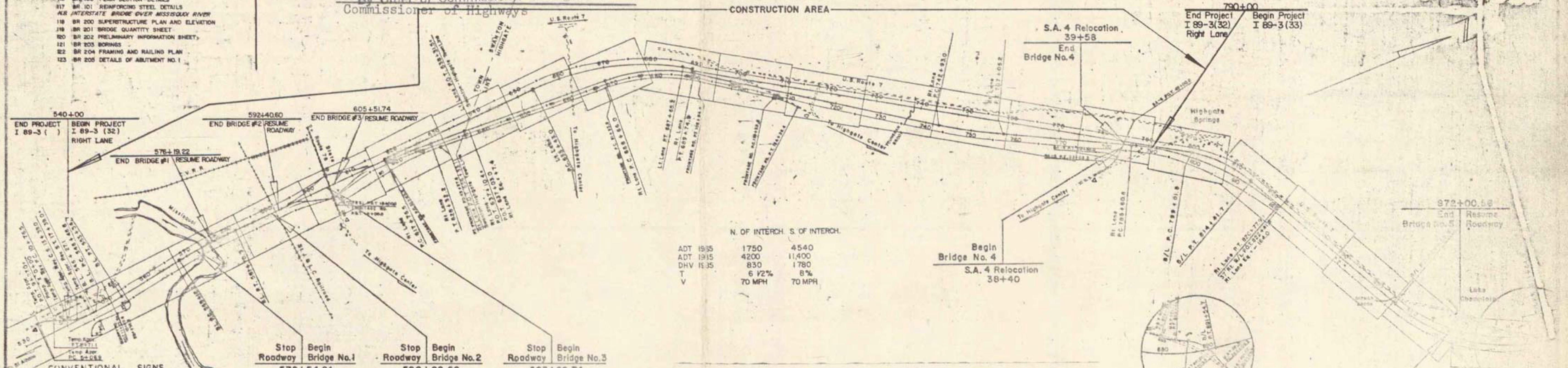
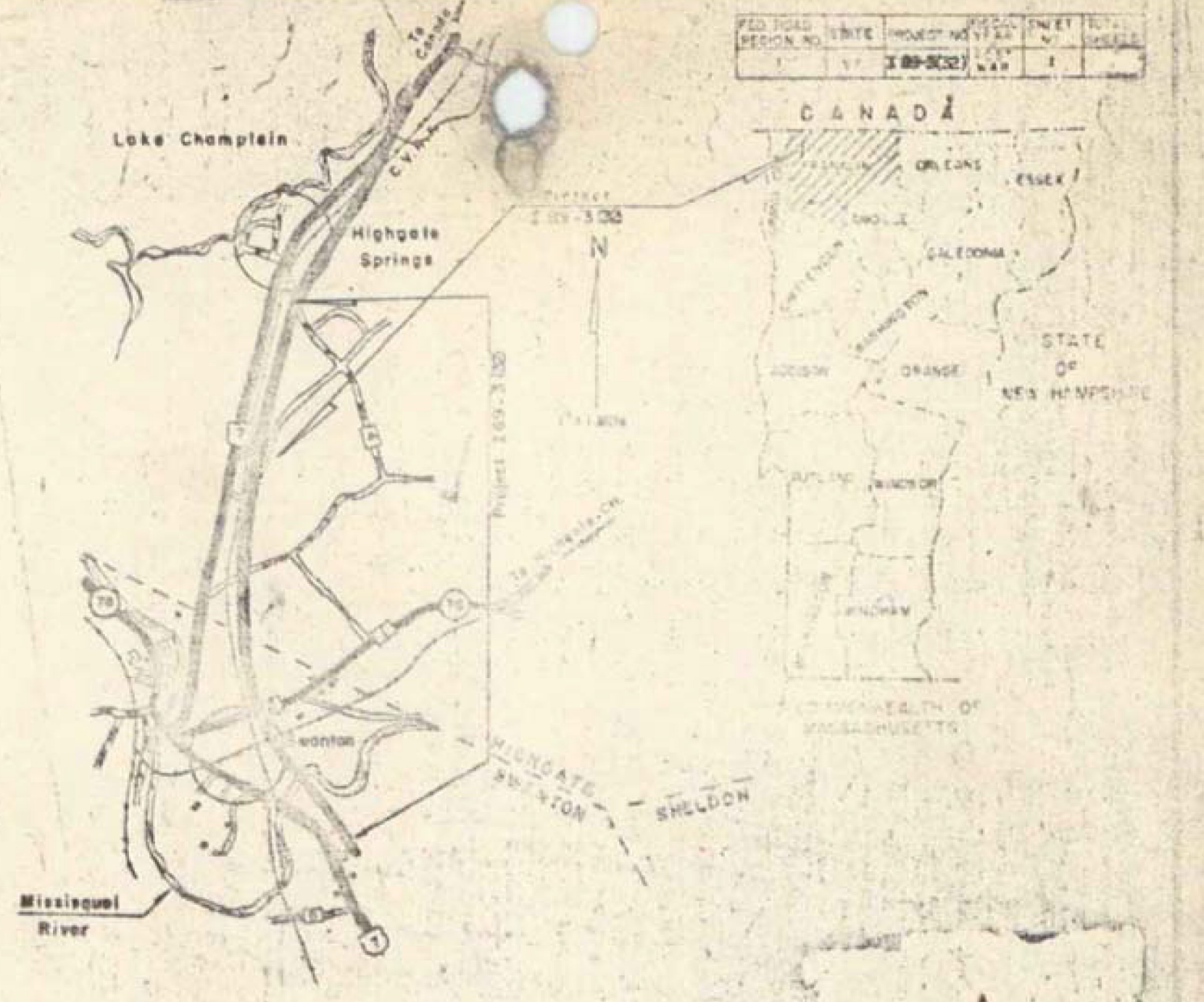

N. OF INTERCH. S. OF INTERCH.

ADT 1935	1750	4540
ADT 1945	4200	11400
DHV 1935	830	1780
T	6 1/2%	8%
V	70 MPH	70 MPH

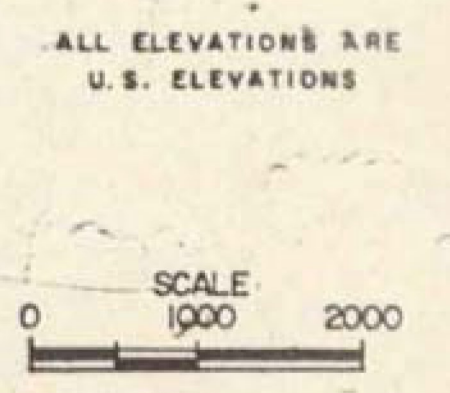
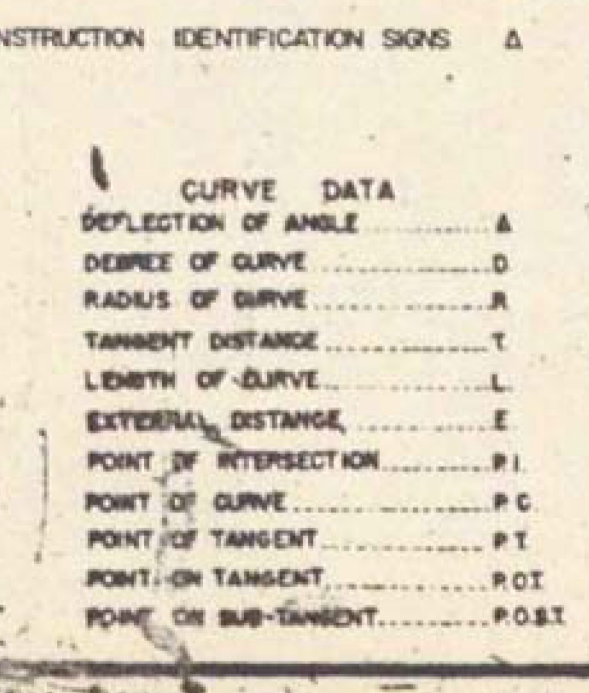
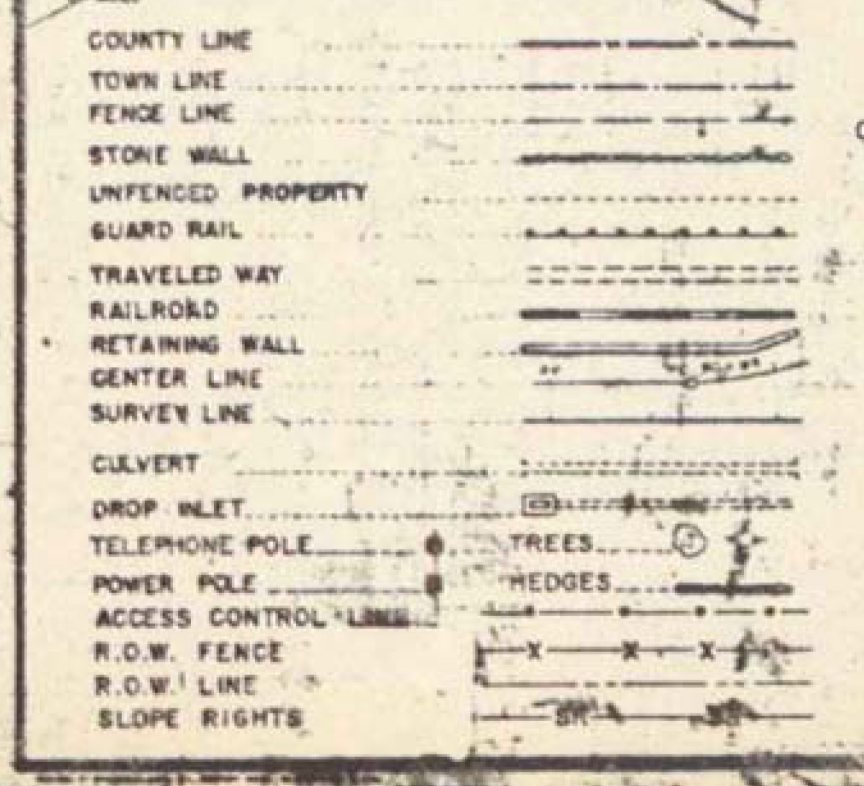

THESE PLANS HAVE BEEN REDUCED PHOTOGRAPHICALLY TO APPROXIMATELY 1/2 SCALE

WEBSTER - MARTIN, INC.
E. U. Webster
Submitted March 5, 1962
Date

THESE PLANS ARE SUBJECT TO SUCH REVISIONS AS MAY BE REQUIRED BY THE BUREAU OF PUBLIC ROADS OR THE COMMISSIONER OF HIGHWAYS.
CONSTRUCTION IS TO BE CARRIED ON IN ACCORDANCE WITH THE PLANS AND THE STANDARD SPECIFICATIONS FOR HIGHWAY BRIDGE CONSTRUCTION OF JANUARY 1956, SUBMITTED TO THE BUREAU OF PUBLIC ROADS FOR APPROVAL ON 10/15/56, INCLUDING ALL SUBSEQUENT APPROVED REVISIONS AND SUCH REVISED SPECIFICATIONS AND SPECIAL PROVISIONS AS ARE SUBMITTED WITH THE PLANS.

SWANTON
IM 089-3(70)
SHEET 15 OF 31
FOR REFERENCE ONLY

APPROVED *R.H. Arnold* ASST. CHIEF ENGINEER DATE 11/7/63
APPROVED *E.W. Atkinson* CHIEF ENGINEER DATE 11/4/63
APPROVED *L.M. Quinn* CHIEF ENGINEER DATE 11/4/63
APPROVED *B.M. Blackwell* CHIEF ENGINEER DATE 11/6/63
APPROVED *L.M. Lane* CHIEF ENGINEER DATE 11/4/63
APPROVED *A.S. Bishop* CHIEF ENGINEER DATE 11/5/63

PROJECT I NO. 89-3 (32)
RIGHT LANE - STAGE I CONSTRUCTION
SHEET 15 OF 246 SHEETS