

SWANTON - Highgate  
I-89-3(32)

INDEX OF SHEETS

SHEET NO. 1	TITLE PAGE
2	TYPICAL CROSS SECTION OF IMPROVEMENT (INTERSTATE) (5' BITUMINOUS CONCRETE PAVEMENT)
3	TYPICAL CROSS SECTIONS (RAMP)
4	TYPICAL CROSS SECTIONS (S.A. ROAD #)
5-7	ALIGNMENT DATA SHEETS
8	TEMPORARY APPROACH TRANSITION SHEET
9-10	QUANTITY SHEETS (ITEMS)
11-12	QUANTITY SHEETS (DRAINAGE)
13-16	GRADE SHEETS
17-22	EARTHWORK SHEETS
23	BLANK
24-70	PLAN AND PROFILE SHEET
71	BLANK
72	BLANK
73	A-61 (DRILLING AND BLASTING OF SOLID ROCK, SUBGRADE)
74	B-1 (BANKING TABLES)
75	B-5 (TYPICAL SLOPE GRADING)
76	B-6 (MUCK EXCAVATION)
77	BLANK
78	B-15 (ENTRANCE AND EXIT TERMINALS)
79	BLANK
80	B-17 (DETAILS OF U-TURNS)
81	D-2 (UNDERDRAIN AND HEADWALLS)
82	D-3 (JUTE MATTING AND GUTTERS)
83	D-4 (ELBOWS AND FLUSHING BASINS)
84	BLANK
85	D-8 (DROP INLETS)
86	D-10 (DROP INLET TOPS)
87	D-11 (DROP INLET GRATES AND COVERS)
88	D-16 (PRECAST REINFORCED CONCRETE CURB DROP INLETS)
89	E-1 (BARRICADES, SIGNS AND LIGHTS) ROADWAY
90	E-2 (BARRICADES, SIGNS AND LIGHTS) BRIDGE
91	E-31 (CONSTRUCTION IDENTIFICATION SIGNS)
92	G-3 (THREE CABLE GUARD RAIL WITH STEEL POSTS)
93	G-4 (PLANK GUARD RAIL)
94	J-1 (BOUNDARY MARKERS)
95	J-4 (FIELD OFFICE)
96	BLANK
97	SB-20-60
98	SB-21-56
99-102	SCWPG-30-62
103-104	SB-56-62
105	SCB-30-62
106-114	SCB-D1 THROUGH D9-62
115	BLANK
116	12'-6" X 12'-9" R.C. BOX (TEAM PASS STA 554+00)
117	BR 101 REINFORCING STEEL DETAILS
118	INTERSTATE BRIDGE OVER MISSISSQUOI RIVER
119	BR 200 SUPERSTRUCTURE PLAN AND ELEVATION
120	BR 201 BRIDGE QUANTITY SHEET
121	BR 202 PRELIMINARY INFORMATION SHEET
122	BR 203 BORINGS
123	BR 204 FRAMING AND RAILING PLAN
124	BR 205 DETAILS OF ABUTMENT NO. 1

SHEET NO.	124	BR 206	DETAILS OF ABUTMENT NO. 2
	125	BR 207	DETAILS OF PIER NO. 1
	126	BR 208	DETAILS OF PIER NO. 2
	127	BR 209	APPROACH SLAB NO. 1 (STD STR. SB-AS-62)
	128	BR 210	APPROACH SLAB NO. 2 (STD STR. SB-AS-62)
	129	BR 211	REINFORCING STEEL SCHEDULE
	130-134	BR 212-216	CHANNEL SECTIONS
		NB INTERSTATE BRIDGE OVER ST. J. AND L.C. RR.	
	135	BR 301	PLAN ELEVATION
	136	BR 302	BRIDGE QUANTITY SHEET
	137	BR 303	PRELIMINARY INFORMATION SHEET
	138	BR 304	BORING LOGS
	139	BR 305	APPROACH SLABS NO. 3 AND NO. 4
	140	BR 306	ABUTMENTS NO. 3 AND NO. 4
	141	BR 307	PIERS NO. 3 AND NO. 4
	142	BR 308	REINFORCING STEEL SCHEDULE
		N.B. INTERSTATE BRIDGE OVER VT. RTE 78	
	143	BR 400	PRELIMINARY INFORMATION SHEET
	144	BR 401	PLAN AND ELEVATION
	145	BR 402	BORINGS
	146	BR 403	DETAILS OF ABUTMENTS (NORTH AND SOUTH)
	147	BR 404	DETAILS OF PIER NO. 1 AND NO. 2
	148	BR 405	REINFORCING STEEL SCHEDULE
	149	BR 406	APPROACH SLAB NO. 1 (STD STR. SB-AS-62)
	150	BR 407	APPROACH SLAB NO. 2 (STD STR. SB-AS-62)
		SA NO. 4 OVER INTERSTATE 89	
	151	BR 500	PLAN AND ELEVATION
	152	BR 501	PRELIMINARY INFORMATION SHEET
	153-154	BR 502-503	BORINGS
	155	BR 504	DETAILS OF ABUTMENT NO. 1
	156	BR 505	DETAILS OF ABUTMENT NO. 2
	157	BR 506	REINFORCING STEEL SCHEDULE
	158	BLANK	
	159-246	CROSS SECTIONS	

STATE OF VERMONT  
DEPARTMENT OF HIGHWAYS

PROPOSED IMPROVEMENT

INTERSTATE PROJECT  
RIGHT LANE CONSTRUCTION - STAGE I

TOWNS OF SWANTON & HIGHGATE  
COUNTY OF FRANKLIN  
ST. ALBANS, VT - PHILIPSBURG, QUE ROAD  
PROJECT I 89-3 (32)

PROJECT NAME & NUMBER	TYPE - STAGE I
SWANTON-HIGHGATE I 89-3(32)	GRADING & DRAINAGE
RECORD PLANS	
MATERIALS	
SUB-BASE OF GRAVEL (MOD) - LAFRANCE QUARRY - HIGHGATE SPRINGS, VT.	
SUB-BASE OF CRUSHED ROCK (MOD) - LAFRANCE QUARRY - HIGHGATE SPRINGS, VT.	
TAR EMULSION - BORDEN CO. - NEW YORK, N.Y.	
BITUMINOUS CONCRETE PAVEMENT - LINSPIKE & SON, INC. - WILLISTON, VT.	
CONCRETE CLASS "A" & CLASS "B" - A.S. ANDERSON'S PLANT - SWANTON, VT. & ST. ALBANS, VT.	
REINFORCING STEEL - BETHLEHEM STEEL CORR. - ALBANY, N.Y.	
STRUCTURAL STEEL & STEEL PILING - VERMONT STRUCTURAL STEEL CORR. - BURLINGTON, VT.	
BRIDGE PAINT - MASTER PROTEZ POWDER CO. - CHICAGO, ILL.	
REINFORCED CONCRETE PIPE - P.R. C.C. & CO. - ST. ALBANS, VT.	
GRISWOLD & CO. INC. - ESSEX JCT. VT.	

Beginning of a point	1.624 miles	southerly of the Swanton-Highgate Town Line and extending northerly	4.736 miles
Length of Roadway	24,328.22	Feet	4.608 Miles
Length of Bridge	679.18	Feet	0.128 Miles
Length of Project	25,007.40	Feet	4.736 Miles

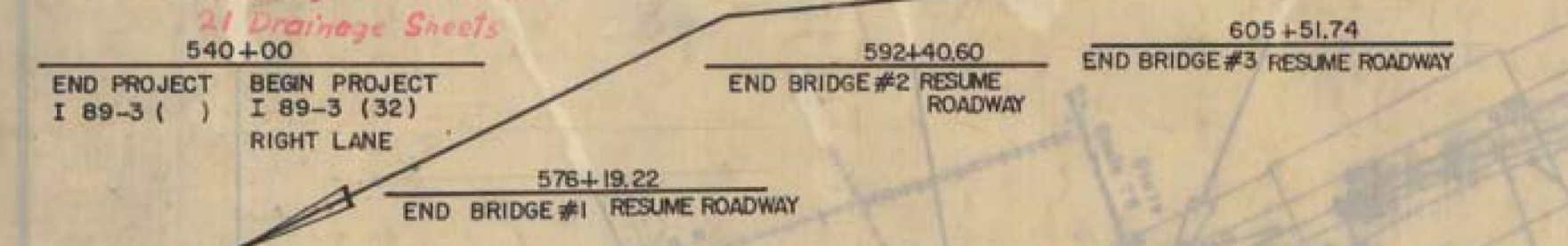
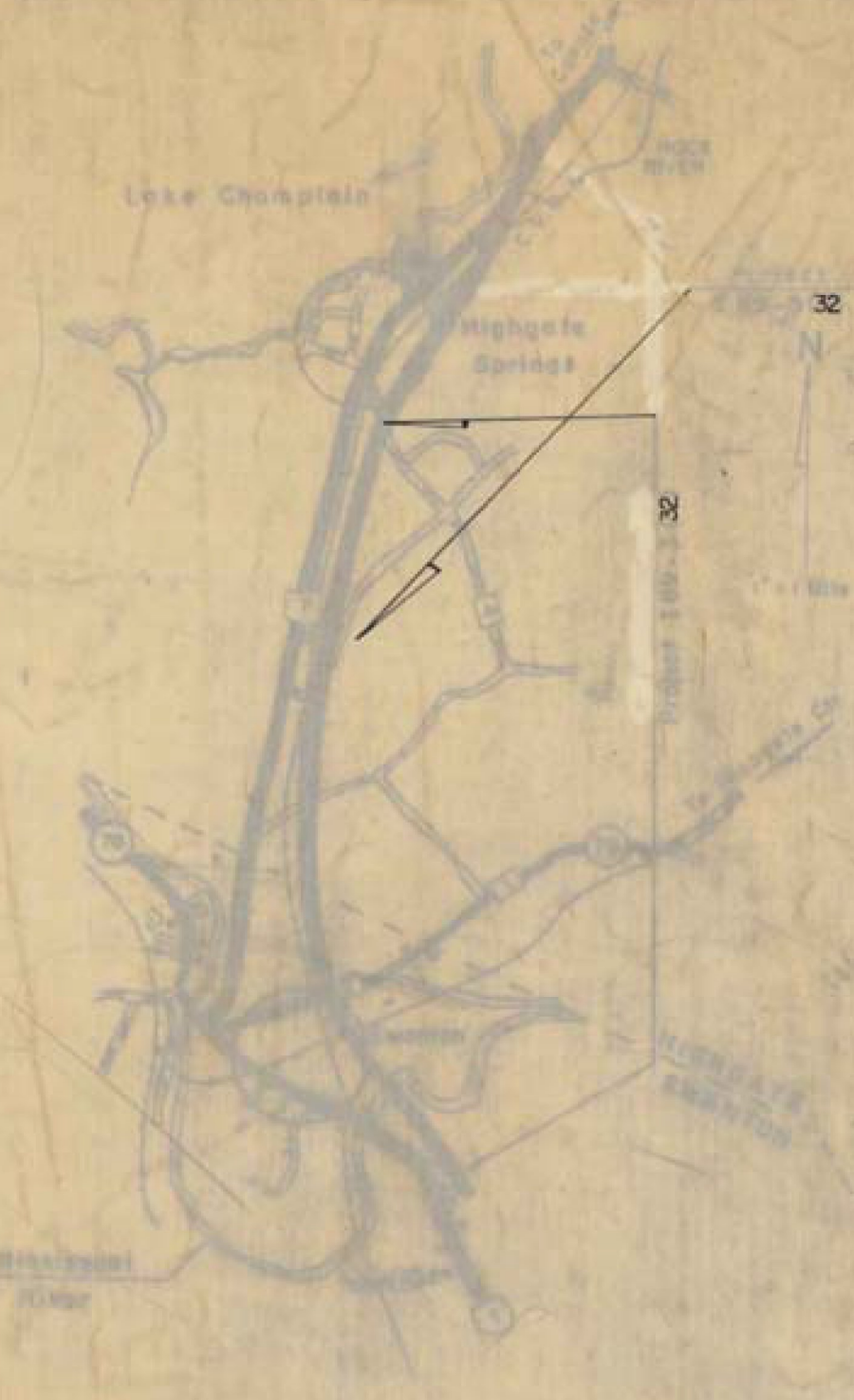

	N. OF INTERCH.	S. OF INTERCH.
ADT 1965	1750	4540
ADT 1985	4200	11400
DHV 1985	830	1780
T	6 1/2%	8%
V	70 MPH	70 MPH

METAL CULVERT PIPE - NORTHEASTERN CULVERT CO. - WESTMINSTER, VT.	CONTRACT:
CONTRACTOR - CALEDONIA SAND & GRAVEL CO. INC. - ST. JOHNSBURY, VT.	DATED - FEBRUARY 26, 1964
NILLER CONSTRUCTION INC. - WINDSOR, VT.	STARTED - MARCH 2, 1964
CHIEF RESIDENT ENGINEER - VAUGHN CLIFFORD	COMPLETED - NOVEMBER 3, 1965
RESIDENT ENGINEER - JOHN R. HUFFS	ACCEPTED - NOVEMBER 3, 1965
INSPECTORS - W. DOYLE, H. WARDER, A. FIDGON, J. BUSHEY	
RECORD PLANS - K. H. BRINLEY-CORRIGAN	

1687



SWANTON-HIGHGATE I 89-3(32)  
CONTRACTOR - CALEDONIA SAND & GRAVEL CO. INC. - ST. JOHNSBURY, VT.  
MILLER CONSTRUCTION INC. - WINDSOR, VT.  
CONST. COMPLETED - NOVEMBER 3, 1965  
RECORD PLANS - K. H. BRINLEY-CORRIGAN



LEGEND

RAH Arnold ASST. CHIEF ENGINEER 11/1/63

E.H. Ot 11/4/63

L.M. Byrne 11/4/63

B.M. Blanchard 11/6/63

G.M. Lane 11/4/63

A.D. Bushey 11/5/63



THESE PLANS ARE SUBJECT TO SUCH REVISIONS AS MAY BE REQUIRED BY THE BUREAU OF PUBLIC ROADS OR THE COMMISSIONER OF HIGHWAYS.

SWANTON  
IM 089-3(70)  
SHEET 14 OF 31  
FOR REFERENCE  
ONLY