

CONSTRUCTION APPROACH SIGNING

SEE STD. E-100M FOR SIGN PLACEMENT

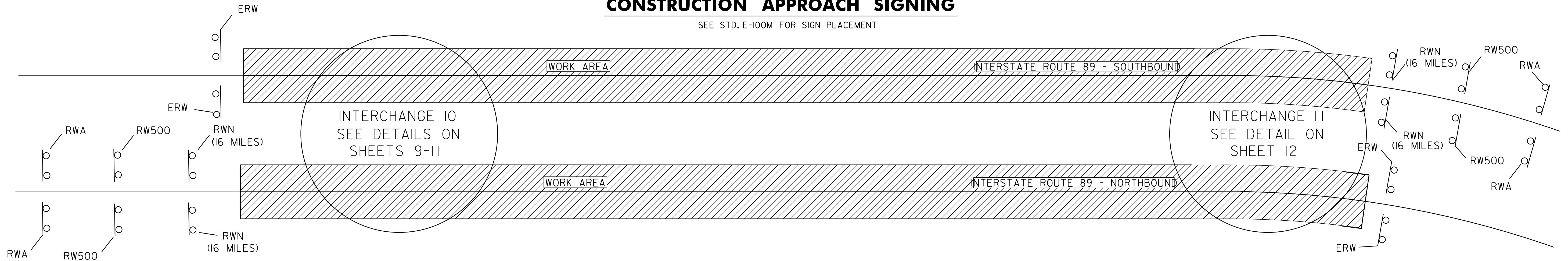

LEGEND

- RWA = ROAD WORK AHEAD
- RW500 = ROAD WORK 500 FEET
- RWN = ROAD WORK NEXT 16 MILES
(8 MILES AT END OF RAMP "H")
- ERW = END ROAD WORK
- SRWA = SIDE ROAD WORK AHEAD
- SRW500 = SIDE ROAD WORK 500 FEET

NOTES:

1. THE CONTRACTOR SHALL SUBMIT A SITE SPECIFIC TRAFFIC CONTROL PLAN TO THE RESIDENT ENGINEER FOR APPROVAL PRIOR TO THE START OF CONSTRUCTION. THE CONTRACTOR SHALL INCLUDE A CONSTRUCTION SIGN PACKAGE FOR EXPECTED LANE CLOSURES AND WORK ZONE SPEED REDUCTIONS IN ACCORDANCE WITH THE LATEST EDITION OF THE MANUAL ON UNIFORM TRAFFIC CONTROL DEVICES (MUTCD) AND VAOT STANDARD E-103. THIS WORK SHALL INCLUDE THE G20-5GP "WORK ZONE" PLAQUE AS DIRECTED BY THE RESIDENT ENGINEER. THE COST OF PREPARING THIS PLAN (AND MAKING CHANGES IF NECESSARY) SHALL BE INCLUDED IN THE UNIT PRICE BID FOR ITEM 641.10, TRAFFIC CONTROL.
2. THE CONTRACTOR SHALL POSITION PORTABLE CHANGEABLE MESSAGE SIGNS (PCMS) WARNING MOTORISTS OF THE EXPECTED ROADWAY CONDITIONS AHEAD. THE MESSAGE TO BE DISPLAYED, AND THEIR PROPOSED LOCATIONS SHALL BE SUBMITTED TO THE RESIDENT ENGINEER IN ADVANCE FOR APPROVAL. THE COST OF PROVIDING THESE MESSAGE SIGNS SHALL BE PAID UNDER ITEM 641.15, PORTABLE CHANGEABLE MESSAGE SIGN.
3. THE BID PRICE FOR TRAFFIC CONTROL, ITEM 641.10, SHALL INCLUDE ALL OF THE FOLLOWING, AS NEEDED: APPROACH AND ON-PROJECT CONSTRUCTION SIGNING, PORTABLE FLASHING ARROW BOARDS, BARRIERS, BARRELS, CONES, BARRICADES, TEMPORARY REGULATORY AND WARNING SIGNS, AND POSTS AS DETAILED IN VTRANS STANDARDS. ALL ADJUSTING, RELOCATING AND REMOVING OF THESE DEVICES AS DIRECTED BY THE RESIDENT ENGINEER SHALL ALSO BE INCLUDED.
4. THE LATEST EDITION OF THE MANUAL ON UNIFORM TRAFFIC CONTROL DEVICES (MUTCD) SHALL BE THE STANDARD FOR ALL TRAFFIC CONTROL DEVICES. EXISTING SIGNS AND MARKINGS SHALL BE VALID UNTIL SUCH TIME AS THEY ARE REPLACED OR RECONSTRUCTED. WHEN NEW TRAFFIC DEVICES ARE ERECTED OR PLACED, OR EXISTING TRAFFIC CONTROL DEVICES ARE REPLACED OR REPAIRED, THE EQUIPMENT, DESIGN, METHOD OF INSTALLATION, PLACEMENT OR REPAIR SHALL CONFORM WITH SUCH STANDARDS.
5. NO CONSTRUCTION SIGNS SHALL BE INSTALLED AS TO INTERFERE OR OBSTRUCT THE VIEW OF EXISTING TRAFFIC CONTROL DEVICES, STOPPING SIGHT DISTANCE, AND CORNER SIGHT DISTANCE FROM DRIVES AND TOWN HIGHWAYS. EXISTING SIGNS WHICH CONFLICT WITH TEMPORARY TRAFFIC CONTROL SHALL BE COMPLETELY COVERED OR REMOVED.
6. SEE VAOT STANDARD E-100 FOR ADDITIONAL SIGN PLACEMENT DETAILS.
7. CONSTRUCTION ZONE SIGN LAYOUT SHALL BE IN ACCORDANCE WITH SECTION 6 OF THE LATEST EDITION OF THE MANUAL ON UNIFORM TRAFFIC CONTROL DEVICES (MUTCD).
8. CONSTRUCTION SIGNS SHALL BE IN NEW OR LIKE NEW CONDITION PER VAOT STANDARDS AND THE SPECIAL PROVISIONS.
9. DIAMOND SHAPED SIGNS SHALL BE 4' X 4' WITH BLACK TEXT AND BORDER ON A RETROREFLECTIVE FLUORESCENT ORANGE BACKGROUND.
10. RETROREFLECTIVE SHEETING SHALL BE ASTM D 4956 TYPE III OR VIII MINIMUM AS NOTED ON VAOT STANDARD E-100 AND IN THE SPECIAL PROVISIONS.
11. CONSTRUCTION ZONE SIGNS SHALL BE INSTALLED AS OUTLINED IN THE SPECIAL PROVISIONS AND THE VAOT STANDARDS.
12. WHERE TEMPORARY SIGNS ARE PLACED BEHIND GUARDRAIL, THEY SHALL BE ADJUSTED SUCH THAT THE BOTTOMS OF THE SIGNS ARE ABOVE THE TOP OF GUARDRAIL.
13. AS THE PAVING OPERATION MOVES, FLAGGER SIGNS SHALL BE MOVED ACCORDINGLY. AT NO TIME SHOULD THE FLAGGER SYMBOL SIGN BE MORE THAN 1000 FEET FROM THE FLAGGER STATION. FLAGGER SIGNS SHALL BE COVERED OR TURNED AWAY FROM TRAFFIC WHEN FLAGGING OPERATIONS CEASE FOR LONGER THAN 15 MINUTES.
14. BARRELS AND CONES SHALL BE USED TO CLEARLY DEFINE THE TRAVEL SPACE AND PROVIDE SEPARATION FROM THE WORK SPACE ALONG ITS ENTIRE LENGTH.
15. FOR LANE CLOSURES GREATER THAN 1/2 MILE LONG, PLACE ONE TYPE III BARRICADE ACROSS THE CLOSED LANE AT 1500 FOOT INTERVALS.

NOT TO SCALE

CONSTRUCTION APPROACH SIGNING SHEET 1

PROJECT NAME: WATERBURY-RICHMOND
PROJECT NUMBER: IM SURF(33)

FILE NAME: I2A178.dgn
PROJECT LEADER: FOWLER
DESIGNED BY: PVT. MGT.
IPARM FILE NAME: I2A178_17.1

PLOT DATE: 10-APR-2014 14:17
DRAWN BY: PVT. MGT.
CHECKED BY: PVT. MGT.
SHEET 17 OF 19