

SECTION A
(GIRDER ASS'Y)

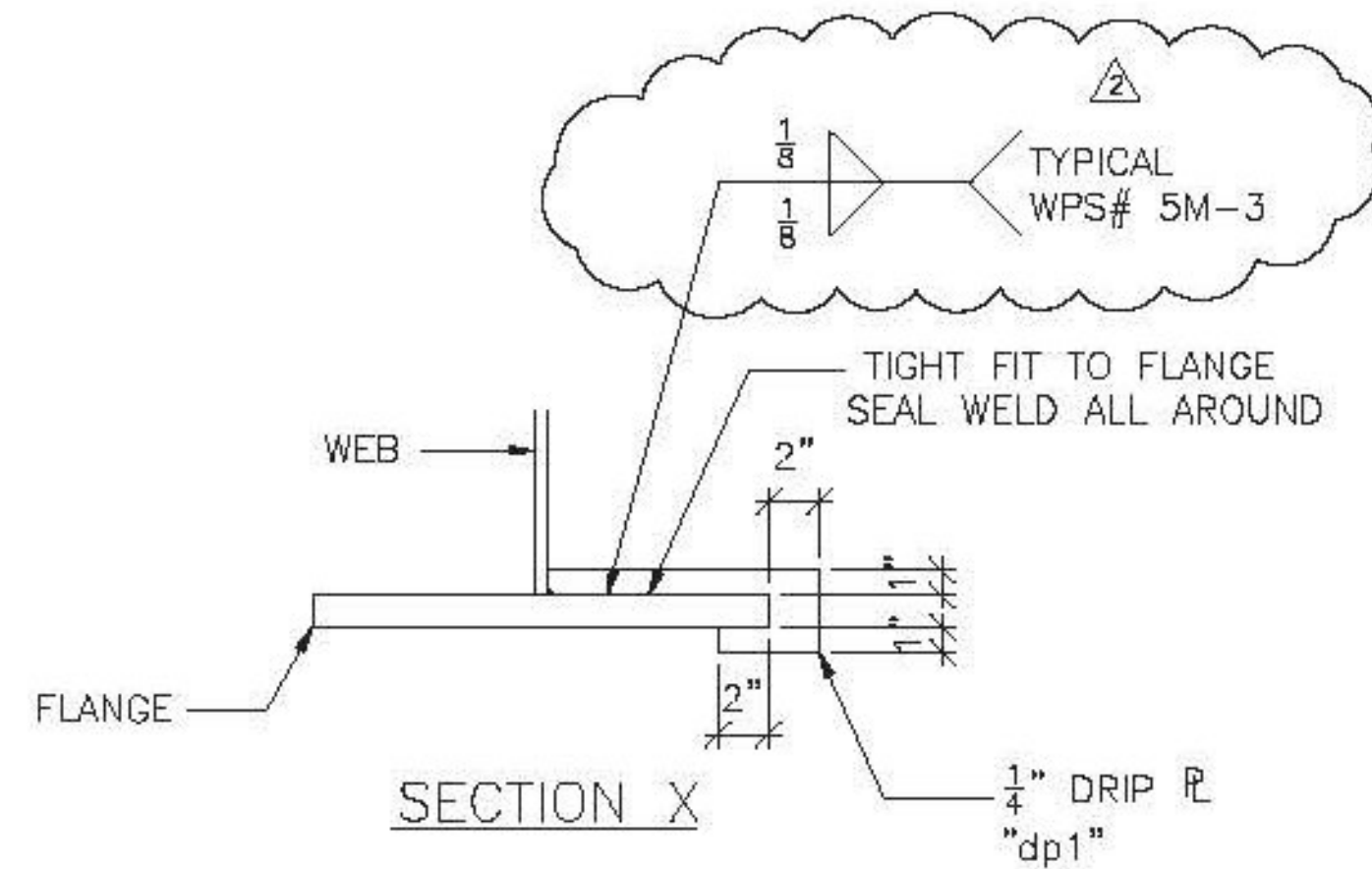

SECTION X

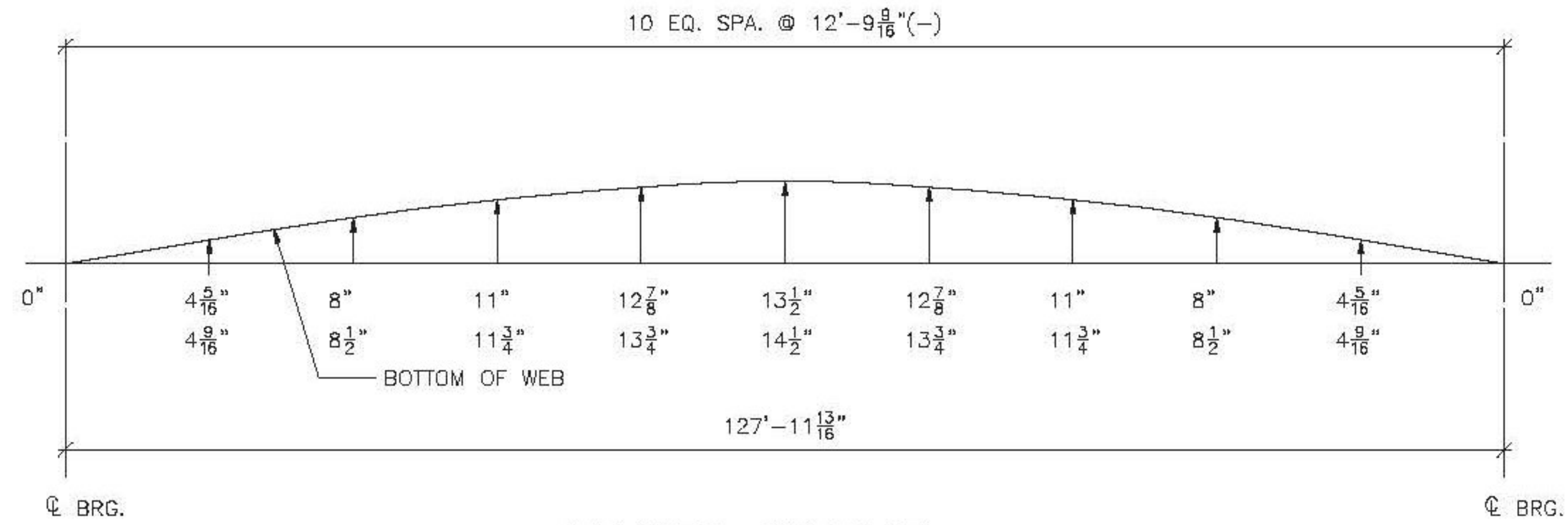

CAMBER DIAGRAM

THE TWO CAMBER DIMENSIONS SHOWN REPRESENT THE FOLLOWING:
 TOP DIMENSION - TOTAL CAMBER IN FINISHED BEAM IN A NO-LOAD POSITION
 BTM. DIMENSION - TOTAL CAMBER OF WEB @ TIME OF FABRICATION

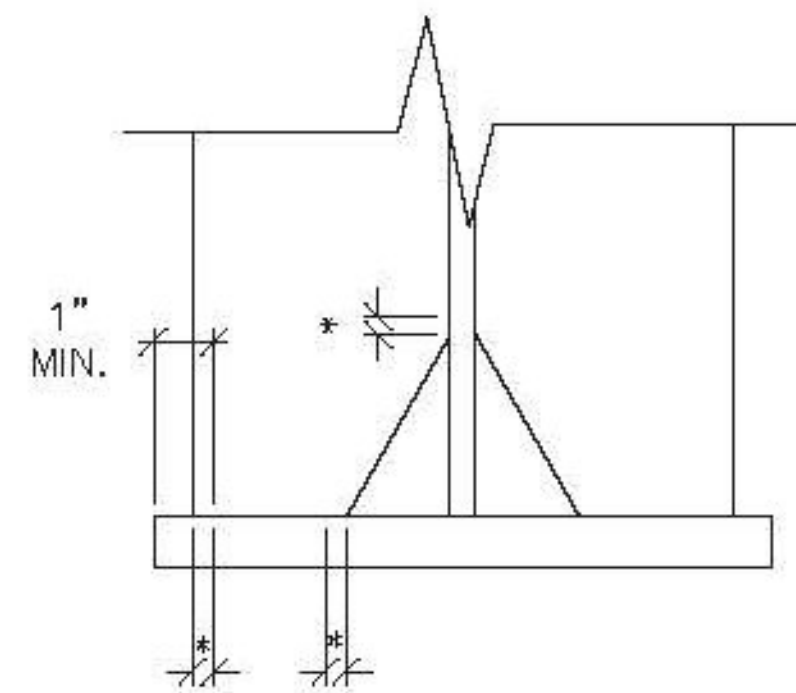

WELD TERMINATION DETAIL

* NO WELD FOR 3/8" MIN. 7/8" MAX.

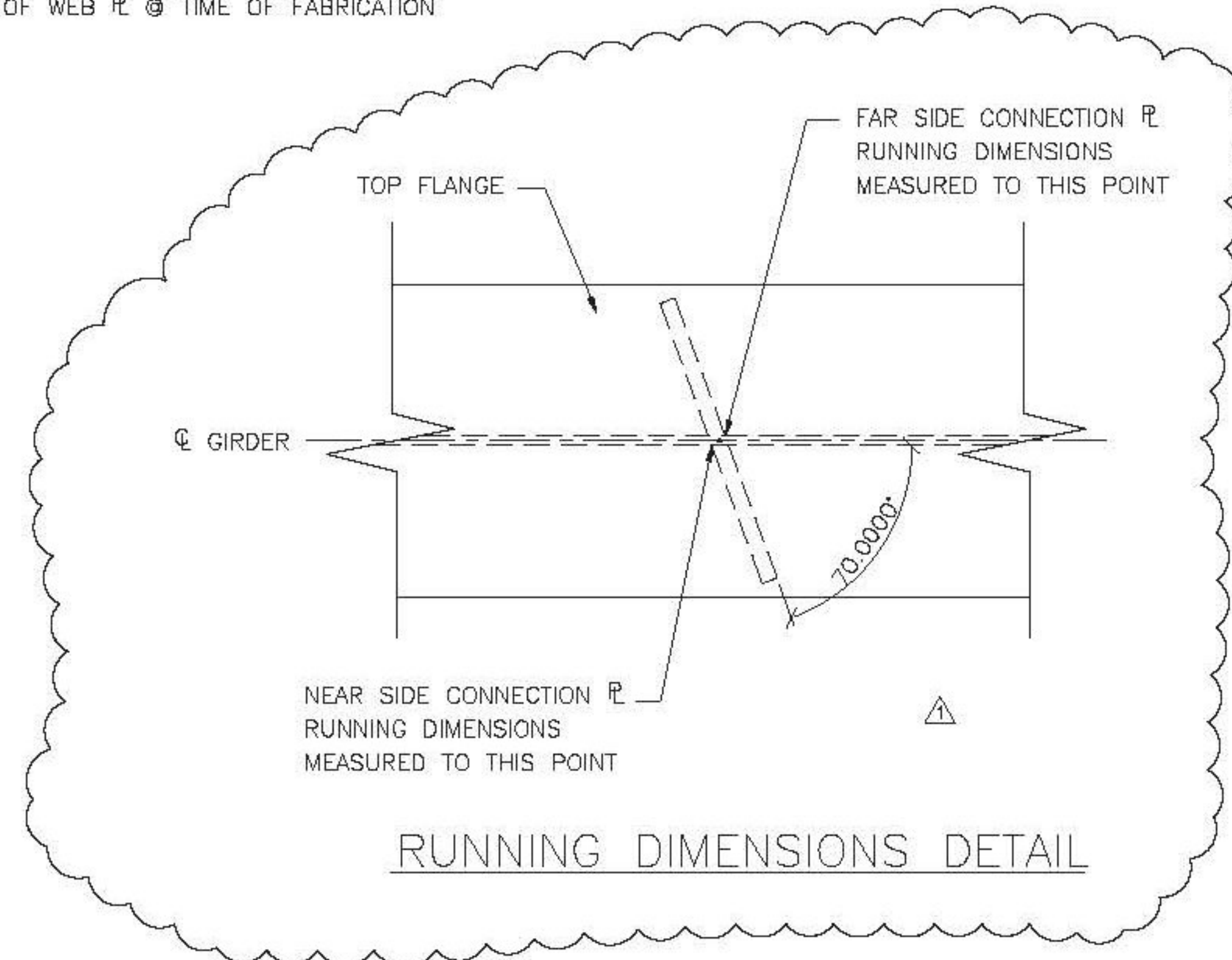

RUNNING DIMENSIONS DETAIL

Vermont Agency of Transportation

RECEIVED

CK'D BY RKJJC OK'D BY WVL

February 17, 2015

RESUBMIT NO Approved
 BY KH DATE 2-19-2015

FINISH				
MATERIAL	ASTM A709 GRADE 50W U.O.N.			
HOLES	15/16" U.O.N.			
ELECTRODES				
WELDS	PER WPS	2/15/15	AS NOTED	JAC
SURFACE PREP		1/29/15	AS NOTED	JAC
		NO	DATE	DESCRIPTION
				BY

REVISIONS		PROJECT NO.
		14-180
		DWG. NO.
		M1

ARC
 ADVANCED RESOURCES & CONST.
 ENTERPRISES, INCORPORATED
 P.O. BOX 120 KINGFIELD, ME. 04947
 PHONE: (207) 265-2846 - FAX: (207) 265-4054

DRAFTER JAC MISC. DETAILS
 DATE 1/09/15 HARTFORD, VT 7-95 NB OVER US RTE. 5
 CHECKED JS PROJECT NUMBER IM 091-2(79)
 DATE 1/14/15 CUSTOMER: PCL CIVIL CONSTRUCTORS