

* STIFFENER FOR LATERAL SLIDE SUPPORT

BILL OF MATERIAL							
SHIP	SHIP MARK	NO. PCS.	PIECE MARK	DESCRIPTION	LENGTH	REMARKS	WT.
1	G4			WELDED PLATE GIRDER			38055
		1	wp1	1/2 X 3/8	53'-6 1/8"	CVN	4328
		1	wp2	1/2 X 3/8	80'-0"	CVN	6466
		1	tf1	1 1/2 X 20	80'-0"	CVN	6806
		1	tf2	1 1/2 X 20	53'-6 1/8"	CVN	4556
		1	bf1	1 1/2 X 20	44'-5 1/4"	CVN	4975
		1	bf2	1 1/2 X 20	44'-5 1/4"	CVN	4975
		1	bf3	1 1/2 X 20	44'-5 1/8"	CVN	4975
		4	p1	SEE SHT. M2			
		4	p2	SEE SHT. M2			
		14	p3	SEE SHT. M2			

BOTTOM FLANGE R MATERIAL SHALL BE ASTM A709 GR. HPS 70W

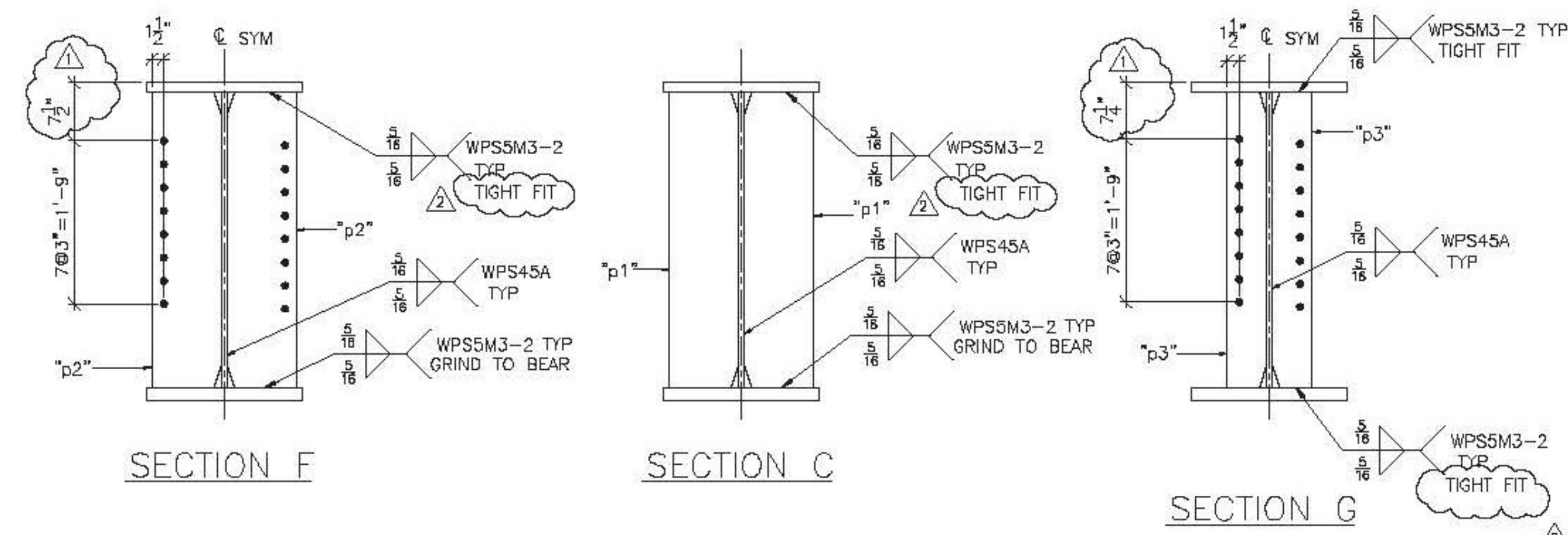

SEE SHEET M1 FOR CAMBER AND SECTIONS & DETAILS NOT SHOWN

Vermont Agency of Transportation
RECEIVED

CK'D BY RKJJC OK'D BY WL
February 17, 2015
RESUBMIT NO Approved
BY KH DATE 2-19-2015

SHOP NOTE:
ENTIRE TOP FLANGE IS IN COMPRESSION
ENTIRE BOTT FLANGE IS IN TENSION

FINISH	SSPC SP10				
MATERIAL	ASHTO M270 (ASTM A706) GR. 50W U.D.N.				
HOLES	15/16" U.D.N.				
ELECTRODES					
WELDS	PER WPS	2/13/15	AS NOTED	JAC	
SURFACE PREP		1/29/15	AS NOTED	JAC	
		NO	DATE	DESCRIPTION	BY

ARC
ADVANCED RESOURCES & CONST. ENTERPRISES, INCORPORATED
P.O. BOX 120 KINGFIELD, ME 04947
PHONE: (207) 265-2646 - FAX: (207) 265-4054

STRINGER DETAILS, G4
HARTFORD, VT I-91 NB OVER US RTE. 5
PROJECT NUMBER IM 091-2(79)
PCL CIVIL CONSTRUCTORS

DRAFTER JAC
DATE 1/6/15
CHECKED JS
DATE 1/14/15

PROJECT NO. 14-180
DWG. NO. 5