

Vermont Agency of Transportation
RECEIVED
 CK'D BY RKJC OK'D BY WL
 February 17, 2015
 RESUBMIT NO Approved
 BY KH DATE 2-19-2015

BILL OF MATERIAL							
SHIP	SHIP MARK	NO. PCS.	PIECE MARK	DESCRIPTION	LENGTH	REMARKS	WT.
1	G3			WELDED PLATE GIRDER			38055
		1	wp1	1/2 X 3B	53'-6 1/8"	CVN	4328
		1	wp2	1/2 X 3B	80'-0"	CVN	6466
		1	tf1	1 1/2 X 20	80'-0"	CVN	6806
		1	tf2	1 1/2 X 20	53'-6 1/8"	CVN	4556
		1	bf1	1 1/2 X 20	44'-5 1/4"	CVN	4975
		1	bf2	1 1/2 X 20	44'-5 1/4"	CVN	4975
		1	bf3	1 1/2 X 20	44'-5 1/8"	CVN	4975
		4	p1	SEE SHT. M2			
		4	p2	SEE SHT. M2			
		14	p3	SEE SHT. M2			

BOTTOM FLANGE R MATERIAL SHALL BE ASTM A709 GR. HPS 70W

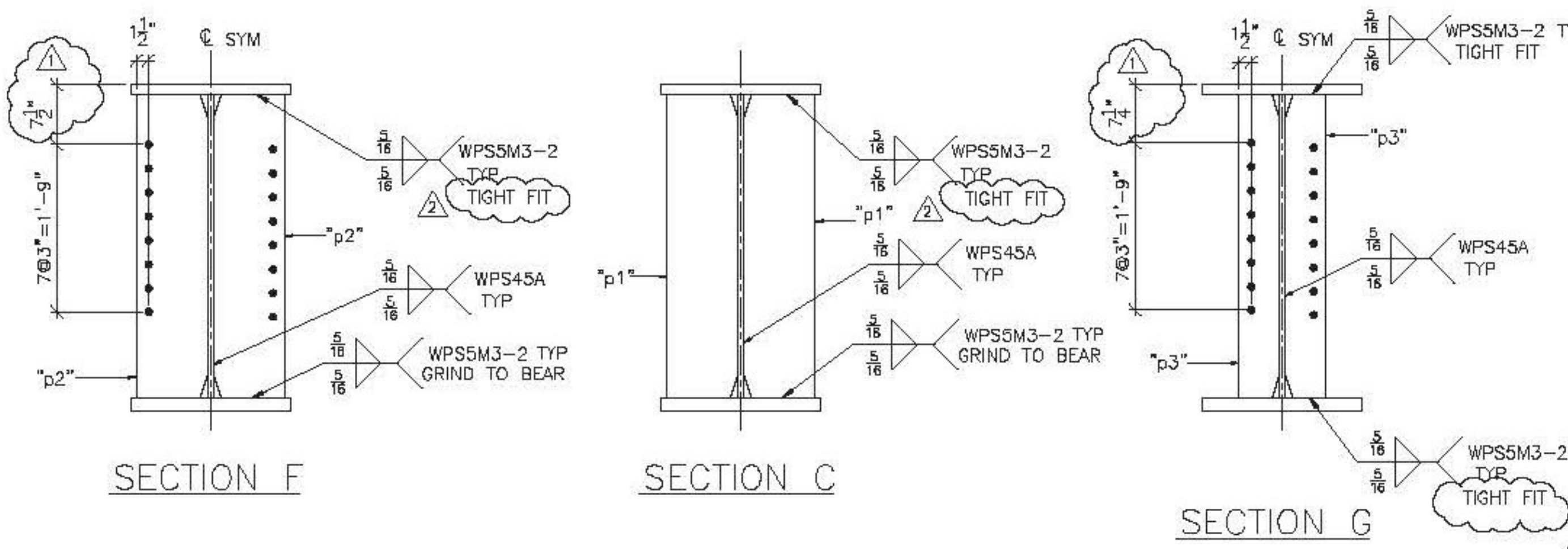

SEE SHEET M1 FOR CAMBER AND SECTIONS & DETAILS NOT SHOWN

SHOP NOTE:
 ENTIRE TOP FLANGE IS IN COMPRESSION
 ENTIRE BOTT FLANGE IS IN TENSION

FINISH	SSPC SP10			
MATERIAL	ASHTO M270 (ASTM A706) GR. 50W U.D.N.			
HOLES	15/16" U.D.N.			
ELECTRODES				
WELDS	PER WPS	2/13/15	AS NOTED	JAC
SURFACE PREP		1/29/15	AS NOTED	JAC
		NO	DATE	DESCRIPTION
				BY

REVISIONS

NO.	DATE	DESCRIPTION	BY
-----	------	-------------	----

ARC
 ADVANCED RESOURCES & CONST. ENTERPRISES, INCORPORATED
 P.O. BOX 120 KINGFIELD, ME 04947
 PHONE: (207) 265-2646 - FAX: (207) 265-4054

DRAFTER	JAC	STRINGER DETAILS, G3	PROJECT NO.
DATE	1/6/15	HARTFORD, VT I-91 NB OVER US RTE. 5	14-180
CHECKED	JS	PROJECT NUMBER IM 091-2(79)	DWG. NO.
DATE	1/14/15	G.C. PCL CIVIL CONSTRUCTORS	4