

Vermont Agency of Transportation
RECEIVED
 CK'D BY RKJUC OK'D BY WL
 February 17, 2015
 RESUBMIT NO Approved
 BY KH DATE 2-19-2015

* STIFFENER FOR LATERAL SLIDE SUPPORT

BILL OF MATERIAL							
SHIP	SHIP MARK	NO. PCS.	PIECE MARK	DESCRIPTION	LENGTH	REMARKS	WT.
1	G2			WELDED PLATE GIRDER			38055
		1	wp1	PL 3/8 X 3B	53'-6 9/16"	CVN	4328
		1	wp2	PL 3/8 X 3B	80'-0"	CVN	6486
		1	tf1	PL 1 1/2 X 20	80'-0"	CVN	6906
		1	tf2	PL 1 1/2 X 20	53'-6 9/16"	CVN	4536
		1	bf1	PL 1 1/2 X 20	44'-5 1/4"	CVN	4915
		1	bf2	PL 1 1/2 X 20	44'-5 1/4"	CVN	4915
		1	bf3	PL 1 1/2 X 20	44'-5 1/4"	CVN	4915
		4	p1	SEE SHT. M2			
		4	p2	SEE SHT. M2			
		14	p3	SEE SHT. M2			

BOTTOM FLANGE PL MATERIAL SHALL BE ASTM A709 GR. HPS 70W

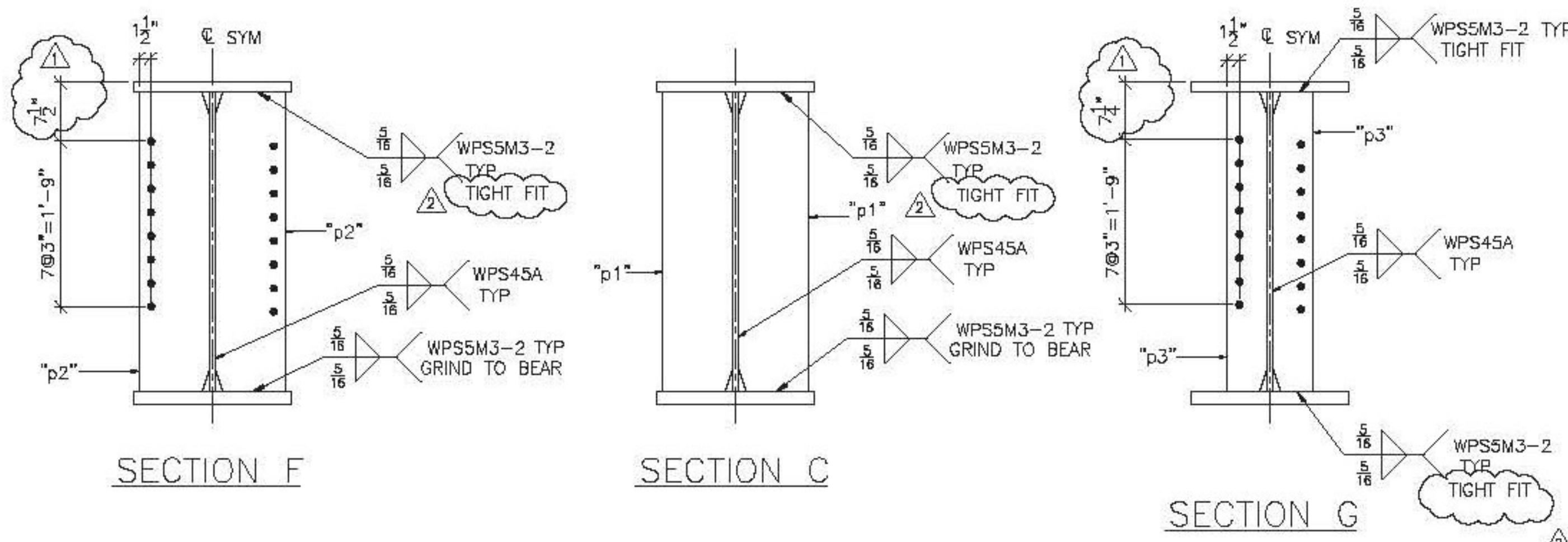

SEE SHEET M1 FOR CAMBER AND SECTIONS & DETAILS NOT SHOWN

SHOP NOTE:
 ENTIRE TOP FLANGE IS IN COMPRESSION
 ENTIRE BOTT FLANGE IS IN TENSION

FINISH	SSPC SP10			
MATERIAL	AASHTO M270 (ASTM A708) GR. 50W U.O.M.			
HOLES	15/16" U.O.M.			
ELECTRODES				
WELDS	PER WPS	2/2/13/15	AS NOTED	JAC
SURFACE PREP		1/1/29/15	AS NOTED	JAC
		NO DATE	DESCRIPTION	BY

REVISIONS

ARC	ADVANCED RESOURCES & CONST. ENTERPRISES, INCORPORATED	PROJECT NO. 14-180
	P.O. BOX 120 KINGFIELD, ME. 04947	DWC. NO.
	PHONE: (207) 265-2646 - FAX: (207) 265-4054	3

DRAFTER JAC
 DATE 1/6/15
 CHECKED JS
 DATE 1/14/15

STRINGER DETAILS, G2
 HARTFORD, VT I-91 NB OVER US RTE. 5
 PROJECT NUMBER IM 091-2(79)
 G.C. PCL CIVIL CONSTRUCTORS