

TEMPORARY CROSSWALK MARKING
 RAMP F MM 0.160 LT. & RT.
 SLIP RAMP E 0.179 LT.

CROSSWALK MARKING
 RAMP F MM 0.160 LT. & RT.
 SLIP RAMP E 0.179 LT.

LETTER OR SYMBOL
 RAMP F MM 0.069 CENTERLINE - "SIGNAL"
 RAMP F MM 0.077 CENTERLINE - "AHEAD"
 RAMP F MM 0.125 LT. - "ONLY" (2)
 RAMP F MM 0.127, RT.
 RAMP F MM 0.127, RT.
 RAMP F MM 0.127, LT. - (2)
 RAMP F MM 0.154, LT. - "ONLY" (2)
 RAMP F MM 0.156, RT.
 RAMP F MM 0.156, RT.
 RAMP F MM 0.156, LT. - (2)

TEMPORARY LETTER OR SYMBOL
 RAMP F MM 0.070 CENTERLINE - "SIGNAL"
 RAMP F MM 0.077 CENTERLINE - "AHEAD"
 RAMP F MM 0.127 RT.
 RAMP F MM 0.127 RT.
 RAMP F MM 0.127 LT. - (2)
 RAMP F MM 0.156 RT.
 RAMP F MM 0.156 RT.
 RAMP F MM 0.156 LT. - (2)

TEMPORARY 6" YELLOW LINE
 RAMP E MM 0.075 TO RAMP E MM 0.178, SOLID RT.
 RAMP E MM 0.176 TO RAMP E MM 0.182, SOLID FAR LT.
 RAMP F MM 0.062 TO RAMP F MM 0.158, SOLID LT.

6" YELLOW LINE
 RAMP E MM 0.075 TO RAMP E MM 0.178, SOLID RT.
 RAMP E MM 0.176 TO RAMP E MM 0.182, SOLID FAR LT.
 RAMP F MM 0.062 TO RAMP F MM 0.158, SOLID LT.

12" WHITE LINE
 RAMP E MM 0.149 TO RAMP E MM 0.162, SOLID CENTERLINE
 RAMP E MM 0.162 TO RAMP E MM 0.176, SOLID CENTERLINE & SOLID LT. W/DIAGONALS

TEMPORARY 12" WHITE LINE
 RAMP E MM 0.149 TO RAMP E MM 0.162, SOLID CENTERLINE
 RAMP E MM 0.162 TO RAMP E MM 0.176, SOLID CENTERLINE & SOLID LT. W/DIAGONALS

TEMPORARY 6" WHITE LINE
 RAMP E MM 0.075 TO RAMP E MM 0.182, SOLID LT.
 RAMP E MM 0.176 TO RAMP E MM 0.182, SOLID LT. & CENTERLINE (BREAK FOR CROSSWALK)
 RAMP F MM 0.062 TO RAMP F MM 0.162, SOLID RT. (BREAK FOR CROSSWALK)
 RAMP F MM 0.077 TO RAMP F MM 0.124, DOTTED CENTERLINE
 RAMP F MM 0.124 TO RAMP F MM 0.158, SOLID LT. & RT./DASHED RT.

6" WHITE LINE
 RAMP E MM 0.075 TO RAMP E MM 0.182, SOLID LT.
 RAMP E MM 0.176 TO RAMP E MM 0.182, SOLID LT. & CENTERLINE (BREAK FOR CROSSWALK)
 RAMP F MM 0.062 TO RAMP F MM 0.162, SOLID RT. (BREAK FOR CROSSWALK)
 RAMP F MM 0.077 TO RAMP F MM 0.124, DOTTED CENTERLINE
 RAMP F MM 0.124 TO RAMP F MM 0.158, SOLID LT. & RT./DASHED RT.

TEMPORARY 24" STOP BAR
 RAMP F MM 0.158 LT. & RT.

24" STOP BAR
 RAMP F MM 0.158 LT. & RT.

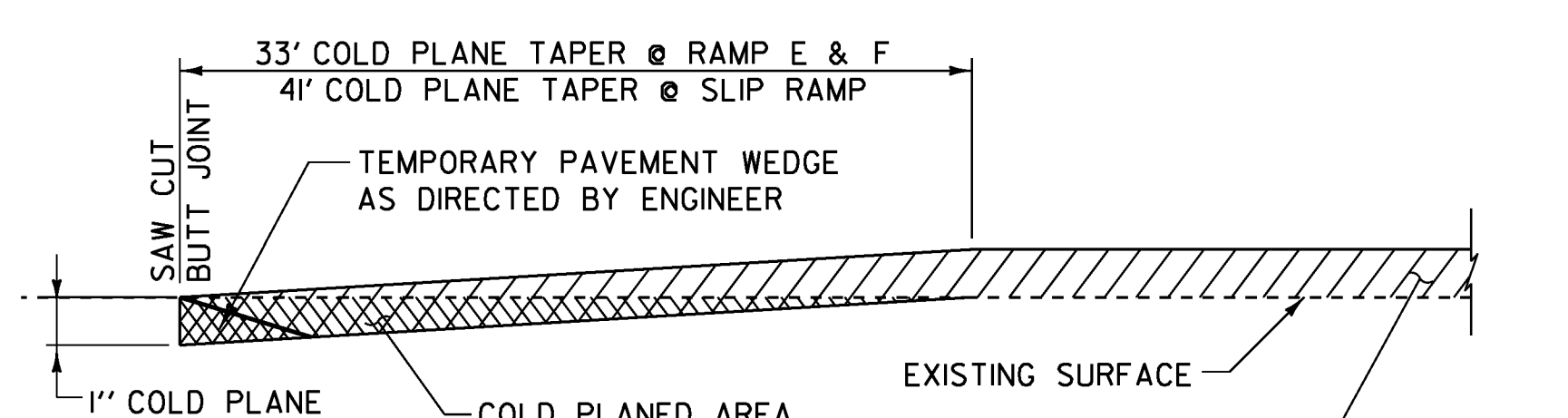
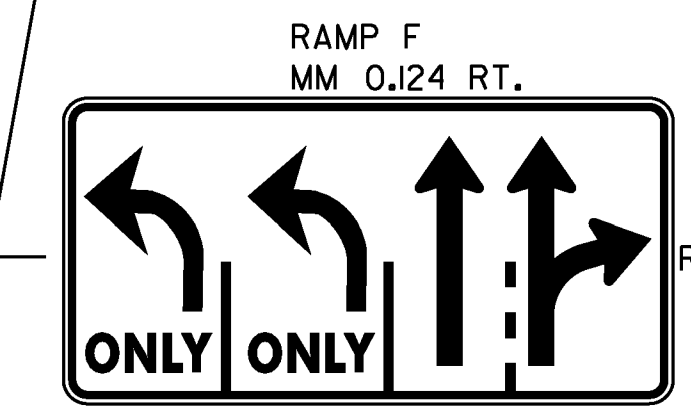
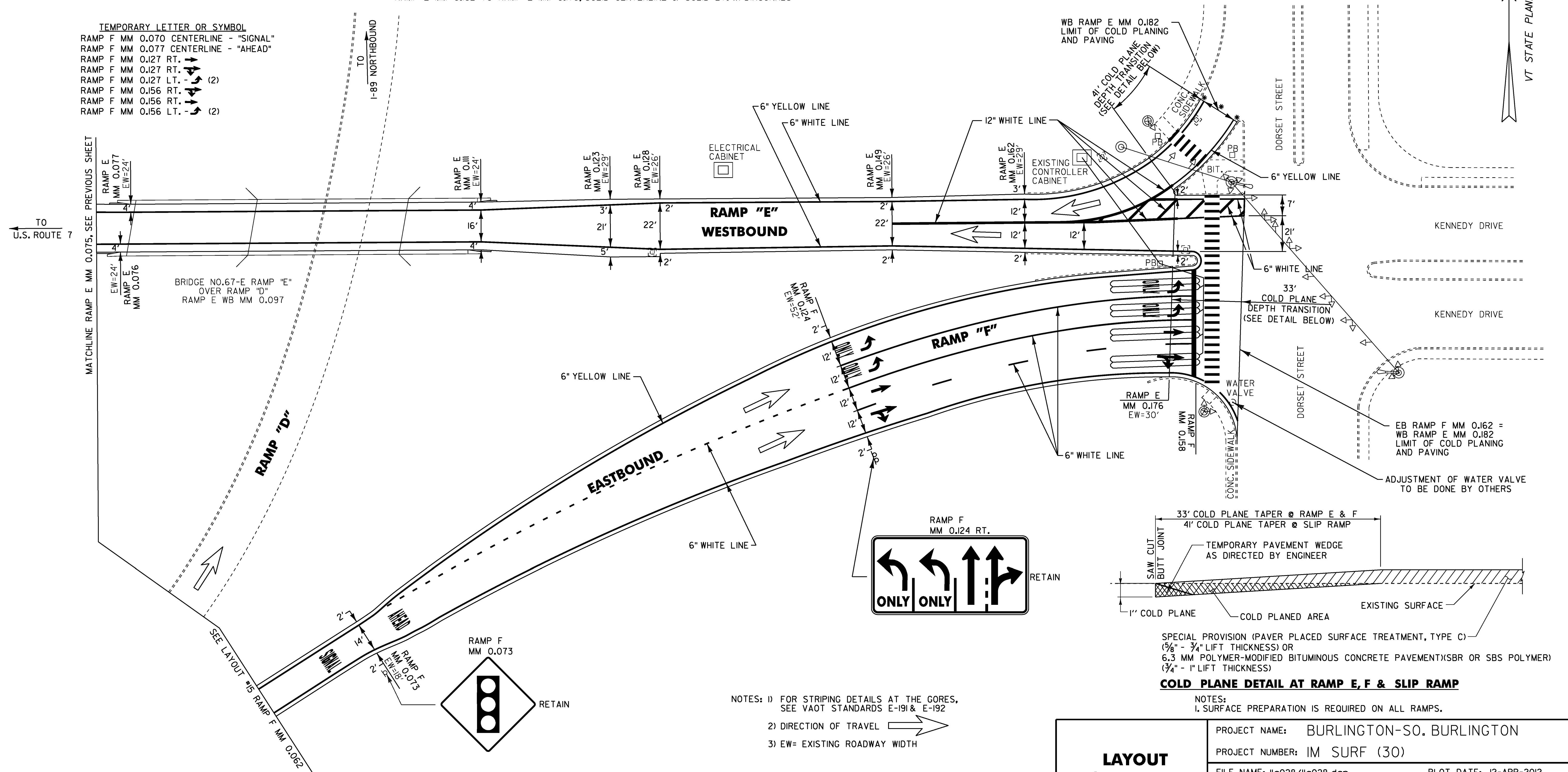
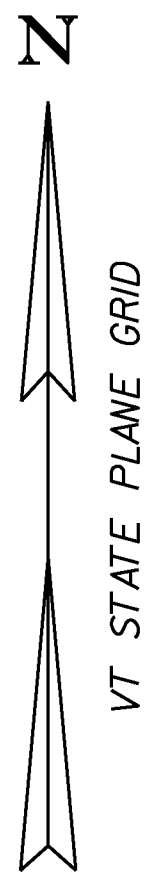

NOTES: 1) FOR STRIPING DETAILS AT THE GORES, SEE VAOT STANDARDS E-191 & E-192
 2) DIRECTION OF TRAVEL
 3) EW= EXISTING ROADWAY WIDTH

SPECIAL PROVISION (PAVER PLACED SURFACE TREATMENT, TYPE C)
 (5/8" - 3/4" LIFT THICKNESS) OR
 6.3 MM POLYMER-MODIFIED BITUMINOUS CONCRETE PAVEMENT (SBR OR SBS POLYMER)
 (3/4" - 1" LIFT THICKNESS)

COLD PLANE DETAIL AT RAMP E, F & SLIP RAMP
 NOTES:
 1. SURFACE PREPARATION IS REQUIRED ON ALL RAMPS.

LAYOUT SHEET #17

PROJECT NAME:	BURLINGTON-SO. BURLINGTON
PROJECT NUMBER:	IM SURF (30)
FILE NAME:	11a028/11a028.dgn
PROJECT LEADER:	M. FOWLER
DESIGNED BY:	L. BULLOCK
11a028/11a028.dgn	
PLOT DATE:	12-APR-2012
DRAWN BY:	L. BULLOCK
CHECKED BY:	M. FOWLER
SHEET	32 OF 49

* MATCH EXISTING CONDITIONS

NOT TO SCALE