

TEMPORARY 6" WHITE LINE
 I-189 EB MM 0.733 TO I-189 EB MM 0.845, DASHED CENTERLINE/SOLID RT.
 I-189 WB MM 0.733 TO I-189 WB MM 0.845, DASHED CENTERLINE/SOLID LT.

6" WHITE LINE
 I-189 EB MM 0.733 TO I-189 EB MM 0.845, DASHED CENTERLINE/SOLID RT.
 I-189 WB MM 0.733 TO I-189 WB MM 0.845, DASHED CENTERLINE/SOLID LT.

TEMPORARY 6" YELLOW LINE
 I-189 EB MM 0.733 TO I-189 EB MM 0.845, SOLID LT.
 I-189 WB MM 0.733 TO I-189 WB MM 0.845, SOLID RT.

6" YELLOW LINE
 I-189 EB MM 0.733 TO I-189 EB MM 0.845, SOLID LT.
 I-189 WB MM 0.733 TO I-189 WB MM 0.845, SOLID RT.

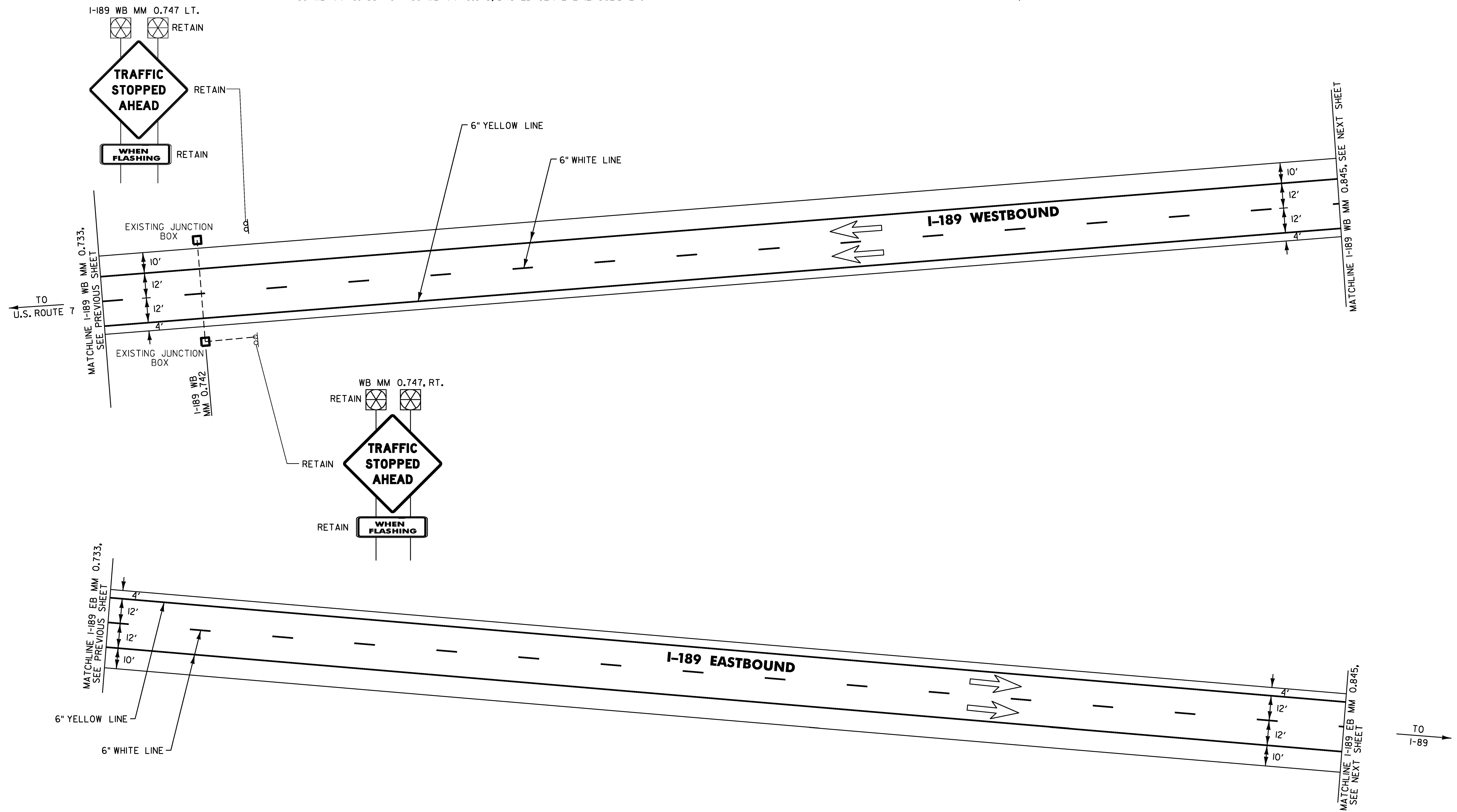
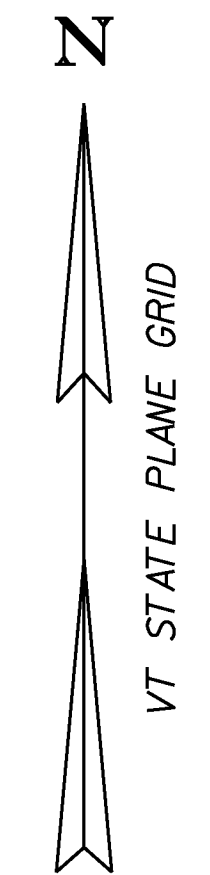

- NOTES: 1) FOR STRIPING DETAILS AT THE GORES, SEE VAOT STANDARDS E-191 & E-192
 2) DIRECTION OF TRAVEL
 3) EW= EXISTING ROADWAY WIDTH

NOT TO SCALE

LAYOUT SHEET #9

PROJECT NAME: BURLINGTON-SO. BURLINGTON

PROJECT NUMBER: IM SURF (30)

FILE NAME: Ila028/Ila028.dgn
 PROJECT LEADER: M. FOWLER
 DESIGNED BY: L. BULLOCK
 Ila028Ia9.1

PLOT DATE: 12-APR-2012
 DRAWN BY: L. BULLOCK
 CHECKED BY: M. FOWLER
 SHEET 24 OF 49