

D.P.R. DIV. NO.	STATE	PROJECT NO.	SHEET NO.	TOTAL SHEETS
1	Vt.	I 91-11111	198	555

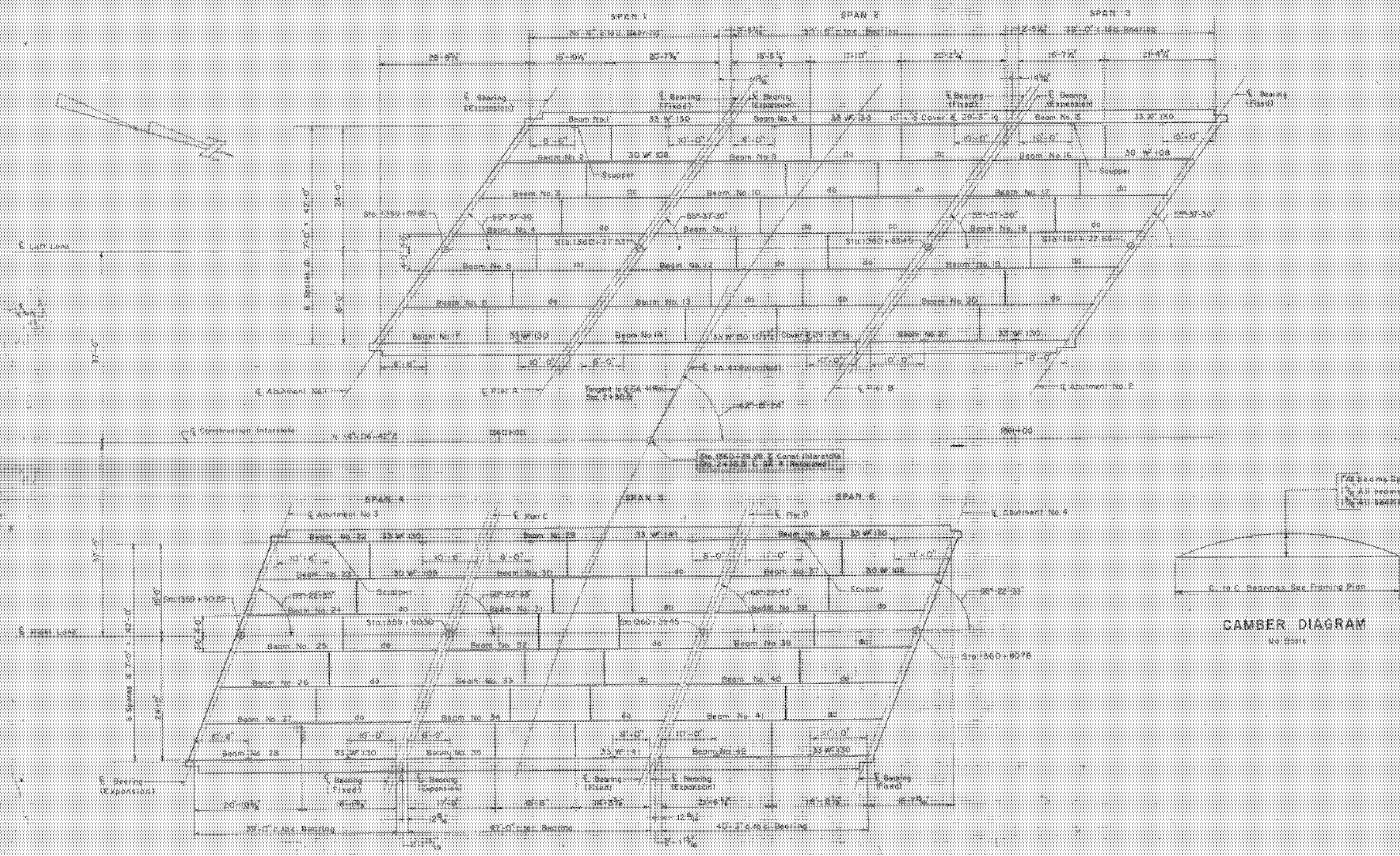

FRAMING PLAN
SCALE 1/4" = 1'-0"

- Notes:
1. Camber diagrams to be IR-DECK 26 for Spans 2 & 5, 18 & 33.3 for Spans 1, 3, 4, & 6.
 2. For Superstructure Sections and Details, see Sheet No. 199.
 3. All beams shall be rolled to true circular camber with the middle ordinate as shown on this sheet.
 4. For Bearing Details, see Standard Sheet No. SB-20-56.
 5. All Ranges as per Standard Sheet No. SB-22-96.
 6. All stationing refers to S. Construction Interstate excluding stationing along SA-4 (Relocated).
 7. All Beams and cover plates shall conform to A.S.T.M. Designation A333. All other structural steel shall conform to Designation A7 or A373.

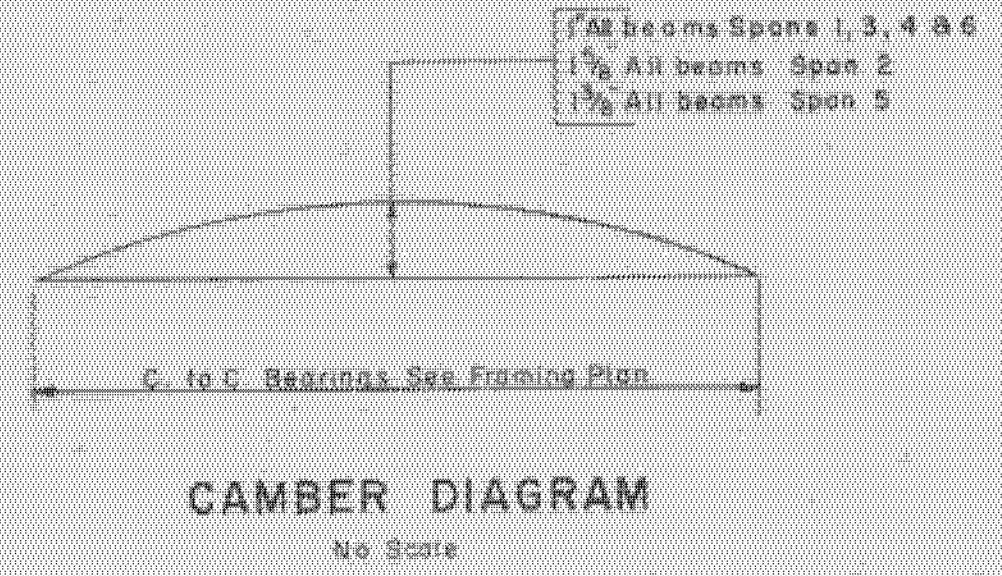

IR-DECK (26)
BR 18 N & S
THIS SHEET FOR
INFORMATION ONLY

SHEET 46 OF 76

STRUCTURAL STEEL PLAN

STATE OF WESTMINSTER - NORWICH
DEPARTMENT OF HIGHWAYS
INTERSTATE PROJECT FOR REFERENCE ONLY
WESTMINSTER
INTERSTATE OVER STA. 1360 + 29.28
SA 4 (RELOCATED) STA 2 + 36.51
THE CLARKESON ENGINEERING CO., INC.
CONSULTING ENGINEERS
BOSTON MASSACHUSETTS
DRAWN BY R.F. CHECKED BY J.W. EGAN
PROJECT NO. I 91-11111 SHEET 198 OF 555