

DIRECTIONAL DRILL/BORE | SHALLOW SLOPES PLACE MATTING ON DISTURBED AREAS & PROTECT ADJACENT CATCH BASINS/CULVERTS | DIRECTIONAL DRILL/BORE | SHALLOW SLOPES PLACE MATTING ON DISTURBED AREAS & PROTECT ADJACENT CATCH BASINS/CULVERTS | STEEP SLOPES PLACE MATTING ON DISTURBED AREAS & PROTECT ADJACENT CATCH BASINS/CULVERTS | SHALLOW SLOPES PLACE MATTING ON DISTURBED AREAS & PROTECT ADJACENT CATCH BASINS/CULVERTS | STEEP SLOPES PLACE MATTING ON DISTURBED AREAS & PROTECT ADJACENT CATCH BASINS/CULVERTS

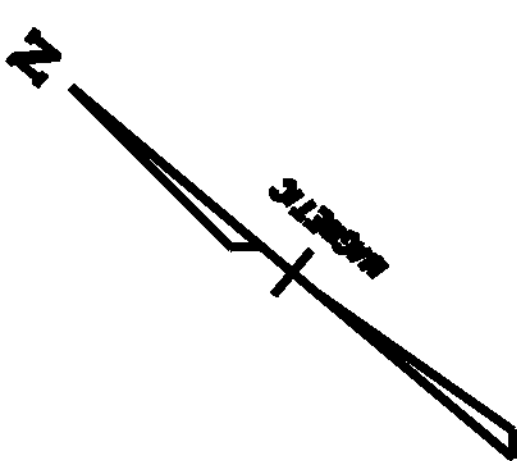

- LEGEND**
- EXISTING LIMIT OF WETLAND
 - EXISTING CULVERT OR DRAINAGE
 - PROPOSED HANDHOLE
 - PROPOSED SPLICE VAULT
 - PROPOSED COMMUNICATION CONDUIT
 - STABILIZED CONSTRUCTION ENTRANCE
 - PROPOSED SILT FENCE

EPSC PLAN
 SCALE 1" = 200'-0"

NOTE: SEE SHEET 50, FOR EPSC NOTES
 AREA OF DISTURBANCE
 (THIS SHEET) = 4,422.0 SF (0.102 AC)

PROJECT NAME: HARTFORD SHARON	
PROJECT NUMBER: FITS503	
FILE NAME: z06e142ER09.dgn	PLOT DATE: 9/15/2010
PROJECT LEADER: J. YOUNG	DRAWN BY: S. GUNN
DESIGNED BY: A. SEAMAN	CHECKED BY: J. WILSON
EPSC PLAN (SHEET 9 OF 14)	SHEET 58 OF 70