

HH#345 528+50 CAT PLOW  
 HH#33 510+25 508+00 TRENCH  
 SPIDER PLOW 488+00  
 TRENCH HH#32 478+00 DIRECTIONAL DRILL/BORE

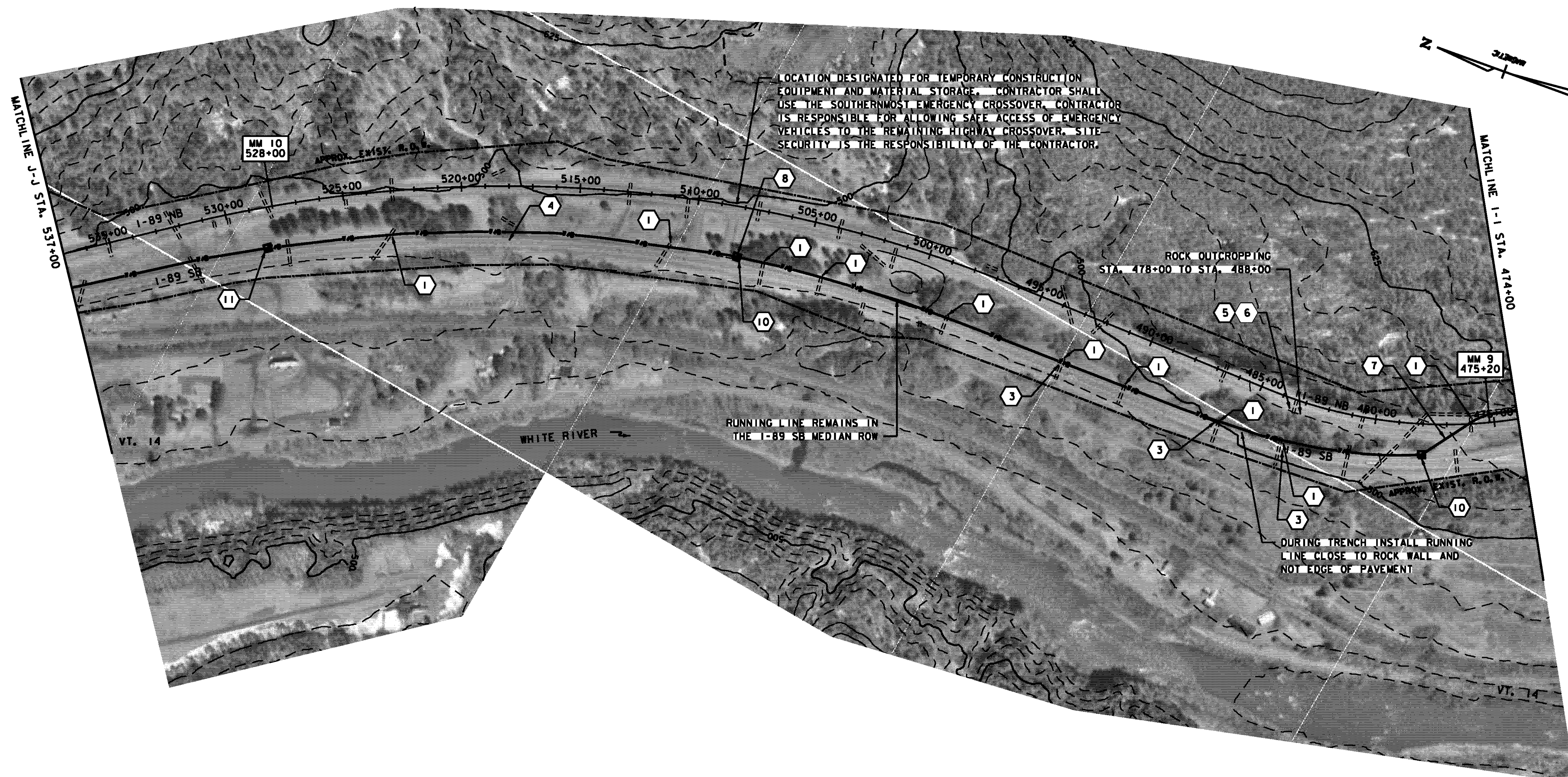

LOCATION DESIGNATED FOR TEMPORARY CONSTRUCTION EQUIPMENT AND MATERIAL STORAGE. CONTRACTOR SHALL USE THE SOUTHERNMOST EMERGENCY CROSSOVER. CONTRACTOR IS RESPONSIBLE FOR ALLOWING SAFE ACCESS OF EMERGENCY VEHICLES TO THE REMAINING HIGHWAY CROSSOVER. SITE SECURITY IS THE RESPONSIBILITY OF THE CONTRACTOR.

ROCK OUTCROPPING STA. 478+00 TO STA. 488+00

RUNNING LINE REMAINS IN THE I-89 SB MEDIAN ROW

DURING TRENCH INSTALL RUNNING LINE CLOSE TO ROCK WALL AND NOT EDGE OF PAVEMENT

**LEGEND**

	PROPOSED HANDHOLE		CONSTRUCTION NOTE
	PROPOSED SPLICE VAULT		ACTION ITEM
	PROPOSED COMMUNICATION CONDUIT		EXISTING MANHOLE
	EXISTING LIMIT OF WETLAND		

**LAYOUT PLAN**  
 SCALE 1" = 200'-0"  
 200 0 200

**TABULATION OF CONSTRUCTION METHODOLOGY**

CAT TRACTOR PLOW:	2620'
SPIDER PLOW:	1973'
TRENCH AND PLACE DUCT OR CONDUIT AS NOTED ON PLAN DRAWINGS:	1170'
DIRECTIONAL BORE - 8" BSP CASING:	373'
HANDHOLES - 2 AT EACH LOCATION:	3
DIG TEST HOLES - LOCATE FOREIGN STRUCTURES:	10
BRIDGE ATTACHMENT:	0
INSTALL CABLE MARKERS:	10
PULL FIBER OPTIC CABLE INTO DUCT:	6605'
SPLICE VAULT & HANDHOLE SETUP:	0

PROJECT NAME:	HARTFORD SHARON	FILE NAME:	z06e142LA10.dgn	PLOT DATE:	9/15/2010
PROJECT NUMBER:	FITS503	PROJECT LEADER:	J. YOUNG	DRAWN BY:	S. GUNN
		DESIGNED BY:	J. DURANTE	CHECKED BY:	J. YOUNG
		LAYOUT PLAN (SHEET 10 OF 14)		SHEET 20	OF 70