

CAT PLOW      HH#27      CAT PLOW      TRENCH      CAT PLOW      BRIDGE ATTACHMENT      TRENCH      CAT PLOW  
 400+65      378+25      374+10      364+92      353+35      349+28

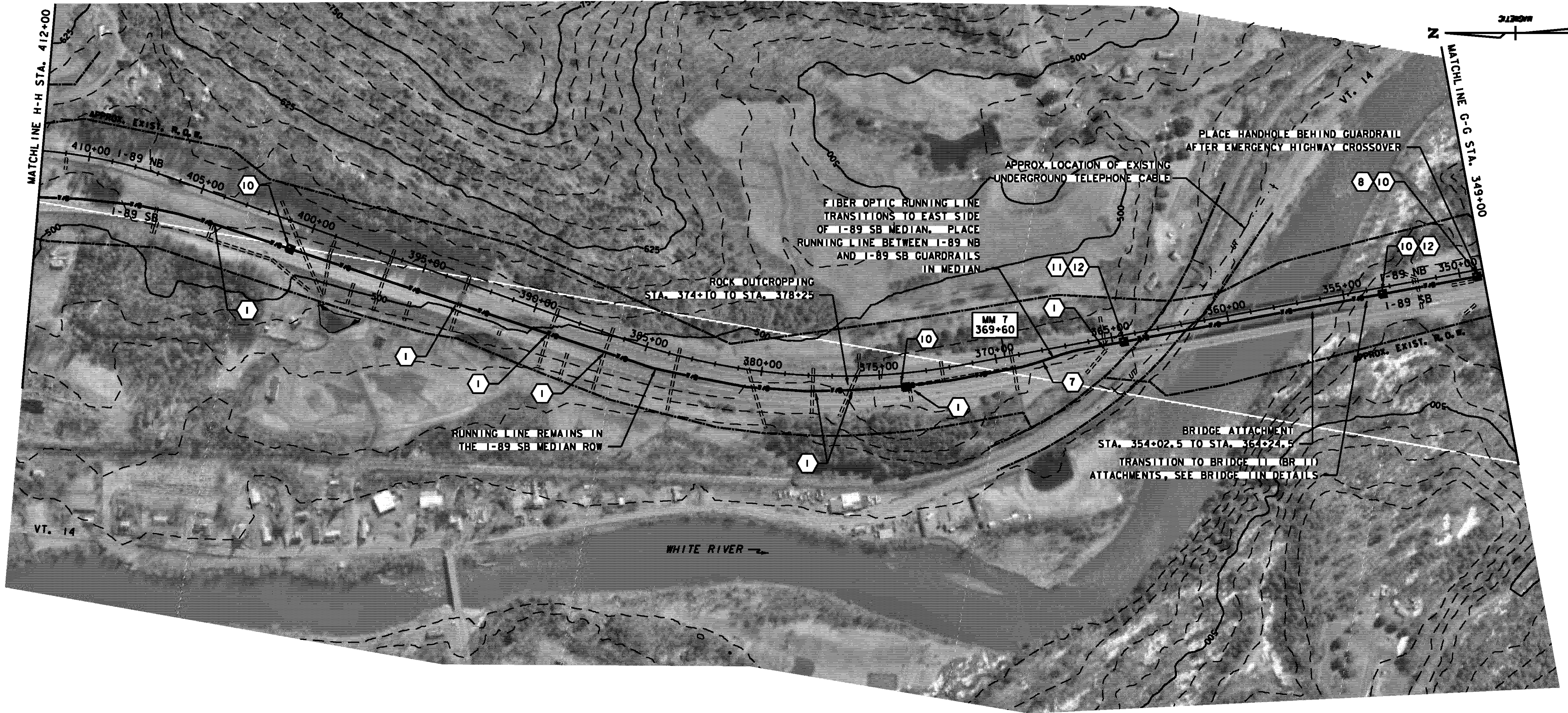

**LEGEND**

|  |                                |  |                   |
|--|--------------------------------|--|-------------------|
|  | PROPOSED HANDHOLE              |  | CONSTRUCTION NOTE |
|  | PROPOSED SPLICE VAULT          |  | ACTION ITEM       |
|  | PROPOSED COMMUNICATION CONDUIT |  | EXISTING MANHOLE  |
|  | EXISTING LIMIT OF WETLAND      |  |                   |

**LAYOUT PLAN**  
 SCALE 1" = 200'-0"  
 200 0 200

**TABULATION OF CONSTRUCTION METHODOLOGY**

|   |       |
|---|-------|
| CAT TRACTOR PLOW:   | 4184' |
| SPIDER PLOW:  | 0     |
| TRENCH AND PLACE DUCT OR CONDUIT AS NOTED ON PLAN DRAWINGS: | 740'  |
| DIRECTIONAL BORE - 8" BSP CASING:                           | 0     |
| HANDHOLES - 2 AT EACH LOCATION:                             | 5     |
| DIG TEST HOLES - LOCATE FOREIGN STRUCTURES:                 | 8     |
| BRIDGE ATTACHMENT:  | 1102' |
| INSTALL CABLE MARKERS:                                      | 11    |
| PULL FIBER OPTIC CABLE INTO DUCT:                           | 6560' |
| SPLICE VAULT & HANDHOLE SETUP:                              | 0     |

|                 |                 |                             |                |             |           |
|-----------------|-----------------|-----------------------------|----------------|-------------|-----------|
| PROJECT NAME:   | HARTFORD SHARON | FILE NAME:                  | z06e142LA8.dgn | PLOT DATE:  | 9/15/2010 |
| PROJECT NUMBER: | FITS503         | DESIGNED BY:                | J. DURANTE     | DRAWN BY:   | S. GUNN   |
|                 |                 | LAYOUT PLAN (SHEET 8 OF 14) |                | CHECKED BY: | J. YOUNG  |
|                 |                 |                             |                | SHEET 18    | OF 70     |