

GENERAL NOTES

1. ALL WORK AND MATERIALS SHALL CONFORM TO THE STATE OF VERMONT, DEPARTMENT OF HIGHWAYS, STANDARD SPECIFICATIONS FOR HIGHWAY AND BRIDGE CONSTRUCTION DATED APRIL 1964, AND THE A.A.S.H.O. SPECIFICATIONS DATED 1969, DESIGNED FOR HS 20-44 LOADING.
2. ALL REINFORCING STEEL SHALL BE DETAILED ON THE REINFORCING STEEL SCHEDULE. ALL SPLICES SHALL BE A MINIMUM OF 40 BAR DIAMETERS.
3. FOR CURTAIN WALL AND APPROACH SLAB BRACKET DETAILS SEE SCB-D2-67
4. Bituminous Concrete Pavement depth shall be 2" at the bridge end and vary to 3" at the roadway end.
5. See Standard SCB-D9-71 @ for fixed end joint details.

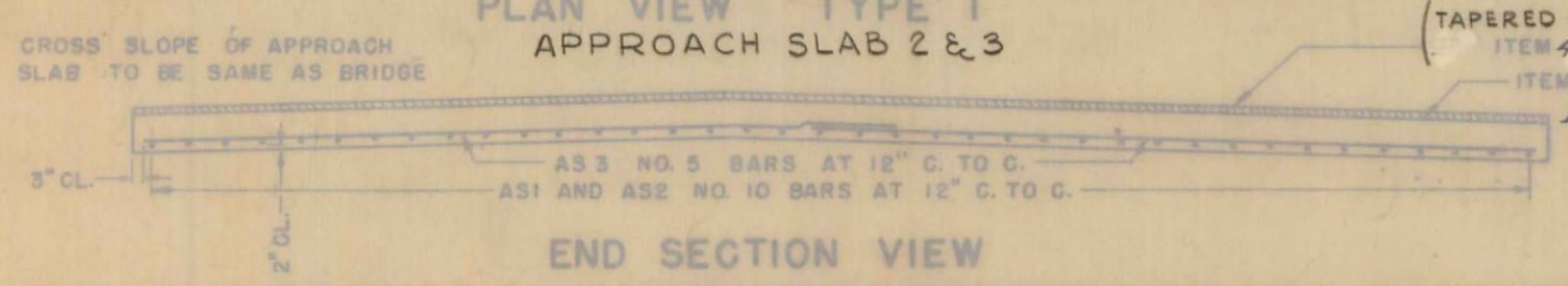

LYNDON-IRASBURG
IM MEMB(29)
SHEET 28 OF 55
BRIDGE NO. 965
FOR REFERENCE ONLY

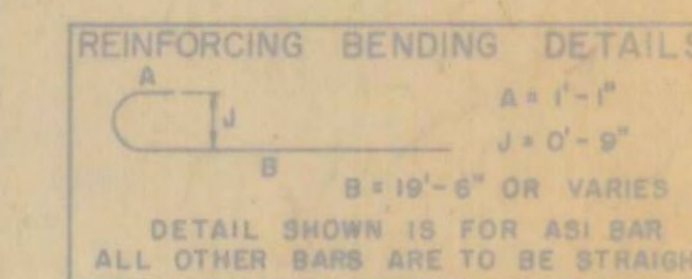

LIST OF QUANTITIES

ITEM NO.	ITEM	UNIT
516	TAR EMULSION FOR BRIDGE FLOORS	GAL.
501	BITUMINOUS CONCRETE PAVEMENT MODIFIED	TONS
372-A	JOINT SEALER - HOT Poured	L.F.
372-C	JOINT SEALER - PREFORMED, TYPE A	L.F.
401-B	CONCRETE CLASS B	CY.
402	REINFORCING STEEL	LB.

Stage 2 Construction
CONTRACT 1
STAGE 1 CONSTRUCTION

REVISIONS AND CORRECTIONS

1. DIMENSIONS OF JOINT FOR SEALER TYPE A REVISED 4/15/65 W.B.T.
2. DIMENSIONS OF JOINT SEALER TYPE B REVISED 6/23/65 W.B.T.
3. JOINT BETWEEN CURB AND SLAB REVISED, BITUMINOUS CONCRETE REVISED TO 2" QUANTITY TOTALS REMOVED. 12/7/65. W.B.T.

DRAWN BY: W.B.T. Jan 1965
TRADED BY: W.B.T. Jan 1965
CHECKED BY: W.M.S. Feb 1965

RECOMMENDED FOR APPROVAL: [Signature] 2/4/65
BRIDGE ENGINEER DATE

RECOMMENDED FOR APPROVAL: [Signature] 2/16/65
ASSISTANT CHIEF ENGINEER DATE

APPROVED BY: [Signature] 2/16/65
CHIEF ENGINEER DATE

DETAILS OF APPROACH SLAB
FOR 39.33' FOOT BRIDGE
(WIDTH)

TO BE USED FOR BRIDGE AT STATION 1287+0
LOCATION I 91 Over Vt. Rte. #122 And Miller Run Relocated

REVISED - B-70 - CRO f AGG.
MADE CURBS 2:0, HELD FASCIA

STATE OF VERMONT
DEPARTMENT OF HIGHWAYS
STANDARD STRUCTURE
SB-AS-65

PROJECT LYNDON - BARTON
TOWN OF LYNDON
ROUTE NO. 1-91 STA. 1287
1-91 OVER VT. 122 & RELOC. MILLER RUN
APPROACH SLAB # 2 8' 3"

NOT TO SCALE
IN CHARGE H.C. MARGOLIS
DESIGNED BY F. McELROY CHECKED BY J. HENRY
PROJECT NO. 1-91-3101 (18)
SHEET 190 OF 333
374 369 BR 221