

- GENERAL NOTES
1. ALL WORK AND MATERIALS SHALL CONFORM TO THE STATE OF VERMONT, DEPARTMENT OF HIGHWAYS, STANDARD SPECIFICATIONS FOR HIGHWAY AND BRIDGE CONSTRUCTION DATED APRIL 1964, AND THE A.S.H.O. SPECIFICATIONS DATED 1969 DESIGNED FOR HS 20-44 LOADING.
  2. ALL REINFORCING STEEL SHALL BE DETAILED ON THE REINFORCING STEEL SCHEDULE. ALL SPLICES SHALL BE A MINIMUM OF 40 BAR DIAMETERS.
  3. FOR CURTAIN WALL AND APPROACH BRACKET DETAILS SEE SCB-D2-67
  4. Bituminous Concrete Pavement depth shall be 2" at the bridge end and vary to 3" at the roadway end.
  5. See standard SCB-D9-71 for fixed end joint details.

LYNDON-IRASBURG  
IM MEMB(29)  
SHEET 27 OF 55  
BRIDGE NO. 96S  
FOR REFERENCE ONLY

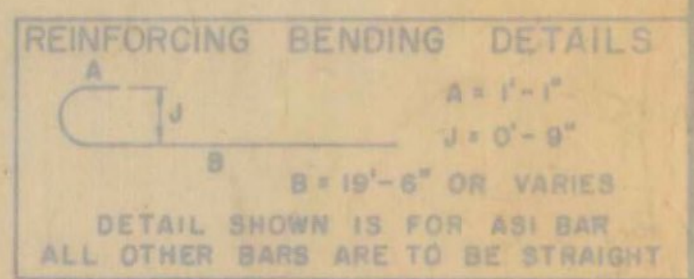

LIST OF QUANTITIES

ITEM NO.	ITEM	UNIT
318	TAR EMULSION FOR BRIDGE FLOORS	SAL.
301	BITUMINOUS CONCRETE PAVEMENT MODIFIED	CY.
372-A	JOINT SEALER - PREFORMED, TYPE A	L.F.
401-B	CONCRETE CLASS B	CY.
402	REINFORCING STEEL	LB.

Stage 2 Construction  
CONTRACT I  
STAGE I CONSTRUCTION

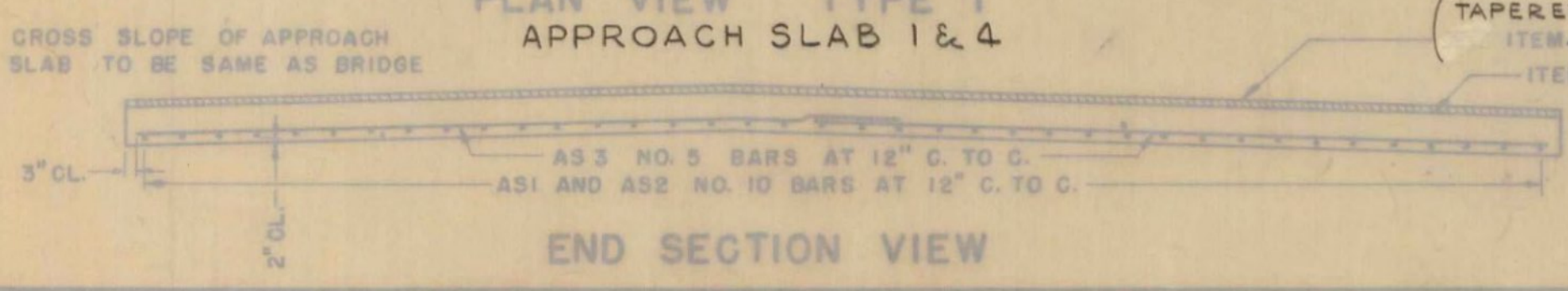

DETAILS OF APPROACH SLAB  
FOR 39.33' FOOT BRIDGE  
TO BE USED FOR BRIDGE AT STATION 1287+0  
LOCATION I 91 Over Vt. Rte. 122 And Miller Run Relocated

STATE OF VERMONT  
DEPARTMENT OF HIGHWAYS  
STANDARD STRUCTURE  
SB-AS-65

PROJECT LYNDON-BARTON  
TOWN OF LYNDON  
ROUTE NO. 1-91 STA. 1287  
1-91 OVER VT. 122 & RELOC. MILLER RUN  
APPROACH SLAB #1 & #4  
NOT TO SCALE  
IN CHARGE H.C. MARGOLIS  
DESIGNED BY F. McELROY CHECKED BY J. HENRY  
PROJECT NO. 1-91-3101(15)  
SHEET 189 OF 250 BR 220  
573 389

REVISIONS AND CORRECTIONS  
1. DIMENSIONS OF JOINT FOR SEALER TYPE A REVISED. 4/15/60 W.B.T.  
2. DIMENSIONS OF JOINT SEALER TYPE B REVISED 6/23/65 W.B.T.  
3. JOINT BETWEEN CURB AND SLAB REVISED, BITUMINOUS CONCRETE REVISED TO 2" QUANTITY TOTALS REMOVED. 12/7/65 W.B.T.

DRAWN BY: W.B.T. Jan 1965  
TRACED BY: W.B.T. Jan 1965  
CHECKED BY: W.M.S. Feb 1965  
RECOMMENDED FOR APPROVAL: [Signature] 2/16/65  
RECOMMENDED FOR APPROVAL: [Signature] 2/16/65  
APPROVED BY: [Signature] 2/16/65

REVISED - 8-70 - CRA & AGC  
MADE CURBS 2'-0", HELD FASCIA