

CURVE #3 I-91 SB
 DELTA = 23° 18' 53" LT
 D = 2° 01' 34"
 R = 2827.79'
 T = 583.41'
 L = 1150.68'
 E = 59.56'
 BANK = EXISTING

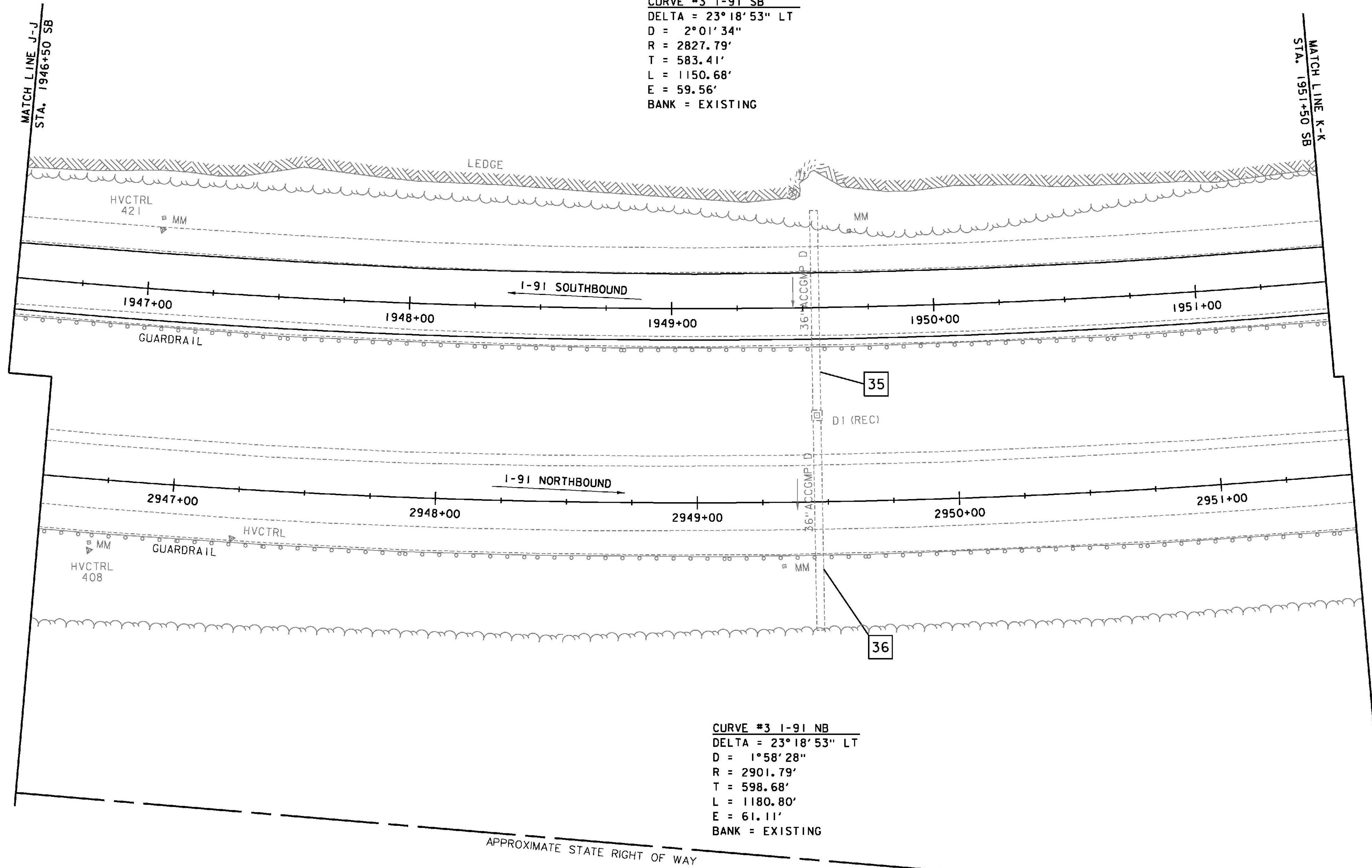

CURVE #3 I-91 NB
 DELTA = 23° 18' 53" LT
 D = 1° 58' 28"
 R = 2901.79'
 T = 598.68'
 L = 1180.80'
 E = 61.11'
 BANK = EXISTING

APPROXIMATE STATE RIGHT OF WAY

DATUM
 VERTICAL NAVD88
 HORIZONTAL NAD 83 (07)

SCALE 1" = 20'-0"
 20 0 20

PROJECT NAME: WINDSOR	PLOT DATE: 7/30/2015
PROJECT NUMBER: IM 091-1(64)	DRAWN BY: S. GUNN
FILE NAME: z10o188bdr.dgn	CHECKED BY: T. MORIN
PROJECT LEADER: J. WILSON	SHEET 24 OF 156
DESIGNED BY: H. FULLER	
LAYOUT SHEET 11	