

GUARDRAIL APPROACH SECTION TO CONCRETE BRIDGE RAILING, TL-3
 1-91 SB: STA. 1920+18 - STA. 1920+36 LT.
 1-91 SB: STA. 1920+18 - STA. 1920+36 RT.
 1-91 NB: STA. 2920+42 - STA. 2920+60 LT.
 1-91 NB: STA. 2920+42 - STA. 2920+60 RT.
 1-91 SB: STA. 1927+48 - STA. 1927+66 LT.
 1-91 SB: STA. 1927+48 - STA. 1927+66 RT.
 1-91 NB: STA. 2927+55 - STA. 2927+73 LT.
 1-91 NB: STA. 2927+92 - STA. 2928+10 RT.

BRIDGE RAILING, CONCRETE F-SHAPE
 1-91 SB: STA. 1920+36 - STA. 1927+48 LT.
 1-91 SB: STA. 1920+36 - STA. 1927+48 RT.
 1-91 NB: STA. 2920+60 - STA. 2927+55 LT.
 1-91 NB: STA. 2920+60 - STA. 2927+92 RT.

END BOX WIDEN AND OVERLAY
 STA. 1919+70.00

FULL DEPTH RECONSTRUCTION
 STA. 1919+70.00 TO STA. 1920+38.50

MATCH LINE E-E
 STA. 1919+50 SB

MATCH LINE F-F
 STA. 1925+25 SB

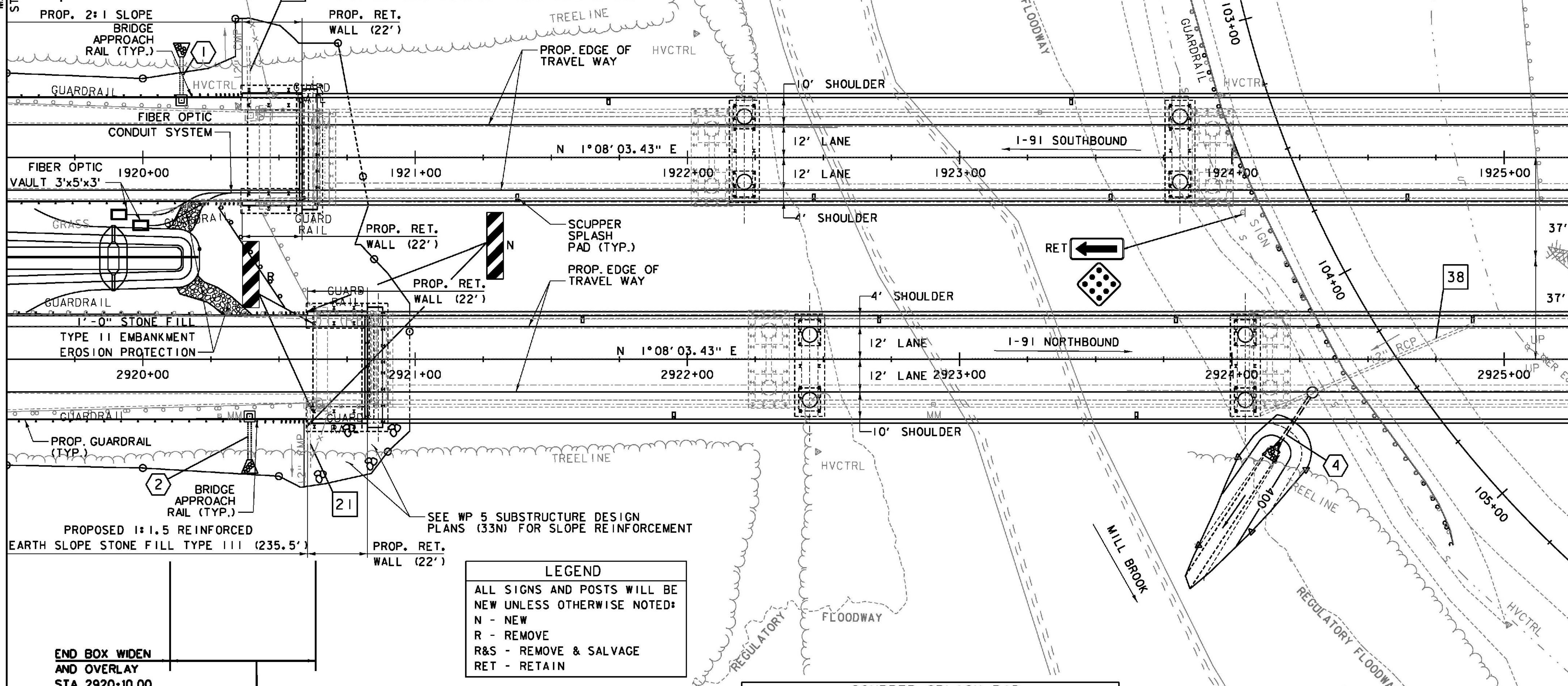

PROPOSED 1:1.5 REINFORCED EARTH SLOPE STONE FILL TYPE III (235.5')

SEE WP 5 SUBSTRUCTURE DESIGN PLANS (33N) FOR SLOPE REINFORCEMENT

LEGEND
 ALL SIGNS AND POSTS WILL BE NEW UNLESS OTHERWISE NOTED:
 N - NEW
 R - REMOVE
 R&S - REMOVE & SALVAGE
 RET - RETAIN

END BOX WIDEN AND OVERLAY
 STA. 2920+10.00

FULL DEPTH RECONSTRUCTION
 STA. 2920+10.00 TO STA. 2920+62.50

FIBER OPTIC VAULT
 1-91 SB: STA. 1919+92 RT.
 1-91 SB: STA. 1920+00 RT.

SCUPPER SPLASH PAD	
SB STA. 1921+71.00 LT.	NB STA. 2921+61.50 LT.
SB STA. 1923+41.00 LT.	NB STA. 2922+70.50 LT.
SB STA. 1925+91.00 LT.	NB STA. 2923+79.50 LT.
SB STA. 1921+37.50 RT.	NB STA. 2924+88.50 LT.
SB STA. 1922+46.50 RT.	NB STA. 2925+97.50 LT.
SB STA. 1923+55.50 RT.	NB STA. 2927+06.50 LT.
SB STA. 1924+64.50 RT.	NB STA. 2921+95.00 RT.
SB STA. 1925+73.50 RT.	NB STA. 2923+65.00 RT.
SB STA. 1926+82.50 RT.	NB STA. 2926+15.00 RT.

DATUM
 VERTICAL NAVD88
 HORIZONTAL NAD 83 (07)

SCALE 1" = 20'-0"
 20 0 20

PROJECT NAME: WINDSOR
 PROJECT NUMBER: IM 091-1(64)
 FILE NAME: z10o188bdr.dgn
 PROJECT LEADER: J. WILSON
 DESIGNED BY: H. FULLER
 LAYOUT SHEET 6

PLOT DATE: 7/30/2015
 DRAWN BY: S. GUNN
 CHECKED BY: T. MORIN
 SHEET 19 OF 156