

TR 15125 CURVE DATA
 $\Delta = 48.52.02$ RT.
 $D = 6.00$
 $R = 954.93$
 $T = 489.9$
 $L = 814.5$
 $E = 93.9$
 $BNK = 0.063$ FT/FT

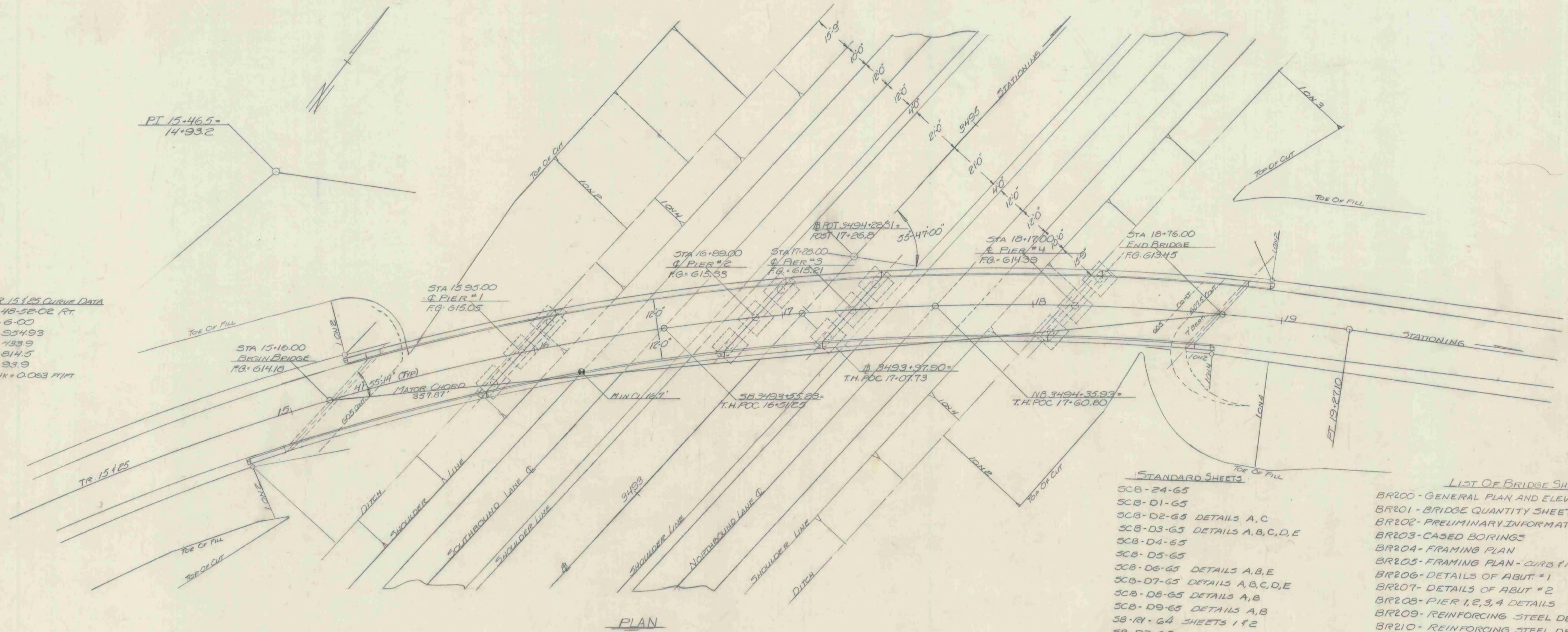

PLAN

- STANDARD SHEETS**
- SCB-24-65
 - SCB-01-65
 - SCB-D2-65 DETAILS A,C
 - SCB-D3-65 DETAILS A,B,C,D,E
 - SCB-D4-65
 - SCB-D5-65
 - SCB-D6-65 DETAILS A,B,E
 - SCB-D7-65 DETAILS A,B,C,D,E
 - SCB-D8-65 DETAILS A,B
 - SCB-D9-65 DETAILS A,B
 - SB-R1-64 SHEETS 1 & 2
 - SB-R2-65

- LIST OF BRIDGE SHEETS**
- BR200 - GENERAL PLAN AND ELEVATION
 - BR201 - BRIDGE QUANTITY SHEET
 - BR202 - PRELIMINARY INFORMATION SHEET
 - BR203 - CASED BORINGS
 - BR204 - FRAMING PLAN
 - BR205 - FRAMING PLAN - CURB & RAILING LENGTHS
 - BR206 - DETAILS OF ABUT. #1
 - BR207 - DETAILS OF ABUT. #2
 - BR208 - PIER 1, 2, 3, 4 DETAILS
 - BR209 - REINFORCING STEEL DETAILS
 - BR210 - REINFORCING STEEL DETAILS

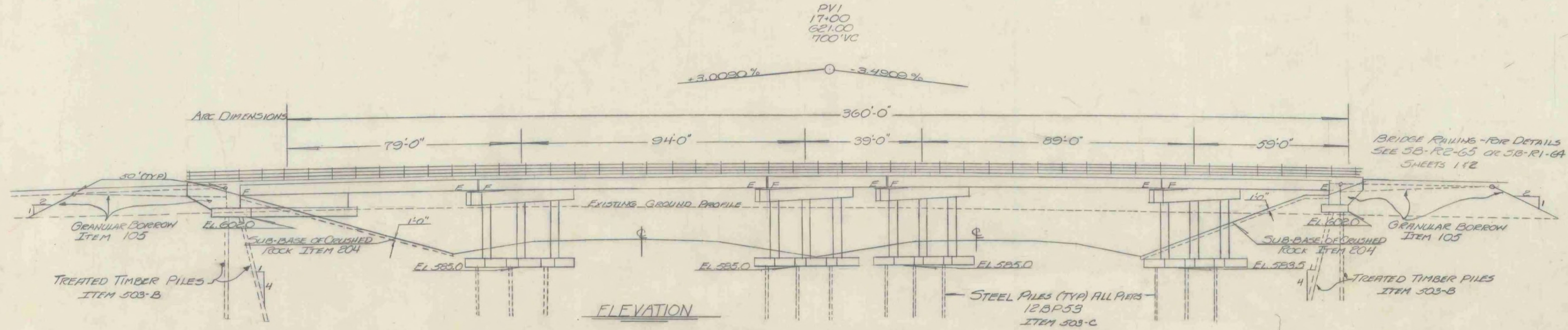

ELEVATION

RICHMOND-HIGHGATE
 IM BPNT(9)
 SHEET 23 OF 30
 BRIDGE 90
 FOR INFORMATION ONLY

STATE OF VERMONT
 DEPARTMENT OF HIGHWAYS

TOWN OF ST. ALBANS-SWANTON

ROUTE NO. 189 LOG STA. _____

PLAN & ELEVATION

I.H. 25#15 OVER 189

SCALE 1"=20'

SURVEYED BY _____

DRAWN BY GII CHECKED BY SNA

PROJECT NO. 189-3 (42)

SHEET 23 OF 30 (153)

TREATED TIMBER PILING CHANGED TO STEEL PILING (12BPS3) AT ALL PIERS