

CONSTRUCTION APPROACH SIGNING ON I-89, LEFT LANE CLOSED

NOT TO SCALE

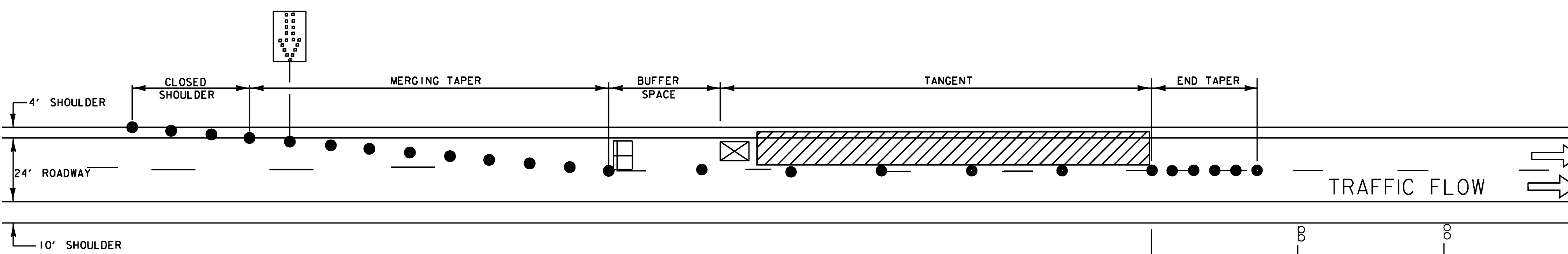

TRAFFIC CONTROL ON I-89, LEFT LANE CLOSED

NOT TO SCALE

LEGEND

- FLASHING ARROW PANEL
- REFLECTORIZED PLASTIC DRUM
- TYPE III BARRICADE
- TRUCK/TRAILER MOUNTED ATTENUATOR (OPTIONAL)
- PORTABLE CHANGEABLE MESSAGE SIGN
- WORK AREA

POSTED SPEED LIMIT	TAPER LENGTHS (FT)		TANGENT W=12 FT (L/2)	MINIMUM BUFFER SPACE LENGTH (FT)	MAXIMUM CHANNELIZING DEVICE SPACING (FT)	
	SHOULDER W=10 FT	MERGING 12 FT LANE			TAPER	TANGENT
≤40	90	320	160	305	40	80
45	150	540	270	360	45	90
50	170	600	300	425	50	100
55	185	660	330	495	55	110
60	200	720	360	570	60	120
65	215	780	390	645	65	130

TAPER RATES ARE DETERMINED USING THE FOLLOWING EQUATIONS:
 $L = WS$ FOR POSTED SPEEDS OF 45 MPH OR GREATER
 $L = WS^2/60$ FOR POSTED SPEEDS OF 40 MPH OR LESS

L = MINIMUM LENGTH OF TAPER
W = WIDTH OF OFFSET IN FEET
S = POSTED SPEED IN MPH

TRAFFIC CONTROL NOTES 1-89:

1. THE TRAFFIC CONTROL PLAN SHOWN IS A SCHEMATIC ONLY AND SHOULD BE USED AS A REFERENCE. THE CONTRACTOR SHALL SUBMIT A SITE SPECIFIC TRAFFIC CONTROL PLAN FOR BRIDGES 52S, 80, 82, 85, 89, 90, 91, 99 AND 101 TO VTRANS FOR APPROVAL. PAYMENT FOR PREPARING AND SUBMITTING THE TRAFFIC CONTROL PLAN, AND MAKING NECESSARY REVISIONS TO THE PLAN, WILL BE INCLUDED IN THE UNIT PRICE BID FOR CONTRACT ITEM 641.10 - TRAFFIC CONTROL. THE CONTRACTOR SHALL ALLOW TWO WEEKS FOR APPROVAL OF THE TRAFFIC CONTROL PLAN. NO WORK SHALL COMMENCE UNTIL THE CONTRACTOR HAS AN APPROVED TRAFFIC CONTROL PLAN.
2. THE EXISTING SPEED LIMIT FOR I-89 IS 65 MPH. THE SPEED LIMIT WILL BE REDUCED TO 50 MPH IN THE WORK ZONE FOR THIS PROJECT. ANY EXISTING SPEED LIMIT SIGNS WITHIN THE SPEED REDUCTION AREA SHALL BE COMPLETELY COVERED.
3. CONSTRUCTION SIGNS SHALL BE INSTALLED SO AS NOT TO OBSTRUCT EXISTING SIGNS.
4. ALL SIGNS SHALL BE IN ACCORDANCE WITH THE CURRENT EDITIONS OF THE "MANUAL ON UNIFORM TRAFFIC CONTROL DEVICES" (MUTCD) AND THE "STANDARD HIGHWAY SIGNS" BOOK (SHS) PUBLISHED BY THE FEDERAL HIGHWAY ADMINISTRATION (FHWA).
5. ORANGE CONSTRUCTION SIGNS SHALL HAVE RETROREFLECTIVE SHEETING EQUAL TO OR EXCEEDING "AMERICAN SOCIETY FOR TESTING AND MATERIALS" (ASTM) TYPE VII, VIII OR IX REQUIREMENTS, UNLESS OTHERWISE NOTED.
6. ROLL UP SIGNS SHALL HAVE A RETROREFLECTIVE SHEETING EQUAL TO OR EXCEEDING ASTM TYPE VI.
7. SIGNS SHALL BE ERECTED BEFORE THE START OF ANY WORK AND SHALL BE COVERED UNTIL WORK COMMENCES AND DURING PERIODS OF INACTIVITY. EACH SIGN SHALL BE ERECTED IN A NEAT AND WORKMAN LIKE MANNER. SIGNS SHALL BE REMOVED UPON COMPLETION OF THE WORK AT THE DISCRETION OF THE ENGINEER.
8. FIXED SIGNS SHALL BE SET SECURELY IN THE GROUND. THE BOTTOM OF A SIGN SHALL BE AT LEAST SEVEN FEET ABOVE THE EDGE OF PAVEMENT. THE NEAREST EDGE OF A SIGN SHALL BE AT LEAST SIX FEET OUTSIDE THE SHOULDER POINT OR FOUR FEET OUTSIDE THE GUARDRAIL.
9. PORTABLE SIGNS SHALL BE PLACED ON THE EDGE OF ROADWAY AND A ONE FOOT MINIMUM HEIGHT ABOVE TRAVELED WAY. WHEN PLACED BEHIND THE GUARD RAIL, THE BOTTOM OF THE SIGN FACE SHALL BE ABOVE THE TOP OF THE GUARDRAIL. ALL VEGETATION THAT INTERFERES WITH VISIBILITY OF THE SIGNS SHALL BE REMOVED. PAYMENT FOR REMOVAL IS SUBSIDIARY TO THE RELATIVE WORK ITEMS.
10. WHERE SIGN INSTALLATIONS ARE NOT PROTECTED BY GUARDRAIL OR OTHER APPROVED TRAFFIC BARRIERS, ALL SIGN STANDS AND POST INSTALLATIONS SHALL BE "NATIONAL COOPERATIVE HIGHWAY RESEARCH PROGRAM" (NCHRP) REPORT 350 COMPLIANT. NO SIGN POSTS SHALL EXTEND OVER THE TOP OF THE SIGN INSTALLED ON SAID POST(S). WHEN ANCHORS ARE INSTALLED STUB SHALL NOT BE GREATER THAN FOUR INCHES ABOVE EXISTING GROUND.
11. THE CONTRACTOR SHALL HAVE SIGNS FOR CLOSURE OF LEFT AND RIGHT LANES INSTALLED BEFORE WORK COMMENCES.
12. THE NUMBER OF CHANNELIZING DEVICES, TYPE III BARRICADES AND OTHER TRAFFIC CONTROL DEVICES SHOWN ARE FOR ILLUSTRATIVE PURPOSES ONLY. THE ACTUAL NUMBER REQUIRED ARE TO BE DETERMINED BASED ON INDIVIDUAL DETOUR CONDITIONS (TAPERS, SPEED LIMITS, LENGTH OF DETOUR, CURVE ETC.). WARNING LIGHTS SHALL NOT BE USED ON CHANNELIZING DEVICES.
13. PLACE LAST CHANNELIZING DEVICE 100 FEET BEYOND THE ANTICIPATED WORK ZONE TERMINAL POINT EACH DAY AND START THE END TAPER. THE END TAPER SHALL BE CONSTRUCTED OF 5 ADDITIONAL RETROREFLECTIVE DRUMS SPACED AT 10 FEET ON CENTER.
14. THE ARROW BOARD SHALL BE PLACED ON THE SHOULDER OF THE ROADWAY, OR, IF PRACTICAL, FURTHER FROM THE TRAVELED LANE AT THE END OF THE SHOULDER TAPER.
15. THE PORTABLE CHANGEABLE MESSAGE SIGNS (PCMS) SHALL BE USED FOR I-89 LANE CLOSURES AND AT THE DISCRETION OF THE ENGINEER FOR LOCAL STREET LANE CLOSURES.
16. TRAVEL LANE SHALL BE A MINIMUM OF 12 FEET WIDE.
17. AT NO TIME WILL THE CONTRACTOR BE ALLOWED TO HAVE WORKERS' VEHICLES, CONSTRUCTION EQUIPMENT OR STOCKPILED MATERIALS WITHIN THE CLEAR ZONE OF INTERSTATE 89 OR THE LOCAL ROADWAYS WITHOUT POSITIVE PROTECTION. POSITIVE PROTECTION SHALL BE AS DIRECTED BY THE ENGINEER. THE CLEAR ZONES FOR INTERSTATE 89 ARE DEFINED AS FOLLOWS:
INTERSTATE 89 - 34 FEET FROM THE TRAVELED WAY
LOCAL ROADWAYS - 16 FEET FROM THE TRAVELED WAY

TRAFFIC CONTROL SHEET (1)

PROJECT NAME: RICHMOND - HIGHGATE	PLOT DATE: 24-JAN-2012
PROJECT NUMBER: IM BPNT (9)	DRAWN BY: W.GERHOLD
FILE NAME: I0a180/str/z10a180tc.dgn	CHECKED BY: R.BENJAMIN
PROJECT LEADER: G.K.DONINGTON	SHEET 7 OF 30
DESIGNED BY: C.CARNEY	
tc.l.dgn	

