

CONSTRUCTION APPROACH SIGNING SHEET

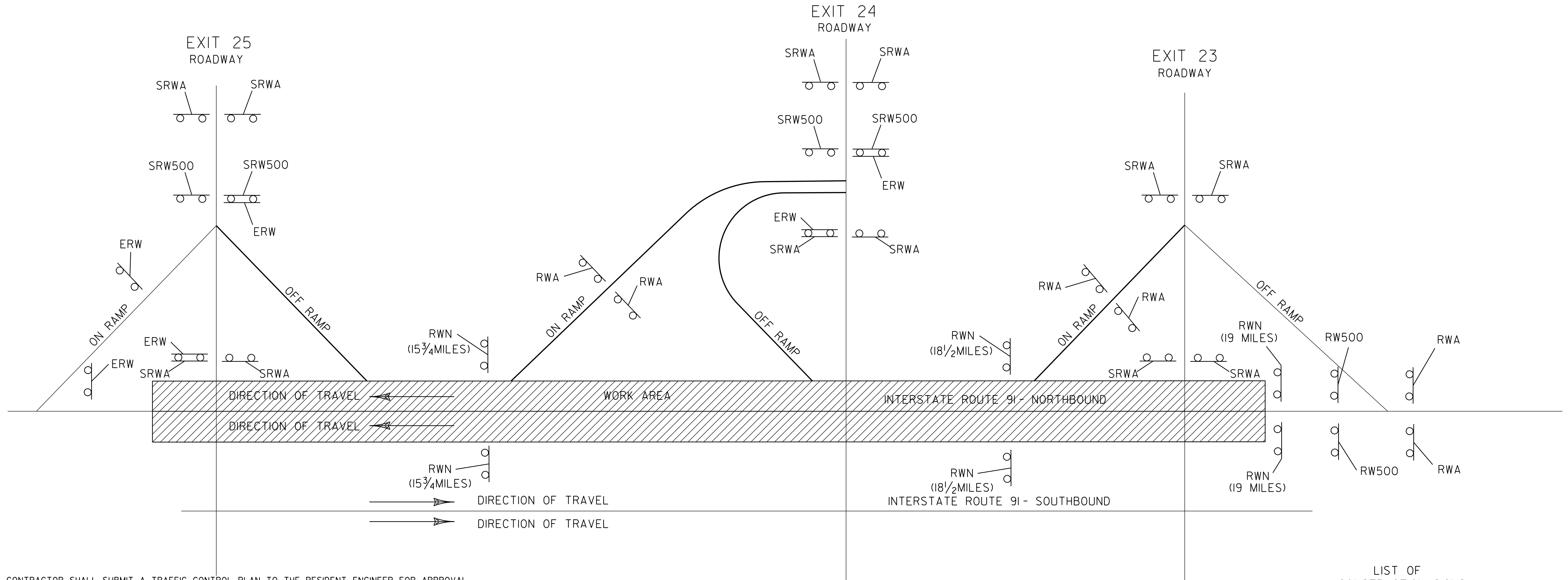

LIST OF CONSTRUCTION SIGNS

LOCATION	RWA	RW500	ERW	RWN	SRWA	SRW500
I-91 NORTHBOUND						
BEGIN PROJECT	2	2		2		
EXIT 23 INTERCHANGE	2			2	4	
EXIT 24 INTERCHANGE	2		2	2	4	2
EXIT 25 INTERCHANGE			3		4	2
END PROJECT			1			
TOTALS	6	2	6	6	12	4

CONSTRUCTION APPROACH SIGNING

SEE STD. E-103 FOR SIGN PLACEMENT

LEGEND

- RWA = ROAD WORK AHEAD
- RW500 = ROAD WORK 500 FEET
- RWN = ROAD WORK NEXT () MILES
- SRWA = SIDE ROAD WORK AHEAD
- ERW = END ROAD WORK
- SRW500 = SIDE ROAD WORK 500 FEET

1. THE CONTRACTOR SHALL SUBMIT A TRAFFIC CONTROL PLAN TO THE RESIDENT ENGINEER FOR APPROVAL PRIOR TO THE START OF CONSTRUCTION. THE COST OF PREPARING THIS PLAN (AND MAKING CHANGES IF NECESSARY) SHALL NOT BE PAID SEPARATELY BUT WILL BE INCLUDED IN THE UNIT BID PRICE FOR ITEM 641.10, "TRAFFIC CONTROL".

2. THE CONTRACTOR SHALL INCLUDE A CONSTRUCTION SIGN APPROACH PACKAGE FOR EXPECTED LANE CLOSURES AND WORK ZONE SPEED REDUCTIONS IN COMPLIANCE WITH VTRANS STANDARD E-103. PAYMENT FOR PROVIDING THIS PACKAGE SHALL BE INCIDENTAL TO ITEM 641.10, "TRAFFIC CONTROL". ADD G20-50P "WORK ZONE" PLAQUE TO SPEED LIMIT SIGNS (SEE FIG. 6F-3 OF MUTCD).

3. ADDITIONAL RAMP SIGNING MAY BE REQUIRED AS DIRECTED BY THE RESIDENT ENGINEER.

4. THE BID PRICE FOR "TRAFFIC CONTROL", ITEM 641.10, SHALL INCLUDE ALL APPROACH AND ON-PROJECT CONSTRUCTION SIGNING, PORTABLE ARROW BOARDS, BARRIERS, BARRELS, CONES, BARRICADES, TEMPORARY REGULATORY AND WARNING SIGNS, AND POSTS AS DETAILED IN VTRANS STANDARDS. ALL ADJUSTING, RELOCATING, AND REMOVING OF THESE DEVICES AS DIRECTED BY THE RESIDENT ENGINEER SHALL ALSO BE INCLUDED. THE FOLLOWING ITEMS WILL BE PAID FOR SEPARATELY:

- 630.10 AND 630.15 - UNIFORMED TRAFFIC OFFICERS AND FLAGGERS
- 646.622 TEMPORARY 6 INCH WHITE LINE, PAINT
- 646.632 TEMPORARY 6 INCH YELLOW LINE, PAINT
- 646.662 TEMPORARY 12 INCH WHITE LINE, PAINT
- 646.682 TEMPORARY 24 INCH STOP BAR, PAINT
- 646.692 TEMPORARY LETTER OR SYMBOL, PAINT
- 646.76 LINE STRIPING TARGETS

5. PORTABLE CHANGEABLE MESSAGE SIGNS (PCMS) SHALL BE PROVIDED FOR USE ALONG THIS PROJECT. THE PLACEMENT OF THESE UNITS AS WELL AS THE MESSAGE WILL BE APPROVED BY THE RESIDENT ENGINEER. THESE SIGNS WILL BE PAID FOR UNDER ITEM 641.15, "PORTABLE CHANGEABLE MESSAGE SIGN".

PCMS SHOULD NOT REPLACE ANY OF THE SIGNING DETAILED IN THE MUTCD AND SHOULD NOT BE USED IF STANDARD TRAFFIC CONTROL DEVICES ADEQUATELY PROVIDE THE INFORMATION THE MOTORISTS NEED TO TRAVEL SAFELY.

THE PCMS SHALL CONSIST OF EITHER ONE OR TWO PHASES. TYPICALLY, A PHASE SHALL CONSIST OF UP TO THREE LINES OF EIGHT CHARACTERS PER LINE. THE PCMS SHOULD BE USED AS A SUPPLEMENT AND NOT AS A SUBSTITUTE FOR CONVENTIONAL SIGNS AND PAVEMENT MARKINGS.

THE PCMS SHOULD COMMUNICATE WHAT INFORMATION MOTORISTS NEED TO KNOW. UNNECESSARY INFORMATION SHOULD BE AVOIDED. MESSAGES SHOULD BE UPDATED PERIODICALLY TO DESCRIBE THE WORK ACTIVITY OCCURRING SO THAT THE PCMS CONTINUES TO COMMAND THE ATTENTION OF MOTORISTS.

6. THE 2009 MUTCD SHALL BE THE STANDARD FOR ALL TRAFFIC CONTROL DEVICES. EXISTING SIGNS, SIGNALS AND MARKINGS SHALL BE VALID UNTIL SUCH TIME AS THEY ARE REPLACED OR RECONSTRUCTED. WHEN NEW TRAFFIC CONTROL DEVICES ARE ERECTED OR PLACED OR EXISTING TRAFFIC CONTROL DEVICES ARE REPLACED OR REPAIRED THE EQUIPMENT, DESIGN, METHOD OF INSTALLATION, PLACEMENT OR REPAIR SHALL CONFORM WITH THE MUTCD.

7. NO CONSTRUCTION SIGNS SHALL BE INSTALLED AS TO INTERFERE OR OBSTRUCT THE VIEW OF EXISTING TRAFFIC CONTROL DEVICES, STOPPING SIGHT DISTANCE, AND CORNER SIGHT DISTANCE FROM DRIVES AND INTERSECTING HIGHWAYS.

8. REFER TO VT. STATE STANDARDS, THE SPECIAL PROVISIONS AND THE MUTCD FOR TEMPORARY TRAFFIC CONTROL SIGN DIMENSIONS AND COLORS.

9. ON VTRANS STANDARD E-103, SIGN W4-2 MAY BE REPLACED WITH W9-2:

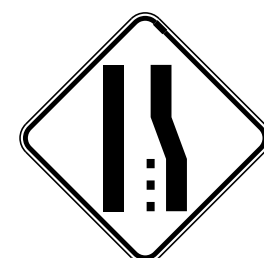

W4-2



W9-2



NOT TO SCALE

PROJECT:	LYNDON - BARTON	PROJECT NO.:	IM SURF(25)
DESIGN FILE NAME:	pl0al20.dgn	PLOT DATE:	11-JUN-2012 11:45
IPARM FILE NAME:	pl0al20casl.i	SURVEY DATE:	N/A
SURVEYED BY:	N/A	DRAWN BY:	LOCKE
SQUAD LEADER:	M. FOWLER	SHEET:	16 OF 18