

INDEX OF SHEETS

- 1. TITLE SHEET
- 2-3. QUANTITY SHEETS
- 4. GENERAL NOTES
- 5-11. TRAFFIC CONTROL
- 12. FRAMING PLAN
- 13. TYPICAL BRIDGE SECTION 8x4x115
- 14. DECK REINFORCING PLAN
- 15. DECK POURING SEQUENCE
- 16. SPLICE DETAILS
- 17. STRUCTURAL STEEL DETAILS
- 18. BEARING DETAILS
- 19. PIER 5 DETAILS
- 20. EXPANSION JOINT @ PIER 0
- 21. EXPANSION JOINT @ PIER 10
- 22. HOPPER & DOWNSPOUT DETAILS
- 23. BRIDGE APPROACH RAIL
- 24-25. GUARD RAIL DETAILS
- 26. SCUPPER DETAILS
- 27. REINFORCING STEEL SCHEDULE
- 28-45. REFERENCE PLANS

STATE OF VERMONT AGENCY OF TRANSPORTATION

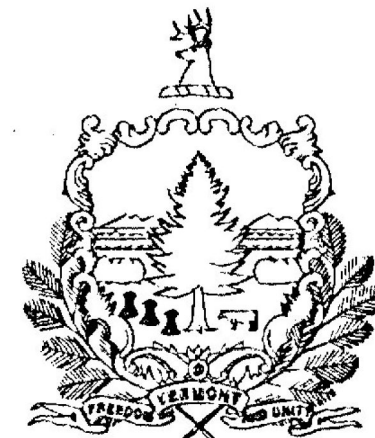

PROPOSED IMPROVEMENT BRIDGE PROJECT CITY OF MONTPELIER COUNTY OF WASHINGTON

RECORD PLANS

CONTRACTOR BECK & BELLUCCI
FRANKLIN, N.H.

RESIDENT ENGINEER ROSS CLARK

CONSTRUCTION BEGAN 3/27/90
CONSTRUCTION COMPLETED 11/12/91

RECORD PLANS BY R.P. Russell

I hereby certify that all the construction required by this set of drawings has been accomplished as indicated herein.

By R.P. Russell Resident Engineer
Date 11-30-94

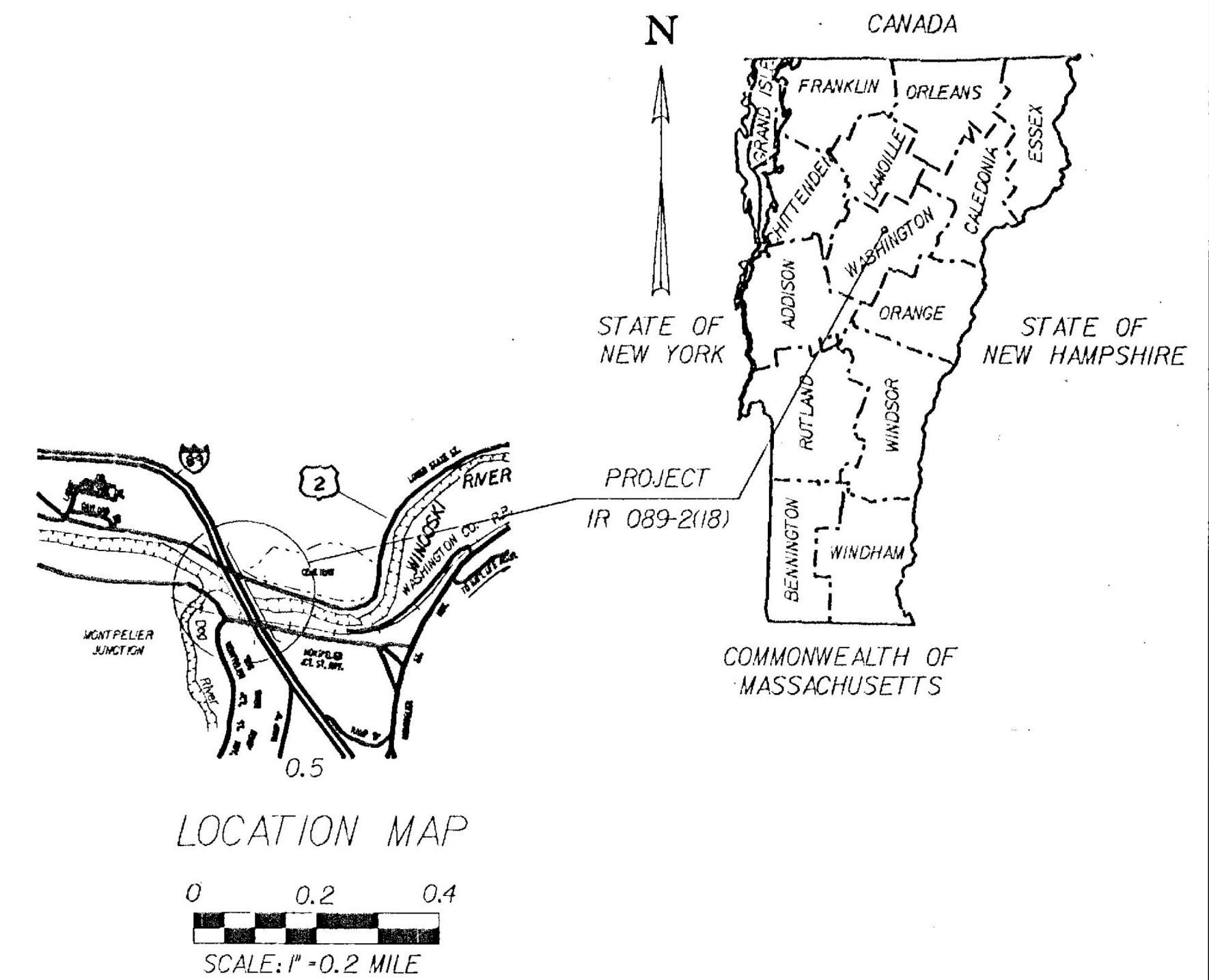

ROUTE NO.: 1-89

BRIDGE NO.: 42 N&S

PROJECT LOCATION: MONTPELIER I-89 OVER THE DOG RIVER ROAD, THE WASHINGTON CO. RAILROAD, THE WINDOSKI RIVER AND U.S. ROUTE 2 BETWEEN MILE MARKERS 53.32 AND 53.54

PROJECT DESCRIPTION: REHABILITATION AND REPAINTING OF BRIDGES 42 NORTH AND 42 SOUTH.

LENGTH OF STRUCTURE W/ APPROACH SLABS:
NB 970.45 FT • 0.184 MILES
SB 1023.25 FT • 0.194 MILES

LENGTH OF PROJECT: 1165.00 FT • 0.221 MILES

LIST OF STANDARDS

- E-100 5-26-89 R
- E-101 10-30-87
- E-102 1-23-89 R
- E-103 1-23-89 R
- E-104 1-23-89 R
- E-104A 1-23-89
- E-106 1-23-89 R
- E-107 4-29-88 R
- E-107A 9-10-87
- E-110 3-1-88 R
- E-120 4-1-88
- E-121 1-23-89
- E-123 1-23-89 R
- E-130 3-1-88 R
- E-131 9-10-87
- E-135 1-23-89 R
- E-140 4-25-88 R
- E-160 3-1-88 R
- E-162 3-1-88 R
- G-1 10-31-85 R
- G-15 4-3-89
- G-18 1-11-88
- E-143 10-30-87
- G-13 1-12-88

NOTE: Any further information concerning final quantities, amounts or other details relative to this project may be found on microfilm in Central Files.

CONVENTIONAL SIGNS

- CONTROL OF ACCESS
- COUNTY LINE
- CULVERT
- FENCE LINE
- GUARD RAIL
- LIMITS OF ACCESS
- POINT OF ACCESS
- POWER POLE
- PROPERTY LINE
- RAILROAD
- R.O.W. TAKING LINE
- SLOPE RIGHTS
- STONE WALL
- SURVEY LINE
- TELEPHONE POLE
- TOE OF SLOPE
- TOP OF CUT
- TOWN LINE
- TRAVELED WAY
- TREES

TRAFFIC DATA

1989 A. D. T.	18060
2009 A. D. T.	29280
1989 D. H. V.	2330
2009 D. H. V.	3780
D	55%
T	7%
DESIGN SPEED • 70 M. P. H.	

LOAD RATING (TONS)

STRESS LEVELS	TRUCK						
	H	HS	352	8 AXLE	3A STR	1A STR	5A SEMI
INVENTORY 0.95 Fy = 28 KSI	39	50	—	—	—	—	—
POSTED 0.67 Fy = 27 KSI	53	69	76	—	57	58	73
OPERATING 0.75 Fy = 24.75 KSI	—	81	92	96	—	—	—

DATUM

HORIZONTAL N/A

VERTICAL ASSUMED. (SEE GENERAL NOTE #12)

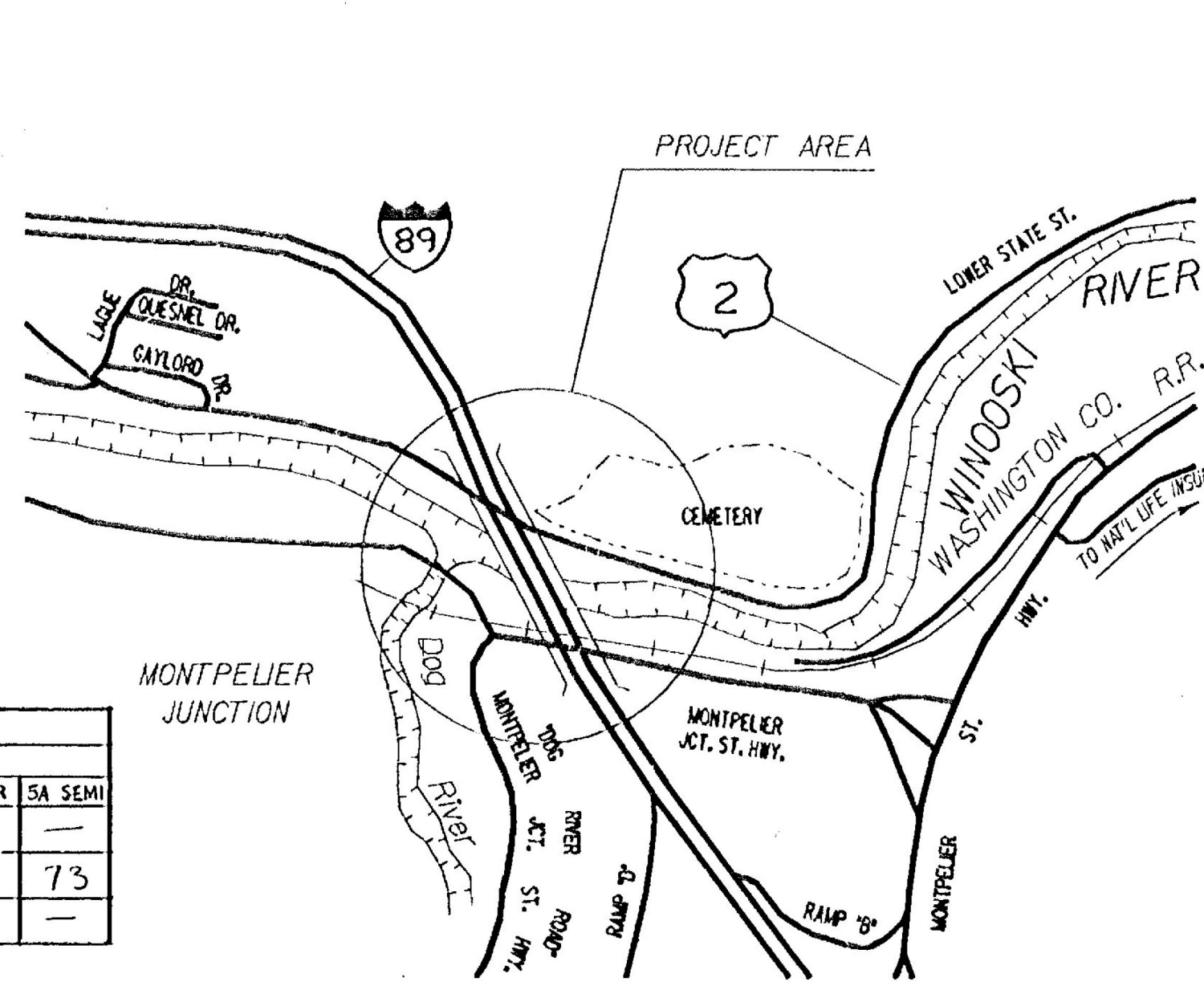

THESE PLANS ARE SUBJECT TO SUCH ENGINEERING CHANGES AS MAY BE REQUIRED BY THE FEDERAL HIGHWAY ADMINISTRATION OR THE VERMONT AOT. CONSTRUCTION IS TO BE CARRIED ON IN ACCORDANCE WITH THESE PLANS AND THE STANDARD SPECIFICATIONS FOR CONSTRUCTION DATED 1986, AS APPROVED BY THE FEDERAL HIGHWAY ADMINISTRATION ON NOVEMBER 21, 1985 FOR USE ON THIS PROJECT, INCLUDING ALL SUBSEQUENT REVISIONS AND SUCH REVISED SPECIFICATIONS AND SPECIAL PROVISIONS AS ARE INCORPORATED IN THESE PLANS.

**MONTPELIER
IM MEMB(23)**

SHEET 51 OF 63
BRIDGE 42N&S
FOR REFERENCE ONLY

SUBMITTED BY ORDER OF THE STATE TRANSPORTATION BOARD

APPROVED Arthur G. Gies DATE 8/1/89
DIRECTOR OF PLANNING

DEPARTMENT OF TRANSPORTATION
FEDERAL HIGHWAY ADMINISTRATION

APPROVED George A. Jovan DATE 9/12/89
DIVISION ADMINISTRATOR

PROJECT - MONTPELIER
PROJECT NUMBER - IR 089-2(18)
SHEET 1 OF 45 SHEETS

BY: J. CLARK ZFAI: [30, 57] 86A003TI.DGN;1