

**INDEX OF SHEETS**  
SEE SHEET 31

# STATE OF VERMONT AGENCY OF TRANSPORTATION

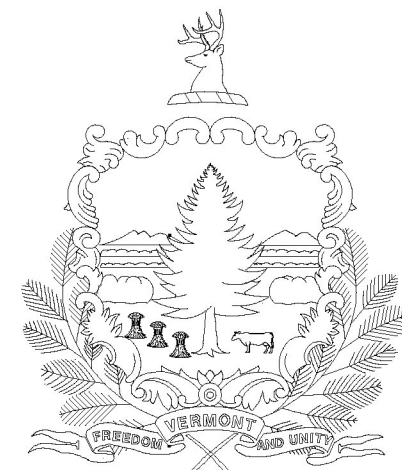

## PROPOSED IMPROVEMENT BRIDGE PROJECT

TOWN OF MONTPELIER  
COUNTY OF WASHINGTON  
BRIDGES NO. 42 NORTH AND 42 SOUTH ON INTERSTATE 89

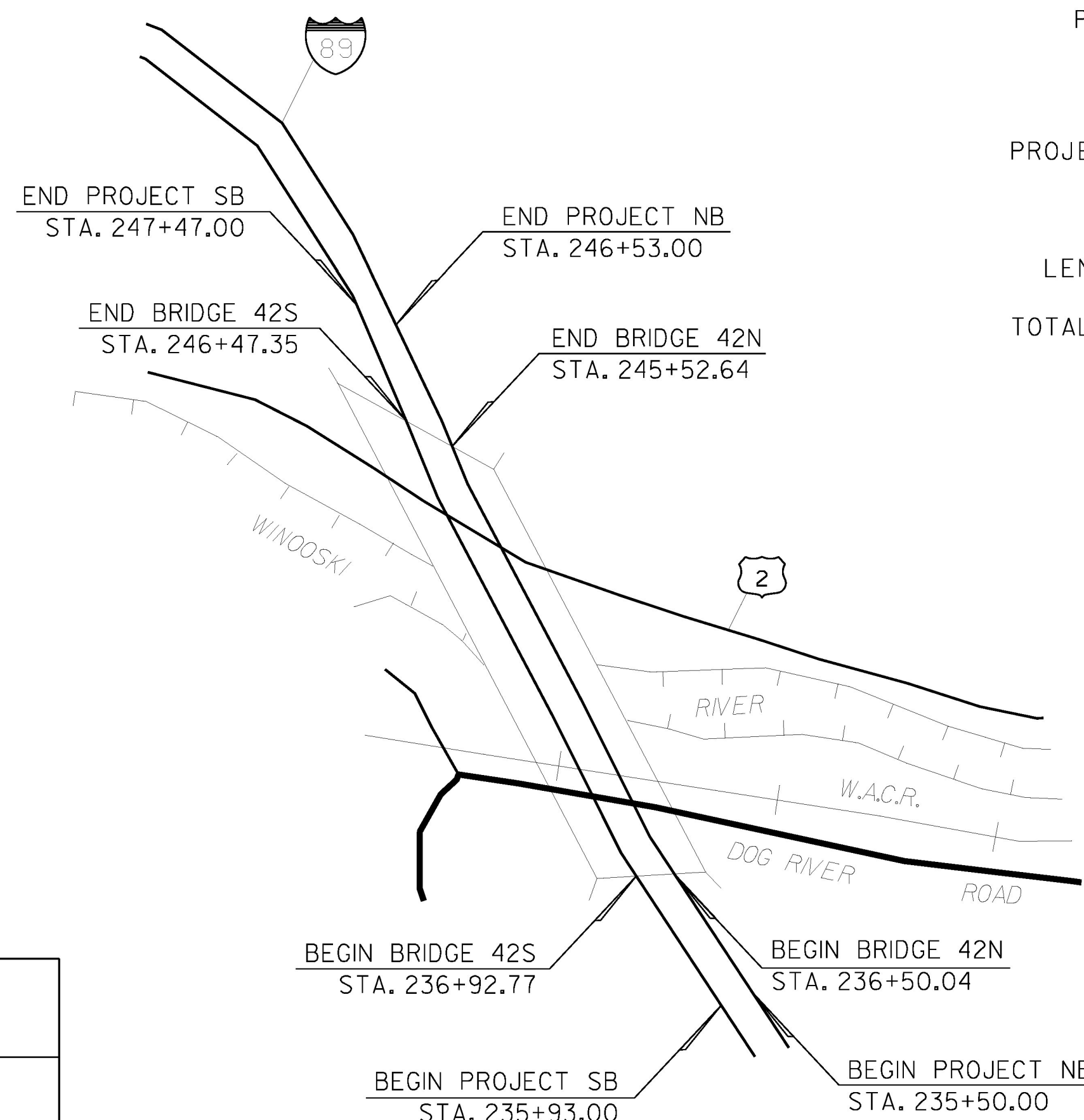
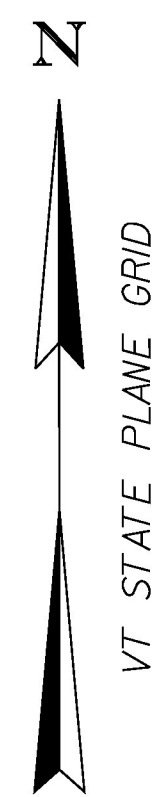
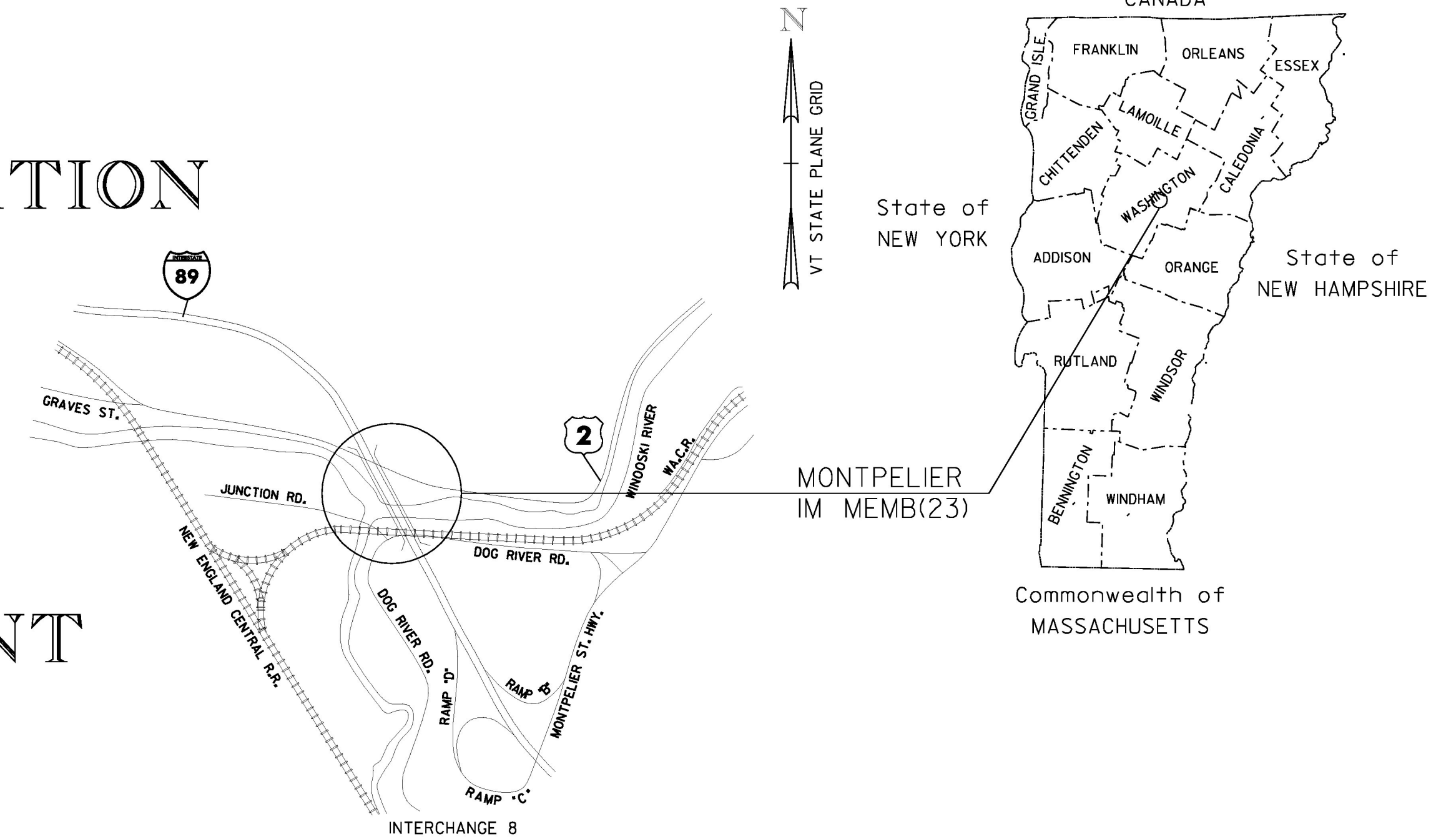

**PROJECT LOCATIONS:** BRIDGES NO. 42N&S ARE LOCATED ON I-89 (MM 53.436) OVER US ROUTE 2, WINOOSKI RIVER, WASHINGTON COUNTY RAILROAD AND DOG RIVER ROAD

**PROJECT DESCRIPTION:** REMOVAL AND REPLACEMENT OF BITUMINOUS CONCRETE WEARING SURFACE AND MEMBRANE ON BRIDGE 42N. REMOVAL AND REPLACEMENT OF BITUMINOUS CONCRETE WEARING SURFACE ON BRIDGE 42S.

**LENGTH OF BRIDGES:** 42N 902 FEET, 42S 955 FEET

**TOTAL LENGTH OF BRIDGES:** 1857 FEET

NOT TO SCALE

**CONVENTIONAL SYMBOLS**

COUNTY LINE	
TOWN LINE	
LIMITS OF ACCESS	
POINT OF ACCESS	
FENCE LINE	
STONE WALL	
TRAVELED WAY	
GUARD RAIL	
RAILROAD	
SURVEY LINE	
CULVERT	
POWER POLE	
TELEPHONE POLE	
TREES	
CONTROL OF ACCESS	
PROPERTY LINE	
R.O.W. TAKING LINE	
SLOPE RIGHTS	
TOP OF CUT	
TOE OF SLOPE	

SURVEYED BY : N/A  
SURVEYED DATE : N/A

DATUM  
VERTICAL N/A  
HORIZONTAL N/A



THESE PLANS ARE SUBJECT TO SUCH ENGINEERING CHANGES AS MAY BE REQUIRED BY THE FEDERAL HIGHWAY ADMINISTRATION OR THE DIRECTOR OF PROGRAM DEVELOPMENT.

CONSTRUCTION IS TO BE CARRIED ON IN ACCORDANCE WITH THESE PLANS AND THE STANDARD SPECIFICATIONS FOR CONSTRUCTION DATED 2006, AS APPROVED BY THE FEDERAL HIGHWAY ADMINISTRATION ON JUNE 15, 2006 FOR USE ON THIS PROJECT, INCLUDING ALL SUBSEQUENT REVISIONS AND SUCH REVISED SPECIFICATIONS AND SPECIAL PROVISIONS AS ARE INCORPORATED IN THESE PLANS.

PROJECT MANAGER : SHERWARD G. FARNSWORTH

PROJECT NAME : MONTPELIER

PROJECT NUMBER : IM MEMB (23)

SHEET 30 OF 63 SHEETS