

INDEX OF SHEETS
SEE SHEET 2

STATE OF VERMONT AGENCY OF TRANSPORTATION



PROPOSED IMPROVEMENT TOWNS OF BERLIN, MONTPELIER, MIDDLESEX AND WATERBURY COUNTY OF WASHINGTON INTERSTATE ROUTE 89 (NB & SB)

BEGINNING IN THE TOWN OF BERLIN AT MILE MARKER 52.600 AND EXTENDING NORTHERLY ALONG INTERSTATE ROUTE 89 (NORTHBOUND) FOR A DISTANCE OF 57,446.40 FT (10.880 MILES) TO MILE MARKER 63.480 IN THE TOWN OF WATERBURY, ALSO BEGINNING IN THE TOWN OF BERLIN AT MILE MARKER 52.620 AND EXTENDING NORTHERLY ALONG INTERSTATE ROUTE 89 (SOUTHBOUND) FOR A DISTANCE OF 57,383.04 FT (10.868 MILES) TO MILE MARKER 63.488 IN THE TOWN OF WATERBURY

LENGTH OF ROADWAY = 57,446.40 FT = (10.880 MILES) (NORTHBOUND LANE)
 LENGTH OF PROJECT = 57,446.40 FT = (10.880 MILES) (NORTHBOUND LANE)
 LENGTH OF ROADWAY = 57,383.04 FT = (10.868 MILES) (SOUTHBOUND LANE)
 LENGTH OF PROJECT = 57,383.04 FT = (10.868 MILES) (SOUTHBOUND LANE)

WORK TO BE PERFORMED UNDER THIS PROJECT INCLUDES SURFACE PREPARATION INVOLVING PATCHING, POTHOLE REPAIR, AND CRACK-SEALING; OVERLAYING WITH A PAVER PLACED SURFACE TREATMENT, OR COLD PLANE & PAVE ON THE EXISTING INTERSTATE TYPICAL, AND APPLICABLE PAVEMENT MARKINGS.

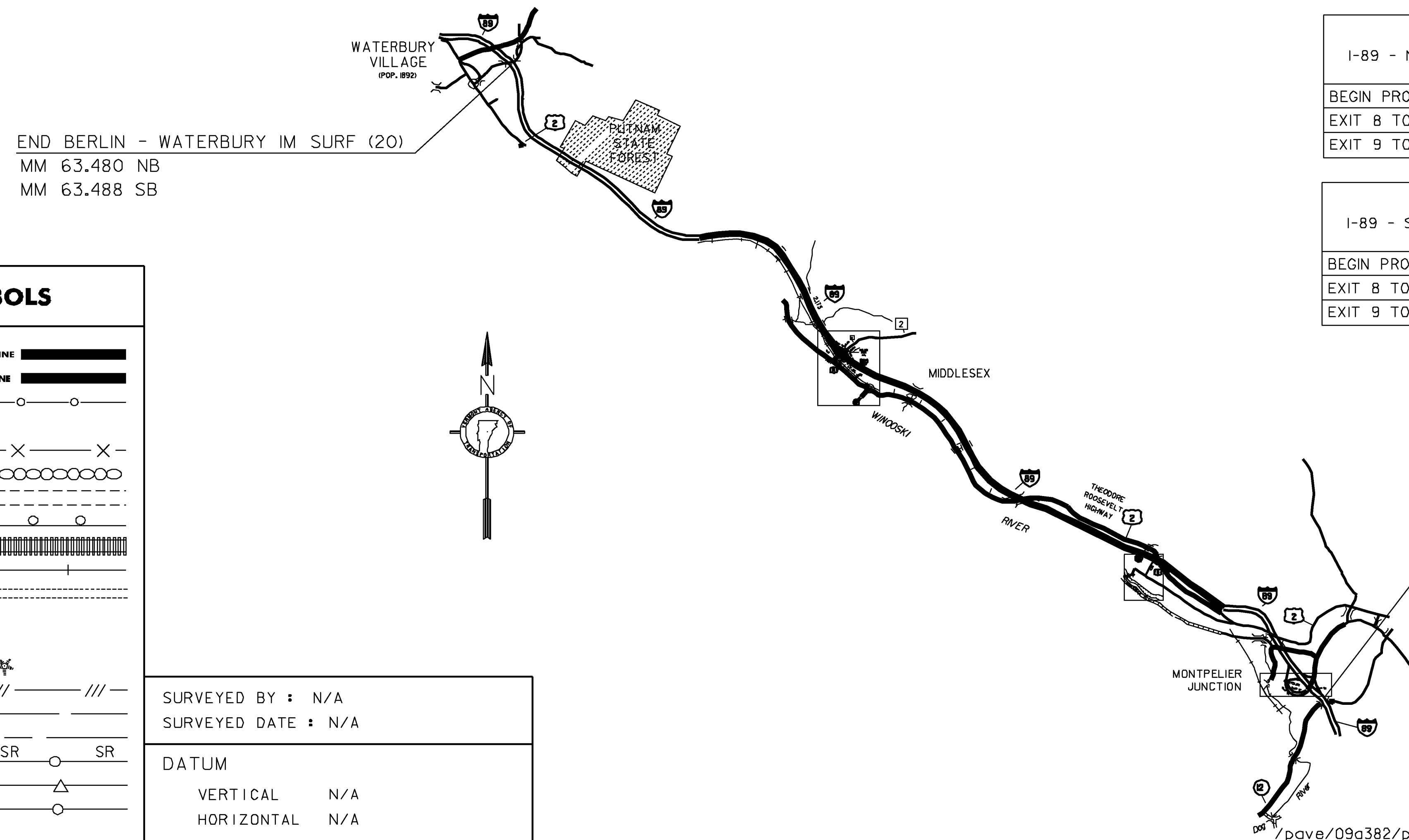
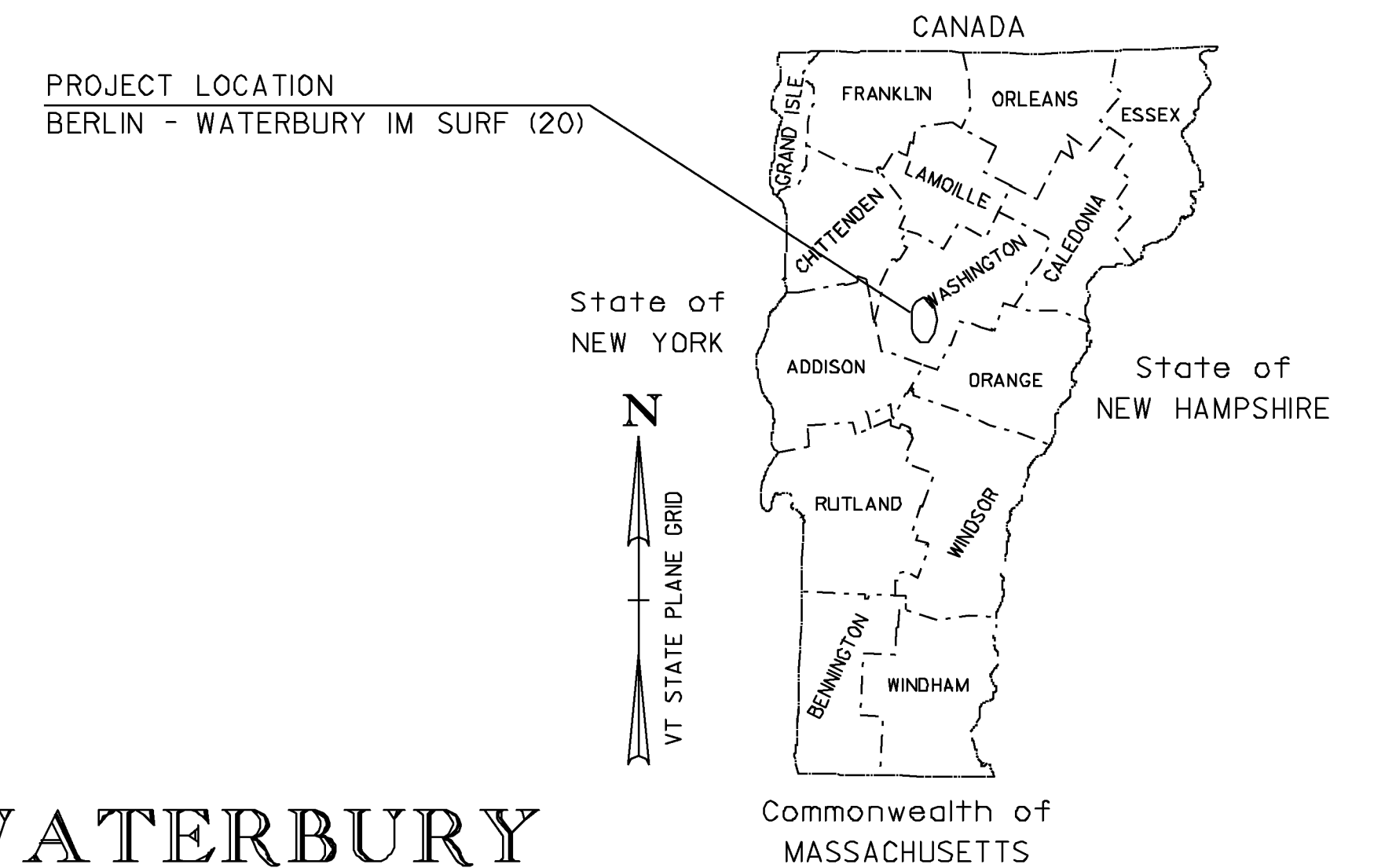

TRAFFIC DATA

I-89 - NORTHBOUND	2010 AADT	2020 AADT	2010 DHV	2020 DHV	FLEXIBLE ESALS (2010 - 2020)	FLEXIBLE ESALS (2010 - 2030)
BEGIN PROJECT TO EXIT 8	10,900	12,200	1,300	1,500	5,736,000	15,373,000
EXIT 8 TO EXIT 9	13,000	14,500	1,600	1,800	5,168,000	13,565,000
EXIT 9 TO END PROJECT	12,500	14,400	1,500	1,700	6,545,000	17,437,000

I-89 - SOUTHBOUND	2010 AADT	2020 AADT	2010 DHV	2020 DHV	FLEXIBLE ESALS (2010 - 2020)	FLEXIBLE ESALS (2010 - 2030)
BEGIN PROJECT TO EXIT 8	10,900	12,200	1,500	1,600	5,489,000	14,675,000
EXIT 8 TO EXIT 9	13,000	14,500	1,700	1,900	4,474,000	12,083,000
EXIT 9 TO END PROJECT	12,500	14,400	1,500	1,700	5,849,000	15,465,000

THESE PLANS ARE SUBJECT TO SUCH ENGINEERING CHANGES AS MAY BE REQUIRED BY THE FEDERAL HIGHWAY ADMINISTRATION OR THE DIRECTOR OF PROGRAM DEVELOPMENT.

CONSTRUCTION IS TO BE CARRIED ON IN ACCORDANCE WITH THESE PLANS AND THE STANDARD SPECIFICATIONS FOR CONSTRUCTION DATED 2006, AS APPROVED BY THE FEDERAL HIGHWAY ADMINISTRATION ON JUNE 15, 2006 FOR USE ON THIS PROJECT, INCLUDING ALL SUBSEQUENT REVISIONS AND SUCH REVISED SPECIFICATIONS AND SPECIAL PROVISIONS AS ARE INCORPORATED IN THESE PLANS.

CONVENTIONAL SYMBOLS	
COUNTY LINE	
TOWN LINE	
LIMITS OF ACCESS	
POINT OF ACCESS	
FENCE LINE	
STONE WALL	
TRAVELED WAY	
GUARD RAIL	
RAILROAD	
SURVEY LINE	
CULVERT	
POWER POLE	
TELEPHONE POLE	
TREES	
CONTROL OF ACCESS	
PROPERTY LINE	
R.O.W. TAKING LINE	
SLOPE RIGHTS	
TOP OF CUT	
TOE OF SLOPE	

SURVEYED BY : N/A
 SURVEYED DATE : N/A
 DATUM
 VERTICAL N/A
 HORIZONTAL N/A

PROJECT MANAGER : MIKE FOWLER
 PROJECT NAME : BERLIN - WATERBURY
 PROJECT NUMBER : IM SURF (20)
 SHEET 5 OF 63 SHEETS