

30" FROM EDGE LINE (WHITE OR YELLOW ) FOR ALL SHOULDERS 6'-0" OR WIDER WITH NO GUARDRAIL. 6" FROM EDGE LINES (WHITE OR YELLOW) FOR ALL SHOULDERS LESS THAN 6'-0" WIDE WITH NO GUARDRAIL.

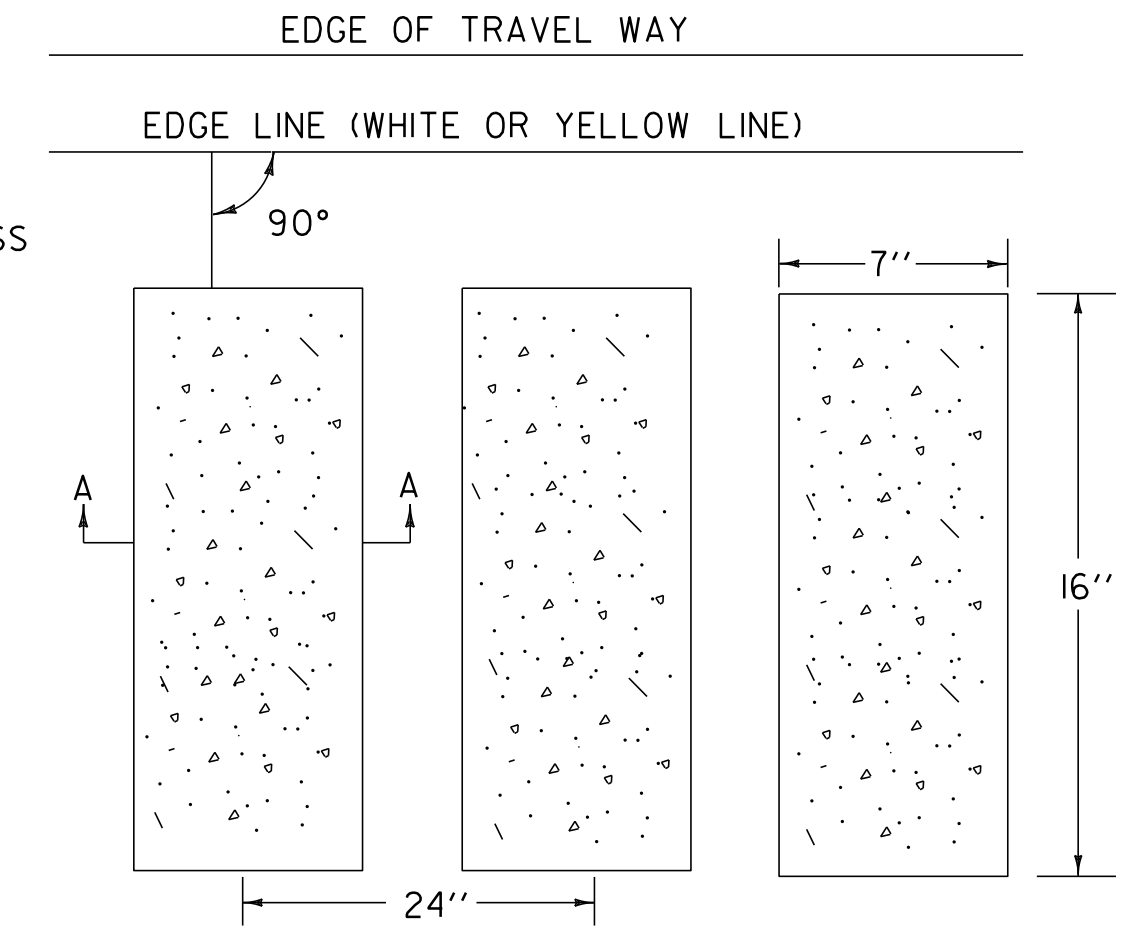

NOTE: STOP MILLED RUMBLE STRIPS WITH GUARDRAIL WITHIN 4'-0" OF TRAVEL WAY.

### TYPICAL RUMBLE STRIP MILLING DETAIL

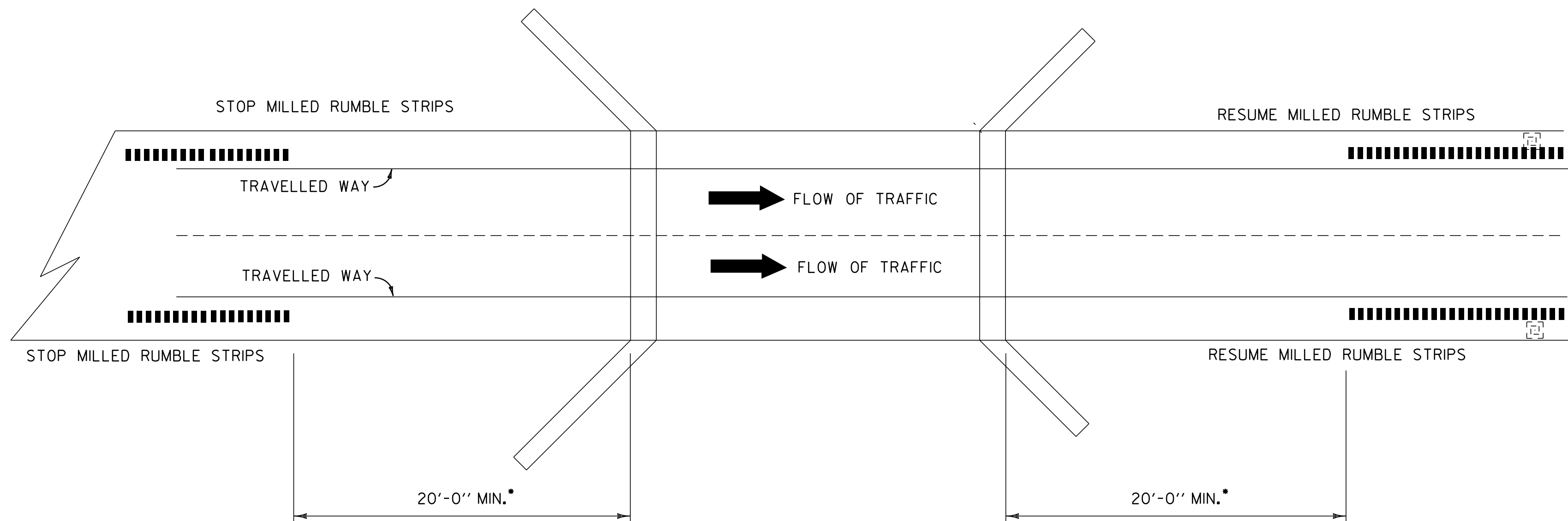

1. APPROACH RAIL WILL DETERMINE MINIMUM DISTANCE IN SOME CASES.
2. DO NOT CUT INTO CONCRETE APPROACH SLABS

### MILLED RUMBLE STRIP BRIDGE & DRAINAGE DETAIL

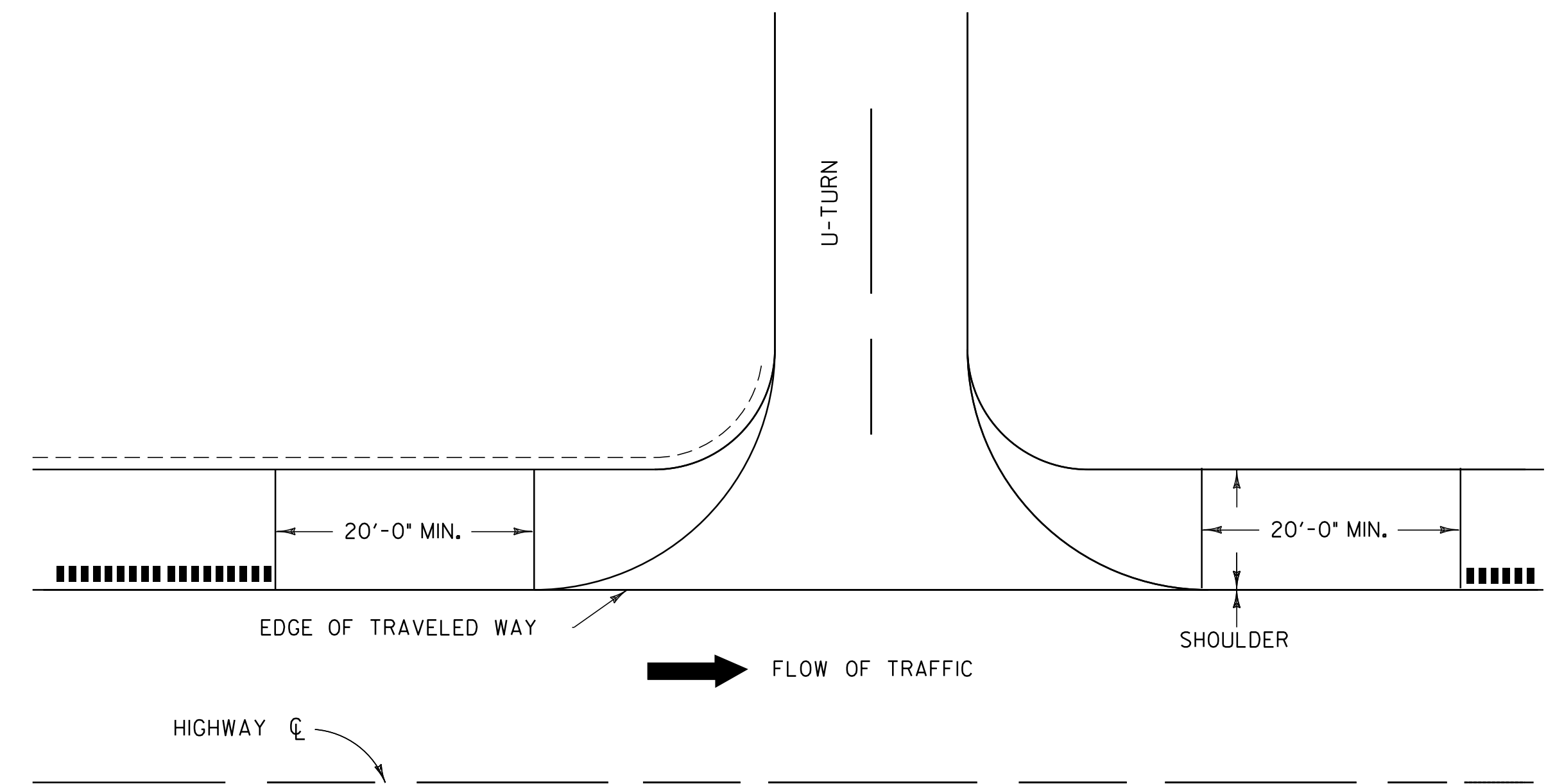

NOTE :THIS DETAIL MAY BE MODIFIED AT THE RESIDENT ENGINEER'S DISCRETION IF ACTUAL FIELD CONDITIONS NECESSITATE SUCH ACTIONS.

### MILLED RUMBLE STRIPS U TURN DETAIL

### DETAILS NOT TO SCALE

#### MILLED RUMBLE STRIP DETAILS #1

PROJECT NAME: SHEFFIELD - BARTON  
PROJECT NUMBER: IM SURF(18)

FILE NAME: p09a044.dgn  
PROJECT LEADER: MIKE FOWLER  
DESIGNED BY: WILDER  
PLOT FILE: p09a044\_08.i

PLOT DATE: 04-NOV-2011 6:15  
DRAWN BY: WILDER  
CHECKED BY: LOCKE  
SHEET 7 OF 9